

30-025-28603

NO. OF COPIES RECEIVED	
DISTRIBUTION	
SANTA FE	
FILE	
U.S.G.S.	
LAND OFFICE	
OPERATOR	

NEW MEXICO OIL CONSERVATION COMMISSION

Form C-101
Revised 1-1-65

5A. Indicate Type of Lease STATE <input checked="" type="checkbox"/> FEE <input type="checkbox"/>
5. State Oil & Gas Lease No. B-1520-1

APPLICATION FOR PERMIT TO DRILL, DEEPEN, OR PLUG BACK

1a. Type of Work b. Type of Well OIL WELL <input checked="" type="checkbox"/> GAS WELL <input type="checkbox"/> OTHER <input type="checkbox"/> SINGLE ZONE <input checked="" type="checkbox"/> MULTIPLE ZONE <input type="checkbox"/>		7. Unit Agreement Name NORTH VACUUM ABO UNIT
2. Name of Operator Mobil Producing TX. & N.M. Inc.		8. Farm or Lease Name
3. Address of Operator Nine Greenway Plaza, Suite 2700, Houston, TEXAS 77046		9. Well No. 244
4. Location of Well UNIT LETTER 0 LOCATED 589 FEET FROM THE South LINE AND 1859 FEET FROM THE East LINE OF SEC. 23 TWP. 17S RGE. 34E NMPM		10. Field and Pool, or Wildcat North Vacuum Abo
12. County LEA		
19. Proposed Depth 8700'		19A. Formation Abo
20. Rotary or C.T. Rotary		
21. Elevations (Show whether DF, RT, etc.) 4028' GL	21A. Kind & Status Plug. Bond On File	21B. Drilling Contractor Unknown
22. Approx. Date Work will start As soon as possible		

PROPOSED CASING AND CEMENT PROGRAM

SIZE OF HOLE	SIZE OF CASING	WEIGHT PER FOOT	SETTING DEPTH	SACKS OF CEMENT	EST. TOP
17-1/2"	13-3/8"	48.0# H-40	0-400'	Circulate	Surface
12-1/4"	8-5/8"	28.0# S-80	0-5000'	Circulate	Surface
7-7/8"	5-1/2"	15.5# K-55 17.0# N-80	4800'-7300' 7300'-TD	Circulate	Surface

BLOWOUT PREVENTOR PROGRAM

Casing String	Equipment Size & API Series	No. & Type	Test Pressure PSI
Surface	13-5/8" x 3000#	1 MG & 1 PR 1 MG 2 PR & Rotary Head	3000 5000

APPROVAL VALID FOR 180 DAYS
PERMIT EXPIRES 8/6/84
UNLESS DRILLING UNDERWAY

IN ABOVE SPACE DESCRIBE PROPOSED PROGRAM: IF PROPOSAL IS TO DEEPEN OR PLUG BACK, GIVE DATA ON PRESENT PRODUCTIVE ZONE AND PROPOSED NEW PRODUCTIVE ZONE. GIVE BLOWOUT PREVENTOR PROGRAM, IF ANY.

I hereby certify that the information above is true and complete to the best of my knowledge and belief.

Signed A. D. BOND A. D. BOND Title Regulatory Technician Supervisor Date 1/26/84

(This space for State Use)
ORIGINAL SIGNED BY JERRY SEXTON
DISTRICT I SUPERVISOR

FEB 6 1984

APPROVED BY _____ TITLE _____ DATE _____

CONDITIONS OF APPROVAL, IF ANY:

RECEIVED
FEB 6 1984
O.C.D.
HOUS OFFICE

OIL CONSERVATION DIVISION

STATE OF NEW MEXICO
ENERGY AND MINERALS DEPARTMENTP. O. BOX 2088
SANTA FE, NEW MEXICO 87501Form C-102
Revised 10-1-78

All distances must be from the outer boundaries of the Section.

Operator MOBIL PRODUCING TX. & N.M. INC.			Lease NORTH VACUUM ABO UNIT		Well No. 244
Unit Letter 0	Section 23	Township 17S	Range 34E	County Lea	
Actual Footage Location of Well: 589 feet from the South line and 1859 feet from the East line					
Ground Level Elev. 4028'	Producing Formation Abo	Pool Vacuum, North-Abo	Dedicated Acreage: (2 wells) 80 Acres		

1. Outline the acreage dedicated to the subject well by colored pencil or hatchure marks on the plat below.
2. If more than one lease is dedicated to the well, outline each and identify the ownership thereof (both as to working interest and royalty).
3. If more than one lease of different ownership is dedicated to the well, have the interests of all owners been consolidated by communitization, unitization, force-pooling, etc?

☒ Yes ☐ No If answer is "yes," type of consolidation UNITIZED

If answer is "no," list the owners and tract descriptions which have actually been consolidated. (Use reverse side of this form if necessary.)

No allowable will be assigned to the well until all interests have been consolidated (by communitization, unitization, forced-pooling, or otherwise) or until a non-standard unit, eliminating such interests, has been approved by the Division.

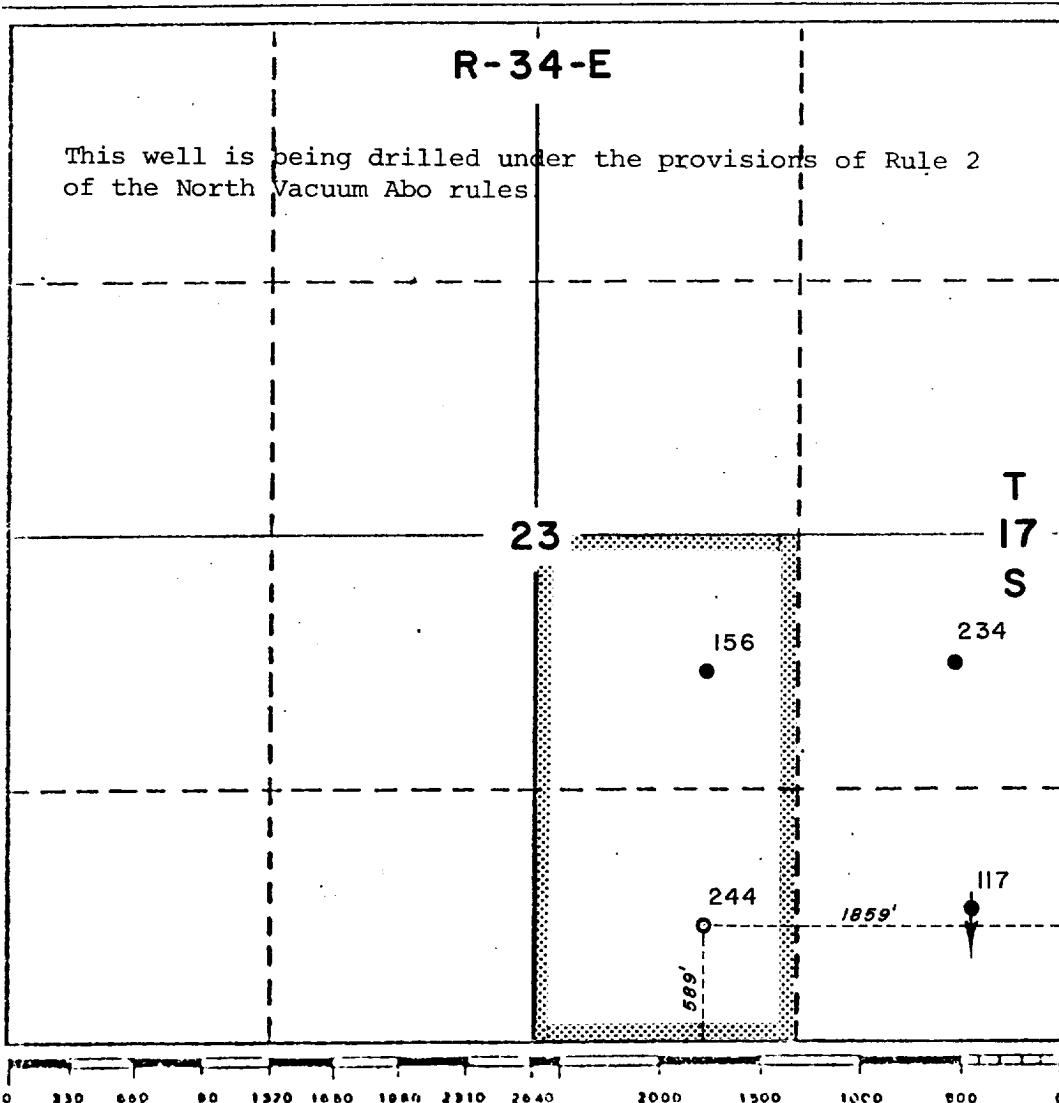

CERTIFICATION

I hereby certify that the information contained herein is true and complete to the best of my knowledge and belief.

Name

A. D. BOND

Position Regulatory
Technician SupervisorCompany Mobil Producing
TX. & N.M. Inc.

Date

1/26/84

I hereby certify that the well location shown on this plat was plotted from field notes of actual surveys made by me or under my supervision and that the same is true and correct to the best of my knowledge and belief.

Date Surveyed

1-12-84

Registered Professional Engineer
and/or Land Surveyor

H. A. CARSON, JR.

Certificate No.

5063

20/5/84
RECEIVED
FEB 6 1984
O.C.D.
HOBBS OFFICE