

COUNTY	LEA	FIELD	*Unnamed		STATE	NM																																																								
OPR	*MOROILCO INC				API	30-025-28745																																																								
NO	1	LEASE	Stivason Federal		MAP																																																									
	Sec 33, T19S, R34E				CO-ORD	7-4-9 NM																																																								
	330 FNL, 330 FEL of Sec				Re SPD	5-31-84																																																								
	13 mi SW/Buckeye				Re CMP	4-25-85																																																								
CSG	8 5/8-1533-600 sx 4 1/2-5207-600 sx 2 3/8-3842				<table border="1"> <thead> <tr> <th colspan="2">WELL CLASS: INIT</th> <th>WP</th> <th>FIN</th> <th>WPD</th> <th>LSE</th> <th>CODE</th> </tr> <tr> <th>FORMATION</th> <th>DATUM</th> <th>FORMATION</th> <th>DATUM</th> <th></th> <th></th> <th></th> </tr> </thead> <tbody> <tr><td></td><td></td><td></td><td></td><td></td><td></td><td></td></tr> <tr><td></td><td></td><td></td><td></td><td></td><td></td><td></td></tr> <tr><td></td><td></td><td></td><td></td><td></td><td></td><td></td></tr> <tr><td></td><td></td><td></td><td></td><td></td><td></td><td></td></tr> <tr><td></td><td></td><td></td><td></td><td></td><td></td><td></td></tr> <tr> <td>ID 5207 (PNRS)</td> <td></td> <td>PBD</td> <td colspan="4">3950</td> </tr> </tbody> </table>		WELL CLASS: INIT		WP	FIN	WPD	LSE	CODE	FORMATION	DATUM	FORMATION	DATUM																																							ID 5207 (PNRS)		PBD	3950			
WELL CLASS: INIT		WP	FIN	WPD	LSE	CODE																																																								
FORMATION	DATUM	FORMATION	DATUM																																																											
ID 5207 (PNRS)		PBD	3950																																																											
IP (Seven Rivers) Perfs 3909-3914 CAOF 4508 MCFGPD. GOR 270; gty (Gas) .694; (Cond) 46; SIWHP 1332; SIBHP 1344																																																														
P.L.C.: None																																																														
CONTR	OPR FILED				*3695 GR	SUBS																																																								

7-22-85

F.R.C. 7-27-85 OWWO
PD 3950 WO (Seven Rivers)
(Orig. Cmp. 7-10-84 thru (Queen) Perfs 4511-
5028; OTD 5207; OPB 5160)
TD 5207; PBD 3950; Complete
PB to 3950
Perf (Seven Rivers) 3909-3914
No treatment reported (3909-3914)
Seven Rivers discovery; No suggested field name
(Seven Rivers) FOUR POINT GAUGES:
Flwd 464 MCFGPD, 6/64 chk, 60 mins, TP 1307
Flwd 777 MCFGPD, 10/64 chk, 60 mins, TP 1250
Flwd 1157 MCFGPD, 15/64 chk, 60 mins, TP 1187
Flwd 1641 MCFGPD, 18/64 chk, 60 mins, TP 1065
BHT 114 deg @ 3911

*Denotes changes & additions 7-4-9 NM

LEA
*MOROILCO INC

*Unnamed
1 Stivason Federal
Sec 33, T19S, R34E

NM
Page #2

7-27-85
8-31-85

COMPLETION ISSUED
RE-ISSUED COMPLETION: Formerly Morocico Inc
Wildcat & 3195 GR

7-4-9 NM
IC 30-025-70357-85

COUNTY **LEA** FIELD **Wildcat** STATE **NM**
 OPR **MOROICCO INC** API **30-025-28745**
 NO **1** LEASE **Strivason Federal** MAP
 Sec **33, T19S, R34E** CO-ORD
330 FNL, 330 FEL of Sec **7-4-9 NM**
13 mi SW/Buckeye SPD **5-31-84 Re** MP **4-25-85**

CSG 8 5/8-1533-600 SX 4 1/2-5207-600 SX 2 3/8-3842	WELL CLASS: INIT WP FIN WPD LSE CODE			
	FORMATION	DATUM	FORMATION	DATUM
	TD 5200 (PNRS)		PBD	3950

IP (Seven Rivers) Perfs 3909-3914 CAOF 4508 MCFGPD. GOR 270;
 gty (Gas) .694; (Cond) 46; SIWHP 1332; SIBHP 1344

P.L.C.: None

CONTR	OPRS ELEV	3195 GR	3085
-------	-----------	---------	------

7-22-85 F.R.C. 7-27-85 OWWO
 PD 3950 WO (Seven Rivers)
 (Orig. Cmp. 7-10-84 thru (Queen) Perfs 4511-
 5028; OTD 5207; OPB 5160)
 TD 5207; PBD 3950; Complete
 PB to 3950
 Perf (Seven Rivers) 3909-3914)
 No treatment reported (3909-3914)
 Seven Rivers gas discovery; No suggested field
 name
 (Seven Rivers) FOUR POINT GAUGES:
 Flwd 464 MCFGPD, 6/64 chk, 60 mins, TP 1307
 Flwd 777 MCFGPD, 10/64 chk, 60 mins, TP 1250
 Flwd 1157 MCFGPD, 15/64 chk, 60 mins, TP 1187
 Flwd 1641 MCFGPD, 18/64 chk, 60 mins, TP 1065
 BHT 114 deg @ 3911
 7-27-85 COMPLETION ISSUED 7-4-9 NM
 IC 30-025-70357-85

**NEW MEXICO OIL CONSERVATION COMMISSION
WELL LOCATION AND ACREAGE DEDICATION PLAT**

Form 128
Supp. 1-65
Eff. 1-65

All distances must be from the outer boundaries of the Section.

Operator MOR OIL CO.			Lease STIVASON FEDERAL		Well No. 1
Unit Letter A	Section 33	Township 19S	Range 34E	County LEA	
Actual Footage Location of Well: 330 feet from the NORTH line and 330 feet from the EAST line					
Ground Level Elev. 3694.9	Producing Formation Seven Rivers	Pool N. San Miguel Seven Rivers Gas		Dedicated Acreage: 160 Acres	

1. Outline the acreage dedicated to the subject well by colored pencil or hachure marks on the plat below.
2. If more than one lease is dedicated to the well, outline each and identify the ownership thereof (both as to working interest and royalty).
3. If more than one lease of different ownership is dedicated to the well, have the interests of all owners been consolidated by communitization, unitization, force-pooling, etc?
☐ Yes ☐ No If answer is "yes," type of consolidation _____

If answer is "no," list the owners and tract descriptions which have actually been consolidated. (Use reverse side of this form if necessary.) _____

No allowable will be assigned to the well until all interests have been consolidated (by communitization, unitization, forced-pooling, or otherwise) or until a non-standard unit, eliminating such interests, has been approved by the Commission.

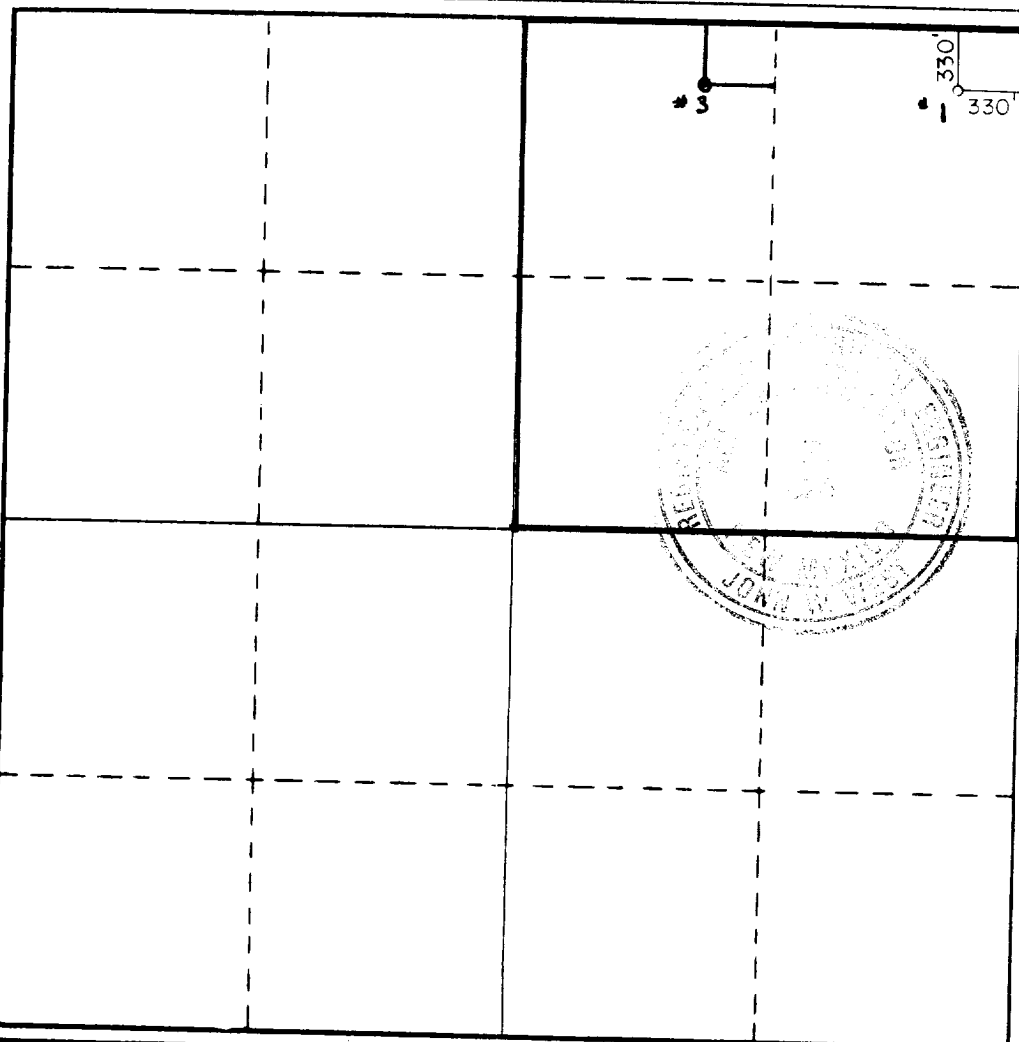

CERTIFICATION

I hereby certify that the information contained herein is true and complete to the best of my knowledge and belief.

Name
Frank S. Morgan
Position
Operator
Company
MorOilCo, Inc.
Date
July 18, 1986

I hereby certify that the well location shown on this plat was plotted from field notes of actual surveys made by me or under my supervision, and that the same is true and correct to the best of my knowledge and belief.

Date Surveyed
5/10/84
Registered Professional Engineer and/or Land Surveyor
John W. West
Certificate No. **JOHN W. WEST, 676**
RONALD J. EIDSON, 3239

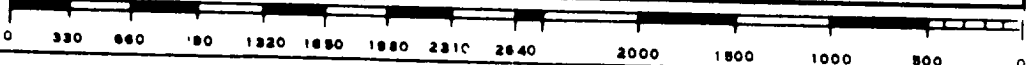

**MEXICO OIL CONSERVATION COMMISSION
WELL LOCATION AND ACREAGE DEDICATION PLAT**

Form C-107
Supersedes C-128
Effective 1-1-65

All distances must be from the outer boundaries of the Section

Operator MOR OIL CO.			Lease STIVASON FEDERAL			Well No. 1
Grid Letter A	Section 33	Township 19S	Range 34E	County LEA		
Actual Footage Location of Well: 330 feet from the NORTH line and 330 feet from the EAST line						
Ground Level Elev. 3694.9	Producing Formation Penrose Queen		Pool Pearl Queen		Dedicated Acreage: 40 Acres	

1. Outline the acreage dedicated to the subject well by colored pencil or hatchure marks on the plat below.
2. If more than one lease is dedicated to the well, outline each and identify the ownership thereof (both as to working interest and royalty).
3. If more than one lease of different ownership is dedicated to the well, have the interests of all owners been consolidated by communitization, unitization, force-pooling, etc?

☐ Yes ☐ No If answer is "yes," type of consolidation _____

If answer is "no," list the owners and tract descriptions which have actually been consolidated. (Use reverse side of this form if necessary.) _____

No allowable will be assigned to the well until all interests have been consolidated (by communitization, unitization, forced-pooling, or otherwise) or until a non-standard unit, eliminating such interests, has been approved by the Commission.

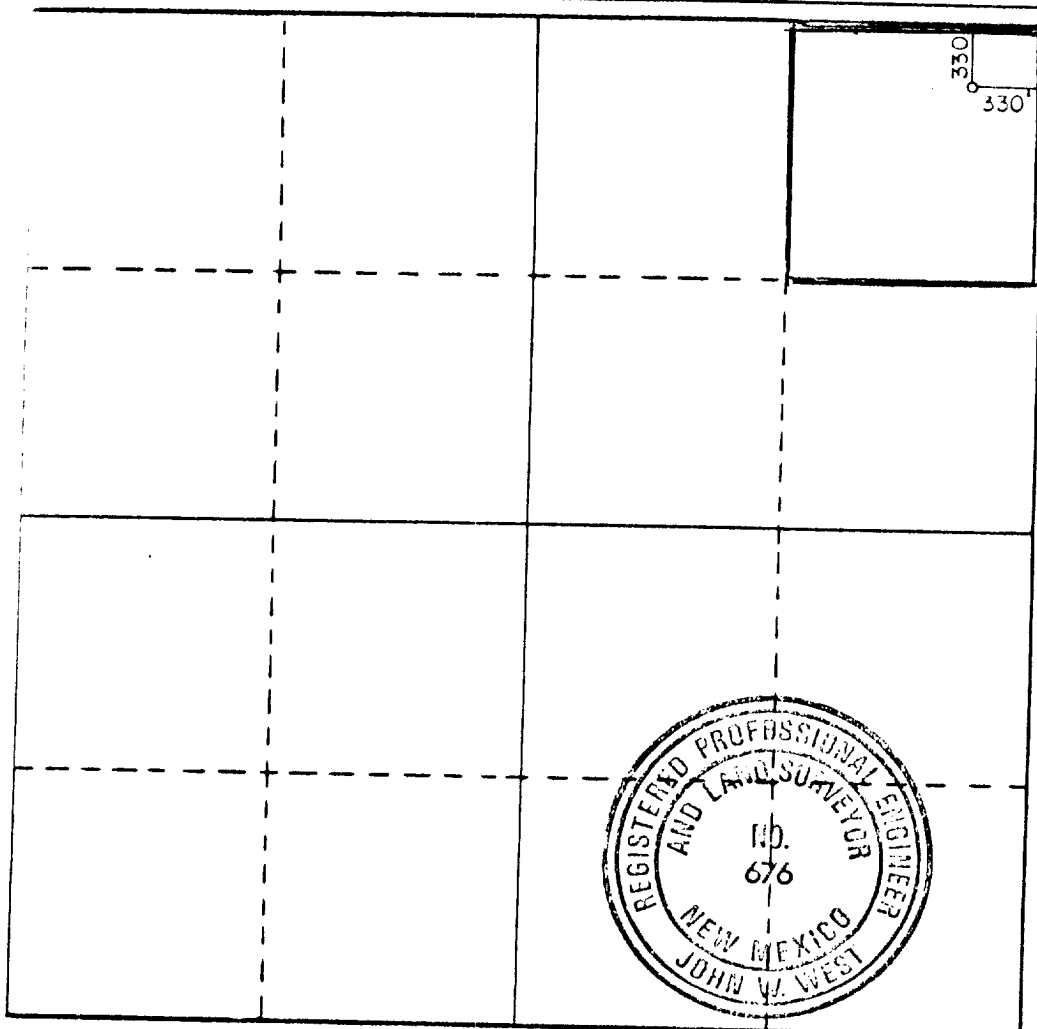

CERTIFICATION

I hereby certify that the information contained herein is true and complete to the best of my knowledge and belief.

Frank S. Morgan

Name

Frank S. Morgan

Position

Operator

Company

MorOilCo, Inc.

Date

May 17, 1984

I hereby certify that the well location shown on this plat was plotted from field notes of actual surveys made by me or under my supervision, and that the same is true and correct to the best of my knowledge and belief.

Date Surveyed

5/10/84

Registered Professional Engineer and/or Land Surveyor

John W. West
Certificate No. **JOHN W. WEST,**
RONALD J. EIDSON

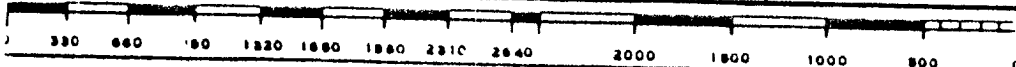

NEW MEXICO OIL CONSERVATION COMMISSION
WELL LOCATION AND ACREAGE DEDICATION PLAT

Form C-102
Supersedes C-128
Effective 1-1-65

All distances must be from the outer boundaries of the Section

Operator MOR OIL CO.		Lease STIVASON FEDERAL		Well No. 1
Unit Letter A	Section 33	Township 19S	Range 4E	County LEA
Actual Footage Location of Well: 330 feet from the NORTH line and 330 feet from the EAST line				
Ground Level Elev. 3694.9	Producing Formation Seven Rivers	Pool Wildcat	Dedicated Acreage: 160 Acres	

1. Outline the acreage dedicated to the subject well by colored pencil or hachure marks on the plat below.
2. If more than one lease is dedicated to the well, outline each and identify the ownership thereof (both as to working interest and royalty).
3. If more than one lease of different ownership is dedicated to the well, have the interests of all owners been consolidated by communitization, unitization, force-pooling, etc?

☐ Yes ☐ No If answer is "yes," type of consolidation _____

If answer is "no," list the owners and tract descriptions which have actually been consolidated. (Use reverse side of this form if necessary.) _____

No allowable will be assigned to the well until all interests have been consolidated (by communitization, unitization, forced-pooling, or otherwise) or until a non-standard unit, eliminating such interests, has been approved by the Commission.

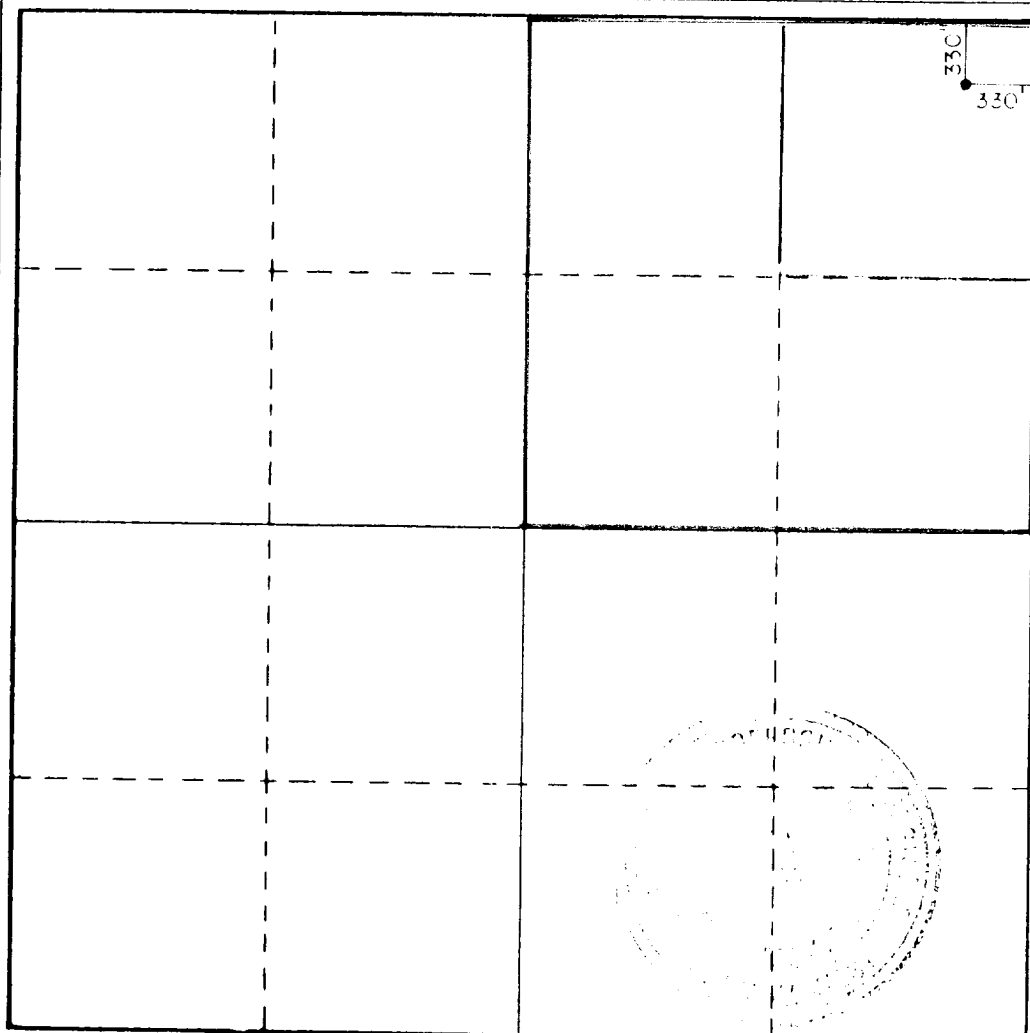

CERTIFICATION

I hereby certify that the information contained herein is true and complete to the best of my knowledge and belief.

Frank S. Morgan

Name

Frank S. Morgan

Position

Operator

Company

MorOilCo, Inc.

Date

May 17, 1984

I hereby certify that the well location shown on this plat was plotted from field notes of actual surveys made by me or under my supervision, and that the same is true and correct to the best of my knowledge and belief.

Date Surveyed

5/10/84

Registered Professional Engineer and/or Land Surveyor

John W. West

Certificate No. JOHN W. WEST,

676

RONALD J. EIDSON,

3239