

CONSERVATION DIVISION

STATE OF NEW MEXICO
ENERGY AND MINERALS DEPARTMENT

P. O. BOX 2088
SANTA FE, NEW MEXICO 87501

Form C-102
Revised 10-1-78

All distances must be from the outer boundaries of the Section.

Operator ARCO Oil and Gas Company			Lease Emma Lawrence		Well No. 1
Division of Atlantic Richfield Company					
Unit Letter I	Section 23	Township 17S	Range 38E	County Lea	
Actual Postage Location of Well:					
1980 feet from the South line and		660 feet from the East line			
Ground Level Elev. 3663.3'	Producing Formation Wolfcamp	Pool Knowles	Dedicated Acreage: 40 Acres		

1. Outline the acreage dedicated to the subject well by colored pencil or hachure marks on the plat below.
2. If more than one lease is dedicated to the well, outline each and identify the ownership thereof (both as to working interest and royalty).
3. If more than one lease of different ownership is dedicated to the well, have the interests of all owners been consolidated by communitization, unitization, force-pooling, etc?

☐ Yes ☐ No If answer is "yes," type of consolidation _____

If answer is "no," list the owners and tract descriptions which have actually been consolidated. (Use reverse side of this form if necessary.) _____

No allowable will be assigned to the well until all interests have been consolidated (by communitization, unitization, forced-pooling, or otherwise) or until a non-standard unit, eliminating such interests, has been approved by the Division.

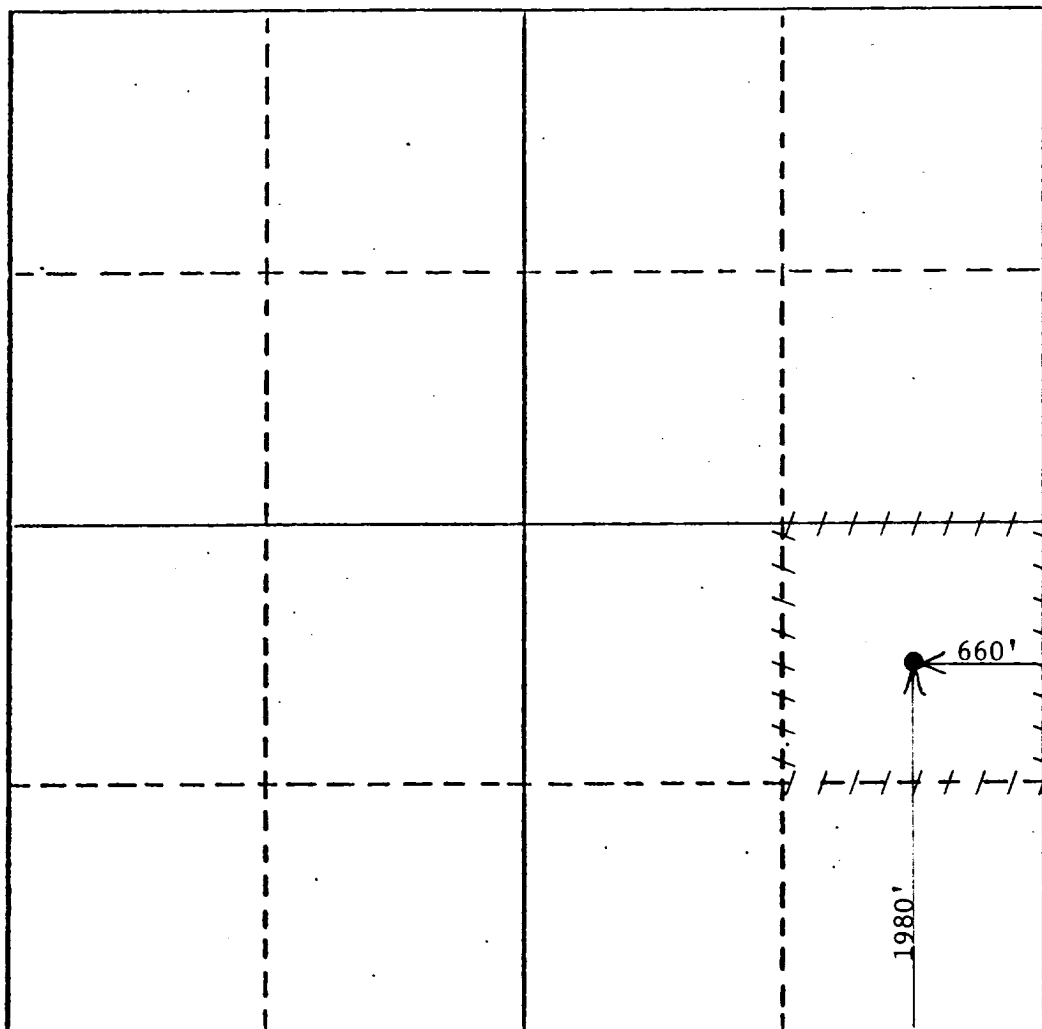

CERTIFICATION

I hereby certify that the information contained herein is true and complete to the best of my knowledge and belief.

Name *D. L. Shackelford*
Position

Engrg Tech Spec.

Company **ARCO Oil and Gas Co.,
Div. of Atlantic Richfield Co.**

Date
6/12/85

I hereby certify that the well location shown on this plat was plotted from field notes of actual surveys made by me or under my supervision, and that the same is true and correct to the best of my knowledge and belief.

Date Surveyed

Registered Professional Engineer
and/or Land Surveyor

Certificate No.

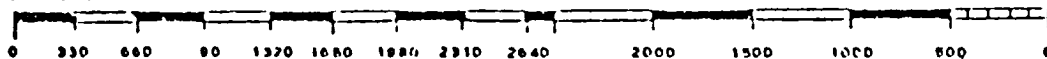

RECEIVED

JUN 12 1985

U.S. DEPT. OF JUSTICE
HOBBY OFFICE