

N. M. CONS. COMMISSION  
P. O. BOX 1000  
HOBBS, NEW MEXICO 88240  
UNITED STATESSUBMIT IN TRIPLICATE\*  
(Other instructions on  
reverse side)Form approved.  
Budget Bureau No. 42-R1425.DEPARTMENT OF THE INTERIOR  
GEOLOGICAL SURVEY

## APPLICATION FOR PERMIT TO DRILL, DEEPEN, OR PLUG BACK

## 1a. TYPE OF WORK

DRILL ☒DEEPEN ☐PLUG BACK ☐

## b. TYPE OF WELL

OIL  
WELL ☒GAS  
WELL ☐OTHER ☐SINGLE  
ZONE ☒MULTIPLE  
ZONE ☐

## 2. NAME OF OPERATOR

Harvey E. Yates Company

## 3. ADDRESS OF OPERATOR

P. O. Box 1933, Roswell, New Mexico 88201

## 4. LOCATION OF WELL (Report location clearly and in accordance with any State requirements.)\*

At surface

660' FSL &amp; 1980' FWL

At proposed prod. zone Same

## 14. DISTANCE IN MILES AND DIRECTION FROM NEAREST TOWN OR POST OFFICE\*

6 miles south of Maljamar, New Mexico

## 15. DISTANCE FROM PROPOSED\*

LOCATION TO NEAREST  
PROPERTY OR LEASE LINE, FT.  
(Also to nearest drlg. unit line, if any)

660'

## 16. NO. OF ACRES IN LEASE

160

17. NO. OF ACRES ASSIGNED  
TO THIS WELL

40

## 18. DISTANCE FROM PROPOSED LOCATION\*

TO NEAREST WELL, DRILLING, COMPLETED,  
OR APPLIED FOR, ON THIS LEASE, FT.

1980'

## 19. PROPOSED DEPTH

9250

## 20. ROTARY OR CABLE TOOLS

Rotary

## 21. ELEVATIONS (Show whether OF, RT, GR, etc.)

3844.8 GL

## 22. APPROX. DATE WORK WILL START\*

As soon as possible

23.

## PROPOSED CASING AND CEMENTING PROGRAM

SIZE OF HOLE	SIZE OF CASING	WEIGHT PER FOOT	SETTING DEPTH	QUANTITY OF CEMENT
17 1/2	13 3/8	54.5#	450	Circ
11	8 5/8	24 - 32#	2675	Circ
7 7/8	5 1/2	15 - 20#	9250	Suff to cover 600' above payzone.

## MUD PROGRAM:

0 - 450 FW Gel/Soda Ash & Paper.  
450 - 2675 Cut Brine  
2675 - 9250 GW Gel - Drispac.

IN ABOVE SPACE DESCRIBE PROPOSED PROGRAM: If proposal is to deepen or plug back, give data on present productive zone and proposed new productive zone. If proposal is to drill or deepen directionally, give pertinent data on subsurface locations and measured and true vertical depths. Give blowout preventer program, if any.

24.

SIGNED

Layne Collins

TITLE

Regulatory Administrator

DATE 5/2/85

(This space for Federal or State office use)

PERMIT NO.

APPROVAL DATE

APPROVED BY

TITLE

DATE

5-13-85

CONDITIONS OF APPROVAL, IF ANY:

APPROVAL SUBJECT TO  
GENERAL REQUIREMENTS AND  
SPECIAL STIPULATIONS  
ATTACHED

NE. MEXICO OIL CONSERVATION COMMISSION  
WELL LOCATION AND ACREAGE DEDICATION PLAT

Form C-102  
Supersedes C-128  
Effective 1-1-65

All distances must be from the outer boundaries of the Section

Operator Harvey E. Yates Co.			Lease Young Deep Unit 4 Federal		Well No. 3
Unit Letter N	Section 4	Township 18S	Range 32E	County Lea	
Actual Footage Location of Well:					
660 feet from the South line and		1980 feet from the West line			
Ground Level Elev. 3844.8	Producing Formation Bone Springs	Pool North Young Bone Springs	Dedicated Acreage: 40 Acres		

- Outline the acreage dedicated to the subject well by colored pencil or hachure marks on the plat below.
- If more than one lease is dedicated to the well, outline each and identify the ownership thereof (both as to working interest and royalty).
- If more than one lease of different ownership is dedicated to the well, have the interests of all owners been consolidated by communitization, unitization, force-pooling, etc?  
☒ Yes ☐ No If answer is "yes," type of consolidation Unitization (Uncommitted to Unit Agreement)

If answer is "no," list the owners and tract descriptions which have actually been consolidated. (Use reverse side of this form if necessary.)

No allowable will be assigned to the well until all interests have been consolidated (by communitization, unitization, forced-pooling, or otherwise) or until a non-standard unit, eliminating such interests, has been approved by the Commission.

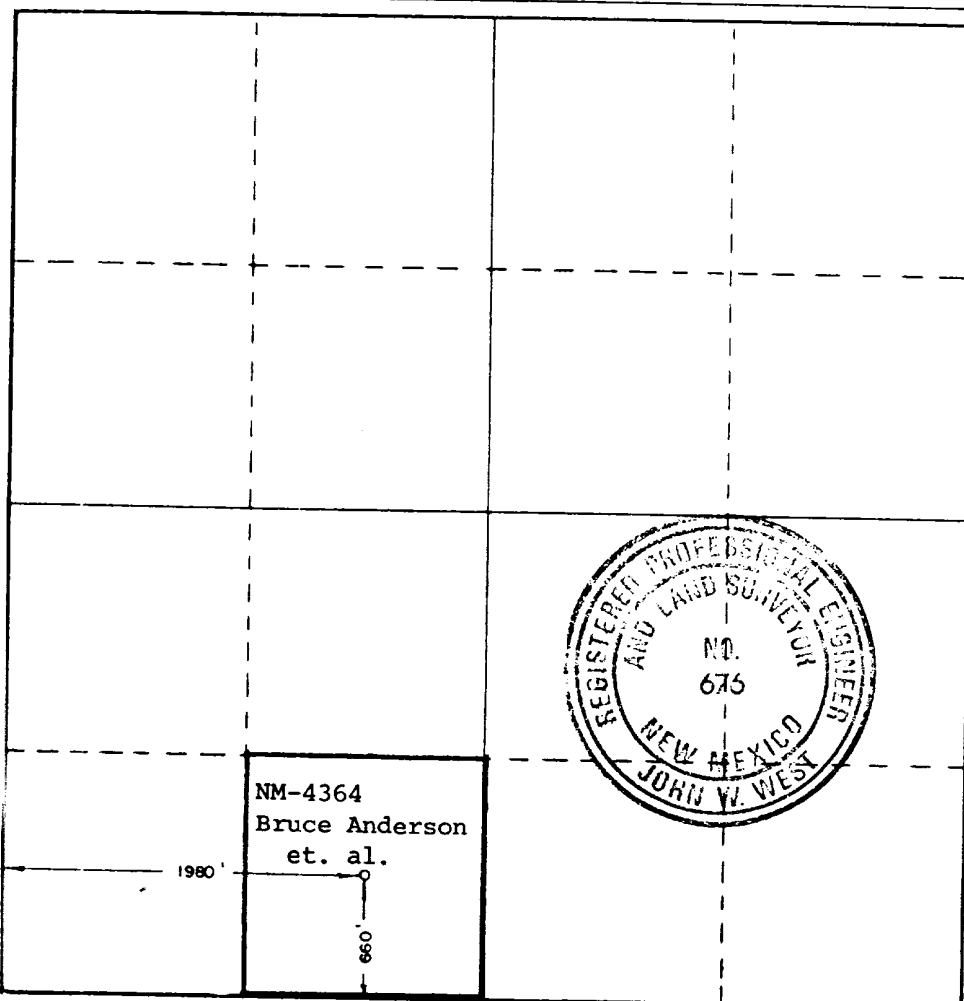

CERTIFICATION

I hereby certify that the information contained herein is true and complete to the best of my knowledge and belief.

*Layne Collis*

Name

Layne Collis

Position

Regulatory Administrator

Company

Harvey E. Yates Company

Date

May 2, 1985

I hereby certify that the well location shown on this plat was plotted from field notes of actual surveys made by me or under my supervision, and that the same is true and correct to the best of my knowledge and belief.

Date Surveyed

4/27/85

Registered Professional Engineer and/or Land Surveyor

*John W. West*

Certificate No. JOHN W. WEST,

676

RONALD J. EIDSON,

3239

## APPLICATION

HARVEY E. YATES COMPANY  
Young Deep Unit 4 Federal #3  
Sec. 4, T-18S, R-32E  
Lea County, New Mexico

In conjunction with Form 9-331C, Application for Permit to Drill the subject well in Section 4, Township 18 South, Range 32 East, Lea County, New Mexico, Harvey E. Yates Company submits the following ten items of pertinent information in accordance with Bureau of Land Management requirements:

1. The geologic surface formation is quaternary alluvium and bolson deposits and other surficial deposits.
2. The estimated tops of geologic markers are as follows:

Rustler	1130'	Cowden Anhy	2250'
Yates	2635'	Yates "A"	2690'
7 Rivers	3063'	Bowers	3520'
Queen	3784'	Penrose	4015'
Grayburg	4291'	San Andres	4630'
Delaware	5200'	Bone Springs	6050'
Wolfcamp	9140'	TD	9250'
3. We do not anticipate finding water but have listed the formation in which we anticipate finding oil or gas.

Bone Springs 6050'.
4. Proposed casing program: See Form 9-331C.
5. Pressure control equipment: See Exhibit C.
6. Mud Program: See Form 9-331C.
7. Auxiliary equipment: Blowout preventer.
8. Testing, logging and coring programs: Two possible DST's; 1-Bone Springs, 1-Wolfcamp. We are not planning to do any coring. Planned logs are DLL-Micro w/GR & Caliper, CN-Den w/GR & Caliper.
9. No abnormal pressures or temperatures are anticipated.
10. Anticipated starting date: As soon as possible.

## SURFACE USE PLAN

HARVEY E. YATES COMPANY  
Young Deep Unit 4 Federal #3  
Sec. 4, T-18S, R-32E  
Lea County, New Mexico

### 1. EXISTING ROADS:

- A. Exhibit A is a portion of the New Mexico Highway map showing the location of the proposed well. The location is approximately 38 miles east of Artesia, New Mexico or about 6 miles south of Maljamar, New Mexico. Leave Artesia on Highway 82 and travel east to the junction of New Mexico Highway 529. Turn south on Highway 529 and travel 7.2 miles to the intersection of New Mexico Highway 126. Turn south on Highway 126 and go 1.7 miles and turn left or south on a caliche road for approximately 600' and turn left or east for 700', turn left or north to the proposed location.
- B. We will have to build approximately 500' of new road to reach our proposed location. Exhibit B is a plat showing the existing roads in the area and the portion of new road that will have to be built.

### 2. PLANNED ACCESS ROADS:

- A. We propose to build approximately 500' of new road to the location. It will be 12' wide and 6" compacted caliche.

### 3. LOCATION OF EXISTING WELLS:

- A. There are two wells in this section besides our proposed Young Deep Unit 4 Federal #3. Exhibit B is a plat showing existing wells and their locations.

### 4. LOCATION OF TANK BATTERIES, ETC.:

- A. In the event we drill a producing well the production equipment located at the Young Deep Unit 4 Federal #1 will be utilized.

### 5. LOCATION AND TYPE OF WATER SUPPLY:

- A. Water will be obtained from commercial sources, either hauled or pipelined.

6. SOURCE OF CONSTRUCTION MATERIAL:
  - A. Caliche will be needed to build 500' of new road to reach our location and to construct the drilling pad. We plan to utilize caliche from a Bureau of Land Management pit location in the NE/4 of Section 9.
7. METHODS OF HANDLING WASTE DISPOSAL:
  - A. Waste will be buried in reserve pits at a depth of 36'. The well site will be cleaned of all waste and this will be done within 30 days after completion of the well.
8. ANCILLARY FACILITIES:
  - A. None required.
9. WELLSITE LAYOUT:
  - A. Exhibit D shows the relative location and dimensions of the well pad, reserve pits and major rig components.
  - B. There will be no cut and fill work done in the area - it is relatively flat with sandy soil and sand dunes. Some of these dunes will have to be levelled.
  - C. The pad and pit area have been staked.
10. PLANS FOR RESTORATION OF THE SURFACE:
  - A. After finishing drilling and/or other completion operations, all equipment and other materials not needed for further operations will be removed. Pits will be filled and the location cleaned of all trash and junk to leave the wellsite as pleasant in appearance as possible.
  - B. If the proposed well is non-productive, all restoration and/or vegetation requirements of the Bureau of Land Management will be complied with and will be accomplished as quickly as possible. All pits will be filled and levelled within 90 days after abandonment.
11. OTHER INFORMATION:
  - A. The surface is federal.
  - B. The topography consists of sandy soil with native

grasses, catclaw, etc. No wildlife was observed, but the usual inhabitants of this region are jackrabbits, reptiles, coyotes, etc.

- C. There are no ponds, lakes, streams or rivers in this area.
- D. There are no occupied dwellings or windmills in the area of the wellsite.
- E. There is no evidence of any archaeological, historical or cultural sites in the area.

12. OPERATOR'S REPRESENTATIVES:

- A. The field representatives responsible for assuring compliance with the approved surface use and operations plan are:

Micky Young  
Harvey E. Yates Company  
P. O. Box 1933  
Roswell, New Mexico 88201  
Office: 505/623-6601  
Mobil: 505/624-1818 #840

John Bilberry  
Harvey E. Yates Company  
P. O. Box 1933  
Roswell, New Mexico 88201  
Office: 505/746-3000  
Mobil: 505/624-1818 #849

13. CERTIFICATION:

I hereby certify that I am familiar with the condition which presently exist; that the statements made in this plan are to the best of my knowledge true and correct; and, that the work associated with the operations proposed herein will be performed by Harvey E. Yates Company and its contractors and subcontractors in conformity with this plan and the terms and conditions under which it is approved.

Layne Collis  
Layne Collis  
Regulatory Administrator

May 2, 1985  
Date

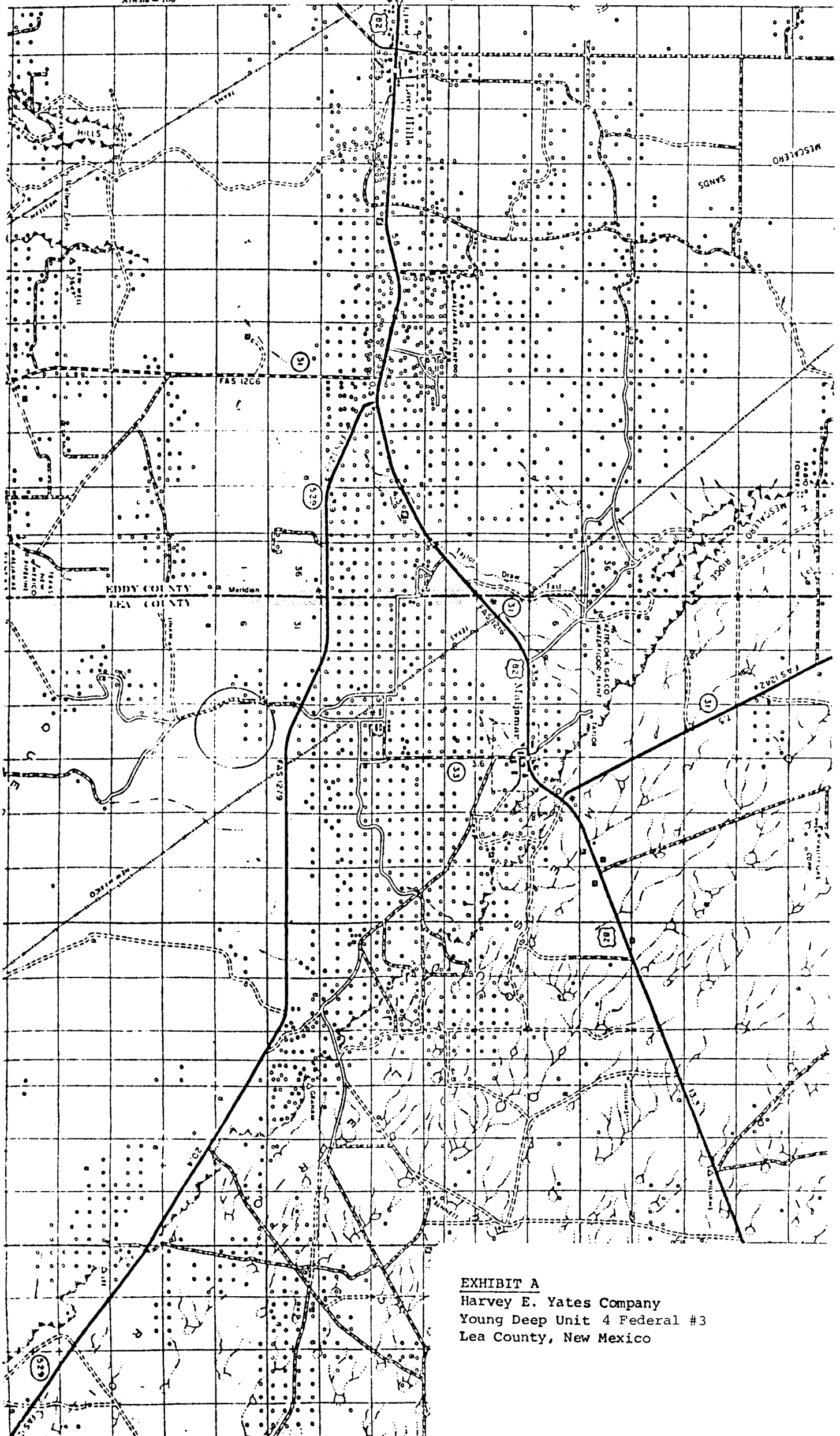

EXHIBIT A  
Harvey E. Yates Company  
Young Deep Unit 4 Federal #3  
Lea County, New Mexico

FIELD Young Deep Unit

OPERATOR Harvey E. Yates Company

COUNTY Lea

WELL NAME & NO. \_\_\_\_\_

STATE New Mexico

SURFACE USE PLAN

R 32 E

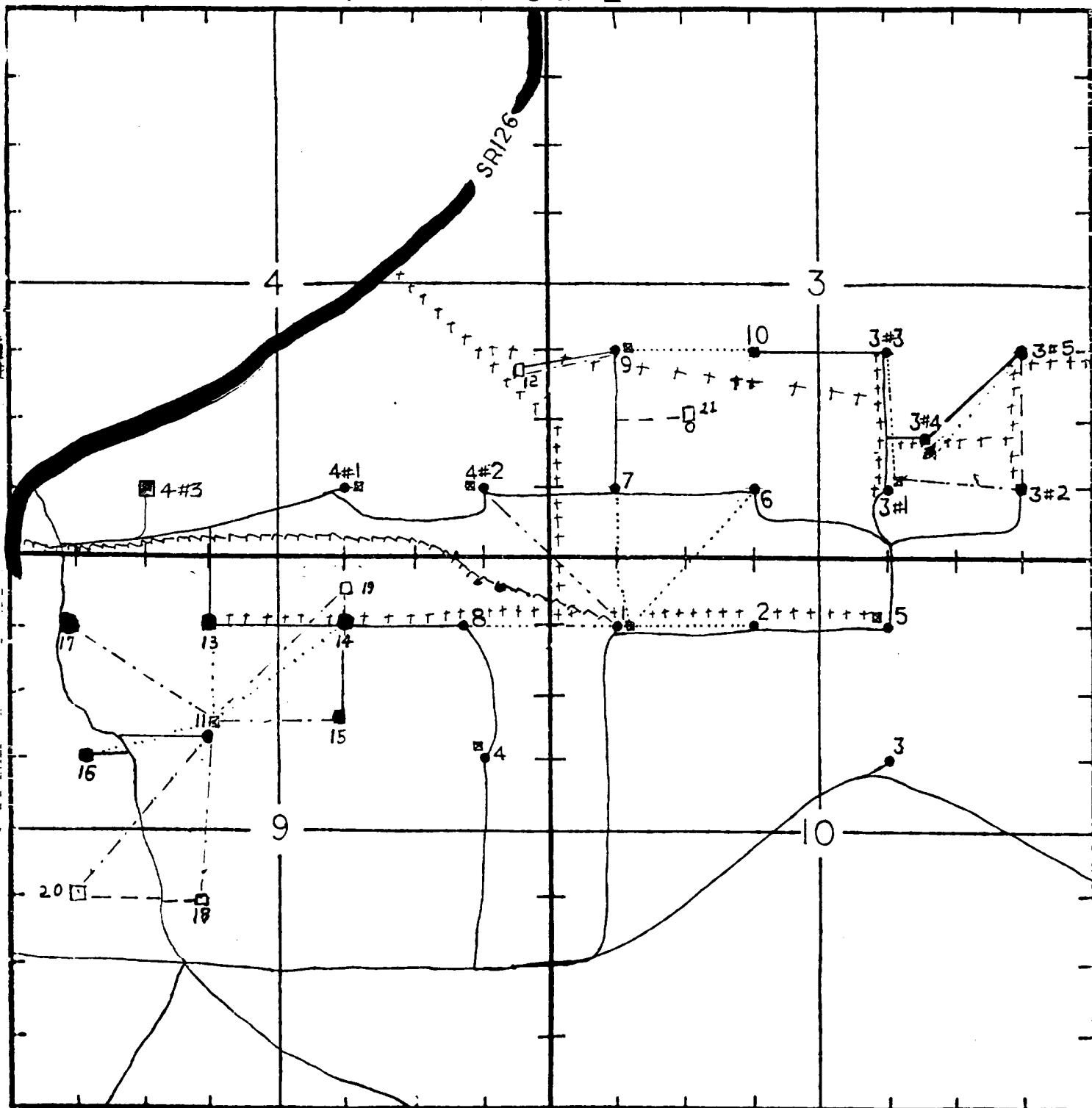

Existing well

Proposed well

Tank battery

Existing surface flowline

Proposed surface flowline

# 900 Series

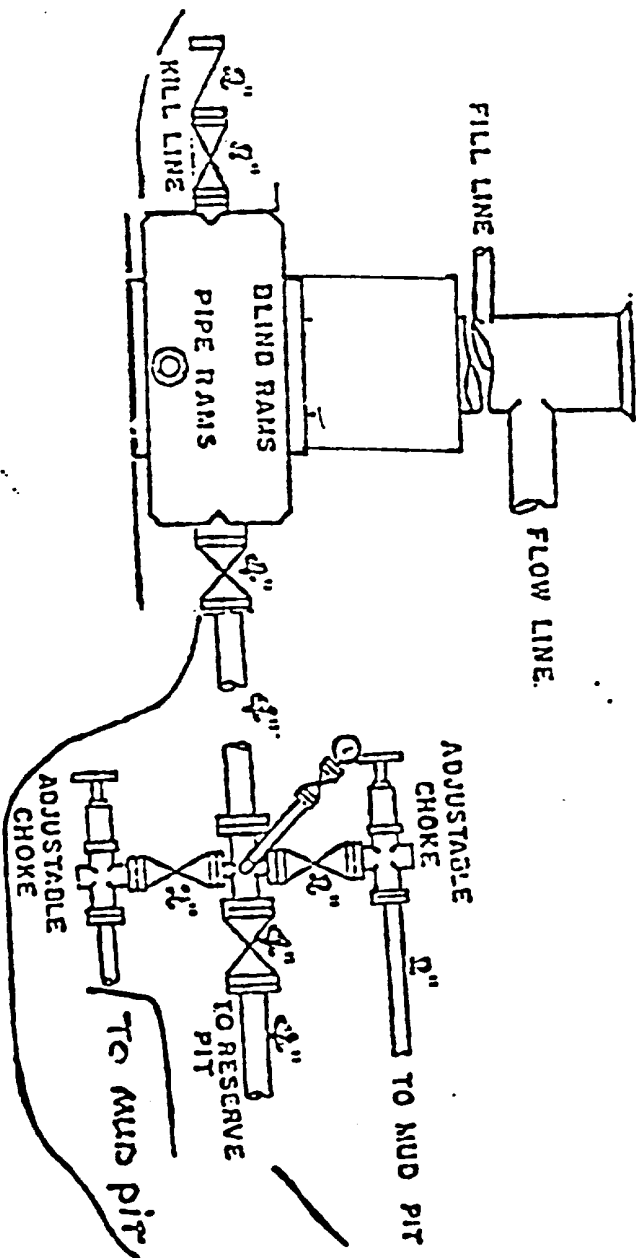
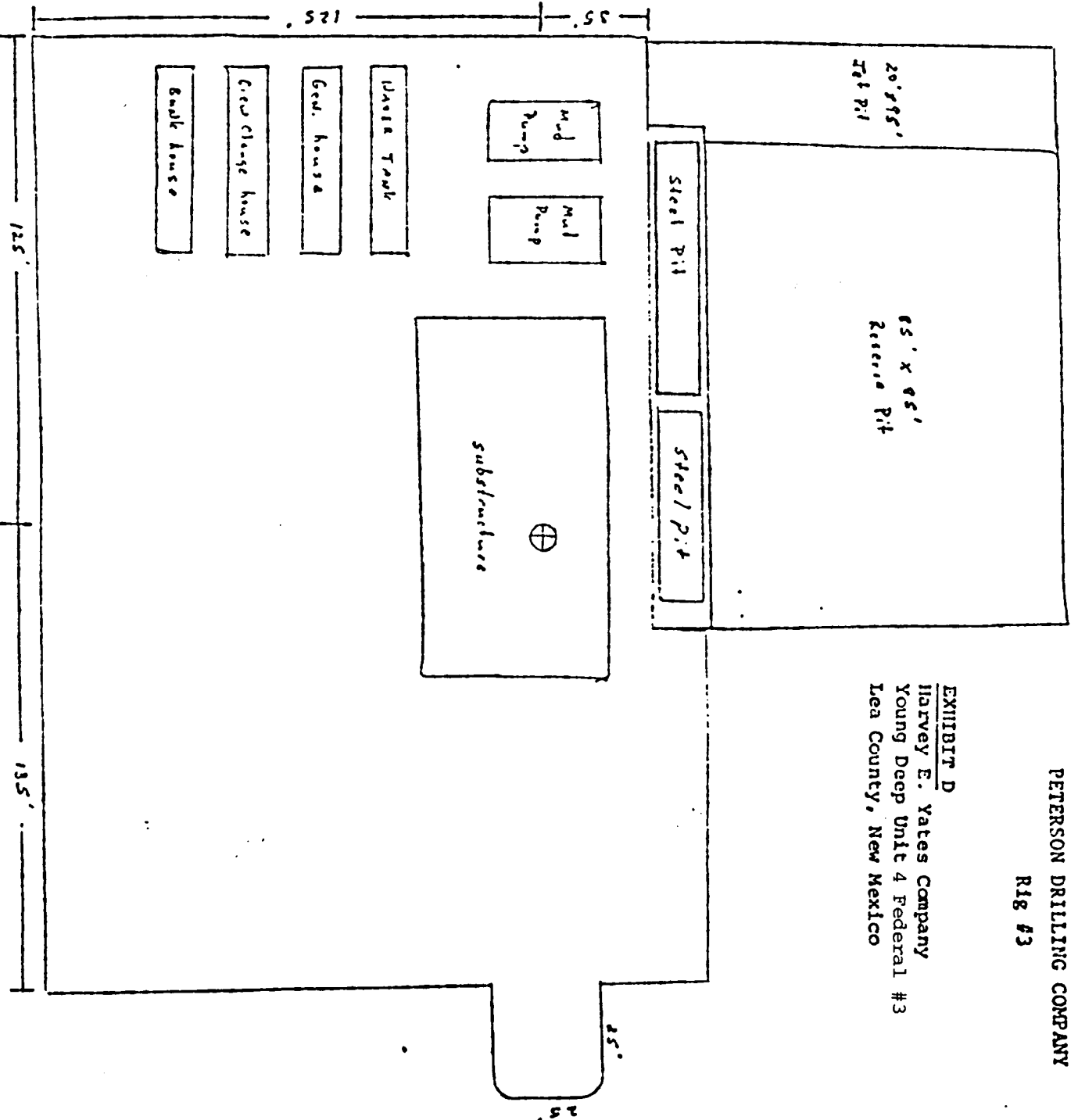

EXHIBIT C  
 Harvey E. Yates Company  
 Young Deep Unit 4 Federal #3  
 Lea County, New Mexico

PETERSON DRILLING COMPANY  
Rlg #3

EXHIBIT D  
Harvey E. Yates Company  
Young Deep Unit 4 Federal #3  
Lea County, New Mexico



**FF**  
**FROM**  
**FF**

**RECEIVED**

**MAY 14 1985**

**O. G. O.**  
**HOBBS OFFICE**