

STATE OF NEW MEXICO
ENERGY AND MINERALS DEPARTMENT

OIL CONSERVATION DIVISION

P. O. BOX 2088
SANTA FE, NEW MEXICO 87501

Form C-101
Revised 10-1-78

NO. OF COPIES RECEIVED	
DISTRIBUTION	
SANTA FE	
FILE	
U.S.G.S.	
LAND OFFICE	
OPERATOR	

5A. Indicate Type of Lease
STATE ☐ REC ☒

5. State Oil & Gas Lease No.

APPLICATION FOR PERMIT TO DRILL, DEEPEN, OR PLUG BACK

1a. Type of Work DRILL <input checked="" type="checkbox"/> DEEPEN <input type="checkbox"/> PLUG BACK <input type="checkbox"/>				7. Unit Agreement Name	
b. Type of Well OIL WELL <input checked="" type="checkbox"/> GAS WELL <input type="checkbox"/> OTHER <input type="checkbox"/> SINGLE ZONE <input checked="" type="checkbox"/> MULTIPLE ZONE <input type="checkbox"/>				8. Farm or Lease Name MCINTOSH	
2. Name of Operator SHELL WESTERN E&P INC.				9. Well No. 1	
3. Address of Operator P. O. BOX 991, HOUSTON, TEXAS 77001				10. Field Pool or Wildcat SCHARB WOLFCAMP, S.E.	
4. Location of Well UNIT LETTER <u>B</u> LOCATED <u>660</u> FEET FROM THE <u>NORTH</u> LINE AND <u>1980</u> FEET FROM THE <u>EAST</u> LINE OF SEC. <u>21</u> TWP. <u>19-S</u> RGE. <u>35-E</u> NMPM				12. County LEA	
19. Proposed Depth 10,900'		19A. Formation WOLFCAMP		20. Rotary or C.T. ROTARY	
21. Elevations (Show whether DF, KI, etc.) 3782.3' GL		21A. Kind & Status Plug. Bond BLANKET		22. Approx. Date Work will start JUNE 10, 1985	

PROPOSED CASING AND CEMENT PROGRAM

SIZE OF HOLE	SIZE OF CASING	WEIGHT PER FOOT	SETTING DEPTH	SACKS OF CEMENT	EST. TOP
17-1/2"	13-3/8"	54.5#	450'	475 SX CLASS C	SURFACE
12-1/4"	8-5/8"	32, 24#	4000'	1250 LITE +625 C	SURFACE
7-7/8"	5-1/2"	15.5, 17#	10,900'	750 SX POZ	7000'

BOP PROGRAM: 3MR - 10 SRRA

Permit Expires 6 Months From Approval
Date Unless Drilling Underway.

IN ABOVE SPACE DESCRIBE PROPOSED PROGRAM; IF PROPOSAL IS TO DEEPEN OR PLUG BACK, GIVE DATA ON PRESENT PRODUCTIVE ZONE AND PROPOSED NEW PRODUCTIVE ZONE. GIVE BLOWOUT PREVENTER PROGRAM, IF ANY.

I hereby certify that the information above is true and complete to the best of my knowledge and belief.

Signed A. J. Fore A. J. FORE Title SUPERVISOR REG. & PERMITTING Date MAY 22, 1985

(This space for State Use)

APPROVED BY [Signature] TITLE [Signature] DATE MAY 28 1985

CONDITIONS OF APPROVAL, IF ANY:

NEW MEXICO OIL CONSERVATION COMMISSION
WELL LOCATION AND ACREAGE DEDICATION PLAT

Form C-102
Supersedes C-128
Effective 1-1-65

All distances must be from the outer boundaries of the Section.

Operator SHELL WESTERN E. & P., INC.			Lease McINTOSH		Well No. 1
Unit Letter B	Section 21	Township 19 SOUTH	Range 35 EAST	County LEA	
Actual Footage Location of Well: 660 feet from the NORTH line and 1980 feet from the EAST line					
Ground Level Elev. 3782.3	Producing Formation WOLFCAMP	Pool SCHARB WOLFCAMP, SOUTHEAST	Dedicated Acreage: 40 Acres		

1. Outline the acreage dedicated to the subject well by colored pencil or hachure marks on the plat below.
2. If more than one lease is dedicated to the well, outline each and identify the ownership thereof (both as to working interest and royalty).
3. If more than one lease of different ownership is dedicated to the well, have the interests of all owners been consolidated by communitization, unitization, force-pooling, etc?

☐ Yes ☐ No If answer is "yes," type of consolidation _____

If answer is "no," list the owners and tract descriptions which have actually been consolidated. (Use reverse side of this form if necessary.) _____

No allowable will be assigned to the well until all interests have been consolidated (by communitization, unitization, forced-pooling, or otherwise) or until a non-standard unit, eliminating such interests, has been approved by the Commission.

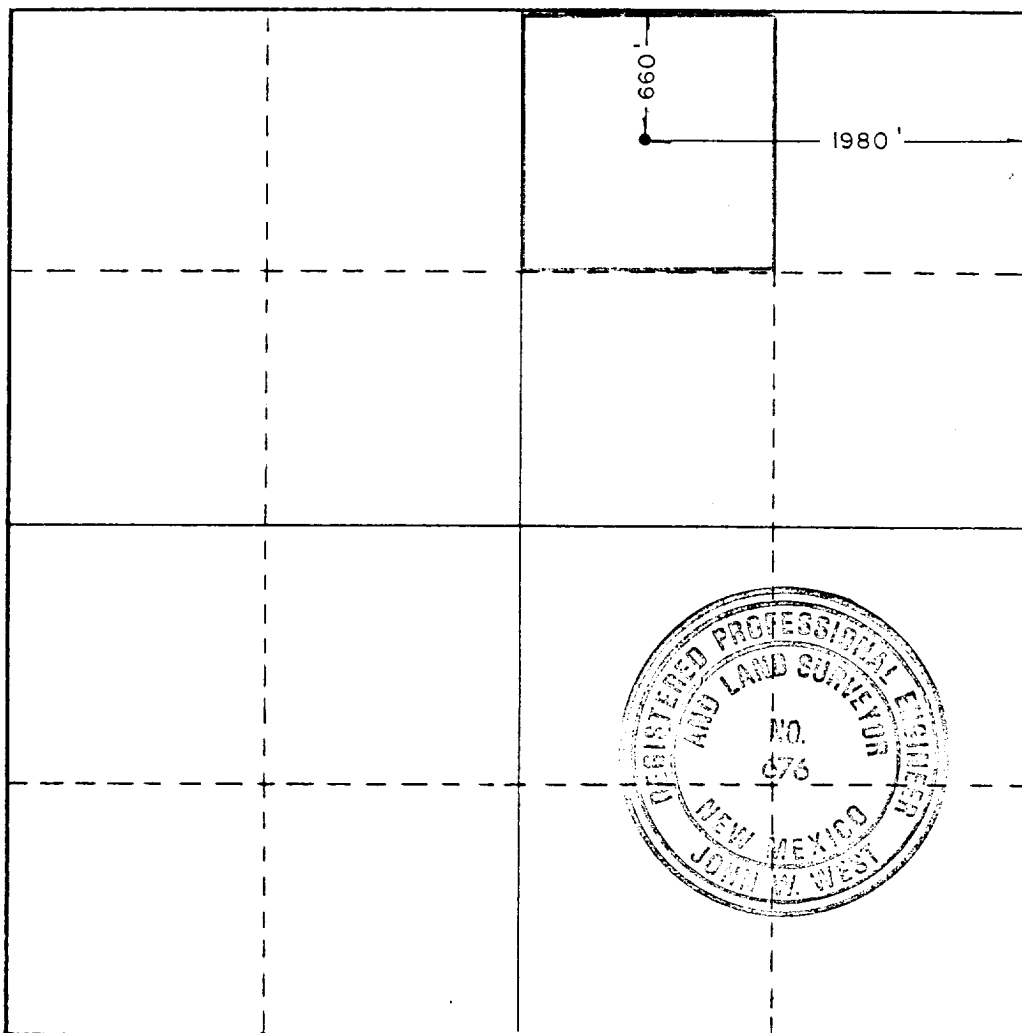

CERTIFICATION

I hereby certify that the information contained herein is true and complete to the best of my knowledge and belief.

Name
A. J. Fore A. J. FORE
Position
SUPERVISOR REG. & PERMITTING
Company
SHELL WESTERN E&P INC.
Date
MAY 22, 1985

I hereby certify that the well location shown on this plat was plotted from field notes of actual surveys made by me or under my supervision, and that the same is true and correct to the best of my knowledge and belief.

Date Surveyed
MAY 16, 1985
Registered Professional Engineer and/or Land Surveyor
John W. West

Certificate No. JOHN W. WEST, 676
RONALD J. EIDSON, 3239

[Handwritten signature]
RECEIVED
MAY 29 1985
O.C.D.
HOBBS C. 111
173