

NEW MEXICO OIL CONSERVATION COMMISSION
WELL LOCATION AND ACREAGE DEDICATION PLAT

Form O-112
Supersedes L-128
Effective 10-85

All distances must be from the outer boundaries of the Section

Lessor FOREST OIL CO.		Lease B. THE STATE		Well No. 8
Tract Letter A	Section 5	Township 19 SOUTH	Range 35 EAST	County LIN
Actual Well Location of Well: 467 feet from the NORTH line and 660 feet from the EAST line				
Ground Level Elev. 919.8'	Producing Formation WOLF CAMP	Pool SCHARB-WOLF CAMP	Estimated Acreage 40	

1. Outline the acreage dedicated to the subject well by colored pencil or hachure marks on the plat below.
2. If more than one lease is dedicated to the well, outline each and identify the ownership thereof (both as to working interest and royalty).
3. If more than one lease of different ownership is dedicated to the well, have the interests of all owners been consolidated by communitization, unitization, force-pooling, etc?

☐ Yes ☐ No If answer is "yes," type of consolidation _____

If answer is "no," list the owners and tract descriptions which have actually been consolidated (Use reverse side of this form if necessary.) _____

No allowable will be assigned to the well until all interests have been consolidated (by communitization, unitization, forced-pooling, or otherwise) or until a non-standard unit, eliminating such interests, has been approved by the Commission.

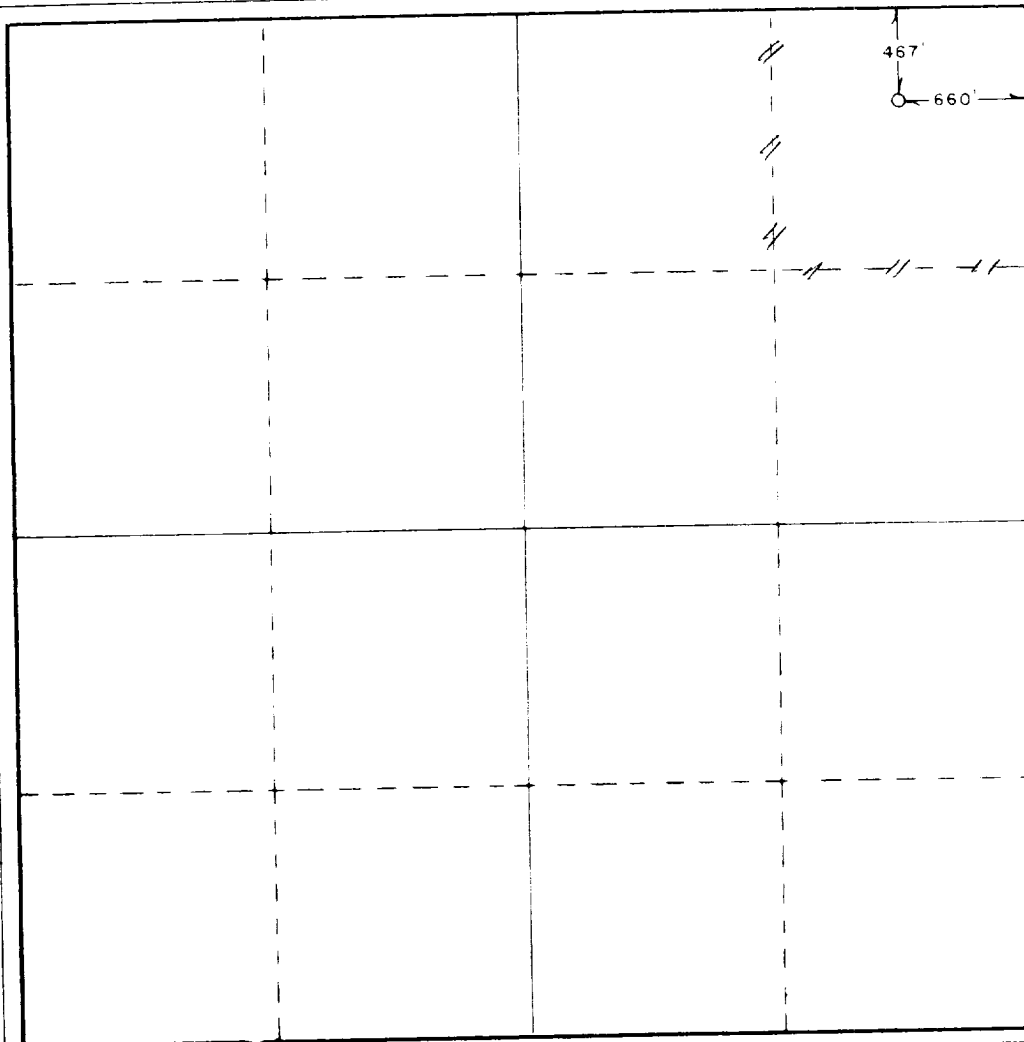

CERTIFICATION

I hereby certify that the information contained herein is true and complete to the best of my knowledge and belief

Name
RONALD L. ISACK
Profession
PETROLEUM ENGINEER
Employer
FOREST OIL CORP.
Date
7 Aug., 1985

I hereby certify that the well location shown on this plat was plotted from field notes of actual surveys made by me or under my supervision, and that the same is true and correct to the best of my knowledge and belief.

Date Surveyed
AUGUST 2, 1985

Registered Professional Engineer
and/or Land Surveyor

John W. West
Certificate No. JOHN W. WEST, 676
RONALD J. EIDSON, 3239

RECEIVED

AUG - 8 1985

11/11/85
11/11/85
11/11/85