

RECEIVED

AUG 28 1985

U.S. GOVERNMENT
HOLDS

OIL CONSERVATION DIVISION

STATE OF NEW MEXICO
ENERGY AND MINERALS DEPARTMENT

P. O. BOX 2088

SANTA FE, NEW MEXICO 87501

Form C-102
Revised 10-1-79

All distances must be from the outer boundaries of the Section.

Operator Mobil Producing Tx. & N.M. Inc.			Lease North Vacuum Abo East Unit		Well No. 20
Unit Letter <u>I</u>	Section 7	Township 17-S	Range 35-E	County Lea	
Actual Footage Location of Well:					
732 feet from the East line and		1982 feet from the South line			
Ground Level Elev. 3999	Producing Formation Abo	Pool Vacuum, North		Dedicated Acreage: <u>2 wells 80</u> Acres	

1. Outline the acreage dedicated to the subject well by colored pencil or hatchure marks on the plat below.
2. If more than one lease is dedicated to the well, outline each and identify the ownership thereof (both as to working interest and royalty).
3. If more than one lease of different ownership is dedicated to the well, have the interests of all owners been consolidated by communitization, unitization, force-pooling, etc?

☐ Yes ☐ No If answer is "yes," type of consolidation _____

If answer is "no," list the owners and tract descriptions which have actually been consolidated. (Use reverse side of this form if necessary.) _____

No allowable will be assigned to the well until all interests have been consolidated (by communitization, unitization, forced-pooling, or otherwise) or until a non-standard unit, eliminating such interests, has been approved by the Division.

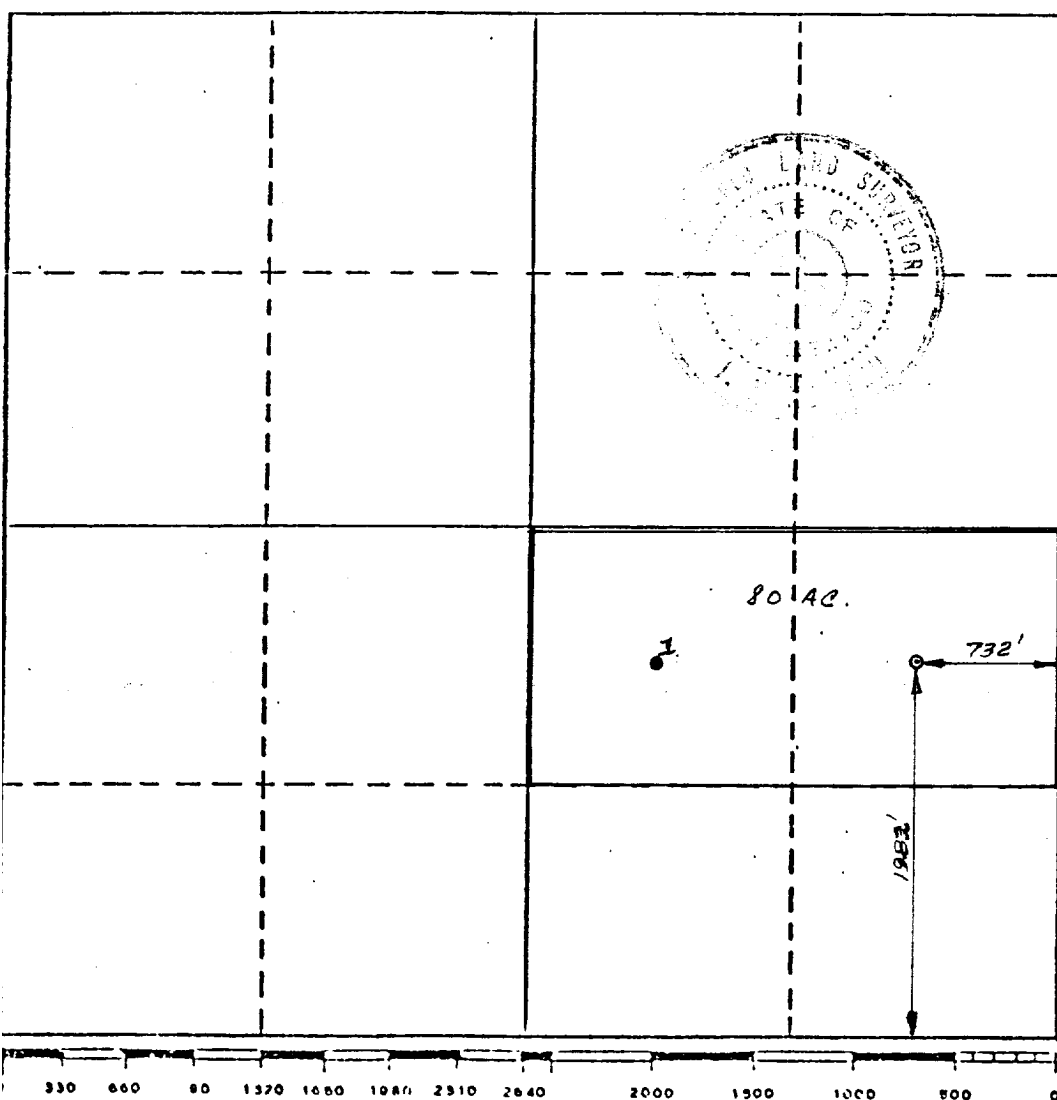

CERTIFICATION

I hereby certify that the information contained herein is true and complete to the best of my knowledge and belief.

Signature G.E. Tate
 Name G.E. Tate
 Position Env. & Reg. Mgr.
 Company Mobil Producing Tx. & N.M. Inc.
 Date August 26, 1985

I hereby certify that the well location shown on this plat was plotted from field notes of actual surveys made by me or under my supervision, and that the same is true and correct to the best of my knowledge and belief.

Date Surveyed August 8, 1985
 Registered Professional Engineer
 and/or Land Surveyor

Certificate No. 5109

RECEIVED
AUG 28 1985
HONOLULU

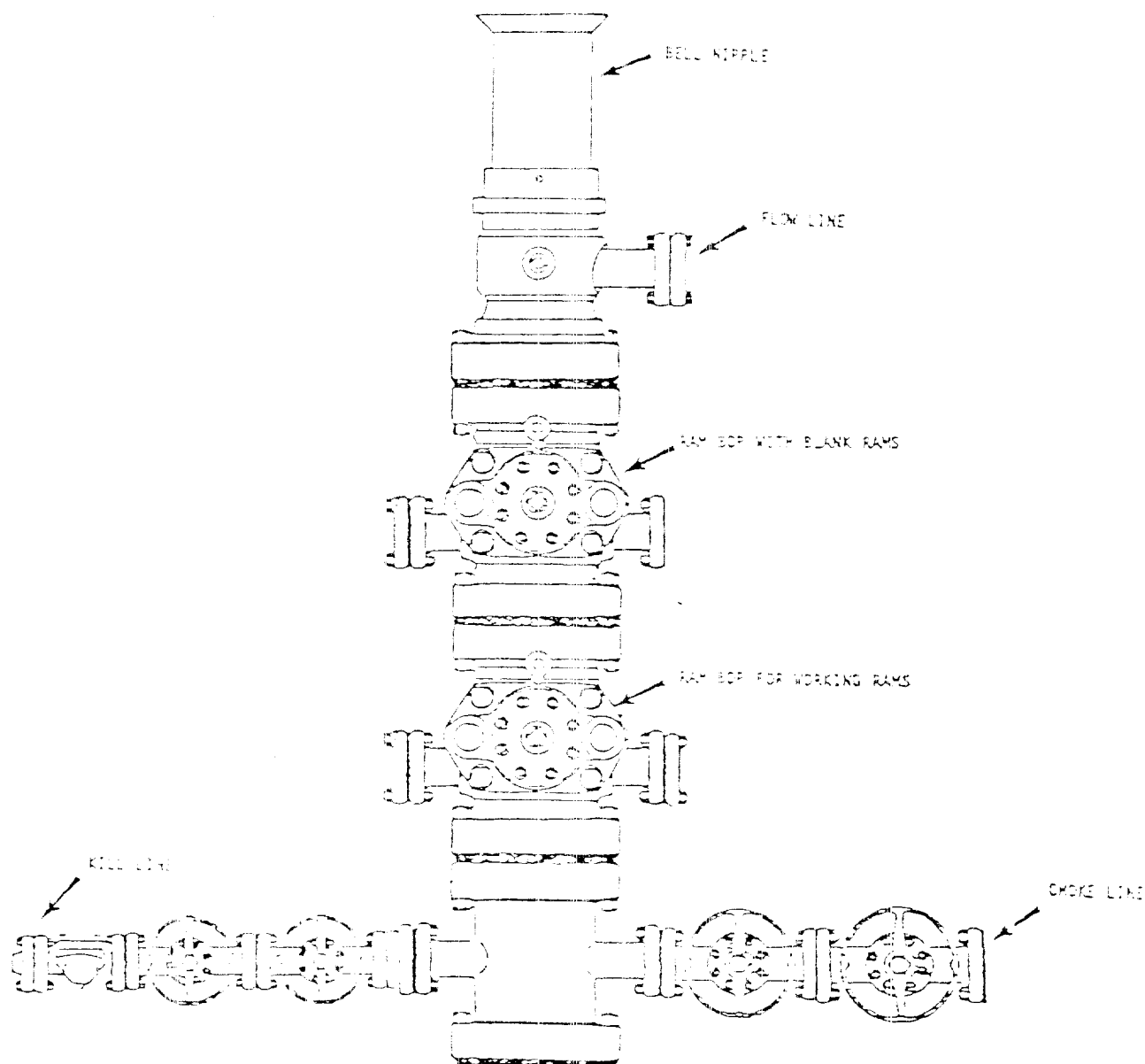

BOP rams will be actuated on each trip of drill pipe and will be tested before drilling the plug on each casing string.

NOTE: ALL VALVES ARE METAL-TO-METAL SEAL AND FLANGED. ALL COMPONENTS MUST MEET ABOVE MINIMUM PRESSURE RATINGS. ALL COMPONENTS TO BE TESTED TO RATED PRESSURE AFTER ASSEMBLY AND BEFORE FURTHER DOWNHOLE OPERATIONS MAY BE CONDUCTED.

Mobil Producing
Texas & New Mexico Inc.
Houston, Texas

WELL NO. 20 North Texas Unit
(LEASE)

Lee COUNTY, TX STATE

BLOWOUT PREVENTER ASSEMBLY

1/2" 3/4" 2000 PSI WP

Scale

Drawn
Checked
Approved
Revised

RECEIVED
AUG 28 1985
FBI
FBI CHICAGO

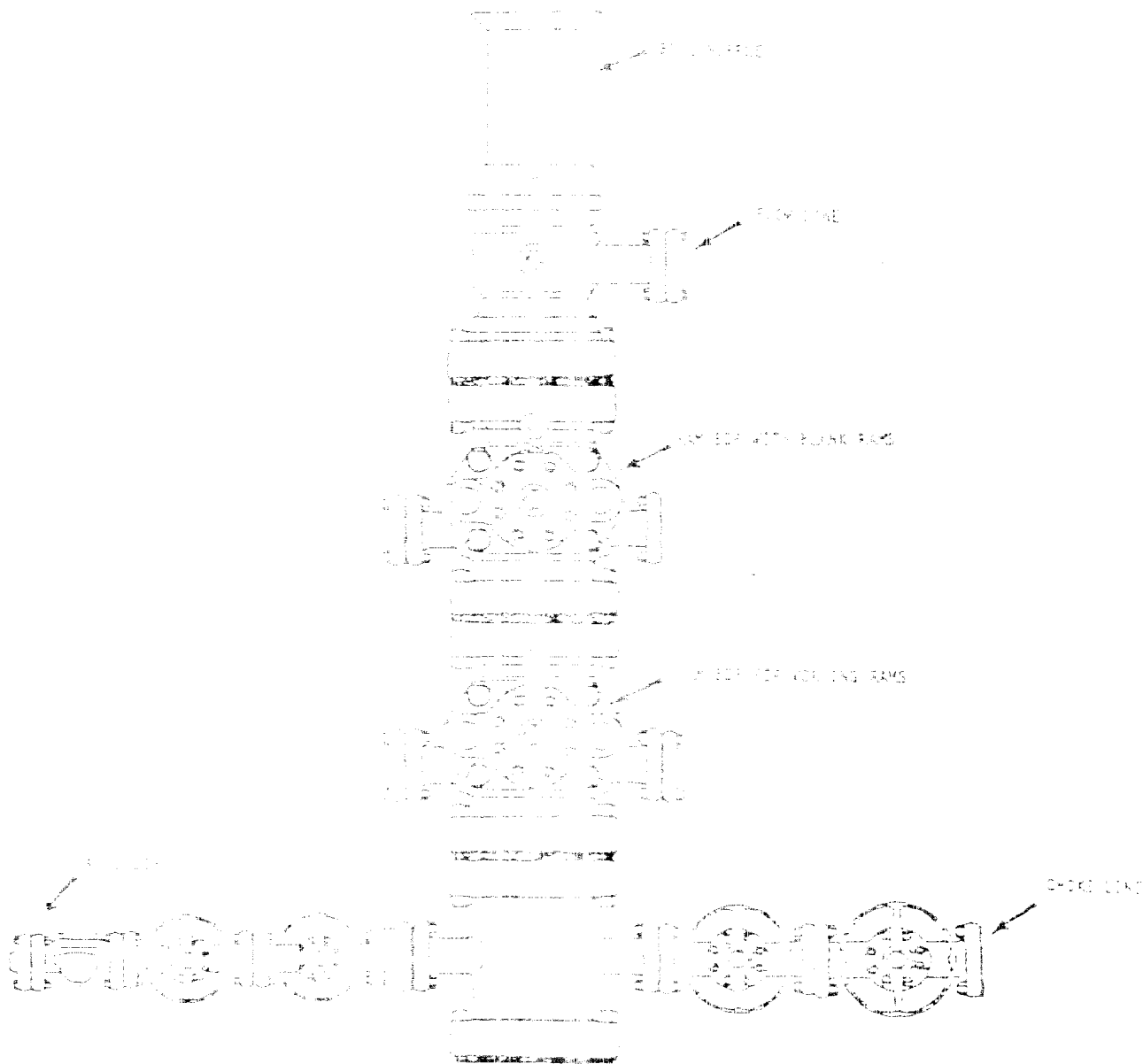

SEE DRAWING FOR DETAILS OF BOP LINE AND VALVE. BOP LINE WILL BE TESTED TO 100% OF DESIGN PRESSURE BEFORE OPERATING.

NOTE: ALL VALVES ARE METAL TO METAL SEALING. ALL COMPONENTS MUST BE TESTED TO MINIMUM DESIGN RATING. ALL COMPONENTS TO BE TESTED TO 100% PRESSURE AFTER ASSEMBLY AND BEFORE STARTING DOWNHOLE OPERATIONS. NO BE OPERATED.

Mobil Producing
Texas & New Mexico Inc.
Houston Texas

DATE: 10/10/68 (DATE)
COUNTY: HOUSTON STATE: TEXAS

BLOWOUT PREVENTER ASSEMBLY

100% TEST (5000 PSI WORK)

Scale

Date

Design

Checked

Approved

Noted

111

98-11-2

RECEIVED
AUG 28 1985
FBI
HONOLULU