

30-125-29393

NO. OF COPIES RECEIVED	
DISTRIBUTION	
SANTA FE	
FILE	
U.S.G.S.	
LAND OFFICE	
OPERATOR	

NEW MEXICO OIL CONSERVATION COMMISSION

Form C-101
Revised 1-1-65

5A. Indicate Type of Lease STATE <input checked="" type="checkbox"/> FEE <input type="checkbox"/>
5. State Oil & Gas Lease No.

APPLICATION FOR PERMIT TO DRILL, DEEPEN, OR PLUG BACK

1a. Type of Work b. Type of Well OIL WELL <input checked="" type="checkbox"/> GAS WELL <input type="checkbox"/> OTHER <input type="checkbox"/> DRILL <input checked="" type="checkbox"/> DEEPEN <input type="checkbox"/> PLUG BACK <input type="checkbox"/> SINGLE ZONE <input type="checkbox"/> MULTIPLE ZONE <input type="checkbox"/>	2. Name of Operator Mobil Producing Tx. & N.M. Inc.	7. Unit Agreement Name K-6023	8. Farm or Lease Name North Vacuum Abo East Unit
3. Address of Operator P.O. Box 633, Midland, Tx. 79702 L.L. Maroney	9. Well No. 22	10. Field and Pool, or Wildcat Vacuum North-Abo	
4. Location of Well UNIT LETTER <u>0</u> LOCATED <u>2000</u> FEET FROM THE <u>East</u> LINE AND <u>660</u> FEET FROM THE <u>South</u> LINE OF SEC. <u>18</u> TWP. <u>17S</u> RGE. <u>35E</u> NMPM			
12. County Lea			
19. Proposed Depth 9000'		19A. Formation Abo	20. Rotary or C.T. Rotary
21. Elevations (Show whether DF, RT, etc.) 3987' GR	21A. Kind & Status Plug. Bond Active Blanket	21B. Drilling Contractor Unknown	22. Approx. Date Work will start Sept. 1, 1985

PROPOSED CASING AND CEMENT PROGRAM

SIZE OF HOLE	SIZE OF CASING	WEIGHT PER FOOT	SETTING DEPTH	SACKS OF CEMENT	EST. TOP
17-1/2"	13-3/8"	48#	400'	Well Circ to Surface	
12-1/4"	8-5/8"	28 & 32#	0-5000'	Well Circ to Surface	
7-7/8"	5-1/2"	15.5 & 17#	0- TD	Well Circ to Surface	

BOP Sketch Attached

Permit Expires 1 Year From Approval
Date Unless Drilling Underway.

IN ABOVE SPACE DESCRIBE PROPOSED PROGRAM: IF PROPOSAL IS TO DEEPEN OR PLUG BACK, GIVE DATA ON PRESENT PRODUCTIVE ZONE AND PROPOSED NEW PRODUCTIVE ZONE. GIVE BLOWOUT PREVENTER PROGRAM, IF ANY.

I hereby certify that the information above is true and complete to the best of my knowledge and belief.

Signed G.E. Tate G.E. Tate Title Env. & Reg. Mgr. Date August 26, 1985

(This space for State Use)
Eddie W. Seay

APPROVED BY Oil & Gas Inspector TITLE DATE AUG 30 1985

CONDITIONS OF APPROVAL, IF ANY:

RECEIVED

AUG 28 1985

U.S. DEPT. OF JUSTICE
GENERAL INVESTIGATIVE DIVISION

OIL CONSERVATION DIVISION

STATE OF NEW MEXICO
ENERGY AND MINERALS DEPARTMENT

P. O. BOX 2088

SANTA FE, NEW MEXICO 87501

Form C-102
Revised 10-1-79

All distances must be from the outer boundaries of the Section.

Operator Mobil Producing Tx. & N.M. Inc.			Lease North Vacuum Abo East Unit		Well No. 22
Unit Letter D	Section 18	Township 17-S	Range 35-E	County Lea	
Actual Footage Location of Well: 2000 feet from the East line and 660 feet from the South line					
Ground Level Elev. 3987	Producing Formation Abo		Pool Vacuum, North		Dedicated Acreage: 2 Wells 80 Acres

1. Outline the acreage dedicated to the subject well by colored pencil or hachure marks on the plat below.
2. If more than one lease is dedicated to the well, outline each and identify the ownership thereof (both as to working interest and royalty).
3. If more than one lease of different ownership is dedicated to the well, have the interests of all owners been consolidated by communitization, unitization, force-pooling, etc?

☐ Yes ☐ No If answer is "yes," type of consolidation _____

If answer is "no," list the owners and tract descriptions which have actually been consolidated. (Use reverse side of this form if necessary.) _____

No allowable will be assigned to the well until all interests have been consolidated (by communitization, unitization, forced-pooling, or otherwise) or until a non-standard unit, eliminating such interests, has been approved by the Division.

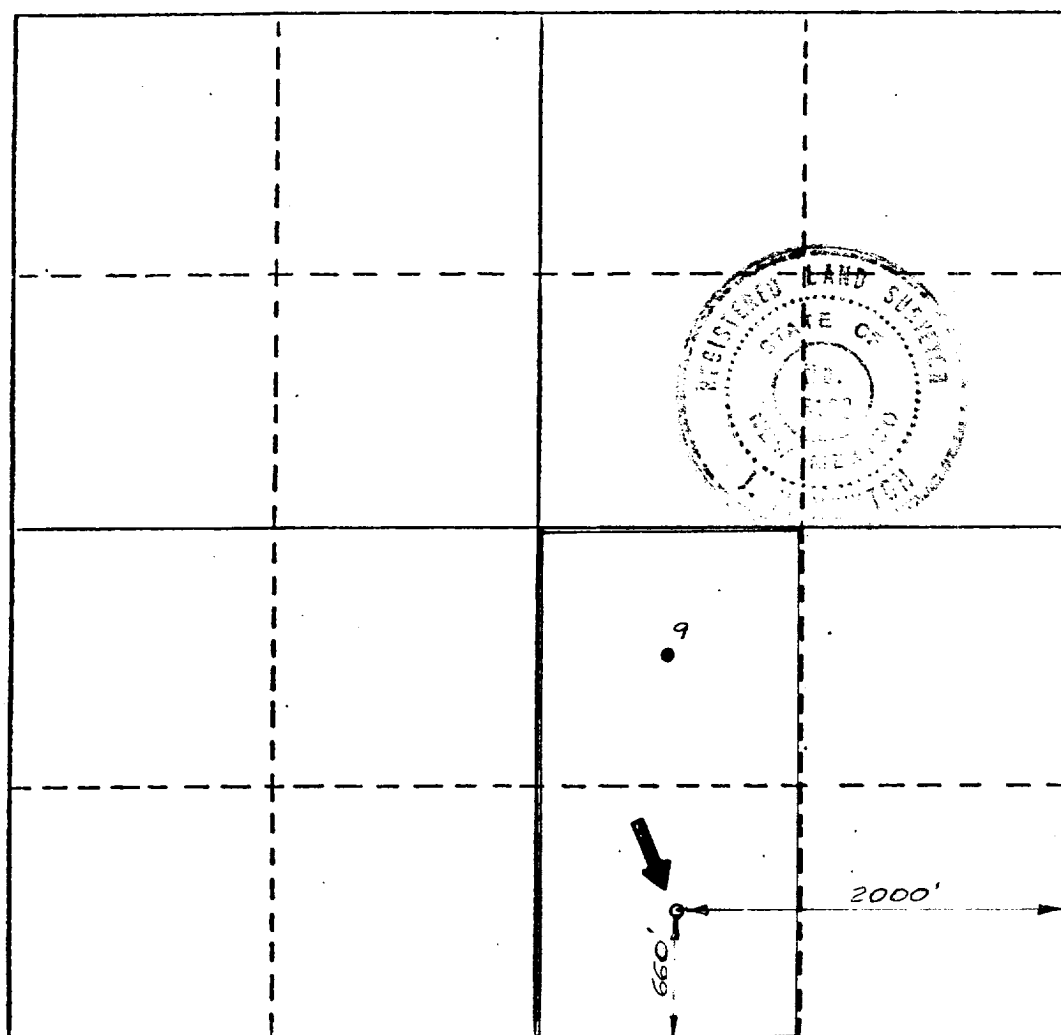

CERTIFICATION

I hereby certify that the information contained herein is true and complete to the best of my knowledge and belief.

Signature *G. E. Tate*Name
G.E. TatePosition
Env. & Reg. Mgr.Company
Mobil Producing Tx. & N.M. Inc.Date
August 26, 1985

I hereby certify that the well location shown on this plat was plotted from field notes of actual surveys made by me or under my supervision, and that the same is true and correct to the best of my knowledge and belief.

Date Surveyed
August 8, 1985Registered Professional Engineer
and/or Land Surveyor

J. A. Newton
Certificate No.
5109

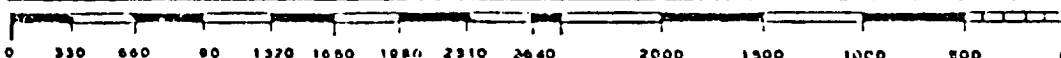

RECEIVED

AUG 28 1985

FBI
RECEIVED OFFICE

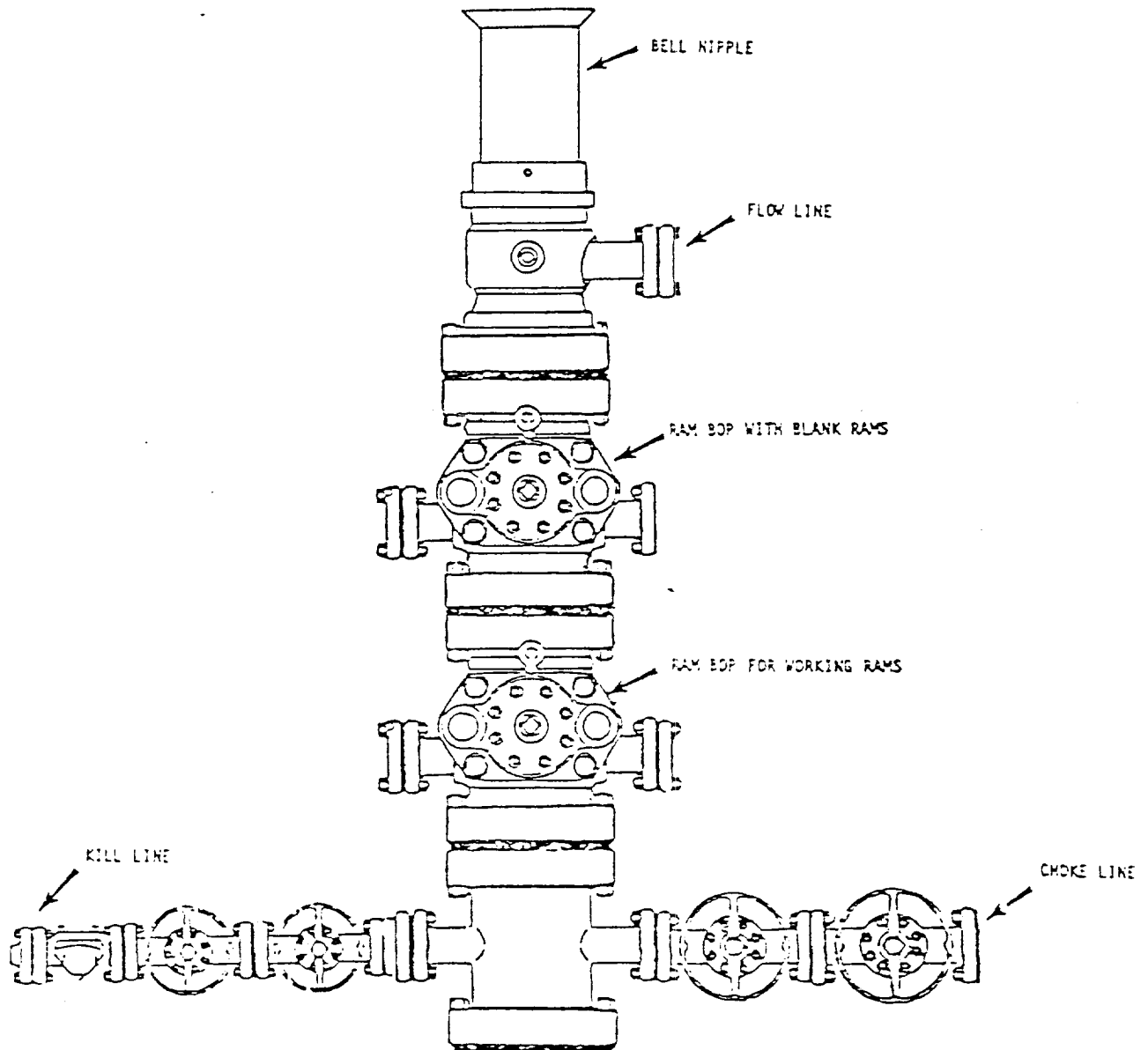

BOP rams will be actuated on each trip of drill pipe and will be tested before drilling the plug on each casing string.

Mobil Producing
Texas & New Mexico Inc.
Houston, Texas

MOBIL NO. 22 North Vanhook Unit
(LEASE)

Lea COUNTY, DM STATE

BLOWOUT PREVENTER ASSEMBLY
(13 ³/₈ IN. 3000 PSI WP)

Scale to

Date
Drawn
Checked
Approved
Reviewed

*NOTE: ALL VALVES ARE METAL-TO-METAL SEAL AND FLANGED. ALL COMPONENTS MUST MEET ABOVE MINIMUM PRESSURE RATINGS. ALL COMPONENTS TO BE TESTED TO RATED PRESSURE AFTER ASSEMBLY AND BEFORE FURTHER DOWNHOLE OPERATIONS MAY BE CONDUCTED.

RECEIVED

AUG 28 1985

U.S.
HOBBY OFFICE

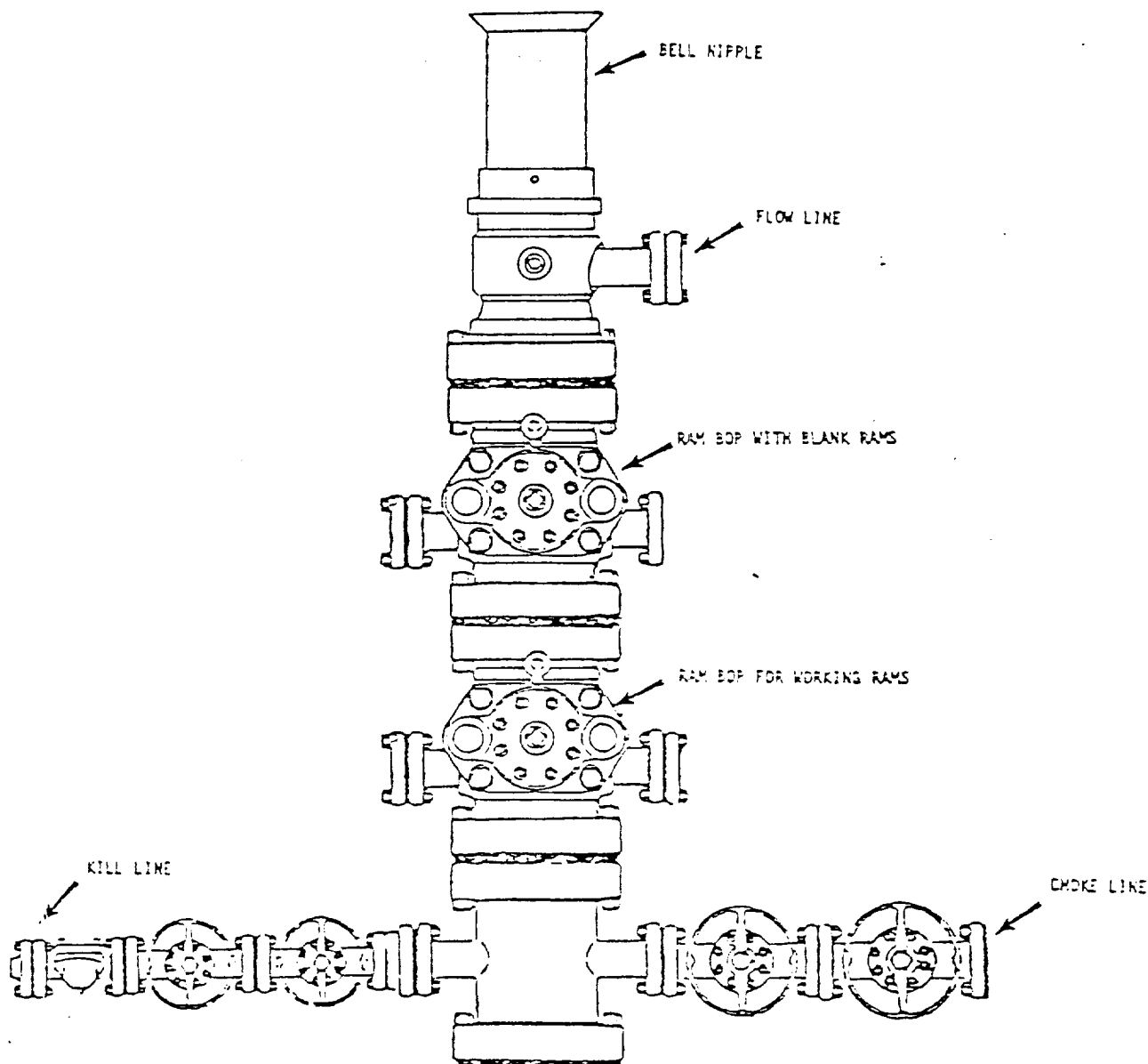

BOP rams will be actuated on each trip of drill pipe and will be tested before drilling the plug on each casing string.

*NOTE: ALL VALVES ARE METAL-TO-METAL SEAL AND FLANGED. ALL COMPONENTS MUST MEET ABOVE MINIMUM PRESSURE RATINGS. ALL COMPONENTS TO BE TESTED TO RATED PRESSURE AFTER ASSEMBLY AND BEFORE FURTHER DOWNHOLE OPERATIONS MAY BE CONDUCTED.

Mobil Producing
Texas & New Mexico Inc.
Houston, Texas

MOBIL NO. 32 North Haven, Oklahoma
(LEASE)
Lea COUNTY, Wm STATE

BLOWOUT PREVENTER ASSEMBLY
(8 5/8 IN. 5000 PSI WP*)

See to

Date
Design
Checked
Approval
Revised

173
98-11-E

RECEIVED

AUG 28 1985

U.S. DEPT. OF JUSTICE
RECORDS OFFICE