

50-025-29452

NO. OF COPIES RECEIVED	
DISTRIBUTION	
SANTA FE	
FILE	
U.S.G.S.	
LAND OFFICE	
OPERATOR	

NEW MEXICO OIL CONSERVATION COMMISSION

Form C-101
Revised 1-1-65

5A. Indicate Type of Lease	
STATE <input checked="" type="checkbox"/>	FEE <input type="checkbox"/>
5. State Oil & Gas Lease No.	
B-1520-1	

APPLICATION FOR PERMIT TO DRILL, DEEPEN, OR PLUG BACK

1a. Type of Work		7. Unit Agreement Name	
DRILL <input checked="" type="checkbox"/> DEEPEN <input type="checkbox"/> PLUG BACK <input type="checkbox"/>		North	
b. Type of Well		8. Farm or Lease Name	
OIL WELL <input checked="" type="checkbox"/> GAS WELL <input type="checkbox"/> OTHER <input type="checkbox"/>		Vacuum Abo Unit	
2. Name of Operator		9. Well No.	
Mobil Producing Texas & New Mexico Inc.		291	
3. Address of Operator		10. Field and Pool, or Wildcat	
P. O. Box 633, Midland, Texas 79702		North Vacuum Abo	
4. Location of Well		12. County	
UNIT LETTER I LOCATED 1967 FEET FROM THE South LINE		Lea	
AND 515 FEET FROM THE East LINE OF SEC. 22 TWP. 17-S RGE. 34-E NMPM			
		19. Proposed Depth	
		9,000'	
		19A. Formation	
		Abo	
		20. Rotary or C.T.	
		Rotary	
21. Elevations (Show whether DF, RT, etc.)		22. Approx. Date Work will start	
4032'		ASAP	
21A. Kind & Status Plug. Bond		21B. Drilling Contractor	
On File		Unknown	

23.

PROPOSED CASING AND CEMENT PROGRAM

SIZE OF HOLE	SIZE OF CASING	WEIGHT PER FOOT	SETTING DEPTH	SACKS OF CEMENT	EST. TOP
17-1/2"	13-3/8"	48#	400'	Circulate	to Surface
12-1/4"	8-5/8"	28# & 32#	0-5000'	Circulate	to Surface
7-7/8"	5-1/2"	15.5# & 17#	0-TD	Circulate	to Surface

Blowout Preventer Sketch Attached

Permit Expires 6 Months From Approval
Date Unless Drilling Underway.

IN ABOVE SPACE DESCRIBE PROPOSED PROGRAM: IF PROPOSAL IS TO DEEPEN OR PLUG BACK, GIVE DATA ON PRESENT PRODUCTIVE ZONE AND PROPOSED NEW PRODUCTIVE ZONE. GIVE BLOWOUT PREVENTER PROGRAM, IF ANY.

I hereby certify that the information above is true and complete to the best of my knowledge and belief.

Signed C. C. Smith / G. E. Tate Title Env. & Regulatory Manager Date 9-26-85

(This space for State Use)
ORIGINAL SIGNED BY JERRY SEXTON
DISTRICT 1 SUPERVISOR

APPROVED BY _____ TITLE _____ DATE _____

CONDITIONS OF APPROVAL, IF ANY:

OCT 2 - 1985

RECEIVED

OCT - 1 1985

C.C.D.
HOBBY OFFICE

All distances must be from the outer boundaries of the Section.

Operator Mobil Producing TX & NM Inc.		Lease North Vacuum Abo Unit		Well No. 291
Unit Letter I	Section 22	Township 17-S	Range 34-E	County Lea

Actual Footage Location of Well:

1967	feet from the South	line and 515	feet from the East	line
Ground Level Elev. 4032'	Producing Formation Abo	Pool North Vacuum Abo	Dedicated Acreage: (2 Wells) 80 Acres	

1. Outline the acreage dedicated to the subject well by colored pencil or hachure marks on the plat below.
2. If more than one lease is dedicated to the well, outline each and identify the ownership thereof (both as to working interest and royalty).
3. If more than one lease of different ownership is dedicated to the well, have the interests of all owners been consolidated by communitization, unitization, force-pooling, etc?

☒ Yes ☐ No If answer is "yes," type of consolidation Unitized

If answer is "no," list the owners and tract descriptions which have actually been consolidated. (Use reverse side of this form if necessary.) _____

No allowable will be assigned to the well until all interests have been consolidated (by communitization, unitization, forced-pooling, or otherwise) or until a non-standard unit, eliminating such interests, has been approved by the Division.

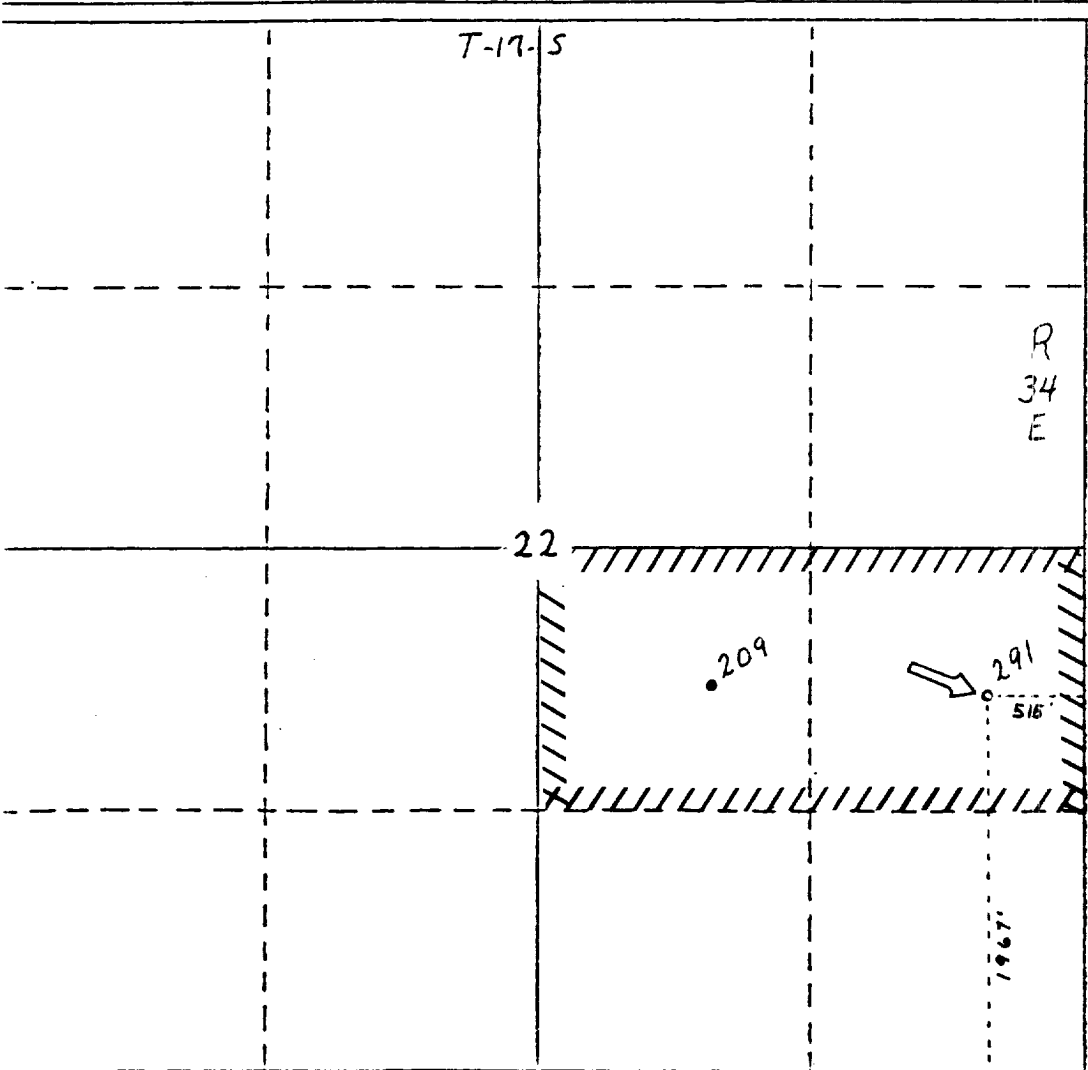

CERTIFICATION

I hereby certify that the information contained herein is true and complete to the best of my knowledge and belief.

C.C. Smith
Name
G. E. Tate
Position
Env. & Regulatory Manager
Company
Mobil Producing TX & NM Inc.
Date
September 23, 1985

REGISTERED LAND SURVEYOR
NO. 5063
NEW MEXICO
H. A. CARSON, JR.

H. A. Carson Jr.
Date Surveyed
9-16-85
Registered Professional Engineer
and/or Land Surveyor

Certificate No.
5063

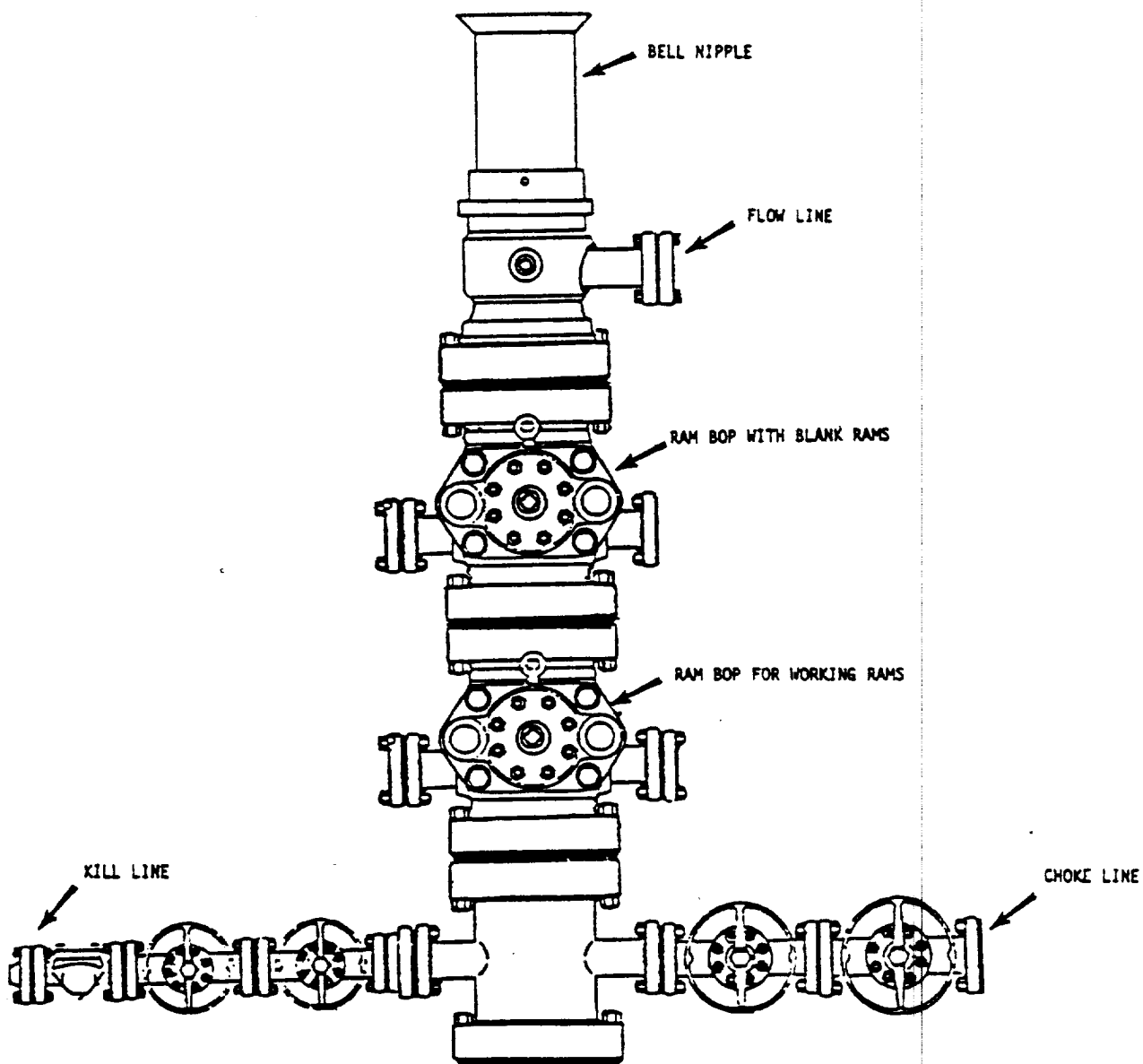

*NOTE: ALL VALVES ARE METAL-TO-METAL SEAL AND FLANGED. ALL COMPONENTS MUST MEET ABOVE MINIMUM PRESSURE RATINGS. ALL COMPONENTS TO BE TESTED TO RATED PRESSURE AFTER ASSEMBLY AND BEFORE FURTHER DOWNHOLE OPERATIONS MAY BE CONDUCTED.

Mobil Producing Texas & New Mexico Inc.

MOBIL NO. 291 NORTH Vacuum Abo
(LEASE)
Lea COUNTY, NEW MEXICO STATE

BLOWOUT PREVENTER ASSEMBLY

11 IN. 5000 PSI WPS)

Scale

Date
Drawn
Checked
Approved
Revised

RECEIVED
OCT - 1 1985
O.C.D.
HOBB'S OFFICE

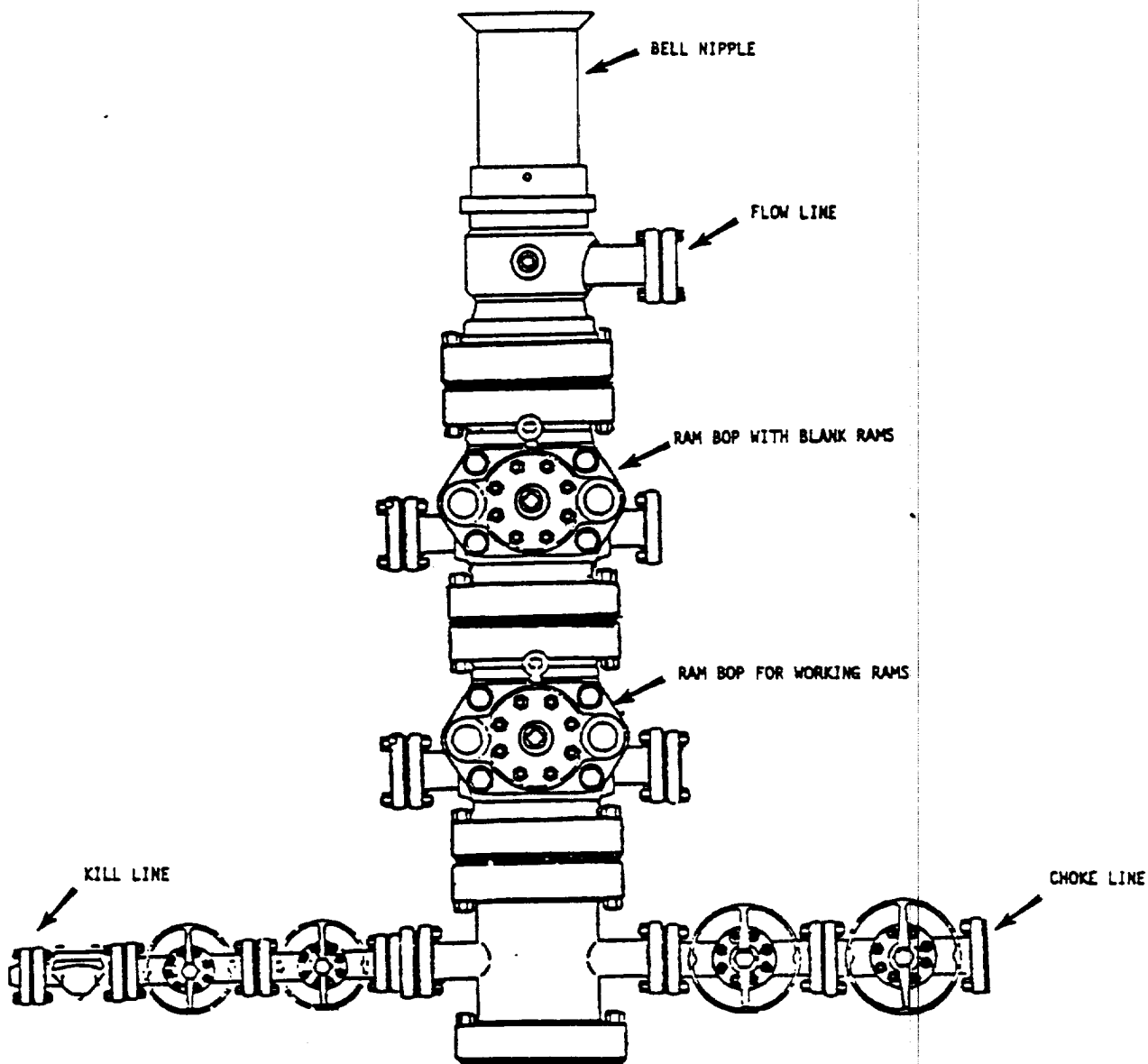

*NOTE: ALL VALVES ARE METAL-TO-METAL SEAL AND FLANGED. ALL COMPONENTS MUST MEET ABOVE MINIMUM PRESSURE RATINGS. ALL COMPONENTS TO BE TESTED TO RATED PRESSURE AFTER ASSEMBLY AND BEFORE FURTHER DOWNHOLE OPERATIONS MAY BE CONDUCTED.

Mobil Producing Texas & New Mexico Inc.

MOBIL NO. 291 North Vacuum Ass
(LEASE),
Lea COUNTY, New Mexico STATE

BLOWOUT PREVENTER ASSEMBLY
(15 5/8 IN. 3000 PSI WP*)

Scale

Date
Drawn
Checked
Approved
Revised

111

RECEIVED
OCT - 1 1985
O.C.D.
HOBS OFFICE