

NEW MEXICO OIL CONSERVATION COMMISSION  
WELL LOCATION AND ACREAGE DEDICATION PLAT

Form C-102  
Supersedes C-128  
Effective 1-1-65

All distances must be from the outer boundary of the Section

Lessee <b>Manzano Oil Corporation</b>			Lease <b>Sunburst Shogrin Federal</b>		Well No. <b>1</b>
Section <b>J</b>	Section <b>22</b>	Township <b>19 South</b>	Range <b>34 East</b>	County <b>Lea</b>	
Field Location of Well:					
1860 feet from the South line of		1980 feet from the East line of		Elev.	
Producing Formation <b>Bone Spring</b>		Pool <b>Lea Bone Spring</b>		Dedicated Acreage <b>80</b>	
Road Level Elev. <b>3768</b>					

- Outline the acreage dedicated to the subject well by colored pencil or hatchure marks on the plat below.
- If more than one lease is dedicated to the well, outline each and identify the ownership thereof (both as to working interest and royalty).
- If more than one lease of different ownership is dedicated to the well, have the interests of all owners been consolidated by communization, unitization, force-pooling, etc?

☐ Yes ☐ No If answer is "yes," type of consolidation \_\_\_\_\_

If answer is "no," list the owners and tract descriptions which have actually been consolidated. (Use reverse side of this form if necessary.) \_\_\_\_\_

No allowable will be assigned to the well until all interests have been consolidated (by communization, unitization, forced-pooling, or otherwise) or until a non-standard unit, eliminating such interests, has been approved by the Commission.

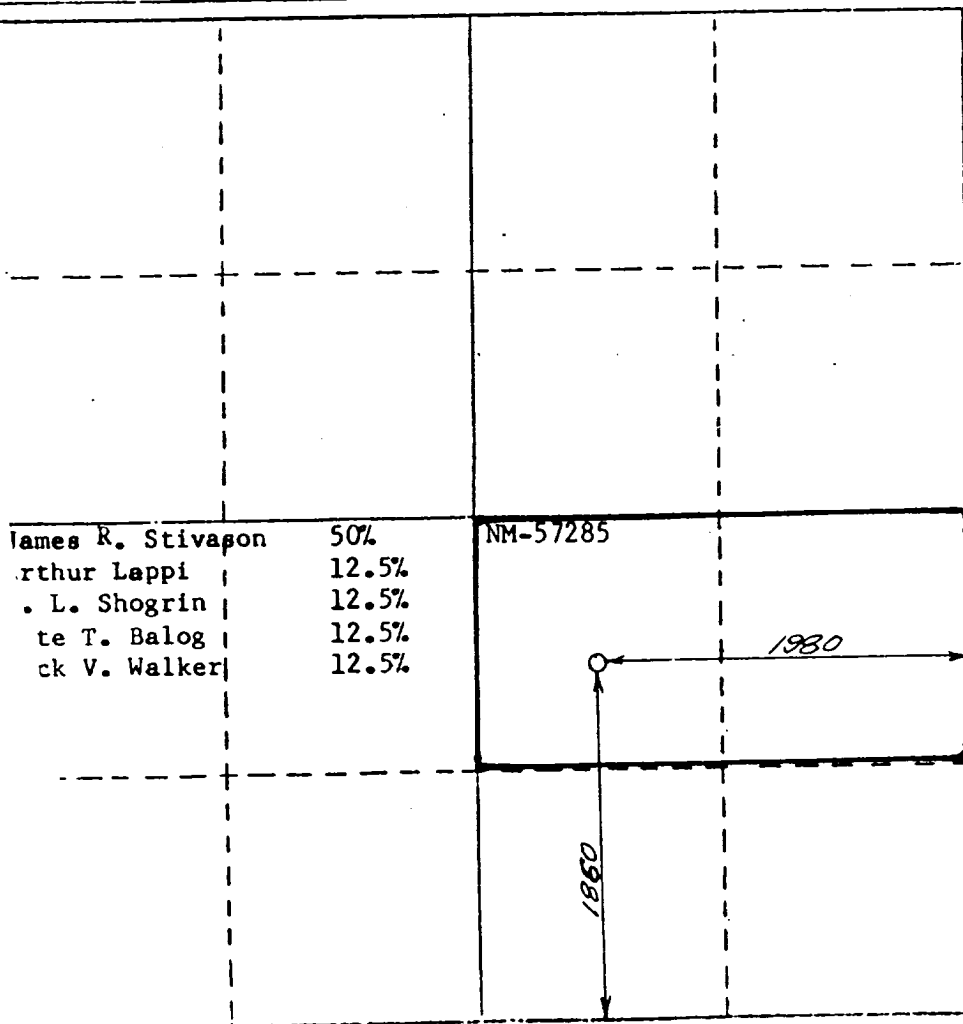

CERTIFICATION

I hereby certify that the information contained herein is true and complete to the best of my knowledge and belief.

Name  
**Jackie Midkiff**  
Position  
**Production Clerk**  
Company  
**Manzano Oil Corporation**  
Date  
**November 27, 1985**

I hereby certify that the well location shown on this plat was plotted from field notes of actual surveys made by me or under my supervision, and that the same is true and correct to the best of my knowledge and belief.

November 6, 1985

Date Surveyed

P. R. Patton

Registered Professional Land Surveyor and/or Land Surveyor

8112

Certificate No.

