

NEW MEXICO OIL CONSERVATION COMMISSION
WELL LOCATION AND ACREAGE DEDICATION PLAT

Form C-100
Supersedes C-128
Effective 1-1-65

All distances must be from the outer boundaries of the Section

Operator Manzano Oil Corporation			Lease Sunburst Shogrin Federal		Well No. 1
Unit Letter J	Section 22	Township 19 South	Range 34 East	County Lea	
Actual Entrance Location of Well:					
1860 feet from the South		1980 feet from the East			
Ground Level Elev. 3768	Producing Formation Wolfcamp	Pool Wildcat	Dedicated Acreage 80		

1. Outline the acreage dedicated to the subject well by colored pencil or hatchure marks on the plat below.
2. If more than one lease is dedicated to the well, outline each and identify the ownership thereof (both as to working interest and royalty).
3. If more than one lease of different ownership is dedicated to the well, have the interests of all owners been consolidated by communitization, unitization, force-pooling, etc?

☐ Yes ☐ No If answer is "yes," type of consolidation _____

If answer is "no," list the owners and tract descriptions which have actually been consolidated. (Use reverse side of this form if necessary.) _____

No allowable will be assigned to the well until all interests have been consolidated (by communitization, unitization, forced-pooling, or otherwise) or until a non-standard unit, eliminating such interests, has been approved by the Commission.

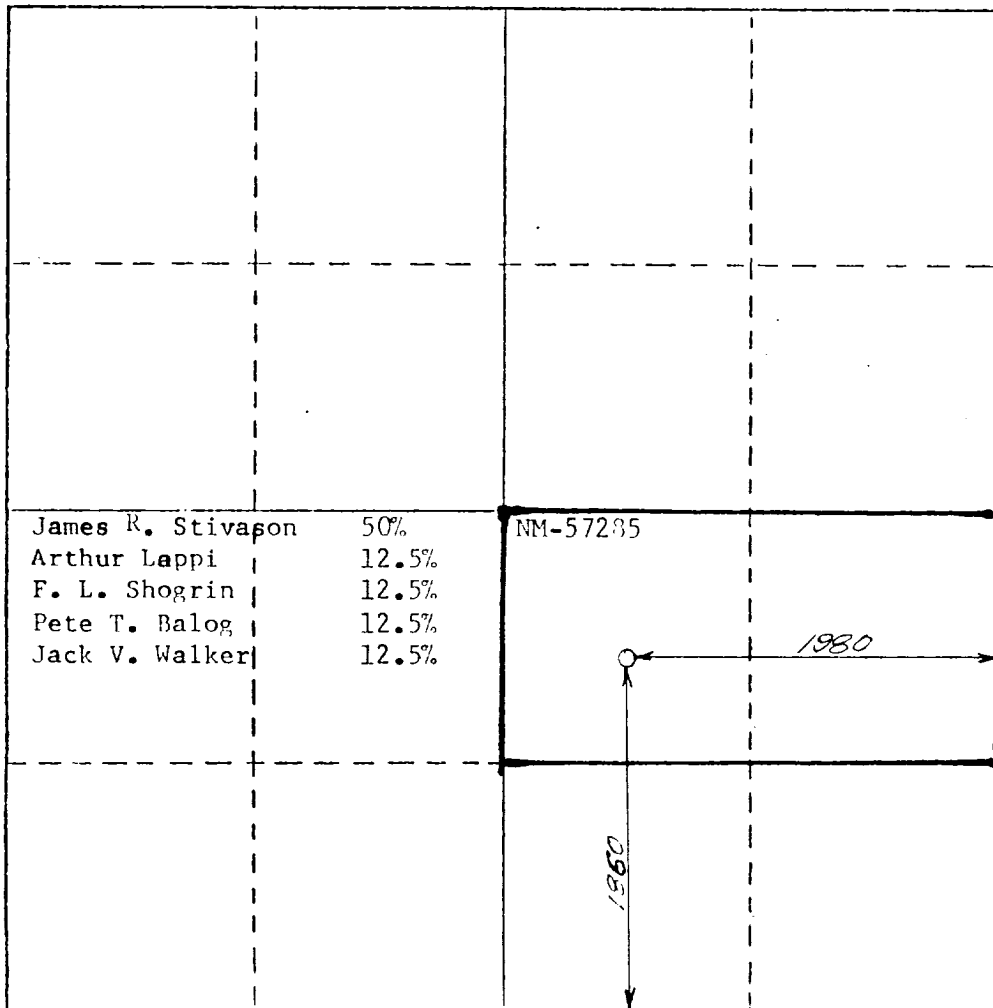

CERTIFICATION

I hereby certify that the information contained herein is true and complete to the best of my knowledge and belief.

George R. Smith

Name

George R. Smith

Position

Agent for:

Company

Manzano Oil Corporation

Date

November 27, 1985

I hereby certify that the well location shown on this plat was plotted from field notes of actual surveys made by me or under my supervision, and that the same is true and correct to the best of my knowledge and belief.

November 6, 1985

Date Surveyed

P. R. Patton

Registered Professional Land Surveyor and/or Land Engineer

8112

Certificate No.

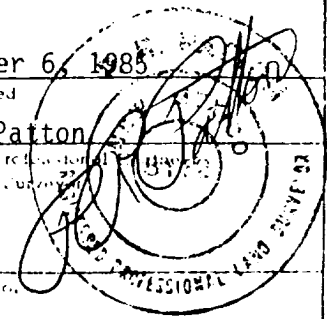

[]

RECEIVED
DEC 12 1935
U.S. CUSTOMS
HONOLULU ICE