

District I
PO Box 1980, Hobbs, NM 88241-1980
District II
PO Drawer DD, Artesia, NM 88211-0719
District III
1000 Rio Brazos Rd., Aztec, NM 87410
District IV
PO Box 2088, Santa Fe, NM 87504-2088

State of New Mexico
Energy, Minerals & Natural Resources Department

OIL CONSERVATION DIVISION
PO Box 2088
Santa Fe, NM 87504-2088

Form C-101
Revised February 10, 1994
Instructions on back
Submit to Appropriate District Office
State Lease - 6 Copies
Fee Lease - 5 Copies

☐ AMENDED REPORT

APPLICATION FOR PERMIT TO DRILL, RE-ENTER, DEEPEN, PLUGBACK, OR ADD A ZONE

Operator Name and Address: Chesapeake Operating, Inc. P. O. Box 18496, Oklahoma City, OK 73154-0496		OGRID Number 147179
		API Number 30-025-29636
Property Code 25417	Property Name OXY R-15	Well No. 1

Surface Location

UL or lot no.	Section	Township	Range	Lot Ida	Feet from the	North/South line	Feet from the	East/West line	County
L	15	17S	37E		1986	South	661	West	Lea

Proposed Bottom Hole Location If Different From Surface

UL or lot no.	Section	Township	Range	Lot Ida	Feet from the	North/South line	Feet from the	East/West line	County
L	15	17S	37E		2178	South	935	West	Lea

Proposed Pool 1 Humble City Strawn	Proposed Pool 2
---------------------------------------	-----------------

Work Type Code E	Well Type Code O	Cable/Rotary R	Lease Type Code P	Ground Level Elevation 3749'
Multiple No	Proposed Depth 11,530'	Formation Strawn	Contractor Patterson	Spud Date 03/15/99

Proposed Casing and Cement Program

Hole Size	Casing Size	Casing weight/foot	Setting Depth	Sacks of Cement	Estimated TOC
17-1/2"	13-3/8"	54.5 & 61#	406'	400	Surf
11"	8-5/8"	24 & 32#	4500'	2150	
7-7/8"	5-1/2"	17#	11,530'	1500	4000'

Describe the proposed program. If this application is to DEEPEN or PLUG BACK give the data on the present productive zone and proposed new productive zone. Describe the blowout prevention program, if any. Use additional sheets if necessary.

Chesapeake Operating, Inc. proposes to re-enter the well & drill to 11,530 TD in the Strawn formation with Patterson as the drilling contractor.

Patterson's BOP stack consists of 11" 5M# blind rams, pipe rams & annular

Permit Expires 1 Year From Approval
1 Year From Drilling Underway

Re-entry

OIL CONSERVATION DIVISION

I hereby certify that the information given above is true and complete to the best of my knowledge and belief. Signature: <u>Barbara J. Bale</u>		Approved by: _____	
Printed name: <u>Barbara J. Bale</u>		Title: _____	
Title: <u>Regulatory Analyst</u>		Approval Date: <u>MAR 09 2000</u> Expiration Date: _____	
Date: <u>03-02-2000</u>	Phone: <u>(405)848-8000</u>	Conditions of Approval: Attached <input type="checkbox"/>	

C-101 Instructions

Measurements and dimensions are to be in feet/inches. Well locations will refer to the New Mexico Principal Meridian.

IF THIS IS AN AMENDED REPORT CHECK THE BOX LABELED "AMENDED REPORT" AT THE TOP OF THIS DOCUMENT.

- 1 Operator's OGRID number. If you do not have one it will be assigned and filled in by the District office.
- 2 Operator's name and address
- 3 API number of this well. If this is a new drill the OCD will assign the number and fill this in.
- 4 Property code. If this is a new property the OCD will assign the number and fill it in.
- 5 Property name that used to be called 'well name'
- 6 The number of this well on the property.
- 7 The surveyed location of this well New Mexico Principal Meridian NOTE: If the United States government survey designates a Lot Number for this location use that number in the 'UL or lot no.' box. Otherwise use the OCD Unit Letter.
- 8 The proposed bottom hole location of this well at TD
- 9 and 10 The proposed pool(s) to which this well is being drilled.
- 11 Work type code from the following table:

N	New well
E	Re-entry
D	Drill deeper
P	Plugback
A	Add a zone
- 12 Well type code from the following table:

O	Single oil completion
G	Single gas completion
M	Multiple completion
I	Injection well
S	SWD well
W	Water supply well
C	Carbon dioxide well
- 13 Cable or rotary drilling code

C	Propose to cable tool drill
R	Propose to rotary drill
- 14 Lease type code from the following table:

F	Federal
S	State
P	Private
N	Navajo
J	Jicarilla
U	Ute
I	Other Indian tribe
- 15 Ground level elevation above sea level
- 16 Intend to multiple complete? Yes or No
- 17 Proposed total depth of this well
- 18 Geologic formation at TD
- 19 Name of the intended drilling company if known.
- 20 Anticipated spud date.
- 21 Proposed hole size ID inches, proposed casing OD inches casing weight in pounds per foot, setting depth of the casing or depth and top of liner, proposed cementing volume, and estimated top of cement
- 22 Brief description of the proposed drilling program and SOG program. Attach additional sheets if necessary.
- 23 The signature, printed name, and title of the person authorized to make this report. The date this report was signed and the telephone number to call for questions about this report.

Received
by the
OCD

DISTRICT I
P.O. Box 1980, Hobbs, NM 88241-1980

State of New Mexico
Energy, Minerals and Natural Resources Department

Form C-102
Revised February 10, 1994
Submit to Appropriate District Office
State Lease - 4 Copies
Fee Lease - 3 Copies

DISTRICT II
P.O. Drawer DD, Artesia, NM 88211-0719

DISTRICT III
1000 Rio Brazos Rd., Aztec, NM 87410

DISTRICT IV
P.O. Box 2088, Santa Fe, N.M. 87504-2088

OIL CONSERVATION DIVISION

P.O. Box 2088
Santa Fe, New Mexico 87504-2088

☐ AMENDED REPORT

WELL LOCATION AND ACREAGE DEDICATION PLAT

API Number 30-025-29636	Pool Code 3490	Pool Name Humble City Strawn
Property Code 25417	Property Name OXY R-15	Well Number 1
OGRID No. 147179	Operator Name CHESAPEAKE OPERATING, INC.	Elevation 3749'

Surface Location

UL or lot No. L	Section 15	Township 17 S	Range 37 E	Lot Idn	Feet from the 1986	North/South line SOUTH	Feet from the 66'	East/West line WEST	County LEA
--------------------	---------------	------------------	---------------	---------	-----------------------	---------------------------	----------------------	------------------------	---------------

Bottom Hole Location If Different From Surface

UL or lot No. L	Section 15	Township 17 S	Range 37 E	Lot Idn	Feet from the 2178	North/South line SOUTH	Feet from the 935	East/West line WEST	County LEA
--------------------	---------------	------------------	---------------	---------	-----------------------	---------------------------	----------------------	------------------------	---------------

Dedicated Acres 80	Joint or Infill	Consolidation Code	Order No.
-----------------------	-----------------	--------------------	-----------

NO ALLOWABLE WILL BE ASSIGNED TO THIS COMPLETION UNTIL ALL INTERESTS HAVE BEEN CONSOLIDATED
OR A NON-STANDARD UNIT HAS BEEN APPROVED BY THE DIVISION

				OPERATOR CERTIFICATION I hereby certify the the information contained herein is true and complete to the best of my knowledge and belief. <u>Barbara J. Bale</u> Signature Barbara J. Bale Printed Name Regulatory Analyst Title 03/02/2000 Date	
SURVEYOR CERTIFICATION I hereby certify that the well location shown on this plat was plotted from field notes of actual surveys made by me or under my supervision, and that the same is true and correct to the best of my belief. JANUARY 18, 1999 Date Surveyed Signature & Seal of Professional Surveyor <u>Ronald J. Eidson</u> 1/19/99 99-11-0034 Certificate No. RONALD J. EIDSON 3039 GARY EIDSON 12641					



LOCATION VERIFICATION MAP

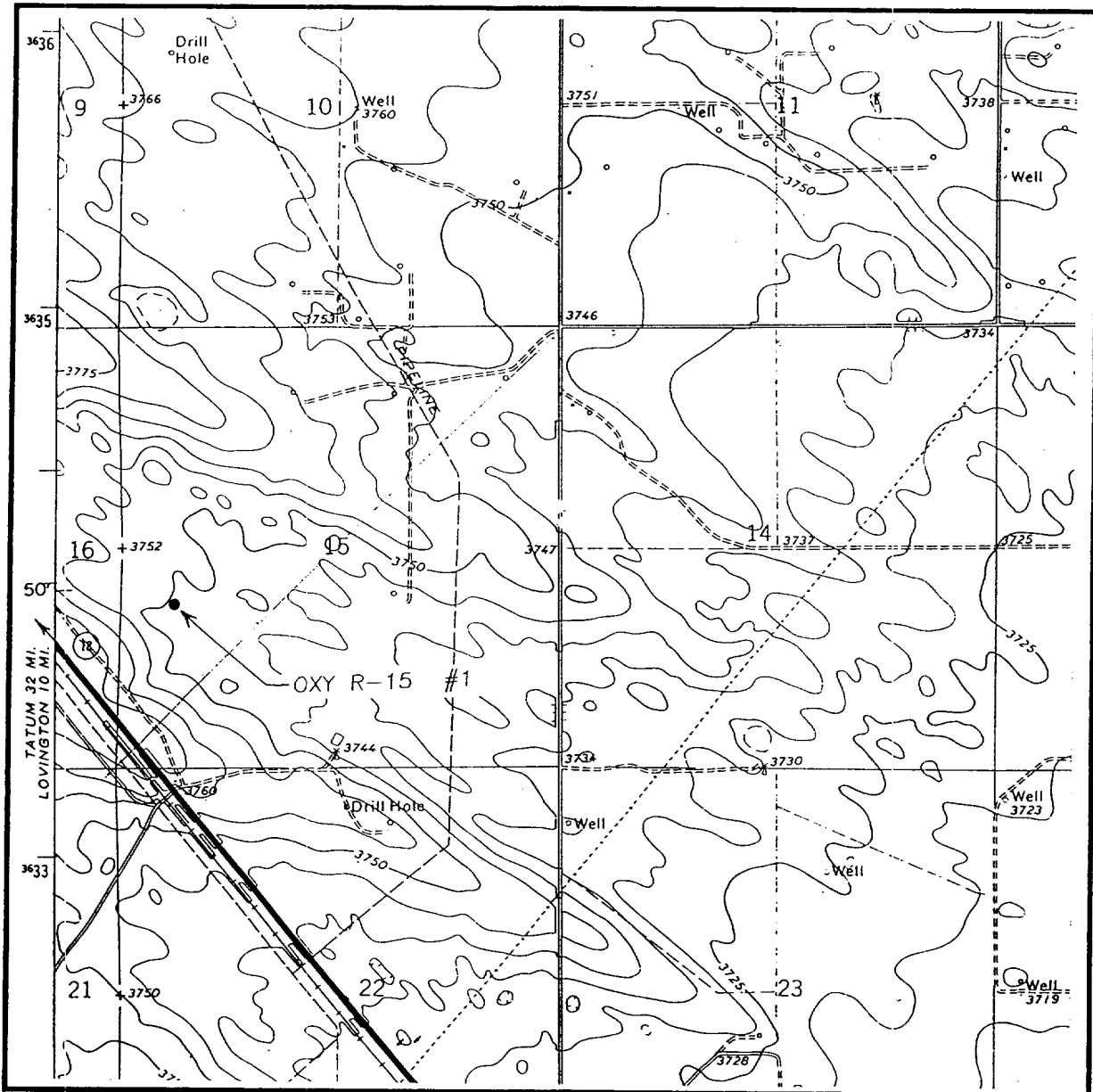



VICINITY MAP

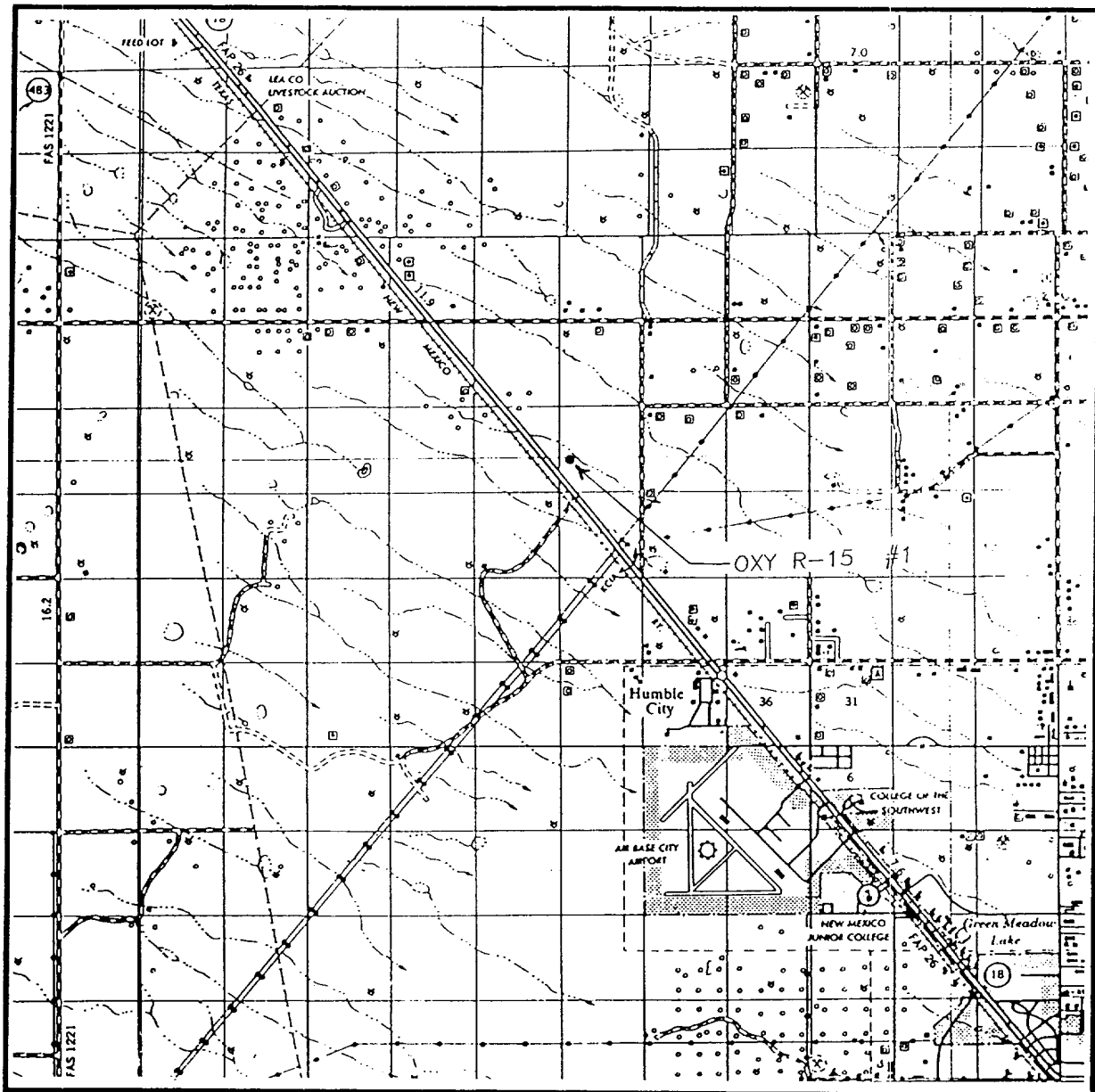

SCALE: 1" = 2 MILES

SEC. 15 TWP. 17-S RGE. 37-E

SURVEY N.M.P.M.

COUNTY LEA

DESCRIPTION 1986' FSL & 661' FWL

ELEVATION 3749'

OPERATOR CHESAPEAKE OPERATING, INC.

LEASE OXY R-15

JOHN WEST SURVEYING CO.
HOBBS, NEW MEXICO
(505) 393-3117



BLOWOUT PREVENTOR SCHEMATIC

CHESAPEAKE OPERATING INC

WELL : OXY 1R-15

FIELD : LOVINGTON PROJECT AREA

RIG : PATTERSON #48

COUNTY : LEA STATE : NEW MEXICO

OPERATION: DRILLING OUT BELOW 9 5/8" CASING

	SIZE	PRESSURE	DESCRIPTION
A	13"		Bell Nipple
B	11"	5,000#	Annular
C	11"	5,000#	4-1/2" Pipe Rams
D	11"	5,000#	Blind Rams
E	11"	5,000#	Drilling Spool
G	11" 5M X 11" 3M Spool 14" tall		
H	11"	3,000#	Bradenhead

Test Schedule	
WP	All Components
70% WP	Annular
	Prior to Drilling Out
	Function Test Every Trip

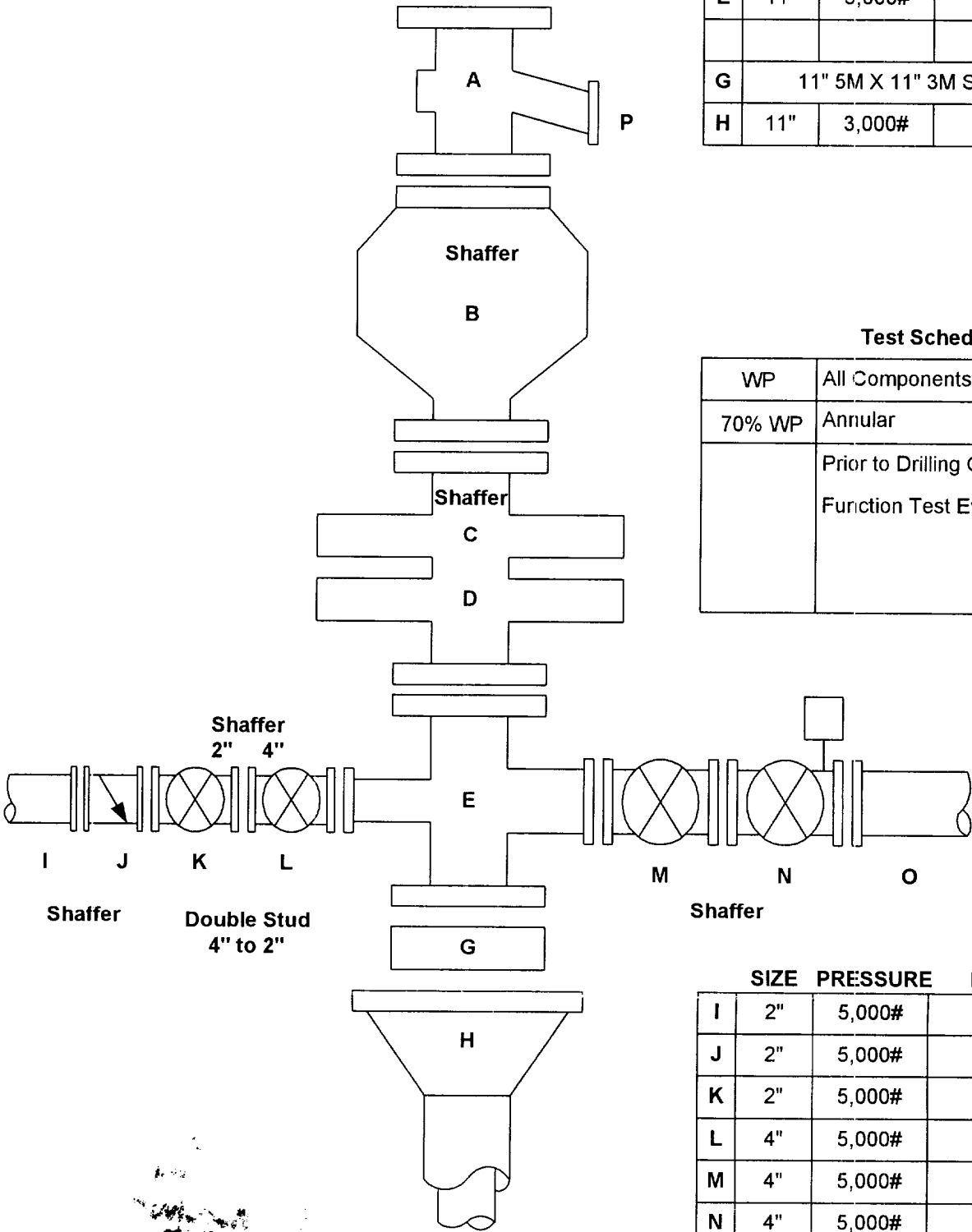

	SIZE	PRESSURE	DESCRIPTION
I	2"	5,000#	Kill Line
J	2"	5,000#	Check Valve
K	2"	5,000#	Gate Valve
L	4"	5,000#	Gate Valve
M	4"	5,000#	Gate Valve
N	4"	5,000#	Gate Valve
O	4"	5,000#	Choke Line
P	12"		Flow Line

