

All distances must be from the outer boundaries of the Section.

Operator Mobil Producing TX. & N.M. Inc.			Lease Lovington Deep Amoco State		Well No. 1
Unit Letter E	Section 6	Township 17-S	Range 36-E	County Lea	
Actual Footage Location of Well: 1980 feet from the North line and 660 feet from the West line					
Ground Level Elev. 3927'	Producing Formation Upper Pennsylvanian		Pool South Shoe Bar		Dedicated Acreage 80 Acres

1. Outline the acreage dedicated to the subject well by colored pencil or hatchure marks on the plat below.
2. If more than one lease is dedicated to the well, outline each and identify the ownership thereof (both as to working interest and royalty).
3. If more than one lease of different ownership is dedicated to the well, have the interests of all owners been consolidated by communitization, unitization, force-pooling, etc?

☐ Yes ☐ No If answer is "yes," type of consolidation \_\_\_\_\_

If answer is "no," list the owners and tract descriptions which have actually been consolidated. (Use reverse side of this form if necessary.) \_\_\_\_\_

No allowable will be assigned to the well until all interests have been consolidated (by communitization, unitization, forced-pooling, or otherwise) or until a non-standard unit, eliminating such interests, has been approved by the Division.

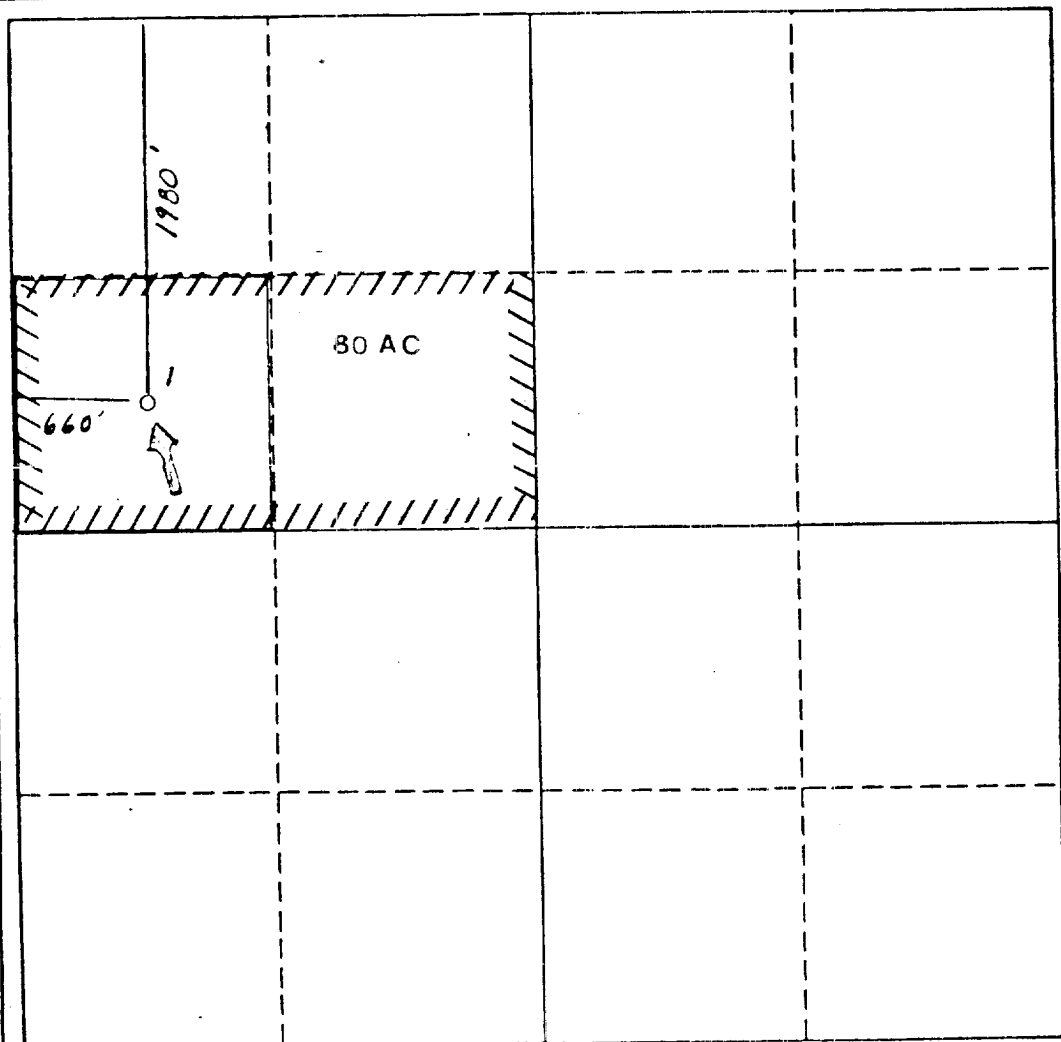

# CERTIFICATION

I hereby certify that the information contained herein is true and complete to the best of my knowledge and belief.

Name  
M. E. Sweeney

Position  
Env. & Reg. Manager

Company  
Inc.  
Mobil Producing TX. & N.M.

Date  
October 14, 1987

I hereby certify that the well location shown on this plat was plotted from field notes of actual surveys made by me or under my supervision, and that the same is true and correct to the best of my knowledge and belief.

5-30-87

Date Surveyed  
30 MAY 1988

Registered Professional Engineer and/or Land Surveyor

Certificate No.  
9669

0 330 660 990 1320 1650 1980 2310 2640 2000 1500 1000 500 0

30-025-03893



YATES NORTH VACUUM UNIT TR 2 # 2

YATES DRILLING CO

D-12-T17S-R34E 660FN 660FW

30-025-02006

