

**MEXICO OIL CONSERVATION COMMISSION
WELL LOCATION AND ACREAGE DEDICATION PLAT**

Form C-102
Supersedes C-128
Effective 1-1-65

All distances must be from the outer boundaries of the Section

Operator NEARHUBS PRODUCTION CO., L.P.			Lease W 11111		Well No. 1
Unit Letter 1	Section 12	Township 37 N	Range 17 E	County L. A.	
Actual Footage Location of Well:					
2440 feet from the SOUTH line and		2460 feet from the EAST line			
Ground Level Elev. 2400	Producing Formation ALOKA	Pool NEARHUBS C-111	Dedicated Acreage: 0 Acres		

1. Outline the acreage dedicated to the subject well by colored pencil or hatchure marks on the plat below.
2. If more than one lease is dedicated to the well, outline each and identify the ownership thereof (both as to working interest and royalty)
3. If more than one lease of different ownership is dedicated to the well, have the interests of all owners been consolidated by communitization, unitization, force-pooling, etc?

☒ Yes ☐ No If answer is "yes," type of consolidation Force Pooling

If answer is "no," list the owners and tract descriptions which have actually been consolidated. (Use reverse side of this form if necessary.) _____

No allowable will be assigned to the well until all interests have been consolidated (by communitization, unitization, forced-pooling, or otherwise) or until a non-standard unit, eliminating such interests, has been approved by the Commission.

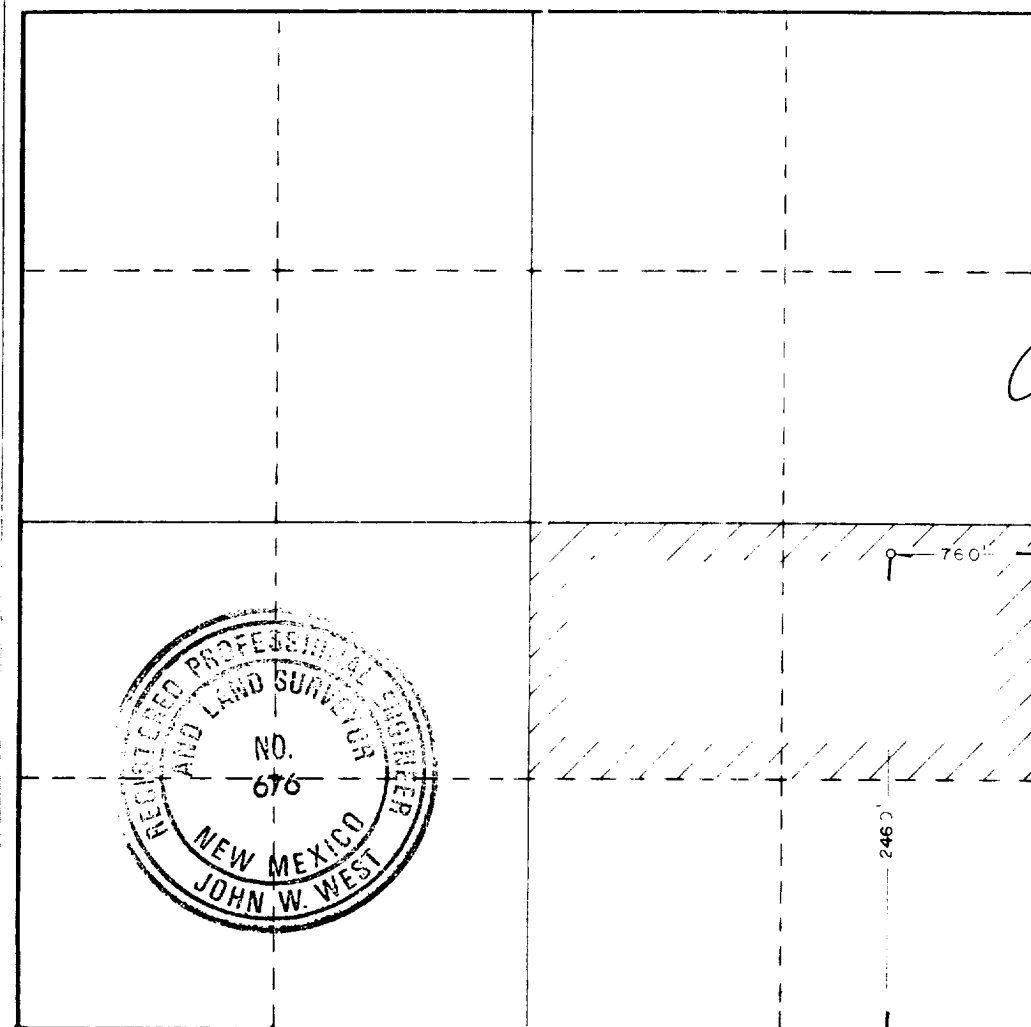

CERTIFICATION

I hereby certify that the information contained herein is true and complete to the best of my knowledge and belief.

Name John W. West
Position Asst. Eng.
Company NEARHUBS PRODUCTION CO.
Date FEBRUARY 20, 1966

I hereby certify that the well location shown on this plat was plotted from field notes of actual surveys made by me or under my supervision, and that the same is true and correct to the best of my knowledge and belief.

Date Surveyed JANUARY 11, 1966
Registered Professional Engineer and/or Land Surveyor John W. West
Certificate No. JOHN W. WEST, 676
RONALD J. EIDSON, 3239