

P. O. BOX 2088

SANTA FE, NEW MEXICO 87501

NO. OF COPIES RECEIVED	
DISTRIBUTION	
SANTA FE	
FILE	
U.S.G.S.	
LAND OFFICE	
OPERATOR	

3A. Indicate Type of Lease	
STATE <input checked="" type="checkbox"/>	FEED <input type="checkbox"/>
3. State Oil & Gas Lease No.	
B-1565	

APPLICATION FOR PERMIT TO DRILL, DEEPEN, OR PLUG BACK

Type of Work		7. Unit Agreement Name	
Type of Well	DRILL <input type="checkbox"/> DEEPEN <input type="checkbox"/> PLUG BACK <input checked="" type="checkbox"/>	8. Term of Lease Name	
OIL WELL <input checked="" type="checkbox"/> GAS WELL <input type="checkbox"/> OTHER <input type="checkbox"/>	SINGLE ZONE <input type="checkbox"/> MULTIPLE ZONE <input type="checkbox"/>	New Mexico "BM" State	
Name of Operator		9. Well No.	
Texaco Producing Inc.		1	
Address of Operator		10. Field and Pool, or Wildcat	
P. O. Box 728, Hobbs, New Mexico		Undesignated Paddock	
Location of Well		Undesignated San Andres	
UNIT LETTER 0 LOCATED 330 FEET FROM THE South LINE		12. County	
1652 FEET FROM THE East LINE OF SEC. 16 TWP. 17-S REC. 36-E NMPM		Lea	
19. Proposed Depth		19A. Formation	
9400' PBTD		Paddock, San Andres	
20. Rotary or C.T.		Pulling Unit	
21A. Kind & Status Plug. Bond		22. Approx. Date Work will start	
Blanket		February 15, 1988	

PROPOSED CASING AND CEMENT PROGRAM

SIZE OF HOLE	SIZE OF CASING	WEIGHT PER FOOT	SETTING DEPTH	SACKS OF CEMENT	EST. TOP
14-3/4"	11-3/4"	42#	407'	400	Circulated
12-1/4"	8-5/8"	32#	4200'	1550	100' (Est.)
7-7/8"	5-1/2"	17#	9461'	1335	100' (Est.)

1. MIRU. Pull rods and pump. Install BOP. Pull tubing.
2. GIH w/CIBP set @ 9200'. Cap w/35' cement. New PBTD 9165'.
3. Perf w/2 JSPI 6245, 50, 57, 61, 64, 72, 82'. (7 Intervals, 14 Holes).
4. GIH w/packer & set @ 6150'. Load backside to 500#.
5. Acidize perfs w/6000 gallons 15% NEFE. (3 BPM, 4500 psi).
6. Swab test. If favorable, place on pump; if not, proceed w/#7.
7. Set CIBP @ 6200'. Cap w/35' cement. New PBTD 6165'.
8. Perf w/2 JSPI 5178-5187' (10 Intervals, 20 Holes).
9. Set packer @ 5100' & load backside to 500#.
10. Acidize w/2000 gallons 15% NEFE (3 BPM, 4500 psi).
11. Swab test. Place on pump if favorable, if not, set CIBP @ 5150' and cap w/35' cement. Load hole w/inhibited water and rig down.

BOVE SPACE DESCRIBE PROPOSED PROGRAM IF PROPOSAL IS TO DEEPEN OR PLUG BACK, GIVE DATA ON PRESENT PRODUCTIVE ZONE AND PROPOSED NEW PROD ZONE. GIVE BLENDOUT PREVENTER PROGRAM, IF ANY.

by certify that the information above is true and complete to the best of my knowledge and belief.

rd J. A. Schaffer Title District Operations Manager Date February 2, 1988

(This space for State Use)

ORIGINAL SIGNED BY JERRY SEXTON

ROVED BY DISTRICT 1 SUPERVISOR TITLE  DATE FEB 8 - 1988

DITIONS OF APPROVAL, IF ANY:

All distances must be from the outer boundaries of the Section.

Operator <b>Texaco Producing Inc.</b>			Lease <b>N. M. "BM" State</b>		Well No. <b>1</b>
Unit Letter <b>0</b>	Section <b>16</b>	Township <b>17-S</b>	Range <b>36-E</b>	County <b>Lea</b>	
Actual Footage Location of Well: <b>330</b> feet from the <b>South</b> line and <b>1652</b> feet from the <b>East</b> line					
Ground Level Elev. <b>3858</b>	Producing Formation <b>Paddock, San Andres</b>		Pool <b>Undes. Paddock Undes. San Andres</b>		Dedicated Acreage: <b>40</b> Acres

1. Outline the acreage dedicated to the subject well by colored pencil or hatchure marks on the plat below.
2. If more than one lease is dedicated to the well, outline each and identify the ownership thereof (both as to working interest and royalty).
3. If more than one lease of different ownership is dedicated to the well, have the interests of all owners been consolidated by communitization, unitization, force-pooling, etc?

☐ Yes ☐ No If answer is "yes," type of consolidation \_\_\_\_\_

If answer is "no," list the owners and tract descriptions which have actually been consolidated. (Use reverse side of this form if necessary.) \_\_\_\_\_

No allowable will be assigned to the well until all interests have been consolidated (by communitization, unitization, forced-pooling, or otherwise) or until a non-standard unit, eliminating such interests, has been approved by the Division.

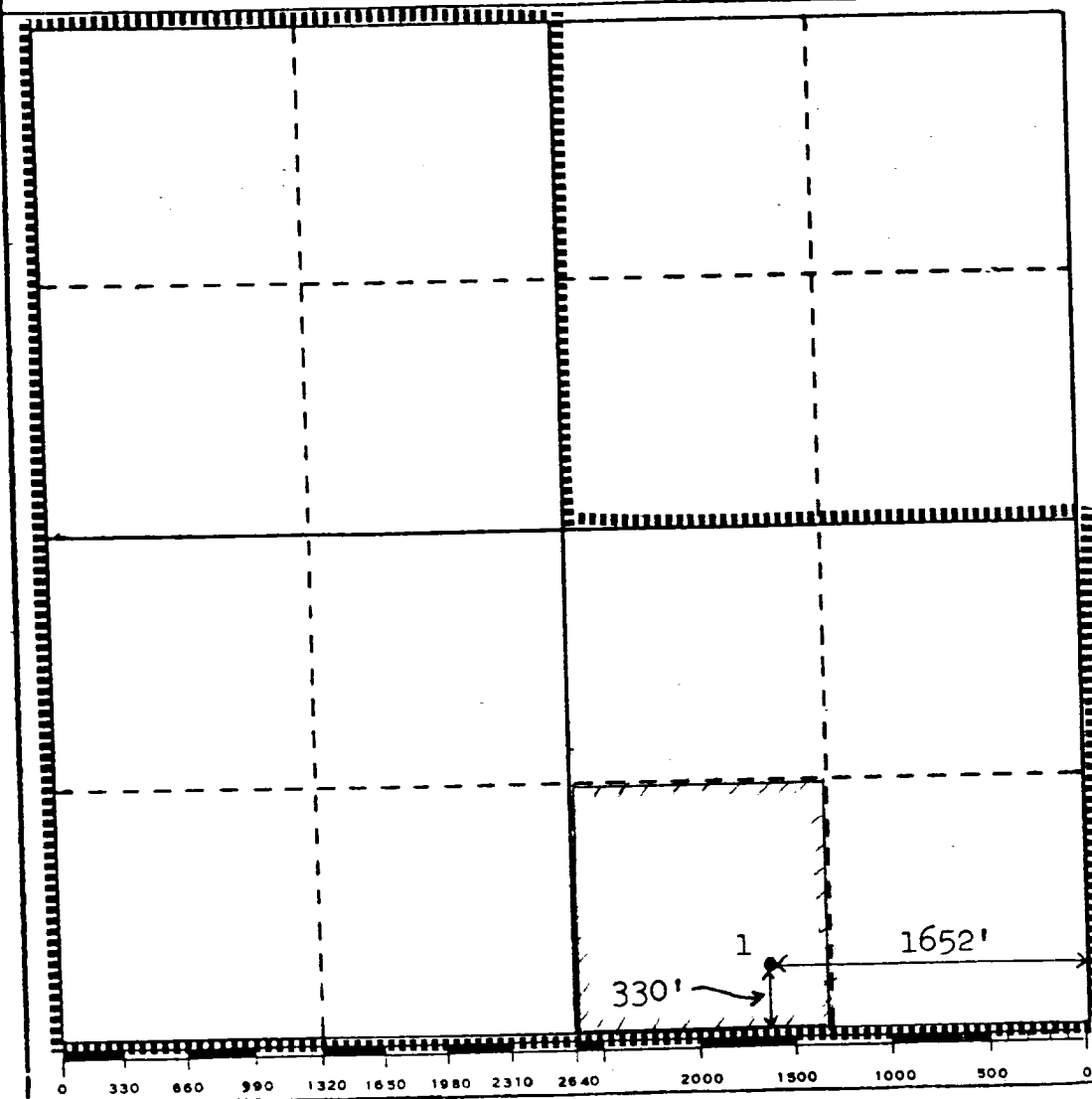

CERTIFICATION

I hereby certify that the information contained herein is true and complete to the best of my knowledge and belief.

Name  
**J. A. Schaffer**

Position  
**Dist. Opr. Mgr.**

Company  
**Texaco Producing Inc.**

Date  
**February 2, 1988**

I hereby certify that the well location shown on this plat was plotted from field notes of actual surveys made by me or under my supervision, and that the same is true and correct to the best of my knowledge and belief.

Date Surveyed

Registered Professional Engineer and/or Land Surveyor

Certificate No.