

STATE OF NEW MEXICO
ENERGY AND MINERALS DEPARTMENT

OIL CONSERVATION DIVISION

P. O. BOX 2088
SANTA FE, NEW MEXICO 87501

Form C-101
Revised 10-1-78

CO. OF COPIES RECEIVED	
DISTRIBUTION	
SANTA FE	
FILE	
U.S.G.S.	
LAND OFFICE	
OPERATOR	

5A. Indicate Type of Lease
STATE ☒ FEE ☐

5. State Oil & Gas Lease No.
E-8581

APPLICATION FOR PERMIT TO DRILL, DEEPEN, OR PLUG BACK

1a. Type of Work
b. Type of Well
OIL WELL ☒ GAS WELL ☐ OTHER ☐
DEEPEN ☐ PLUG BACK ☐
SINGLE ZONE ☒ MULTIPLE ZONE ☐

7. Unit Agreement Name

8. Farm or Lease Name
Midway, 8408 JV-P

2. Name of Operator
BTA OIL PRODUCERS

3. Address of Operator
104 South Pecos Midland, Texas 79701

4. Location of Well
UNIT LETTER -D- LOCATED 990 FEET FROM THE North LINE
AND 660 FEET FROM THE West LINE OF SEC. 13 TWP. 17-S REC. 36-E NMPM

9. Well No.
4

10. Field and Pool, or Wildcat
Midway (Abo)

12. County
Lea

19. Proposed Depth
9,200

19A. Formation
Abo

20. Rotary or C.T.
Rotary

21. Elevations (Show whether DF, HT, etc.)
3,824' GR

21A. Kind & Status Plug. Bond
Blanket

21B. Drilling Contractor
Landis Drlg. Co.

22. Approx. Date Work will start
2-12-87

PROPOSED CASING AND CEMENT PROGRAM

SIZE OF HOLE	SIZE OF CASING	WEIGHT PER FOOT	SETTING DEPTH	SACKS OF CEMENT	EST. TOP
17-1/2"	13-3/8"	54.5#	400'	450 sx	Circ.
11"	8-5/8"	24 & 32#	4000'	2000 sx	Circ.
7-7/8"	5-1/2"	17#	9200'	1500 sx	1200

BOP - Double Ram (Shaffer) - Diagram Attached.

There are no producing wells in this quarter-quarter section. There is one P&A well, (5-19-74) David #1 located 330' east of our proposed location.

IN ABOVE SPACE DESCRIBE PROPOSED PROGRAM; IF PROPOSAL IS TO DEEPEN OR PLUG BACK, GIVE DATA ON PRESENT PRODUCTIVE ZONE AND PROPOSED NEW TIME ZONE. GIVE BLOWOUT PREVENTER PROGRAM, IF ANY.

I hereby certify that the information above is true and complete to the best of my knowledge and belief.

Signed Dorothy Voughten Title Regulatory Supervisor Date 2/6/87

(This space for State Use)

Orig. Signed by
Paul Kautz

APPROVED BY Geologist TITLE _____

CONDITIONS OF APPROVAL, IF ANY:

FEB 10 1987

Permit Expires 6 Months From Approval
Date Unless Drilling Underway.

RECEIVED
FEB 9 1987
HOBBS, OGD

18-42-4 800V

B T A O I L P R O D U C E R S

Field: Midway (Abo)

Lease: Midway, 8408 JV-P Well, No. 4

Driller's Zero 1 ft Above Rotary Table

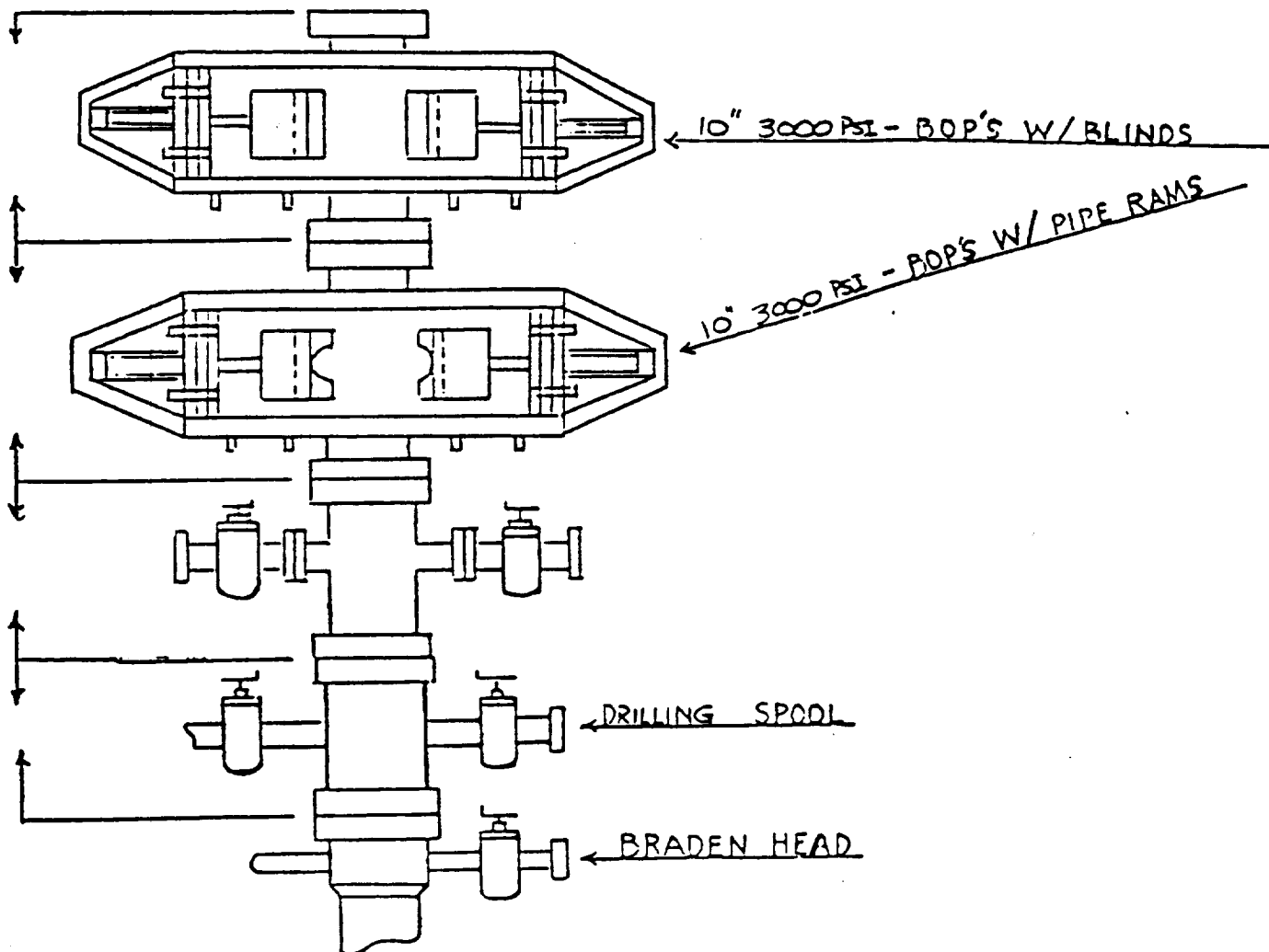

RECEIVED
FEB 9 1987
OCD
HUMAN RIGHTS OFFICE

V MEXICO OIL CONSERVATION COMMISSION
WELL LOCATION AND ACREAGE DEDICATION PLAT

Form C-102
Supersedes C-128
Effective 1-4-65

All distances must be from the outer boundaries of the Section.

Operator BTA OIL PRODUCERS		Lease 8408-WF MIDWAY 8408 JV-F		Well No. 4
Unit Letter "D"	Section 13	Township 17-S	Range 36-E	County LEA
Actual Footage Location of Wells: 990 feet from the NORTH line and 660 feet from the WEST line				
Ground Level Elev. 3824	Producing Formation ABO	Pool MIDWAY (ABO)	Dedicated Acreage: 40 Acres	

1. Outline the acreage dedicated to the subject well by colored pencil or hachure marks on the plat below.
2. If more than one lease is dedicated to the well, outline each and identify the ownership thereof (both as to working interest and royalty).
3. If more than one lease of different ownership is dedicated to the well, have the interests of all owners been consolidated by communitization, unitization, force-pooling, etc?

☐ Yes ☐ No If answer is "yes," type of consolidation _____

If answer is "no," list the owners and tract descriptions which have actually been consolidated. (Use reverse side of this form if necessary.) _____

No allowable will be assigned to the well until all interests have been consolidated (by communitization, unitization, forced-pooling, or otherwise) or until a non-standard unit, eliminating such interests, has been approved by the Commission.

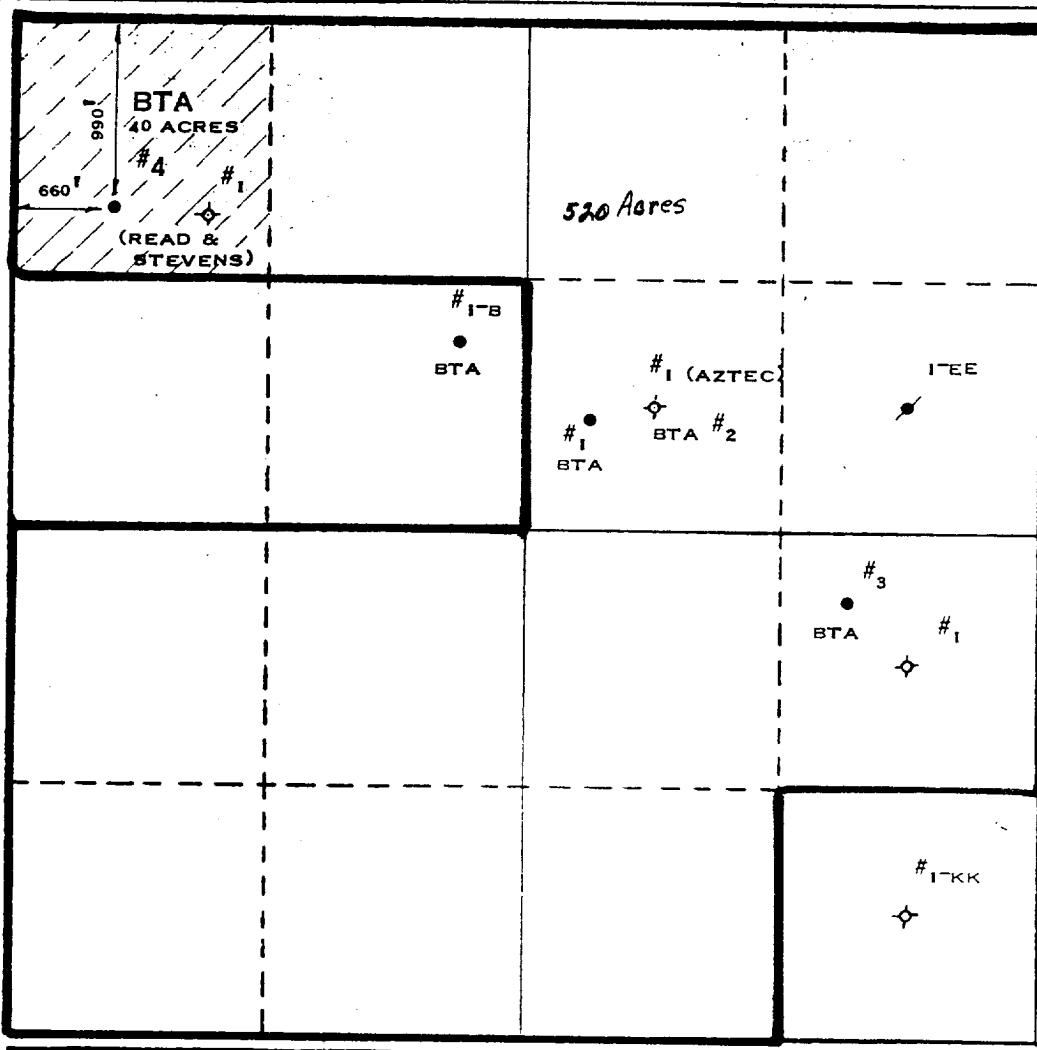

CERTIFICATION

I hereby certify that the information contained herein is true and complete to the best of my knowledge and belief.

Dorothy Houghton
Name

DOROTHY HOUGHTON

Position

Regulatory Supervisor

Company

BTA OIL PRODUCERS

Date

2/6/87

I hereby certify that the well location shown on this plat was plotted from field notes of actual surveys made by me or under my supervision, and that the same is true and correct to the best of my knowledge and belief.

Date Surveyed

FEBRUARY 5, 1987

Registered Professional Engineer and/or Land Surveyor

Max A. Schumann Jr.
MAX A. SCHUMANN JR.

Certificate No.

1510

RECEIVED
FEB 9 1987
OCD
HOBBS OFFICE

Rec'd 4-24-87

[Handwritten signature]