

NEW MEXICO OIL CONSERVATION COMMISSION
WELL LOCATION AND ACREAGE DEDICATION PLAT

Form O-10,
Supersedes O-1, 8
Effective 1-1-65

All distances must be from the outer boundaries of the Section

| | | | | | | | | |
|--|---------------------|---------------------|--------------------------------------|--------------------|---------------------|--------------------------------------|--|--|
| Operator Pennzoil Company | | | Lease 36 Pennzoil State = 600 | | | Well No. | | |
| Section 1 | Section 19 South | Township 31 East | Range 10 East | County Brewster | State New Mexico | Section 320 | | |
| Actual Surface Location of Well (600) | | | Feet from top of East line and (480) | | | Feet from top of West line and (320) | | |
| In and Layer Elev. (5,811) | | | Formation MORROW | | | Feet QUAIL RIDGE | | |

1. Outline the acreage dedicated to the subject well by colored pencil or hatchure marks on the plat below.
2. If more than one lease is dedicated to the well, outline each and identify the ownership thereof (both as to working interest and royalty) (STATE OF NEW MEXICO IS ROYALTY OWNER)
3. If more than one lease of different ownership is dedicated to the well, have the interests of all owners been consolidated by communitization, unitization, force-pooling, etc?

☐ Yes ☐ No If answer is "yes," type of consolidation COMMUNITIZATION

If answer is "no" list the owners and tract descriptions which have actually been consolidated (use reverse side of this form if necessary):

No allowable will be assigned to the well until all interests have been consolidated by communitization, unitization, forced-pooling, or otherwise or until a non-standard unit, eliminating such interests, has been approved by the Commission.

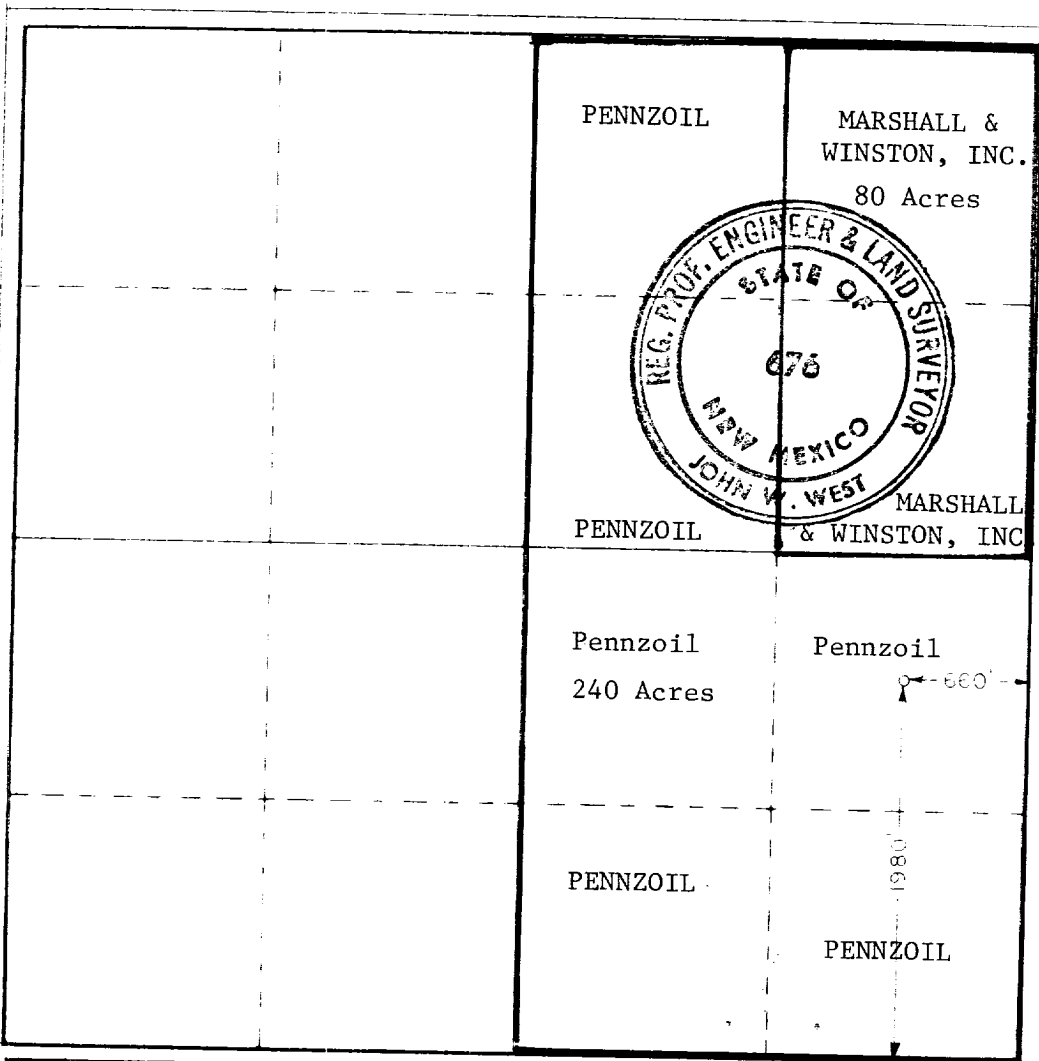

CERTIFICATION

I hereby certify that the information contained herein is true and complete to the best of my knowledge and belief.

Roy R. Johnson
Roy R. Johnson

Production Accountant

PENNZOIL COMPANY

May 6, 1987

I hereby certify that the well location shown on this plat was plotted from field notes of actual surveys made by me or under my supervision, and that the same is true and correct to the best of my knowledge and belief.

Signature
May 1, 1987
Registered Professional Engineer and Land Surveyor

Certificate No. JOHN W. WEST, 676
RONALD J. EIDSON, 3239

RECEIVED
MAY 7 1987
OCD
HOBBS OFFICE

RECEIVED
MAY 19 1987
OCD
HOBBS OFFICE