

Submit to Appropriate
District Office
State Lease - 4 copies
Fee Lease - 3 copies

State of New Mexico
Energy, Minerals and Natural Resources Department

Form C-102
Revised 1-1-89

OIL CONSERVATION DIVISION

P.O. Box 2088
Santa Fe, New Mexico 87504-2088

DISTRICT I
P.O. Box 1980, Hobbs, NM 88240

DISTRICT II
P.O. Drawer DD, Artesia, NM 88210

DISTRICT III
1000 Rio Brazos Rd., Aztec, NM 87410

WELL LOCATION AND ACREAGE DEDICATION PLAT

All Distances must be from the outer boundaries of the section

Operator Mallon Oil Company			Lease Pennzoil "36" State Comm.		Well No. 1
Unit Letter I	Section 36	Township 19 South	Range 33 East	County Lea	
Actual Footage Location of Well: 1980 feet from the South line and 660 feet from the East line					
Ground level Elev. 3598.3'	Producing Formation Atoka		Pool Wildcat Quail Ridge	Dedicated Acreage: 320 Acres	

1. Outline the acreage dedicated to the subject well by colored pencil or hatchure marks on the plat below.

2. If more than one lease is dedicated to the well, outline each and identify the ownership thereof (both as to working interest and royalty).

3. If more than one lease of different ownership is dedicated to the well, have the interest of all owners been consolidated by communitization, unitization, force-pooling, etc.?

☒ Yes ☐ No If answer is "yes" type of consolidation Communitization for Pennsylvanian

If answer is "no" list the owners and tract descriptions which have actually been consolidated. (Use reverse side of this form if necessary.)

No allowable will be assigned to the well until all interests have been consolidated (by communitization, unitization, forced-pooling, or otherwise) or until a non-standard unit, eliminating such interest, has been approved by the Division.

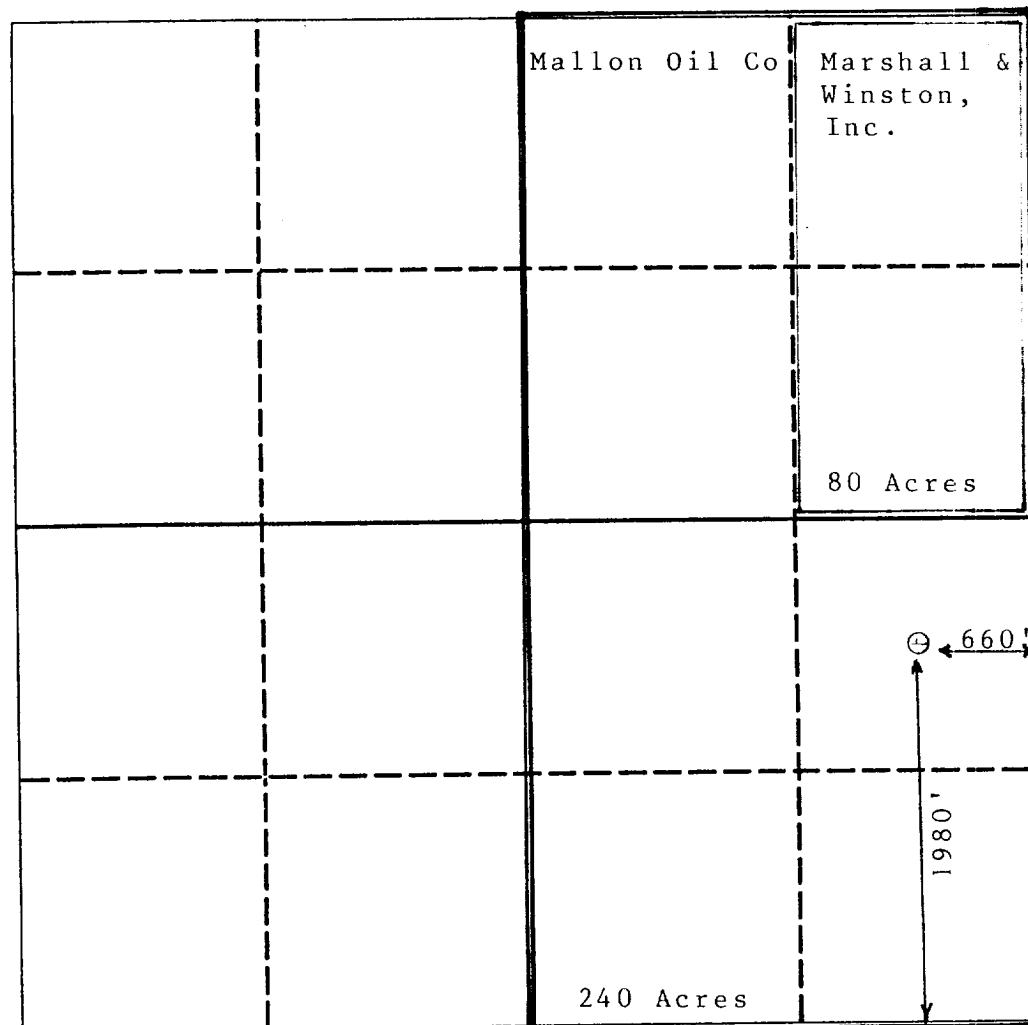

OPERATOR CERTIFICATION

I hereby certify that the information contained herein is true and complete to the best of my knowledge and belief.

Signature
Joe H. Cox, Jr.
Printed Name
Joe H. Cox, Jr.
Position
V.P. Operations
Company
Mallon Oil Company
Date
11/22/93

SURVEYOR CERTIFICATION

I hereby certify that the well location shown on this plat was plotted from field notes of actual surveys made by me or under my supervision, and that the same is true and correct to the best of my knowledge and belief.

Date Surveyed
Signature & Seal of Professional Surveyor
Certificate No.

WRS COMPLETION REPORT

COMPLETIONS SEC 36 TWP 19S RGE 33E
PI# 30-T-0015 05/09/88 30-025-29918-0000 PAGE 1

NMEX LEA * 1980FSL 660FEL SEC NE SE
STATE COUNTY FOOTAGE SPOT
PENNZOIL CO D DG
OPERATOR WELL CLASS INIT FIN

1 PENNZOIL STATE "36" COM
WELL NO. LEASE NAME

3615KB 3598GR QUAIL RIDGE
OPER ELEV FIELD/POOL AREA
API 30-025-29918-0000

LEASE TYPE NO. PERMIT OR WELL I.D. NO.
05/24/1987 10/29/1987 ROTARY GAS

SPUD DATE COMP. DATE TYPE TOOL STATUS
14000 MORROW MCVAY DRLG 7 RIG SUB 16

PROJ. DEPTH PROJ. FORM CONTRACTOR
DTD 13690 PB 13646 FM/TD BARNETT

DRILLERS T.D. LOG T.D. PLUG BACK TO OLD T.D. FORM T.D.

LOCATION DESCRIPTION

14 MI SW BUCKEYE, NM

CASING/LINER DATA

CSG 13 3/8 @ 1391 W/ 1525 SACKS
CSG 8 5/8 @ 4925 W/ 3375 SACKS
CSG 5 1/2 @ 13690 W/ 3123 SACKS

TUBING DATA

TBG 2 7/8 AT 13058

INITIAL POTENTIAL

IPF 6609 MCFD 24HRS
MORROW PERF W/ 320/IT 13145-13333 GROSS

SITP 4355
@13239FT BHT 160F
890MCFD TP 4059 BHFP 5935
1204MCFD TP 3897 BHFP 5752
1585MCFD TP 3724 BHFP 5556
3100MCFD TP 3047 BHFP 4778

BH 6267 FPCAOF 6609MCFD

GTY 51.8 GOR 17358

GAS GTY .659

P/L CON NONE

1ST THRU 4TH PT TEST IN 60 MINS, CKS-NO DETAILS

CONTINUED IC# 300257013087

Petroleum Information

Copyrighted 1988
Petroleum
Information Corporation

DB a company of
The Dun & Bradstreet Corporation

WRS-GET
Form No. 87

COMPLETIONS
 PI# 30-T-0015 05/09/88 SEC 36 TWP 19S RGE 33E
 30-025-29918-0000 PAGE 2

PENNZOIL CO
 1 PENNZOIL STATE "36" COM D DG

TYPE	FORMATION	TH TOP	DEPTH/SUB	BSE	DEPTH/SUB
LOG	YATES	3730	-132		
LOG	BONE SPG	8248	-4650		
LOG	BONE SP1	9338	-5740		
LOG	BONE SP2	9824	-6226		
LOG	BONE SP3	10607	-7009		
LOG	WOLFCAMP	10872	-7274		
LOG	WFCMP LM	11117	-7519		
LOG	STRAWN	12162	-8564		
LOG	ATOKA	12423	-8825		
LOG	MORROW	12700	-9102		
LOG	BARNETT SF	13568	-9970		

SUBSEA MEASUREMENTS FROM GR

FORMATION TEST DATA

DST 1 10586-10619 BONE SP2
 GAS TS IN 1H
 REC 4.0 BBL OIL 17.8 CC OIL
 REC 5.3 CFT GAS
 INIT OP 4M IFP 299 FFP 311
 FINAL OP 1H35M IFP 261 FFP 424 BHT 158F
 ISIP 5225 1H PSIP 4848 4H37M IHP 5237 FHP 5250
 SPL CHAM PRESS FINAL 1250
 GTY 38.6
 SPL REC 5.37 CFT GAS

PRODUCTION TEST DATA

MORROW PERF W/ 320/IT 13145-13333 GROSS
 PERF 13145-13147 : 3169-13173 13182-13188 13193-13222
 PERF 13244-13254 : 3262-13264 13268-13278 13318-13333
 NATURAL

LOGS AND SURVEYS /INTERVAL, TYPE/

LOGS	DIL	DENL	NEUT
LOGS	GR	CAL	

DRILLING PROGRESS DETAILS

PENNZOIL CO
 DR 1828

CONTINUED

COMPLETIONS
PI# 30-T-0015 05/09/88 SEC 36 TWP 19S RGE 33E
30-025-29918-0000 PAGE 3

PENNZOIL CO
1

PENNZOIL STATE "36" COM

D DG

DRILLING PROGRESS DETAILS

MIDLAND, TX 79702
915-682-7316
05/08 LOC/1987/
05/29 DRLG 3094 (ANHY, SALT, SD)
06/03 DRLG 4928 (ANHY, SALT, SD)
06/09 DRLG 5137 (LM, SD)
06/11 5137 TD, WSHG STUCK PIPE
06/16 5137 TD, WSHG STUCK DP
06/23 5137 TD, WSHG
06/26 5137 TD, WSHG
07/06 5137 TD, WSHG
07/14 DRLG 8075 (LM, SD)
07/20 DRLG 10496 (LM)
07/27 DRLG 12205 (SH, LM, CHT)
08/03 DRLG 12970 (LM, SD, SH)
08/06 DRLG 13128 (LM, SD, SH)
08/12 13690 TD, WOC
08/17 13690 TD, WOCT
09/04 13690 TD, WOCT
10/09 13690 TD, WOCT
11/04 13690 TD, PB 13646, TSTG
12/16 13690 TD, PB 13646, PREP TEST
12/30 13690 TD, PB 13646, TOP
01/12 13690 TD, PB 13646, TOP
01/28 13690 TD, PB 13646, TSTG
02/01 13690 TD, PB 13646, TSTG
02/09 13690 TD, PB 13646, TSTG
02/11 13690 TD, PB 13646, SI
02/22 13690 TD, PB 13646, SI
02/26 13690 TD, PB 13646, SI
04/07 13690 TD, PB 13646, SI
04/12 13690 TD, PB 13646, SI
05/05 LOCAL CALL: DELAWARE MOUNTAIN GROUP 5520
TD REACHED 08/12/87 RIG REL 08/16/87
05/05 13690 TD, PB 13646
COMP 10/29/87, IPCAOF 6609 MCFGPD, GOR
17358, GTY 51.8, GTY (GAS)
.659, SIWHP 4355, SIBHP
6267
PROD ZONE - MORROW 13145-13333
NO CORES, ONE DST RPTD



STATE OF NEW MEXICO
ENERGY AND MINERALS DEPARTMENT
OIL CONSERVATION DIVISION
HOBBS DISTRICT OFFICE

GARREY CARRUTHERS
GOVERNOR

May 8, 1987

POST OFFICE BOX 1980
HOBBS, NEW MEXICO 88241-1980
(505) 393-6161

Pennzoil Company
P.O. Drawer 1828
Midland, TX 79702-1828

Attn: Joel Pettit

Re: Pennzoil State 36 Com #1-I
Section 36, T19S, R33E

Gentlemen:

Your application for a permit to drill a well to the Morrow formation at the above location has been received. This area is located within the "Potash Area" and drilling in this area is governed by "special rules and regulations" as set out by R-111-A.

We have reviewed your application and find the following must be complied with before the permit can be approved.

- ✓ 1) A map or plat of the area showing potash leases and well location must accompany Form C-101.
- ✓ 2) Potash operators holding potash leases within a radius of one mile of the proposed well must be notified by copy of your application for permit to drill. You will need to furnish the OCD a copy of the return receipts showing date of delivery to potash lease holders. We are required to wait 10 days from date of delivery to allow for objections. If waivers are obtained from all potash operators, the 10-day waiting period can be waived.
- ✓ Your lease name indicates the acreage is communitized, but your acreage dedication plat does not address questions (2) and (3) concerning this. We are returning Form C-102 in order that you may supply this information.
- ✓ Your proposed surface casing setting depth of 400 feet will be amended to top of salt at approximately 1400 feet cemented with cement adequate to circulate to surface.

*Waivers
obtained*

Pennzoil Company

-2-

May 8, 1987

If you have any questions concerning this matter, please contact
Jerry Sexton at (505 393-6161).

Very truly yours,

OIL CONSERVATION DIVISION

Jerry Sexton
Supervisor, District I

JS/ed

enclosure

Pool APACHE RIDGE BONE SPRING Operator Mallon Oil Co.

Lease Pennzoil 36 St. Well No. 1 Unit I S 36 T 19 R 33

[illegible]