

NEW MEXICO OIL CONSERVATION COMMISSION
WELL LOCATION AND ACREAGE DEDICATION PLAT

Form C-102
Supersedes C-128
Effective 1-1-65

All distances must be from the outer boundaries of the Section

Operator Charles B. Gillespie			Lease Shipp		Well No. 2
Unit Letter C	Section 11	Township 17 South	Range 37 East	County Lea	
Actual Footage Location of Well: 810 feet from the North line and 1980 feet from the West line					
Ground Level Elev. 3753.7	Producing Formation Strawn	Pool Humble City Strawn Wildcat		Dedicated Acreage: 40 80 Acres	

1. Outline the acreage dedicated to the subject well by colored pencil or hachure marks on the plat below.
2. If more than one lease is dedicated to the well, outline each and identify the ownership thereof (both as to working interest and royalty).
3. If more than one lease of different ownership is dedicated to the well, have the interests of all owners been consolidated by communitization, unitization, force-pooling, etc?

☐ Yes ☐ No If answer is "yes," type of consolidation _____

If answer is "no," list the owners and tract descriptions which have actually been consolidated. (Use reverse side of this form if necessary.) _____

No allowable will be assigned to the well until all interests have been consolidated (by communitization, unitization, forced-pooling, or otherwise) or until a non-standard unit, eliminating such interests, has been approved by the Commission.

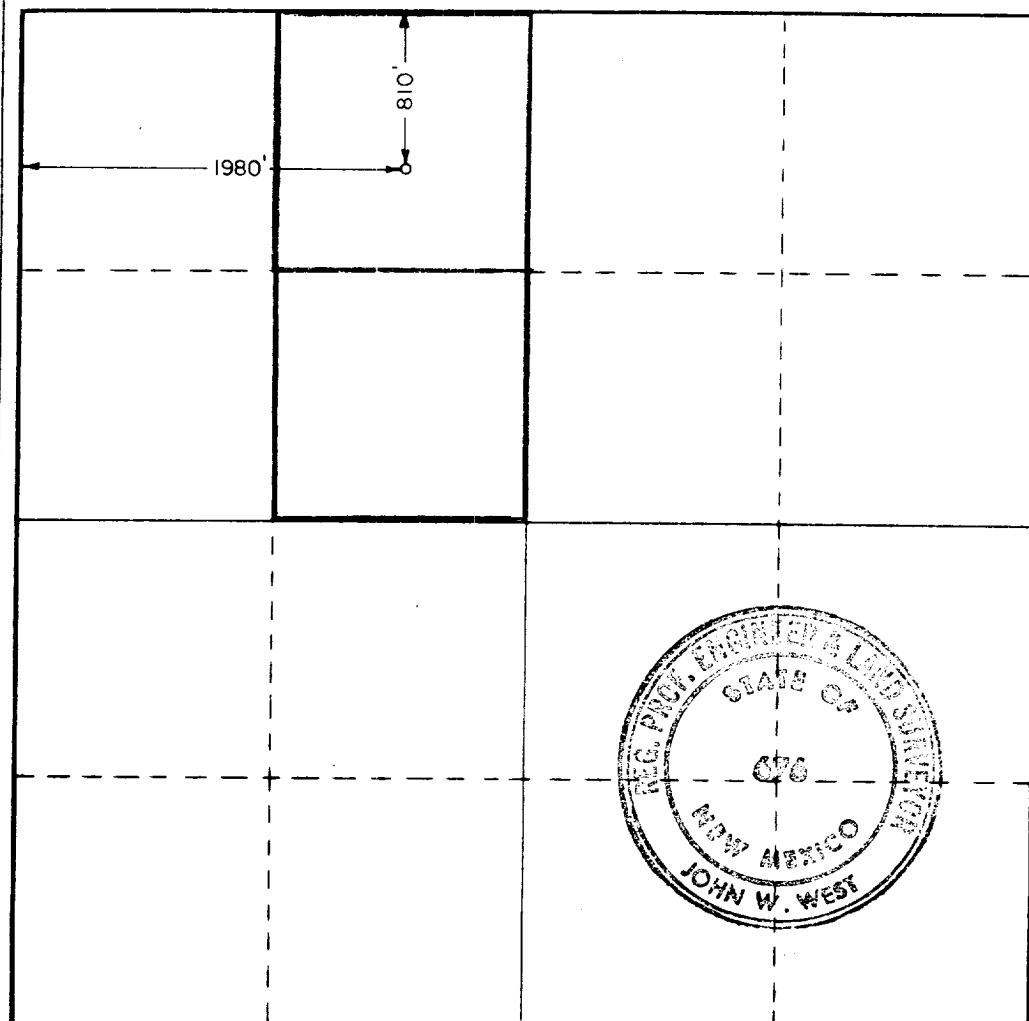

CERTIFICATION

I hereby certify that the information contained herein is true and complete to the best of my knowledge and belief.

Name
David Hastings
Position
Production Manager
Company
Charles B. Gillespie, Jr.
Date
5/29/87

I hereby certify that the well location shown on this plat was plotted from field notes of actual surveys made by me or under my supervision, and that the same is true and correct to the best of my knowledge and belief.

Date Surveyed
May 27, 1987
Registered Professional Engineer
and/or Land Surveyor

Certificate No. JOHN W. WEST, 676
RONALD J. EIDSON, 3239

RECEIVED
JUN 1 1987
OCD
HOBBS OFFICE

78-01-217274

ELF

WRS COMPLETION REPORT

COMPLETIONS SEC 11 TWP 17S RGE 37E
PI# 30-T-0017 12/07/87 30-025-29937-0000 PAGE 1

NMEX LEA * 810FNL 1980FWL SEC NE NW
STATE COUNTY FOOTAGE SPOT
GILLESPIE CHARLES B JR D D
OPERATOR WELL CLASS INIT FIN
2 SHIPP
WELL NO. LEASE NAME
3768KB 3754GR HUMBLE CITY
OPER ELEV FIELD POOL AREA
API 30-025-29937-0000

LEASE TYPE NO. PERMIT OR WELL I.D. NO.
07/03/1987 08/06/1987 ROTARY D&A
SPUD DATE COMP. DATE TYPE TOOL STATUS
11800 STRAWN WILLBROS DRLG 4 RIG SUB 13
PROJ. DEPTH PROJ. FORM CONTRACTOR
DTD 11693 FM/TD STRAWN
DRILLERS T.D. LOG T.D. PLUG BACK TD OLD T.D. FORM T.D.

LOCATION DESCRIPTION

6 MI W KNOWLES, NM

CASING/LINER DATA

CSG 13 3/8 @ 445
CSG 8 5/8 @ 4460 W/ 1725 SACKS

DRILLING PROGRESS DETAILS

GILLESPIE CHARLES B JR
BOX 8
MIDLAND, TX 79702
915-683-1765
06/02 LOC/1987/
07/23 DRLG 9530
07/28 DRLG 10520
08/05 DRLG 11649
08/11 11693 TD, HOLDING FOR DATA
RIG REL 08/06/87
11/30 11693 TD
COMP 8/6/87, D&A
NO CORES OR DSTS RPTD

IC# 300257016187