

NO. OF COPIES RECEIVED	
DISTRIBUTION	
SANTA FE	
FILE	
U.S.G.S.	
LAND OFFICE	
OPERATOR	

5A. Indicate Type of Lease  
STATE ☒ FEDERAL ☐

5. State Oil & Gas Lease No.  
B-2863-1

APPLICATION FOR PERMIT TO DRILL, DEEPEN, OR PLUG BACK

1a. Type of Work DRILL <input checked="" type="checkbox"/> DEEPEN <input type="checkbox"/> PLUG BACK <input type="checkbox"/>		7. Unit Agreement Name East Vacuum Gb/SA Unit
b. Type of Well OIL WELL <input checked="" type="checkbox"/> GAS WELL <input type="checkbox"/> OTHER <input type="checkbox"/> SINGLE ZONE <input checked="" type="checkbox"/> MULTIPLE ZONE <input type="checkbox"/>		8. Farm or Lease Name East Vacuum Gb/SA Unit
2. Name of Operator Phillips Petroleum Company		9. Well No. Tract 3374 004
3. Address of Operator Room 401, 4001 Penbrook St., Odessa, Texas 79762		10. Field and Pool, or Wildcat Vacuum Gb/SA
4. Location of Well UNIT LETTER <u>L</u> LOCATED <u>1980 / 950</u> FEET FROM THE <u>South</u> LINE AND <u>210</u> FEET FROM THE <u>West</u> LINE OF SEC. <u>33</u> TWP. <u>17-S</u> RGE. <u>35-E</u> NMPM		12. County Lea
19. Proposed Depth 4800'		19A. Formation Grayburg San Andres
20. Rotary or C.T. Rotary		21. Elevations (Show whether DF, RT, etc.) 3951.0 GL (Unprepared)
21A. Kind & Status Plug. Bond Blanket		21B. Drilling Contractor advise later
22. Approx. Date Work will start Upon approval		

23.

PROPOSED CASING AND CEMENT PROGRAM

SIZE OF HOLE	SIZE OF CASING	WEIGHT PER FOOT	SETTING DEPTH	SACKS OF CEMENT	EST. TOP
12-1/4	8-5/8	24#	1600'	1000 sk "C"	surface
7-7/8	5-1/2	15.5#	4800'	1400 sk "C"	surface

Use mud additives as required for control.

BOP Equipment: Series 900, 3000# WP (See attached schematic - Figure 7-9 or 7-10)

IN ABOVE SPACE DESCRIBE PROPOSED PROGRAM: IF PROPOSAL IS TO DEEPEN OR PLUG BACK, GIVE DATA ON PRESENT PRODUCTIVE ZONE AND PROPOSED NEW PRODUCTIVE ZONE. GIVE BLOWOUT PREVENTER PROGRAM, IF ANY.

I hereby certify that the information above is true and complete to the best of my knowledge and belief.

Signed W.J. Mueller Title Eng. Supervisor, Reservoir Date 7/27/87

(This space for State Use)  
Signed by  
Paul Kautz  
Geologist

APPROVED BY \_\_\_\_\_ TITLE \_\_\_\_\_ DATE AUG 18 1987

CONDITIONS OF APPROVAL, IF ANY:

Permit Expires 6 Months From Approval  
Date Unless Drilling Underway.

NSL-2373

RECEIVED

JUL 30 1987

OCD

MOBBS OFFICE

NEW MEXICO OIL CONSERVATION COMMISSION  
WELL LOCATION AND ACREAGE DEDICATION PLAT

Form C-102  
Supersedes C-128  
Effective 1-1-65

All distances must be from the outer boundaries of the Section

Operator Phillips Petroleum Company		Lease EVCSAU		Tr 3374		Well No. 3374-004
Plot Letter 1	Section 33	Township 17 South	Range 35 East	County Lea		
Actual Forage Location of Well						
1950		feet from the	line and	110	feet from the	West line
Ground Level Elev. 3471.0	Producing Formation Grayburg San Andres		Pool Vacuum		Dedicated Acreage: 40 Acres	

1. Outline the acreage dedicated to the subject well by colored pencil or hatchure marks on the plat below.
2. If more than one lease is dedicated to the well, outline each and identify the ownership thereof (both as to working interest and royalty).
3. If more than one lease of different ownership is dedicated to the well, have the interests of all owners been consolidated by communization, unitization, force-pooling, etc?

☒ Yes ☐ No If answer is "yes" type of consolidation Unitization

If answer is "no" list the owners and tract descriptions which have actually been consolidated. (Use reverse side of this form if necessary.)

No allowable will be assigned to the well until all interests have been consolidated (by communization, unitization, forced-pooling, or otherwise) or until a non-standard unit, eliminating such interests, has been approved by the Commission.

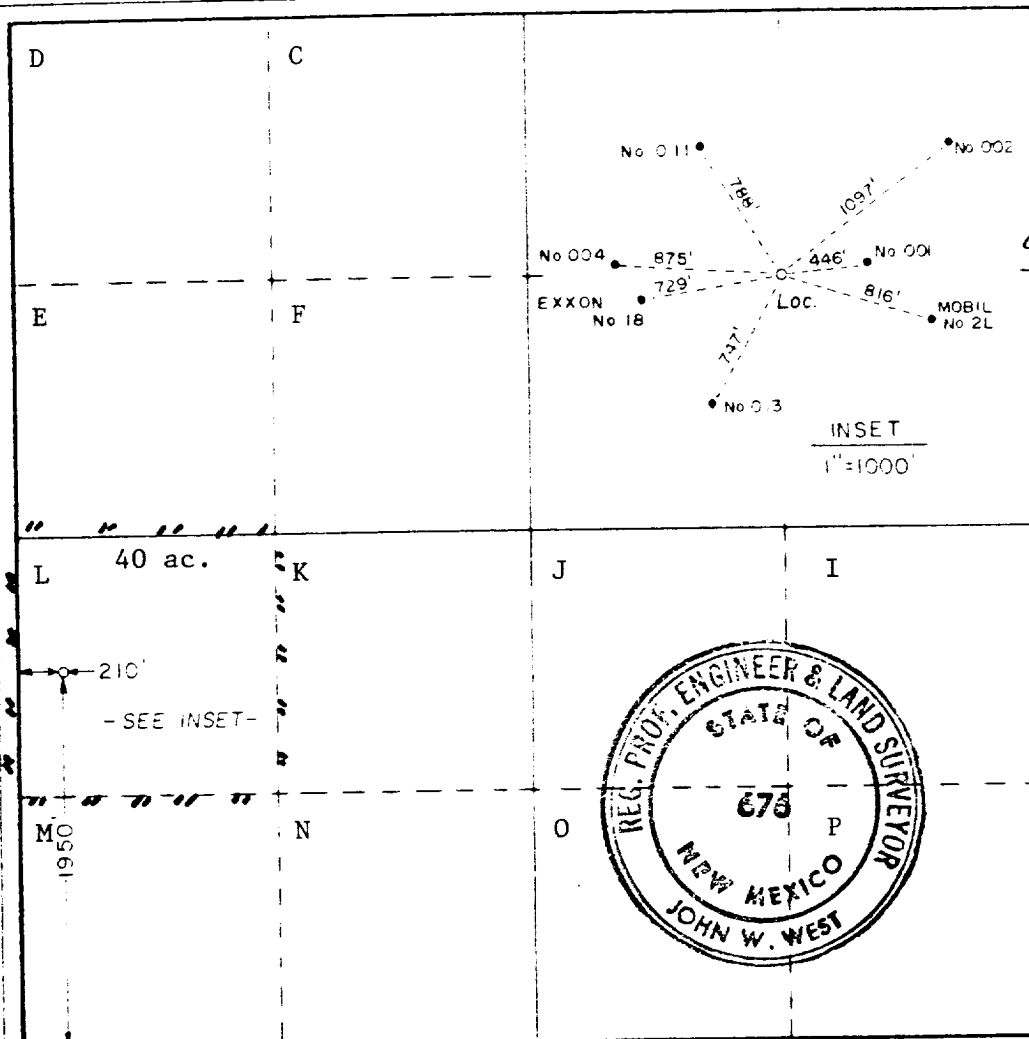

CERTIFICATION

I hereby certify that the information contained herein is true and complete to the best of my knowledge and belief.

W. J. Mueller  
Position  
Eng. Supervisor, Reservoir  
Company  
Phillips Petroleum Company

Date  
7/29/87

I hereby certify that the well location shown on this plat was plotted from field notes of actual surveys made by me or under my supervision, and that the same is true and correct to the best of my knowledge and belief.

Date Surveyed  
July 9, 1987  
Registered Professional Engineer and or Land Surveyor

Certificate No JOHN W. WEST, 676  
RONALD J. EIDSON, 3239

RECEIVED

JUL 30 1987

OCD  
MOBBS OFFICE

# FIELD PRACTICES AND STANDARDS

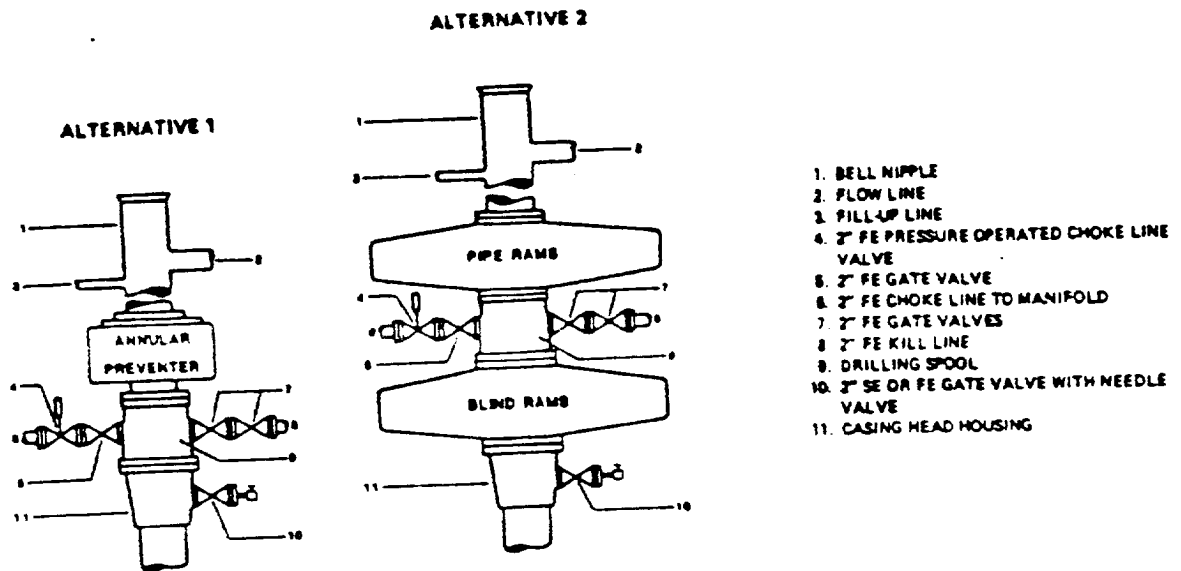

NOTE: THE DRILLING SPOOL MAY BE LOCATED BELOW BOTH SETS OF RAMS IF A DOUBLE PREVENTER IS USED AND IT DOES NOT HAVE SUITABLE OUTLETS BETWEEN RAMS

Figure 7-9. Standard Hydraulic Blowout Preventer Assembly (2 M or 3 M Working Pressure) Alternative 1

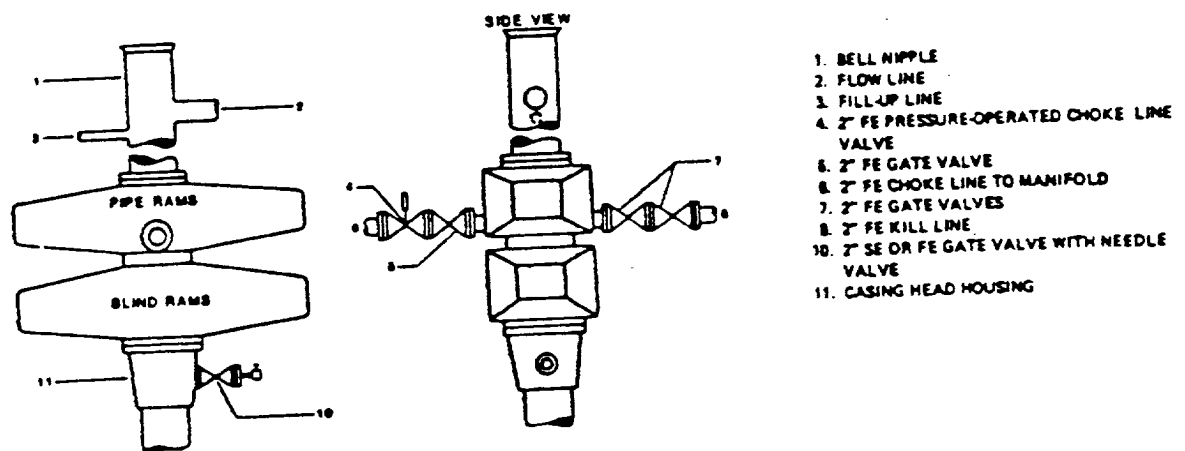

Figure 7-10. Standard Hydraulic Blowout Preventer Assembly (2 M or 3 M Working Pressure) Alternative 3 (without Drilling Spool)

RECEIVED

JUL 30 1987

OCD  
HOBBS OFFICE

EAST VACUUM GRAYBURG/SAN ANDRES UNIT  
Lea County, New Mexico  
Well No. 3374-004

The proposed infill producer is required to convert a 40-acre five spot pattern within the WAG Area to a 40-acre inverted nine-spot pattern. The 10-acre infill location will increase the WAG flood efficiency by producing oil currently trapped between adjacent injectors.

REG/PR06/evgsau

**RECEIVED**  
**JUL 30 1987**  
**OCD**  
**HOBBS OFFICE**

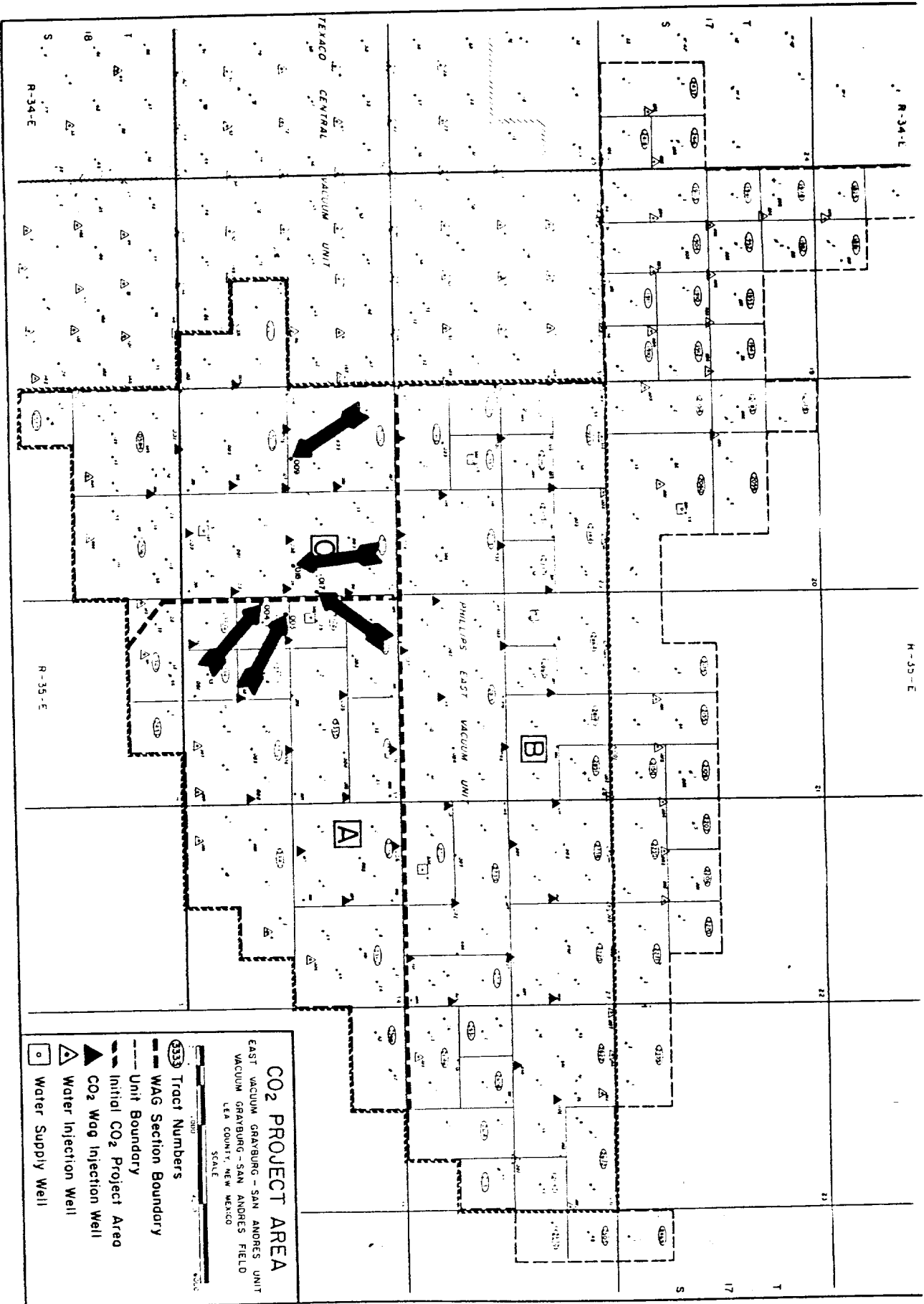

RECEIVED  
JUL 30 1987  
OCD  
HOBBS OFFICE

88-81-8727

ELF