

**NEW MEXICO OIL CONSERVATION COMMISSION
WELL LOCATION AND ACREAGE DEDICATION PLAT**

Form C-102
Supersedes C-128
Effective 1-1-85

All distances must be from the outer boundaries of the Section

Operator Phillips Petroleum Company			Lease EVGSAU <i>TR 3702</i>		Well No. 3202-017
Tract Letter H	Section 32	Township 17 South	Range 35 East	County Lea	
Actual True Edge Location of Well: <div style="display: flex; justify-content: space-between;"> 2000 feet from the North line and 120 feet from the East line </div>					
Ground Level Elev 3943.7	Producing Formation Grayburg San Andres	Pool Vacuum	Dedicated Acreage: 40 Acres		

1. Outline the acreage dedicated to the subject well by colored pencil or hachure marks on the plat below.
2. If more than one lease is dedicated to the well, outline each and identify the ownership thereof (both as to working interest and royalty).
3. If more than one lease of different ownership is dedicated to the well, have the interests of all owners been consolidated by communitization, unitization, force-pooling, etc?

☒ Yes ☐ No If answer is "yes" type of consolidation unitization

If answer is "no," list the owners and tract descriptions which have actually been consolidated. (Use reverse side of this form if necessary.) _____

No allowable will be assigned to the well until all interests have been consolidated (by communitization, unitization, forced-pooling, or otherwise) or until a non-standard unit, eliminating such interests, has been approved by the Commission.

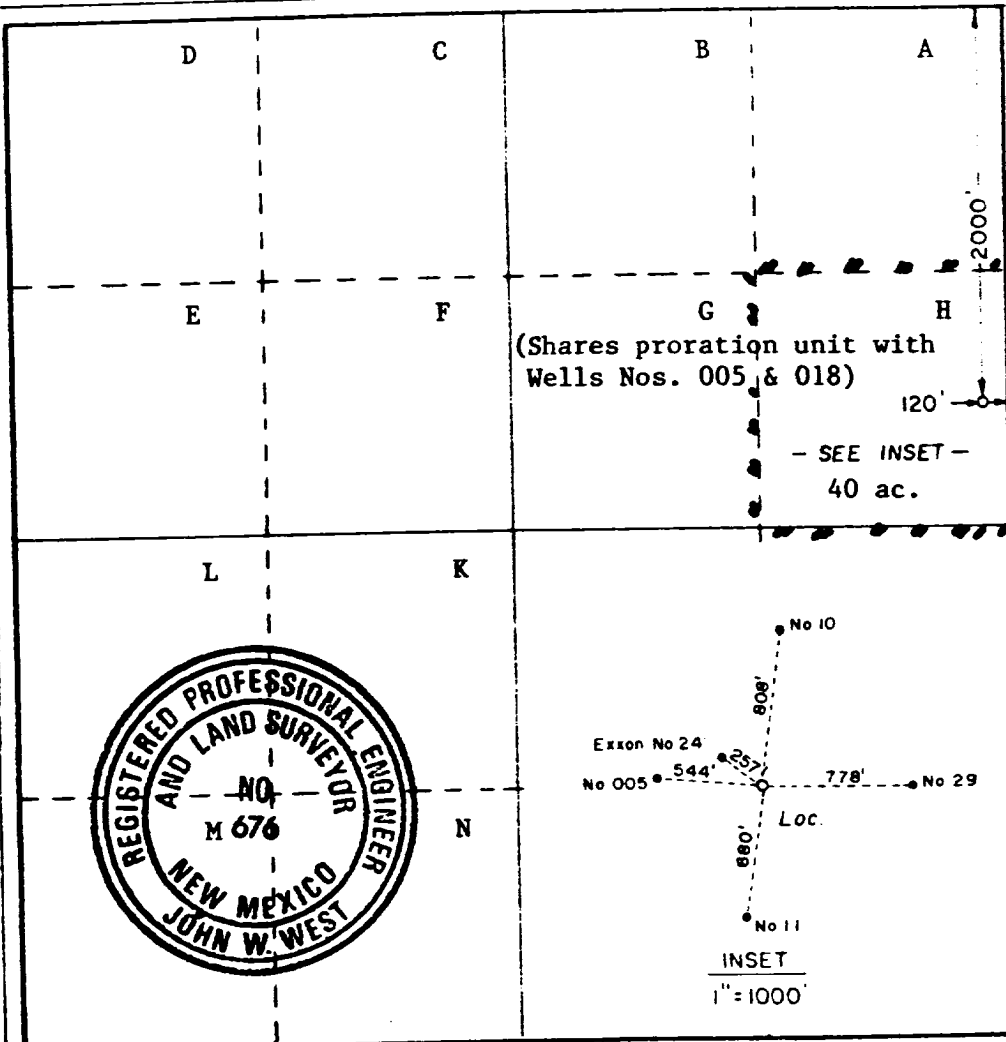

CERTIFICATION

I hereby certify that the information contained herein is true and complete to the best of my knowledge and belief.

Signature: *W. J. Mueller*
Name: **W. J. Mueller**

Position: **Eng. Supervisor, Reservoir**

Company: **Phillips Petroleum Co.**

Date: **7/27/87**

I hereby certify that the well location shown on this plat was plotted from field notes of actual surveys made by me or under my supervision, and that the same is true and correct to the best of my knowledge and belief.

Date Surveyed: **July 9, 1987**

Registered Professional Engineer and/or Land Surveyor

Signature: *John W. West*

Certificate No. **JOHN W. WEST, 676**
NEW MEXICO 3270