

NO. OF COPIES DESIRED	
DISTRIBUTION	
SANTA FE	
FILE	
U.S.G.S.	
LAND OFFICE	
OPERATOR	

3A. Indicate Type of Lease
STATE ☒ FEE ☐
3. State Oil & Gas Lease No.
B-1565

APPLICATION FOR PERMIT TO DRILL, DEEPEN, OR PLUG BACK

Type of Work
Type of Well DRILL ☒ DEEPEN ☐ PLUG BACK ☐
OIL WELL ☒ GAS WELL ☐ OTHER ☐ SINGLE ZONE ☒ MULTIPLE ZONE ☐
Name of Operator
Texaco Producing Inc.
Address of Operator
P. O. Box 728, Hobbs, New Mexico 88240
Location of Well
UNIT LETTER A LOCATED 90 FEET FROM THE North LINE
706 FEET FROM THE East LINE OF SEC. 36 TWP. 17-S RCE. 34-E
12. County
Lea
19. Proposed Depth 4700' 19A. Formation Grayburg San Andres 20. Rotary or C.T. Rotary
Elevations (Show whether DF, KT, etc.) 3993 GR 21A. Kind & Status Plug. Bond Blanket 21B. Drilling Contractor 22. Approx. Date Work will start November 22, 1987

PROPOSED CASING AND CEMENT PROGRAM

SIZE OF HOLE	SIZE OF CASING	WEIGHT PER FOOT	SETTING DEPTH	SACKS OF CEMENT	EST. TOP
26"	20"	94#	350'	1000	Circulate
17-1/2"	13-3/8"	54.5#	1550'	1500	Circulate
12-1/4" & 8-1/2"*	7"	23#	4300'	2050	Circulate

*Reduce hole size to 8-1/2" at 2800' if no waterflow is encountered. 6-1/8" bit will be used from 4300' to TD.

CEMENTING PROGRAM

SURFACE CASING: 1000 sacks 50/50 Pozmix Class "H" w/2% CaCl & 1/4# Flocele (15.6 ppg, 1.18 cu. ft./sx.).

INTERMEDIATE CASING: 1250 sacks 50/50 Pozmix Class "H" w/2% CaCl, 1/4# Flocele (14.15 ppg, 1.26 cu. ft./sx.) followed by 250 sacks Class "H" w/2% CaCl, 1/4# Flocele (15.6 ppg, 1.18 cu. ft./sx.).

PRODUCTION CASING: 1800 sacks 50/50 Pozmix Class "H" w/10# Salt & 1/4# Flocele (14.15 ppg, 1.28 cu. ft./sx) followed by 250 sacks Class "H" w/2% CaCl (15.6 ppg, 1.18 cu. ft./sx.).

Administrative Order NSL-2366 applies.

All other wells located in this 1/4, 1/4 section are operated by Texaco.

ABOVE SPACE DESCRIBE PROPOSED PROGRAM; IF PROPOSAL IS TO DEEPEN OR PLUG BACK, GIVE DATA ON PRESENT PRODUCTIVE ZONE AND PROPOSED NEW PROOD ZONE. GIVE SLOWOUT PREVENTER PROGRAM, IF ANY.

I hereby certify that the information above is true and complete to the best of my knowledge and belief.

Signed L. J. Seeman Title Dist. Petr. Engr. Date 10/06/87

(This space for State Use)

ORIGINAL SIGNED BY JERRY SEXTON

APPROVED BY DISTRICT 1 SUPERVISOR TITLE DATE OCT 14 1987

CONDITIONS OF APPROVAL, IF ANY:

Permit Expires 6 Months From Approval
Date Unless Drilling Underway.

NSL 2366

All distances must be from the outer boundaries of the Section.

Operator Texaco Producing Inc.			Lease Central Vacuum Unit		Well No. 242
Unit Letter A	Section 36	Township 17-S	Range 34-E	County Lea	
Actual Footage Location of Well: 90 feet from the North line and 706 feet from the East line					
Ground Level Elev. 3993'	Producing Formation San Andres	Pool Vacuum (Grayburg-San Andres)		Dedicated Acreage: 40 Acres	

1. Outline the acreage dedicated to the subject well by colored pencil or hatchure marks on the plat below.
2. If more than one lease is dedicated to the well, outline each and identify the ownership thereof (both as to working interest and royalty).
3. If more than one lease of different ownership is dedicated to the well, have the interests of all owners been consolidated by communitization, unitization, force-pooling, etc?

☐ Yes ☐ No If answer is "yes," type of consolidation _____

If answer is "no," list the owners and tract descriptions which have actually been consolidated. (Use reverse side of this form if necessary.) _____

No allowable will be assigned to the well until all interests have been consolidated (by communitization, unitization, forced-pooling, or otherwise) or until a non-standard unit, eliminating such interests, has been approved by the Division.

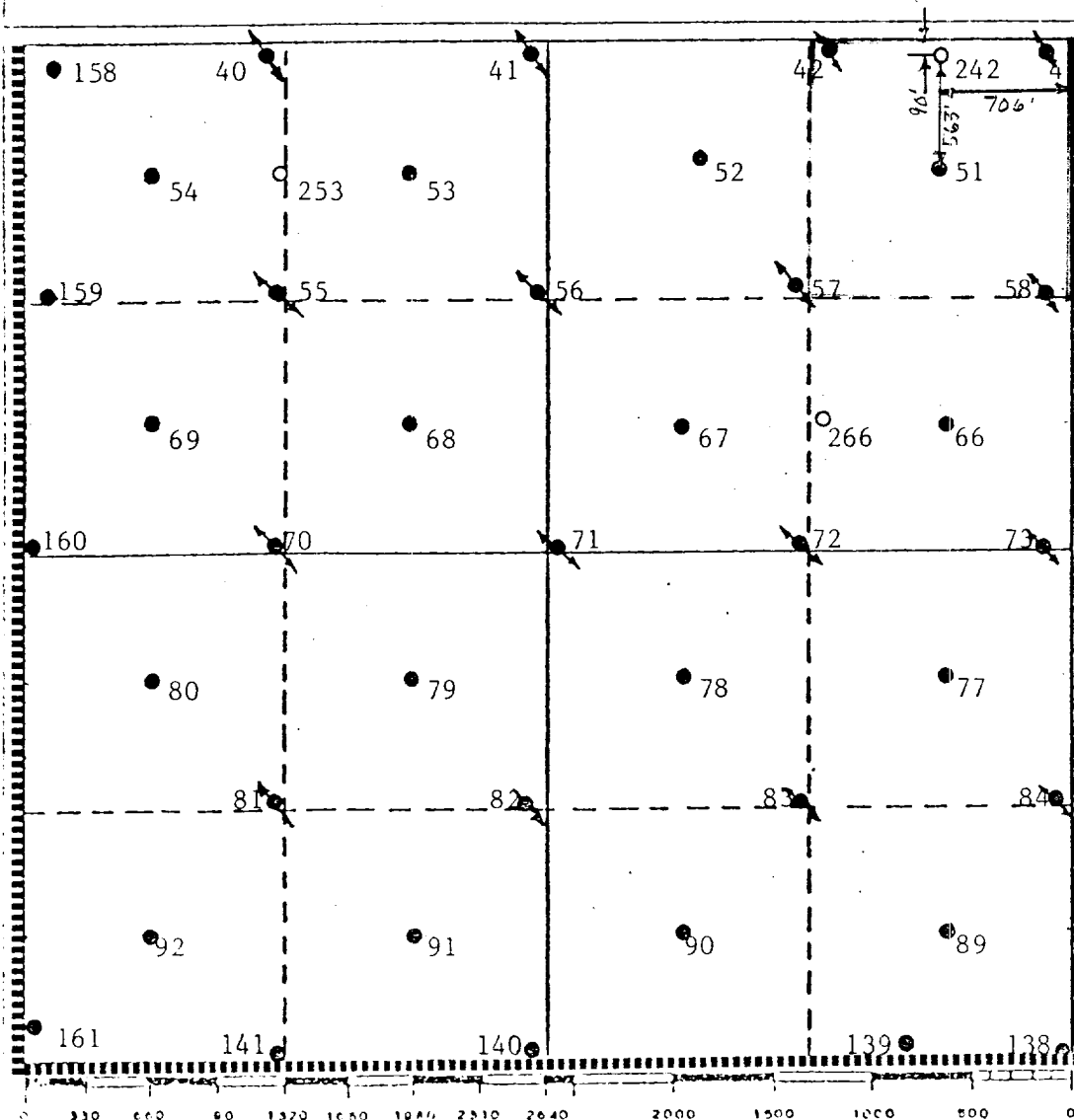

CERTIFICATION

I hereby certify that the information contained herein is true and complete to the best of my knowledge and belief.

B. L. Eiland

Name

B. L. Eiland

Position

Division Surveyor

Company

Texaco Producing Inc.

Date

July 2, 1987

I hereby certify that the well location shown on this plot was plotted from field notes of actual surveys made by me or under my supervision, and that the same is true and correct to the best of my knowledge and belief.

Date Surveyed

June 15, 1987

Registered Professional Engineer and/or Land Surveyor

B. L. Eiland

Certification No. 4388

DRILLING CONTROL
CONDITION II-B 3000 WP
FOR AIR DRILLING OR
WHERE YATES AIR BLOWS ARE EXPECTED

H₂S TRIM REQUIRED

YES _____ NO _____

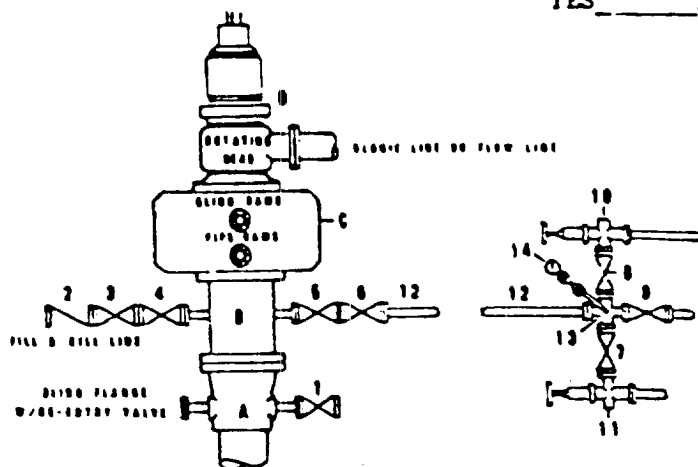

DRILLING CONTROL

MATERIAL LIST - CONDITION II - B
FOR AIR DRILLING

- | | |
|---------------|---|
| A | Texaco Wellhead |
| B | 3000# W.P. drilling spool with a 2" minimum flanged outlet for kill-line and 3" minimum flanged outlet for choke line |
| C | 3000# W.P. Dual ram type preventer, hydraulic operated with 1" steel, 3000# W.P. control lines (where sub-structure height is adequate, 2-3000# W.P. single ram type preventers may be utilized.) |
| D | Rotating Head and extended Electric Line. |
| 1,3,4,
7,8 | 2" minimum 3000# W.P. flanged full opening steel gate valve, or Halliburton Lo Torc Plug valve. |
| 2 | 2" minimum 3000# W.P. back pressure valve |
| 5,6,9 | 3" minimum 3000# W.P. flanged full opening steel gate valve, or Halliburton Lo Torc Plug valve. |
| 12 | 3" minimum schedule 80, Grade "B", seamless line pipe |
| 13 | 2" minimum x 3" minimum 3000# W.P. flanged cross |
| 10, 11 | 2" minimum 3000# W.P. adjustable choke bodies |
| 14 | Cameron Mud Gauge or equivalent (location optional in choke line.) |



TEXACO, INC.
 MIDLAND DIVISION
 MIDLAND, TEXAS



SCALE	DATE	EST NO	DRG NO
DRAWN BY			
CHECKED BY			
APPROVED BY			

EXHIBIT C

RECEIVED
OCT 13 1987
OCD
HOBBS OFFICE

173