

Permit Expires 6 Months From Approval
Date Unless Bridging Underway.

OIL CONSERVATION DIVISION

P. O. BOX 2088

STATE OF NEW MEXICO
ENERGY AND MINERALS DEPARTMENT

SANTA FE, NEW MEXICO 87501

Form C-102
Revised 10-1-78

All distances must be from the outer boundaries of the Section.

| | | | | | |
|---|--------------------------------------|---------------------|-------------------------------------|---------------|----------------------------------|
| Operator Mobil Exploration & Producing U.S., Inc. | | | Lease Lovington Deep Amoco State | | Well No. 3 |
| Unit Letter N | Section 6 | Township 17South | Range 36 East | County Lea | |
| Actual Footage Location of Well: 1745 feet from the West line and 730 feet from the South line | | | | | |
| Ground Level Elev. 3917 | Producing Formation Pennsylvanian | | Pool South Shoe Bar | | Dedicated Acreage: 76.8 Acres |

1. Outline the acreage dedicated to the subject well by colored pencil or hachure marks on the plat below.
2. If more than one lease is dedicated to the well, outline each and identify the ownership thereof (both as to working interest and royalty).
3. If more than one lease of different ownership is dedicated to the well, have the interests of all owners been consolidated by communitization, unitization, force-pooling, etc?

☐ Yes ☐ No If answer is "yes," type of consolidation _____

If answer is "no," list the owners and tract descriptions which have actually been consolidated. (Use reverse side of this form if necessary.) _____

No allowable will be assigned to the well until all interests have been consolidated (by communitization, unitization, forced-pooling, or otherwise) or until a non-standard unit, eliminating such interests, has been approved by the Division.

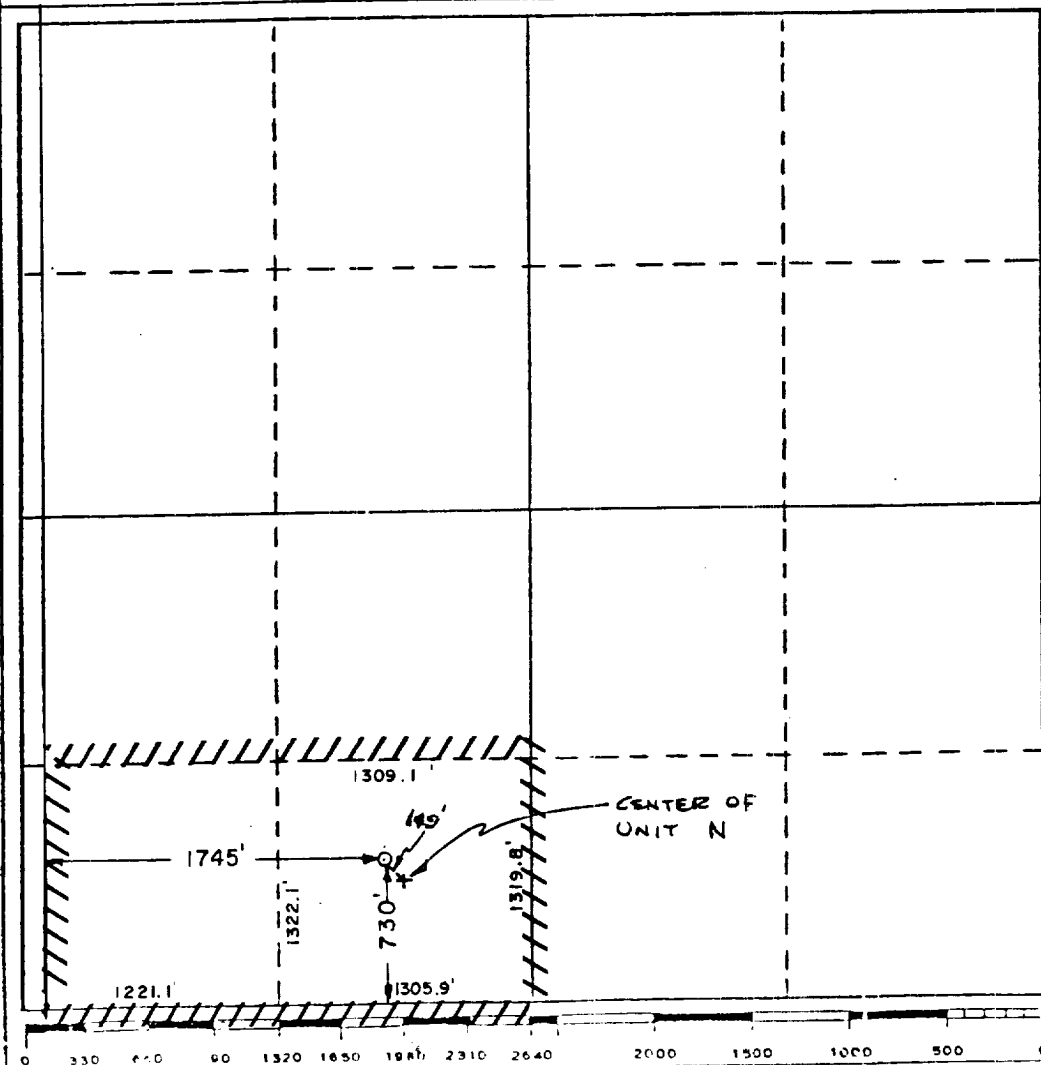

CERTIFICATION

I hereby certify that the information contained herein is true and complete to the best of my knowledge and belief.

Name

M. E. Sweeney

Position

Environmental & Regulatory Mgr.

Company

Mobil Producing Texas & New Mexico Inc.
c/o Mobil Exploration & Producing
U.S. Inc.

7-28-88

I hereby certify that the well location shown on this plat was plotted from field notes of actual surveys made by me or under my supervision, and that the same is true and correct to the best of my knowledge and belief.

Date Surveyed

November 6, 1987

Registered Professional Engineer
and/or Land Surveyor

Certificate No.

5109