

30-025-30207

NO. OF COPIES RECEIVED	
DISTRIBUTION	
SANTA FE	
FILE	
U.S.G.S.	
LAND OFFICE	
OPERATOR	

NEW MEXICO OIL CONSERVATION COMMISSION

Form C-101  
Revised 1-1-65

5A. Indicate Type of Lease STATE <input checked="" type="checkbox"/> FEE <input type="checkbox"/>
5. State Oil & Gas Lease No. B-1527
7. Unit Agreement Name
8. Farm or Lease Name North Vacuum Abo East Unit
9. Well No. 23
10. Field and Pool, or Wildcat Vacuum, North Abo
12. County Lea
19. Proposed Depth 9000'
19A. Formation Abo
20. Rotary or C.T. Rotary
21. Elevations (Show whether DF, RT, etc.) 4011 GL
21A. Kind & Status Plug. Bond Blanket on File
21B. Drilling Contractor Unknown
22. Approx. Date Work will start Feb. 15, 1988

APPLICATION FOR PERMIT TO DRILL, DEEPEN, OR PLUG BACK

1a. Type of Work

b. Type of Well DRILL ☒ DEEPEN ☐ PLUG BACK ☐  
OIL WELL ☒ GAS WELL ☐ OTHER ☐ SINGLE ZONE ☒ MULTIPLE ZONE ☐

2. Name of Operator

Mobil Producing TX. & N.M. Inc.  
c/o Mobil Exploration & Producing U.S. Inc.  
P. O. Box 633, Midland, Texas 79702

4. Location of Well

UNIT LETTER N LOCATED 1359 FEET FROM THE West LINE

AND 660 FEET FROM THE South LINE OF SEC. 7 TWP. 17-S RGE. 35-E NMPM

21. Elevations (Show whether DF, RT, etc.)

21A. Kind & Status Plug. Bond

21B. Drilling Contractor

22. Approx. Date Work will start

PROPOSED CASING AND CEMENT PROGRAM

SIZE OF HOLE	SIZE OF CASING	WEIGHT PER FOOT	SETTING DEPTH	SACKS OF CEMENT	EST. TOP
17½	13-3/8	48#	0-400'	400 sx.	Surface
12½	8-5/8	28 & 32#	0-4800'	3000 sx.	Surface
7-7/8	5½	15.5 & 17#	0-9000'	1000 sx.	Surface

BLOWOUT PREVENTER PROGRAM

See Attached

IN ABOVE SPACE DESCRIBE PROPOSED PROGRAM: IF PROPOSAL IS TO DEEPEN OR PLUG BACK, GIVE DATA ON PRESENT PRODUCTIVE ZONE AND PROPOSED NEW PRODUCTIVE ZONE. GIVE BLOWOUT PREVENTER PROGRAM, IF ANY.

I hereby certify that the information above is true and complete to the best of my knowledge and belief.

Signed M. E. Sweeney M. E. Sweeney Title Manager Environmental and Regulatory Date 1-18-88

(This space for State Use)

Orig. Signed by  
Paul Kautz

Mobil Producing Texas & New Mexico Inc.  
acting by and through its agent  
Mobil Exploration & Producing U.S. Inc.

APPROVED BY

Geologist

TITLE

DATE

FEB 1 - 1988

CONDITIONS OF APPROVAL, IF ANY:

NSL 2461

Permit Expires 6 Months From Approval  
Date Unless Drilling Underway.

RECEIVED  
JAN 21 1988  
OCD  
HOBBS OFFICE

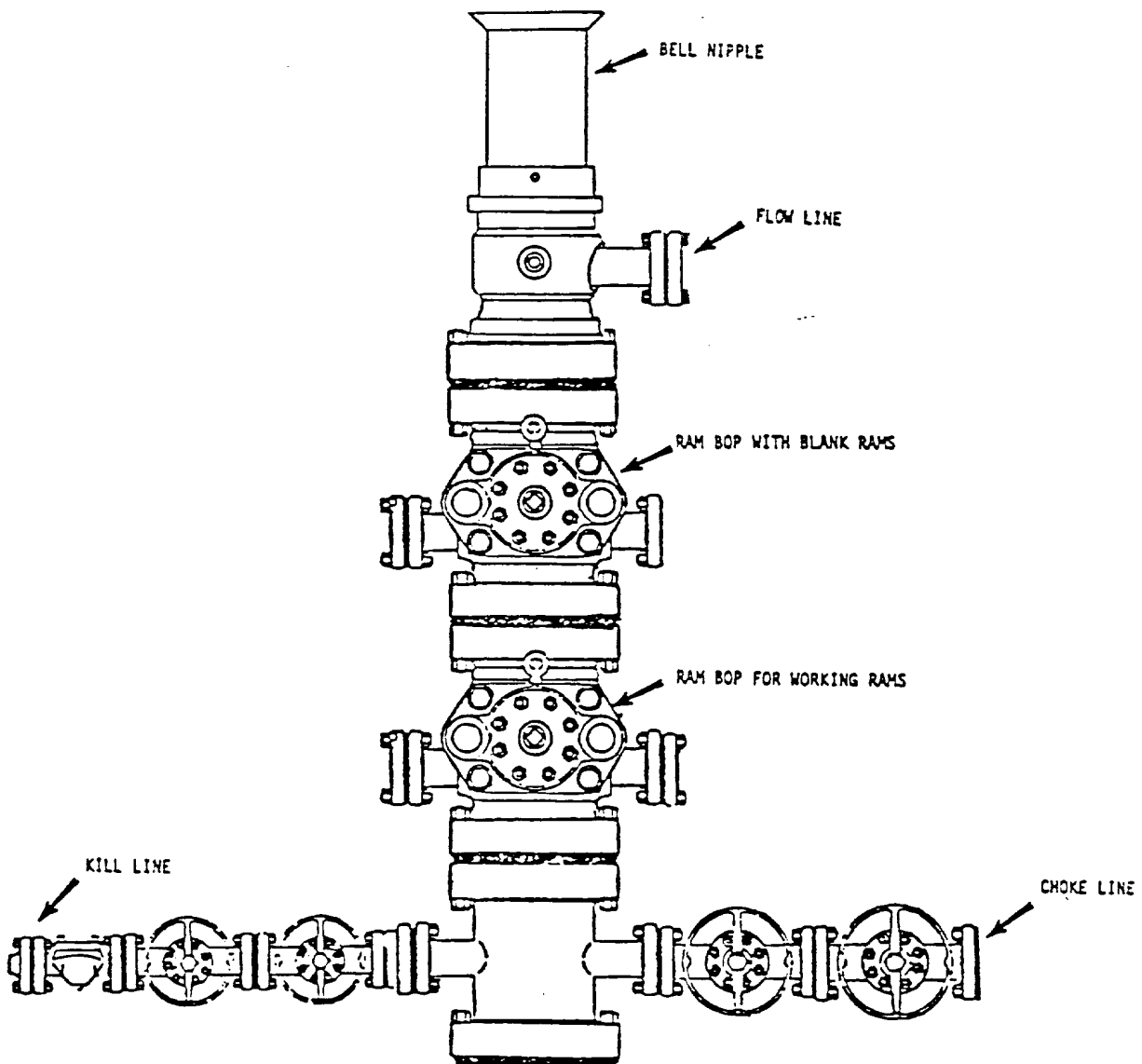

BOP rams will be actuated on each trip of drill pipe and will be tested before drilling the plug on each casing string.

\*NOTE: ALL VALVES ARE METAL-TO-METAL SEAL AND FLANGED. ALL COMPONENTS MUST MEET ABOVE MINIMUM PRESSURE RATINGS. ALL COMPONENTS TO BE TESTED TO RATED PRESSURE AFTER ASSEMBLY AND BEFORE FURTHER DOWNHOLE OPERATIONS MAY BE CONDUCTED.

**Mobil Producing  
Texas & New Mexico Inc.**  
Houston, Texas

North Vacuum Abo  
MOBIL NO. 23 East Unit  
(LEASE)  
Lea COUNTY, New Mexico STATE

BLOWOUT PREVENTER ASSEMBLY  
11 IN. 5000 PSI WPS)

Scale

Date  
Drawn  
Checked  
Approved  
Revised

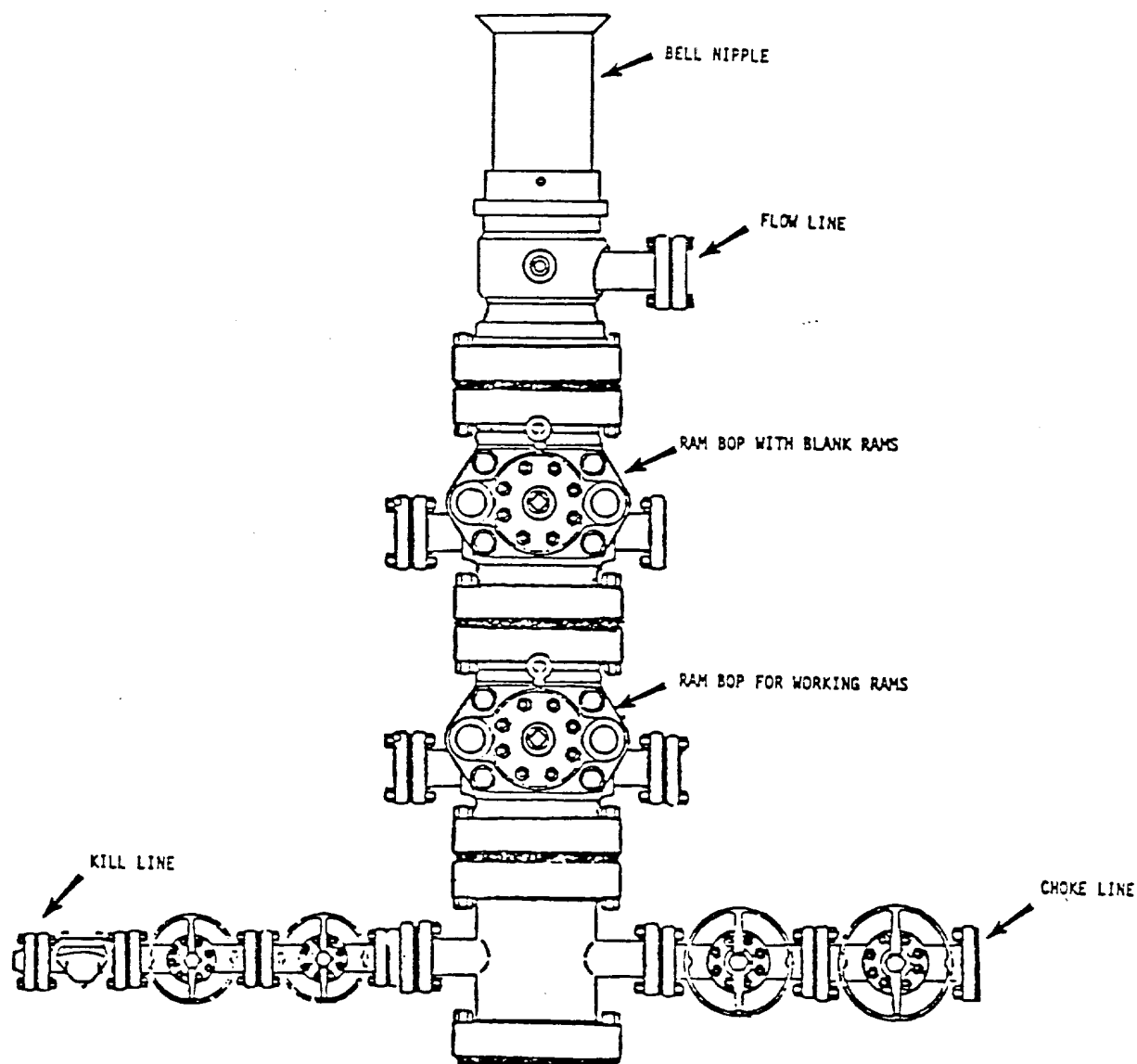

BOP rams will be actuated on each trip of drill pipe and will be tested before drilling the plug on each casing string.

\*NOTE: ALL VALVES ARE METAL-TO-METAL SEAL AND FLANGED. ALL COMPONENTS MUST MEET ABOVE MINIMUM PRESSURE RATINGS. ALL COMPONENTS TO BE TESTED TO RATED PRESSURE AFTER ASSEMBLY AND BEFORE FURTHER DOWNHOLE OPERATIONS MAY BE CONDUCTED.

**Mobil Producing  
Texas & New Mexico Inc.**  
Houston, Texas

MOBIL NO. 23 North Vacuum Abo  
East Unit  
(LEASE)  
Lea COUNTY, New Mexico STATE

BLOWOUT PREVENTER ASSEMBLY  
13-5/8 IN. 3000 PSI WP\*)

Seals

Date  
Drawn  
Checked  
Approved  
Revised

All distances must be from the outer boundaries of the Section.

Operator MOBIL EXPLORATION AND PRODUCING U.S.			Lease NORTH VACUUM ABO EAST UNIT		Well No. 23
Unit Letter N	Section 7	Township 17-S	Range 35-E	County LEA	
Actual Postage Location of Well:					
feet from the Ground Level Elev.		line and Producing Formation Abo		feet from the line Pool Vacuum, North	
				Dedicated Acreage: 2 Wells - 80 Acres	

1. Outline the acreage dedicated to the subject well by colored pencil or hatchure marks on the plat below.
2. If more than one lease is dedicated to the well, outline each and identify the ownership thereof (both as to working interest and royalty).
3. If more than one lease of different ownership is dedicated to the well, have the interests of all owners been consolidated by communitization, unitization, force-pooling, etc?

☐ Yes ☐ No If answer is "yes," type of consolidation \_\_\_\_\_

If answer is "no," list the owners and tract descriptions which have actually been consolidated. (Use reverse side of this form if necessary.) \_\_\_\_\_

No allowable will be assigned to the well until all interests have been consolidated (by communitization, unitization, forced-pooling, or otherwise) or until a non-standard unit, eliminating such interests, has been approved by the Division.

All wells in the quarter - quarter are operated by Mobil Producing Texas & New Mexico Inc.

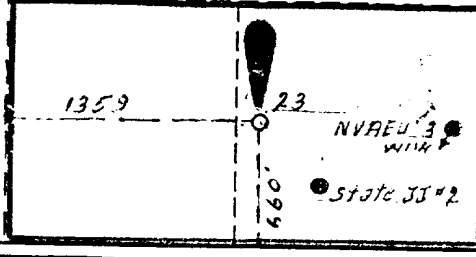
Actual Lease Line for Irregular section	T-17-S		R-35-E		7
					
0 330 660 990 1320 1650 1980 2310 2640 2000 1500 1000 500 0					

**CERTIFICATION**

I hereby certify that the information contained herein is true and complete to the best of my knowledge and belief.

*M. E. Sweeney* M. E. Sweeney  
Name  
Environmental & Regulatory Mgr.  
Position  
Mobil Producing Tx. & N.M. Inc.  
Company c/o Mobil Exploration and Producing U.S. Inc.  
Date  
1-18-88

I hereby certify that the well location shown on this plat was plotted from field notes of actual surveys made by me or under my supervision, and that the same is true and correct to the best of my knowledge and belief.

Date Surveyed  
January 11, 1988  
Registered Professional Engineer and/or Land Surveyor  
*H. A. Carlson*  
Certificate No.  
5063

RECEIVED  
JAN 21 1988  
OCD  
HOBBS OFFICE

THIS DRAWING AND ALL INFORMATION THEREON IS THE PROPERTY OF MOBIL PRODUCING TEXAS & NEW MEXICO INC. AND SHALL NOT BE COPIED OR USED EXCEPT FOR THE PURPOSE FOR WHICH IT IS EXPRESSLY FURNISHED. THE DRAWING AND ANY COPIES THEREON (PARTIAL OR COMPLETE) SHALL BE RETURNED TO THE OWNER ON DEMAND.

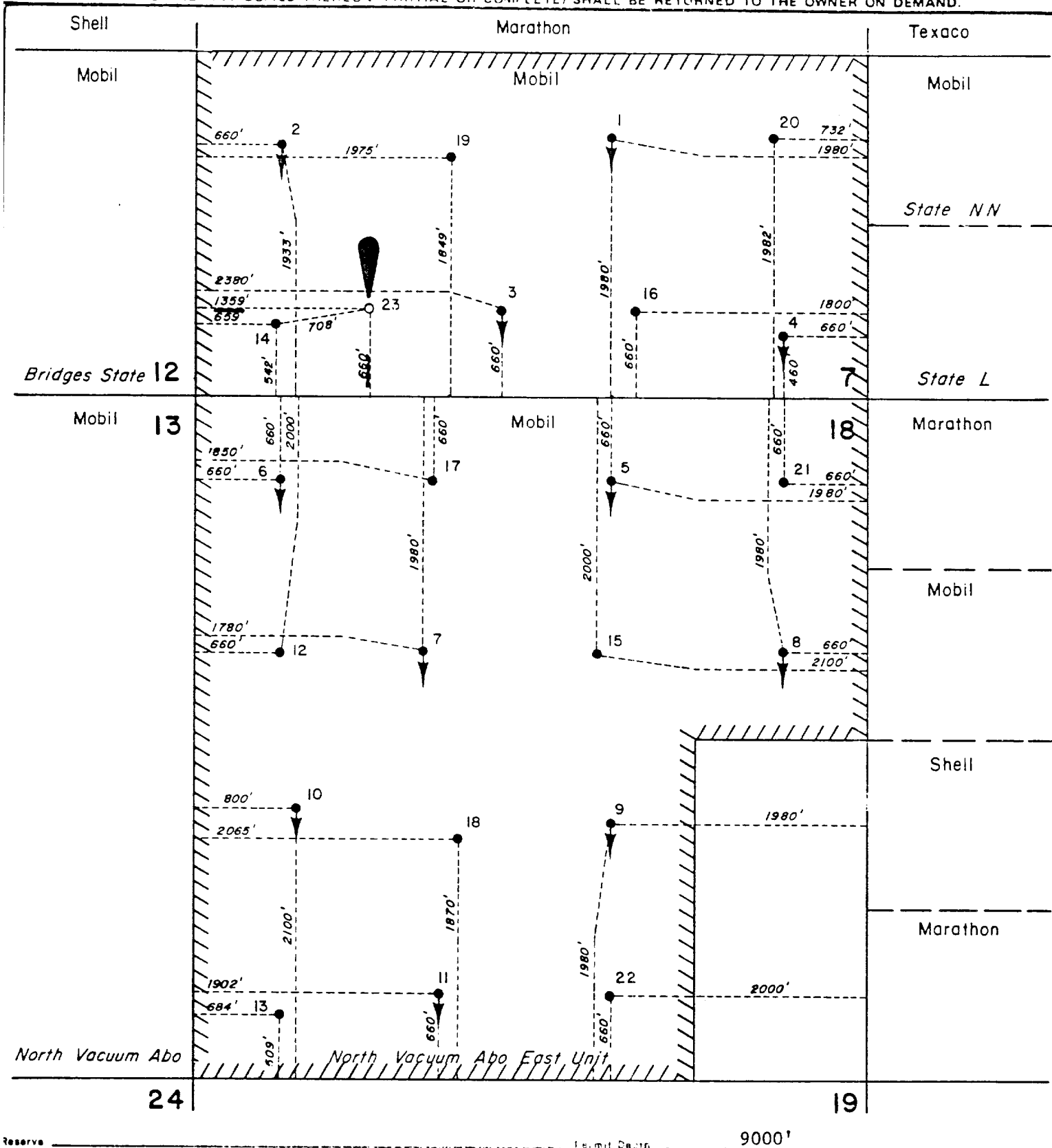

THE STATE OF TEXAS  
COUNTY OF Midland

I hereby certify that this plat truly represents conditions as they actually exist on this lease, that said plat which is drawn to the scale indicated hereon, is to the best of my knowledge true and correct, that it accurately shows said lease with all wells on same, that number and locations of said wells are as indicated hereon; and that this plat correctly reflects all pertinent and required data.

### Mobil Producing Texas & New Mexico Inc. Midland Division

LEASE North Vacuum Abo East Unit

WELL NO. 23 DATE 1-19 19 87

LEASE NO.

TOTAL ACRES IN LEASE 865.74 ACRES COVERED BY PLAT 865.74

DESCRIPTION S 1/2 of Sec. 7 and all of Sec. 18 less the SE 1/2 of the SE quarter, T-17-S, R-35-E

3 miles North of Buckeye

Lea County, N.M.

DRAWN A L W

DATE 1-15-88

FIELD Vacuum, North

SCALE 1"=1000'

FILE NO. 10

(Abo)

RECEIVED  
JAN 21 1988  
OCD  
HOBBS OFFICE

88-0158-204  
177