

STATE OF NEW MEXICO  
ENERGY AND MINERALS DEPARTMENT

C.L. CONSERVATION DIVISION  
P. O. BOX 2088  
SANTA FE, NEW MEXICO 87501

30-025-30367

Form C-101  
Revised 10-1-78

NO. OF COPIES RECEIVED	
DISTRIBUTION	
SANTA FE	
FILE	
U.S.G.S.	
LAND OFFICE	
OPERATOR	

5A. Indicate Type of Lease  
STATE ☐ FEE ☒  
5. State Oil & Gas Lease No.

APPLICATION FOR PERMIT TO DRILL, DEEPEN, OR PLUG BACK

1a. Type of Work DRILL <input checked="" type="checkbox"/> DEEPEN <input type="checkbox"/> PLUG BACK <input type="checkbox"/>			7. Unit Agreement Name
b. Type of Well OIL WELL <input checked="" type="checkbox"/> GAS WELL <input type="checkbox"/> OTHER <input type="checkbox"/> SINGLE ZONE <input checked="" type="checkbox"/> MULTIPLE ZONE <input type="checkbox"/>			8. Farm or Lease Name PENRON-BYERS
2. Name of Operator TXO PRODUCTION CORP.			9. Well No. 1
3. Address of Operator 900 WILCO BUILDING <i>Midland, TX 79701</i>			10. Field and Pool, or Wildcat SHIPP STRAWN
4. Location of Well UNIT LETTER <u>P</u> LOCATED <u>810</u> FEET FROM THE <u>SOUTH</u> LINE AND <u>660</u> FEET FROM THE <u>EAST</u> LINE OF SEC. <u>3</u> TWP. <u>17-S</u> RGE. <u>37-E</u> NMPM			12. County LEA
19. Proposed Depth 11,750		19A. Formation STRAWN	20. Rotary or C.T. ROTARY
21. Elevations (Show whether DF, RT, etc.) 3762.8' GL	21A. Kind & Status Plug. Bond BLANKET	21B. Drilling Contractor NOT SELECTED	22. Approx. Date Work will start UPON APPROVAL

PROPOSED CASING AND CEMENT PROGRAM

SIZE OF HOLE	SIZE OF CASING	WEIGHT PER FOOT	SETTING DEPTH	SACKS OF CEMENT	EST. TOP
15"	11-3/4"	42#	400'	310	SURFACE
11"	8-5/8"	24# & 28#	4200'	1750	SURFACE
7-7/8"	5-1/2"	17#	11,750'	450	9500'

SEE ATTACHED FOR BOP SKETCH.

ABOVE SPACE DESCRIBE PROPOSED PROGRAM: IF PROPOSAL IS TO DEEPEN OR PLUG BACK, GIVE DATA ON PRESENT PRODUCTIVE ZONE AND PROPOSED NEW PRODUCTION ZONE. GIVE BLOWOUT PREVENTER PROGRAM, IF ANY.

I hereby certify that the information above is true and complete to the best of my knowledge and belief.

Signed Arthur R. Brown Title Agent Date APRIL 29, 1988  
(This space for State Use)

ORIGINAL SIGNED BY JERRY SEXTON  
APPROVED BY DISTRICT SUPERVISOR TITLE DATE APR 29 1988  
CONDITIONS OF APPROVAL, IF ANY:

Permit Expires 6 Months From Approval  
Date Unless Drilling Underway.

NEW MEXICO OIL CONSERVATION COMMISSION  
WELL LOCATION AND ACREAGE DEDICATION PLAT

Form C-102  
Supersedes C-124  
Effective 1-1-65

All distances must be from the outer boundaries of the Section

Operator TXO Production Company			Lease Penron Byers			Well No. 1
Unit Letter P	Section 3	Township 17 South	Range 37 East	County Lea		
Actual Footage Location of Well: 310 feet from the south line and 660 feet from the east line						
Ground Level Elev. 3762.8	Producing Formation STRAWN		Pool SHIPP STRAWN		Dedicated Acreage: 80 Acres	

1. Outline the acreage dedicated to the subject well by colored pencil or hachure marks on the plat below.
2. If more than one lease is dedicated to the well, outline each and identify the ownership thereof (both as to working interest and royalty).
3. If more than one lease of different ownership is dedicated to the well, have the interests of all owners been consolidated by communitization, unitization, force-pooling, etc?

☐ Yes ☐ No If answer is "yes," type of consolidation \_\_\_\_\_

If answer is "no," list the owners and tract descriptions which have actually been consolidated (Use reverse side of this form if necessary.) \_\_\_\_\_

No allowable will be assigned to the well until all interests have been consolidated (by communitization, unitization, forced-pooling, or otherwise) or until a non-standard unit, eliminating such interests, has been approved by the Commission.

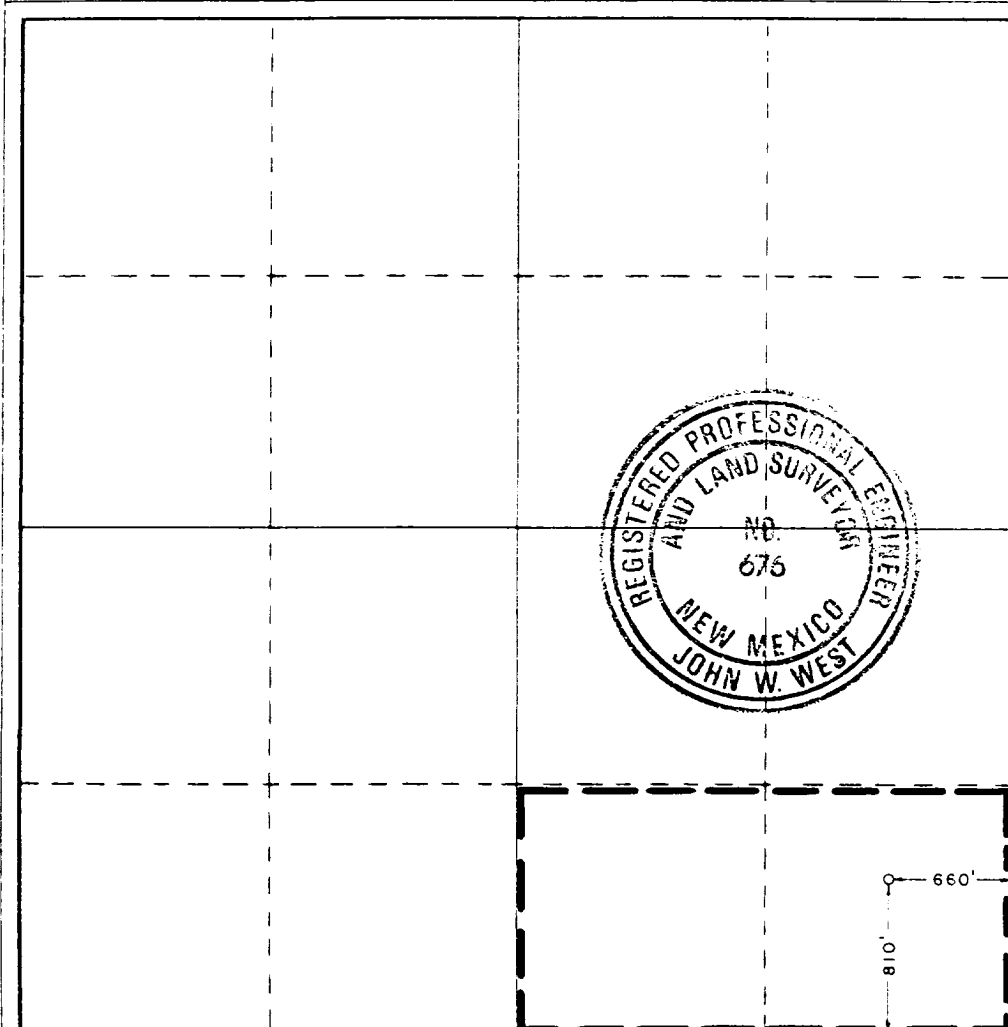

CERTIFICATION

I hereby certify that the information contained herein is true and complete to the best of my knowledge and belief.

*Arthur R. Brown*  
Arthur R. Brown

Position  
Agent

Company  
TXO PRODUCTION CORP.

Date  
APRIL 29, 1988

I hereby certify that the well location shown on this plat was plotted from field notes of actual surveys made by me or under my supervision, and that the same is true and correct to the best of my knowledge and belief.

Date Surveyed  
April 29, 1988

Registered Professional Engineer and/or Land Surveyor

*John W. West*

Certificate No. JOHN W. WEST, 676  
RONALD J. EIDSON, 3239

RECEIVED  
APR 29 1993  
OCD  
HOBBS OFFICE

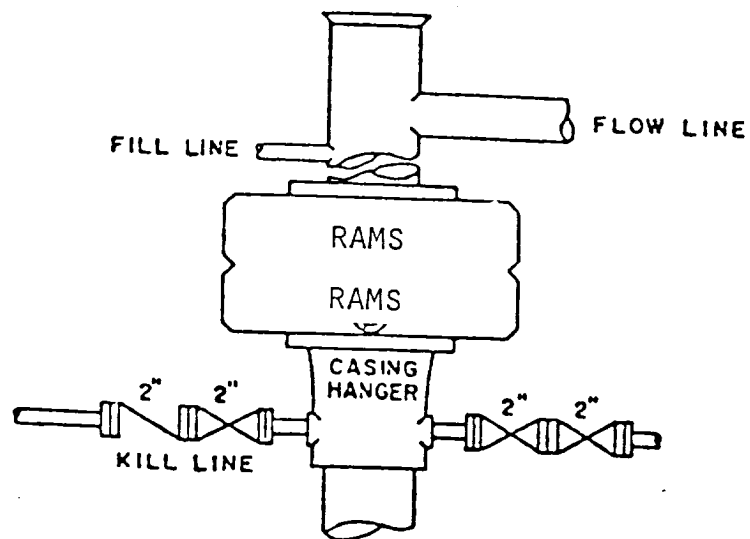

BOP STACK

3000 PSI WORKING PRESSURE

BOP ARRANGEMENT

Recd 9.15.88

111