

NE EXICO OIL CONSERVATION COMMISSION
WELL LOCATION AND ACREAGE DEDICATION PLAT

Form C-102
Supersedes C-128
Effective 1-1-65

All distances must be from the outer boundaries of the Section

Operator Hanley Petroleum, Inc.			Lease SHIPP			Well No. 1		
Tract Letter M	Section 10	Township 17 South		Range 37 East	County Lea			
Actual Footage Location of Well: 990 feet from the South line and 330 feet from the West line								
Ground Level Elev. 3761.5	Producing Formation STRAWN		Pool SHIPP STRAWN			Dedicated Acreage: 80 Acres		

1. Outline the acreage dedicated to the subject well by colored pencil or hachure marks on the plat below.
2. If more than one lease is dedicated to the well, outline each and identify the ownership thereof (both as to working interest and royalty).
3. If more than one lease of different ownership is dedicated to the well, have the interests of all owners been consolidated by communitization, unitization, force-pooling, etc?

☐ Yes ☐ No If answer is "yes," type of consolidation _____

If answer is "no," list the owners and tract descriptions which have actually been consolidated. (Use reverse side of this form if necessary.) _____

No allowable will be assigned to the well until all interests have been consolidated (by communitization, unitization, forced-pooling, or otherwise) or until a non-standard unit, eliminating such interests, has been approved by the Commission.

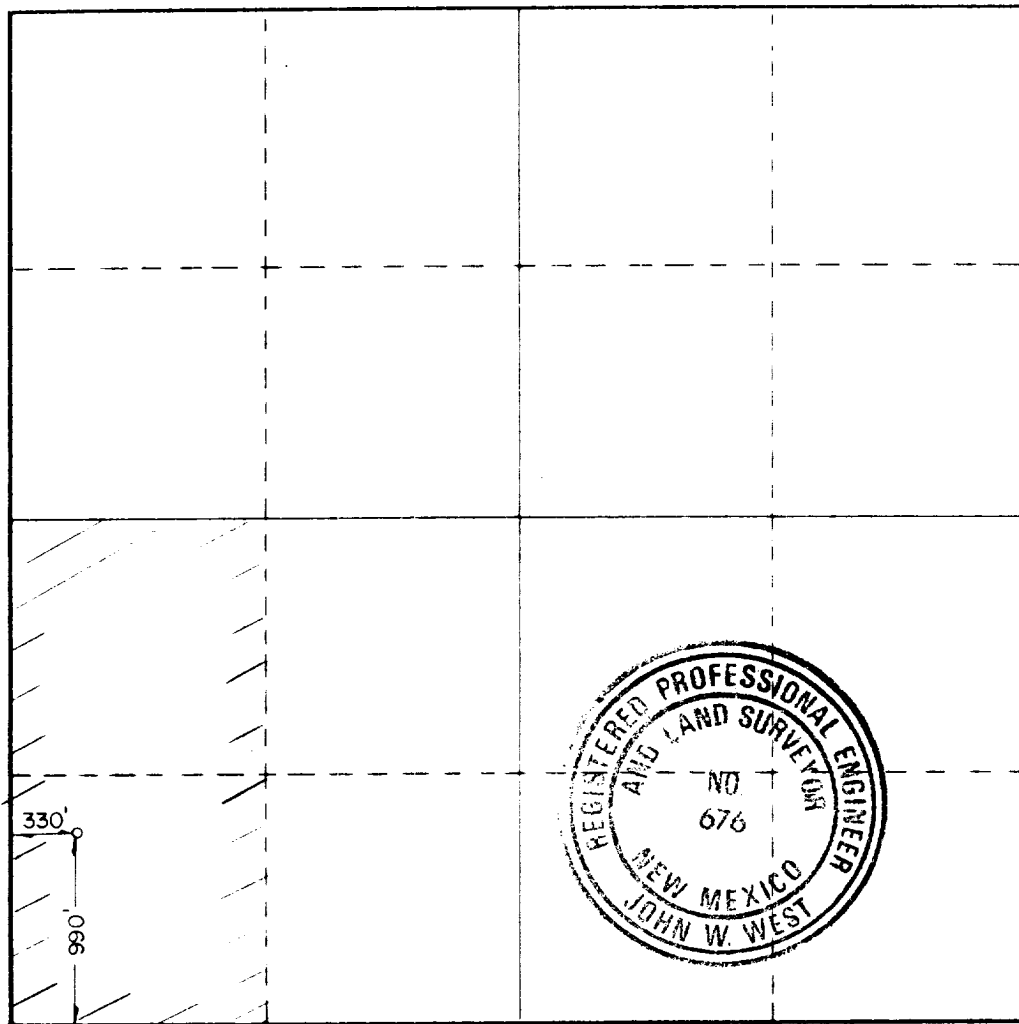

CERTIFICATION

I hereby certify that the information contained herein is true and complete to the best of my knowledge and belief.

Name
William K. Goss
Position
AGENT
Company
HANLEY PETROLEUM COMPANY
Date
MAY 17, 1988

I hereby certify that the well location shown on this plat was plotted from field notes of actual surveys made by me or under my supervision, and that the same is true and correct to the best of my knowledge and belief.

Date Surveyed
May 17, 1988
Registered Professional Engineer and/or Land Surveyor
John W. West
Certificate No. JOHN W. WEST, 676
RONALD J. EIDSON, 3239

ELF
ABOVE DATE DOES NOT
INDICATE WHEN NOT
CONFIDENTIAL/HOBS
WILL BE RELEASED
WILL BE RELEASED

3/5/03

Rec'd 7-21-88

ELF

RECEIVED
MAY 20 1988
OCD
HOBBS OFFICE