

30-02530476

STATE OF NEW MEXICO  
ENERGY AND MINERALS DEPARTMENTOIL CONSERVATION DIVISION  
P. O. BOX 2088  
SANTA FE, NEW MEXICO 87501Form C-101  
Revised 10-1-78

NO. OF COPIES RECEIVED	
DISTRIBUTION	
SANTA FE	
FILE	
U.S.G.S.	
LAND OFFICE	
OPERATOR	

5A. Indicate Type of Lease	
STATE <input checked="" type="checkbox"/>	FEE <input type="checkbox"/>
5. State Oil & Gas Lease No.	
B-155	

## APPLICATION FOR PERMIT TO DRILL, DEEPEN, OR PLUG BACK

1a. Type of Work		7. Unit Agreement Name	
b. Type of Well OIL WELL <input checked="" type="checkbox"/> GAS WELL <input type="checkbox"/> OTHER <input type="checkbox"/>		8. Farm or Lease Name New Mexico "O" St. NCT-1	
2. Name of Operator Texaco Producing Inc.		9. Well No. 29	
3. Address of Operator P. O. Box 723, Hobbs, New Mexico 88240		10. Field and Pool, or Wildcat Vacuum Glorieta	
4. Location of Well UNIT LETTER <u>N</u> LOCATED <u>990</u> FEET FROM THE <u>South</u> LINE AND <u>2310</u> FEET FROM THE <u>West</u> LINE OF SEC. <u>36</u> TWP. <u>17-S</u> RGE. <u>34-E</u> NMPM		12. County Lea	
11. Elevations (Show whether DF, RT, etc.) 3984 GR		19. Proposed Depth 6270'	
21A. Kind & Status Plug. Bond Blanket		19A. Formation Glorieta	
21B. Drilling Contractor		20. Rotary or C.T. Rotary	
22. Approx. Date Work will start			

## PROPOSED CASING AND CEMENT PROGRAM

SIZE OF HOLE	SIZE OF CASING	WEIGHT PER FOOT	SETTING DEPTH	SACKS OF CEMENT	EST. TOP
28"	24"	125.5#	40'	Redimix	Surface
20"	16"	65#	400'	600	Circulate
15"	11-3/4"	42#	1550'	1250	Surface
11"	8-5/8"	32#	4850'	1500	Surface
7-7/8"	5-1/2"	15.5#	6270'	350	Surface

## CASING PROGRAM

SURFACE CASING: 600 sacks Class "H" w/2% CaCl & 1/4# Flocele (15.6 ppg, 1.18 cu. ft./sx., 5.2 gallons water/sack).

INTERMEDIATE CASING: 1250 sacks Class "H" & 2% CaCl & 1/4# Flocele (15.6 ppg, 1.18 cu. ft./sx, 5.2 gallons water/sack).

INTERMEDIATE CASING: 1st Stage: 1000 sacks Class "H" & 18% Salt (15.9 ppg, 1.22 cu. ft./sx, 5.2 gallons water/sack) plus 200 sacks Class "H" (15.9 ppg, 1.22 cu. ft./sx., 4.8 gallons water/sack)

2nd Stage: 300 sacks Class "H" & 2% CaCl (15.6 ppg, 1.13 cu. ft./sx., 5.2 gallons water/sack). DV Tool @ 1555'. ECP @ 1560'.

PRODUCTION CASING: 1st Stage: 150 sacks "H" Lightweight & 1/4# Flocele (12.7 ppg, 1.84 cu. ft./sx., 9.9 gallons water/sack) & 200 sacks "H" & 1/4# Flocele (15.6 ppg, 1.18 cu. ft./sx., 5.2 gallons water/sack).

OVER:

IN ABOVE SPACE DESCRIBE PROPOSED PROGRAM; IF PROPOSAL IS TO DEEPEN OR PLUG BACK, GIVE DATA ON PRESENT PRODUCTIVE ZONE AND PROPOSED NEW PRODUCTION ZONE. GIVE BLOWOUT PREVENTER PROGRAM, IF ANY.

I hereby certify that the information above is true and complete to the best of my knowledge and belief.

Signed W. B. Cade Title District Operations Manager Date 9/22/88(This space for Original Signed by)  
Paul Kautz  
GeologistAPPROVED BY \_\_\_\_\_ TITLE \_\_\_\_\_ DATE SEP 23 1988

CONDITIONS OF APPROVAL, IF ANY:

Permit Expires 6 Months From Approval  
Date Unless Drilling Underway.

**NEW MEXICO OIL CONSERVATION COMMISSION  
WELL LOCATION AND ACREAGE DEDICATION PLAT**

Form C-102  
Supersedes C-128  
Effective 1-4-65

All distances must be from the outer boundaries of the Section.

Operator <b>TEXACO PRODUCING INC.</b>			Lease <b>New Mexico "0" State NCT-1</b>		Well No. <b>29</b>
Unit Letter <b>N</b>	Section <b>36</b>	Township <b>17 South</b>	Range <b>34 East</b>	County <b>Lea</b>	
Actual Footage Location of Well: <div style="display: flex; justify-content: space-between;"> <span>990 feet from the <b>South</b> line and</span> <span>2310 feet from the <b>West</b> line</span> </div>					
Ground Level Elev. <b>3984'</b>	Producing Formation <b>Glorieta (Paddock)</b>	Pool <b>Vacuum Glorieta</b>	Dedicated Acreage: <b>40 Acres</b>		

1. Outline the acreage dedicated to the subject well by colored pencil or hachure marks on the plat below.
2. If more than one lease is dedicated to the well, outline each and identify the ownership thereof (both as to working interest and royalty).
3. If more than one lease of different ownership is dedicated to the well, have the interests of all owners been consolidated by communitization, unitization, force-pooling, etc?

☐ Yes   ☐ No   If answer is "yes," type of consolidation \_\_\_\_\_

If answer is "no," list the owners and tract descriptions which have actually been consolidated. (Use reverse side of this form if necessary.) \_\_\_\_\_

No allowable will be assigned to the well until all interests have been consolidated (by communitization, unitization, forced-pooling, or otherwise) or until a non-standard unit, eliminating such interests, has been approved by the Commission.

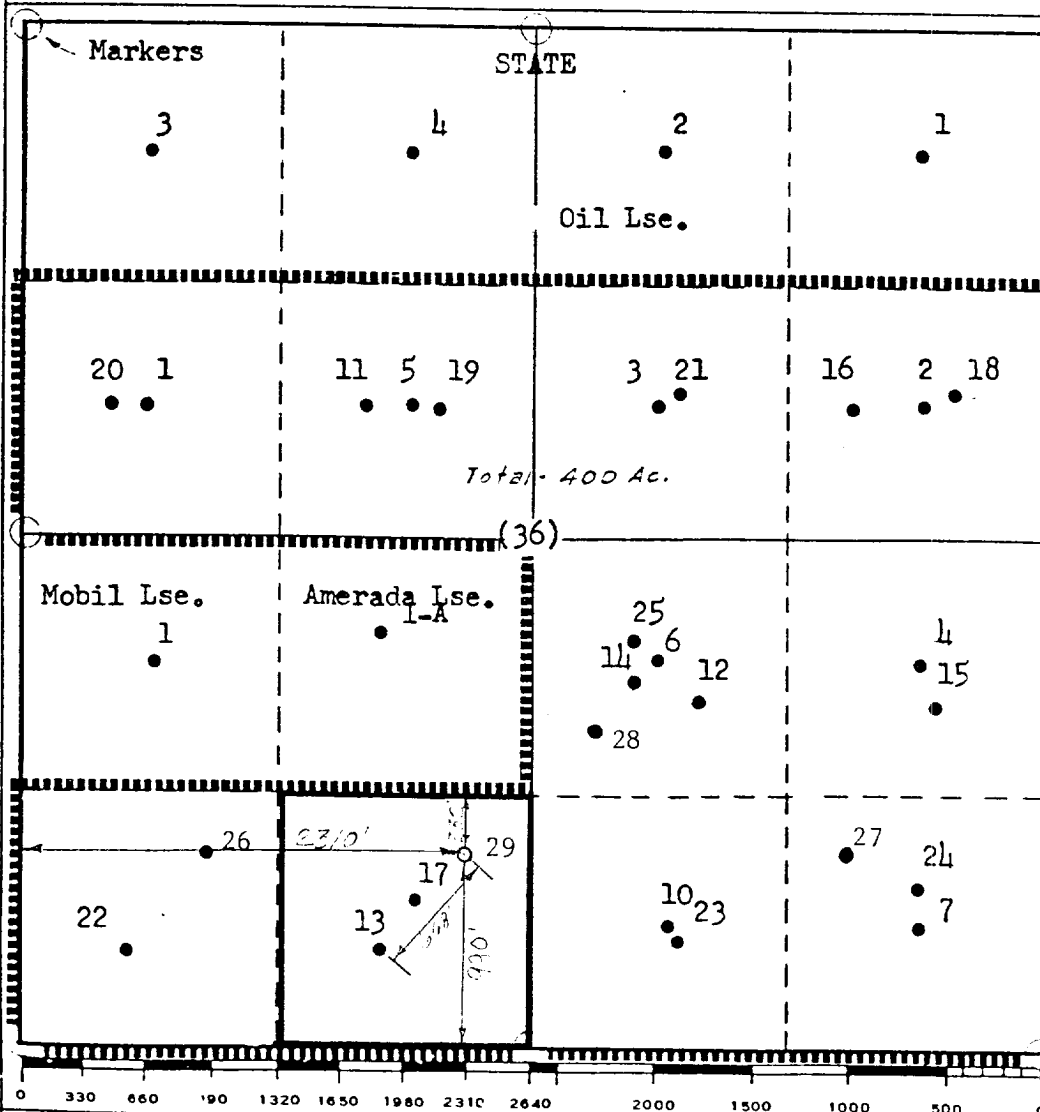

**CERTIFICATION**

I hereby certify that the information contained herein is true and complete to the best of my knowledge and belief.

*B. L. Eiland*  
Name

B.L. Eiland

Position

Division Surveyor

Company

Texaco Producing Inc.

Date

8/24/88

I hereby certify that the well location shown on this plat was plotted from field notes of actual surveys made by me or under my supervision, and that the same is true and correct to the best of my knowledge and belief.

Date Surveyed

8/23/88

Registered Professional Engineer  
and/or Land Surveyor

*B. L. Eiland*  
B.L. Eiland

Certificate No.

4386

**RECEIVED**

**SEP 22 1988**

**OCD  
HOBBS OFFICE**

**DRILLING CONTROL**  
**CONDITION II-B 3000 WP**  
**FOR AIR DRILLING OR**  
**WHERE YATES AIR BLOWS ARE EXPECTED**

H<sub>2</sub>S TRIM REQUIRED  
 YES \_\_\_\_\_ NO \_\_\_\_\_

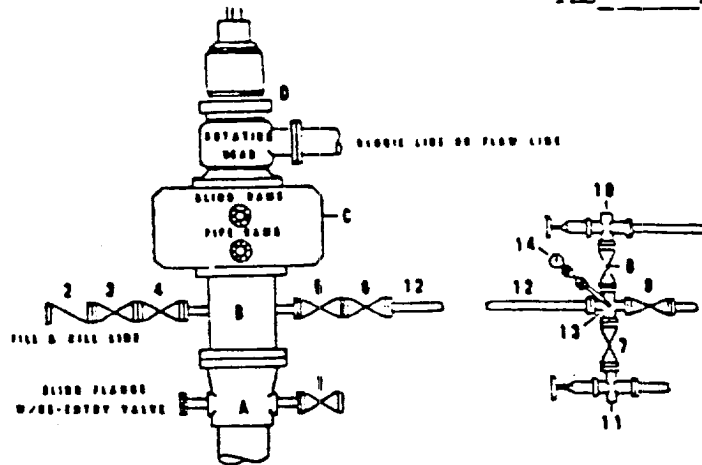

DRILLING CONTROL

MATERIAL LIST - CONDITION II - B  
FOR AIR DRILLING

- |               |   |
|---------------|---|
| A             | Texaco Wellhead   |
| B             | 3000# W.P. drilling spool with a 2" minimum flanged outlet for kill-line and 3" minimum flanged outlet for choke line   |
| C             | 3000# W.P. Dual ram type preventer, hydraulic operated with 1" steel, 3000# W.P. control lines (where sub-structure height is adequate, 2-3000# W.P. single ram type preventers may be utilized.) |
| D             | Rotating Head and extended Blosie Line.   |
| 1,3,4,<br>7,8 | 2" minimum 3000# W.P. flanged full opening steel gate valve, or Halliburton Lo Torc Plug valve.   |
| 2             | 2" minimum 3000# W.P. back pressure valve   |
| 5,6,9         | 3" minimum 3000# W.P. flanged full opening steel gate valve, or Halliburton Lo Torc Plug valve.   |
| 12            | 3" minimum schedule 80, Grade "B", seamless line pipe   |
| 13            | 2" minimum x 3" minimum 3000# W.P. flanged cross  |
| 10, 11        | 2" minimum 3000# W.P. adjustable choke bodies   |
| 14            | Cameron Mud Gauge or equivalent (location optional in choke line.)  |



**TEXACO, INC.**  
 MIDLAND DIVISION  
 MIDLAND, TEXAS



SCALE	DATE	EST NO.	DRG NO.
DRAWN BY			
CHECKED BY			
APPROVED BY			

**EXHIBIT C**

68/8/5 8004  
173

RECEIVED

SEP 22 1966

HOUSTON, TEXAS