

30-025-30526

NO. OF COPIES RECEIVED		
DISTRIBUTION		
SANTA FE		
FILE		
U.S.G.S.		
LAND OFFICE		
OPERATOR		

NEW MEXICO OIL CONSERVATION COMMISSION

Form C-101
Revised 1-1-65

5A. Indicate Type of Lease STATE <input type="checkbox"/> FEE <input checked="" type="checkbox"/>	
5. State Oil & Gas Lease No.	
7. Unit Agreement Name	
8. Farm or Lease Name Hardin	
9. Well No. 1	
10. Field and Pool, or Wildcat Wildcat	
12. County Lea	
19. Proposed Depth 11,575'	19A. Formation Strawn
20. Rotary or C.T. Rotary	
21. Elevations (Show whether DF, RT, etc.) 3684' G.L.	22. Approx. Date Work will start Jan. 15, 1989

APPLICATION FOR PERMIT TO DRILL, DEEPEN, OR PLUG BACK	
1a. Type of Work b. Type of Well DRILL <input checked="" type="checkbox"/> DEEPEN <input type="checkbox"/> PLUG BACK <input type="checkbox"/> OIL WELL <input checked="" type="checkbox"/> GAS WELL <input type="checkbox"/> OTHER <input type="checkbox"/> SINGLE ZONE <input checked="" type="checkbox"/> MULTIPLE ZONE <input type="checkbox"/>	
2. Name of Operator TXO Production Corp.	
3. Address of Operator 900 Wilco Building, Midland, TX 79701	
4. Location of Well UNIT LETTER M LOCATED 660 FEET FROM THE South LINE AND 660 FEET FROM THE West LINE OF SEC. 15 TWP. 17-S RGE. 38-E NMPM	
23.	

PROPOSED CASING AND CEMENT PROGRAM

SIZE OF HOLE	SIZE OF CASING	WEIGHT PER FOOT	SETTING DEPTH	SACKS OF CEMENT	EST. TOP
17 1/2"	13-3/8"	48#	400'	418	Surface
11"	8-5/8"	24#, 28#, 32#	5200'	1400	Surface
7-7/8"	3-1/2"	17#	11575'	520	9100'

See Attached for BOP Sketch

IN ABOVE SPACE DESCRIBE PROPOSED PROGRAM: IF PROPOSAL IS TO DEEPEN OR PLUG BACK, GIVE DATA ON PRESENT PRODUCTIVE ZONE AND PROPOSED NEW PRODUCTIVE ZONE. GIVE BLOWOUT PREVENTER PROGRAM, IF ANY.

I hereby certify that the information above is true and complete to the best of my knowledge and belief.

Signed Tim Goudeau Title Drig. & Prod. Engr. Date 12/8/88
(This space for State Use)

APPROVED BY _____ TITLE _____ DATE _____
CONDITIONS OF APPROVAL, IF ANY:

Permit Expires 6 Months From Approval
Date Unless Drilling Underway.

All distances must be from the outer boundaries of the Section.

Operator TXO Production Corp.		Lease Hardin		Well No. 1
Unit Letter M	Section 15	Township 17-S	Range 38-E	County Lea
Actual Footage Location of Well:				
660 feet from the South line and 660 feet from the West line				
Ground Level Elev. 3684' G.L.	Producing Formation Strawn	Pool Wildcat	Dedicated Acreage: 40 Acres	

1. Outline the acreage dedicated to the subject well by colored pencil or hachure marks on the plat below.
2. If more than one lease is dedicated to the well, outline each and identify the ownership thereof (both as to working interest and royalty).
3. If more than one lease of different ownership is dedicated to the well, have the interests of all owners been consolidated by communitization, unitization, force-pooling, etc?

☐ Yes ☐ No If answer is "yes," type of consolidation _____

If answer is "no," list the owners and tract descriptions which have actually been consolidated. (Use reverse side of this form if necessary.) _____

No allowable will be assigned to the well until all interests have been consolidated (by communitization, unitization, forced-pooling, or otherwise) or until a non-standard unit, eliminating such interests, has been approved by the Division.

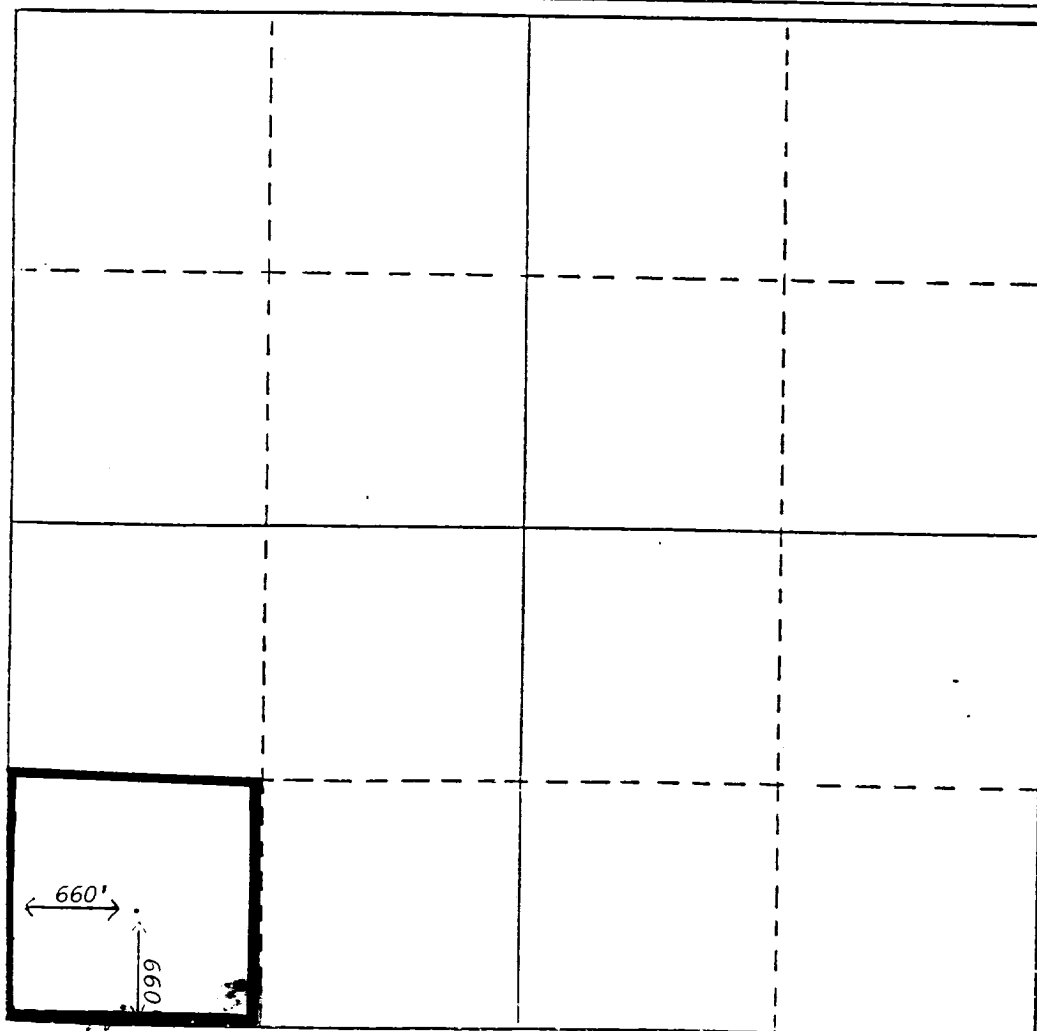

CERTIFICATION

I hereby certify that the information contained herein is true and complete to the best of my knowledge and belief.

Tim Goudeau
Name
Drilling & Production Engr.
Position
TXO Production Corp.
Company
12/8/88
Date

I hereby certify that the well location shown on this plat was plotted from field notes of actual surveys made by me or under my supervision, and that the same is true and correct to the best of my knowledge and belief.

Date Surveyed _____

Registered Land Surveyor _____

Certificate No. _____

330 660 990 1320 1650 1980 2310 2640 2970 3300 3630 3960 4290 4620 4950 5280 5610 5940 6270 6600

RECEIVED

DEC 12 1988

OCU
HOBBS OFFICE

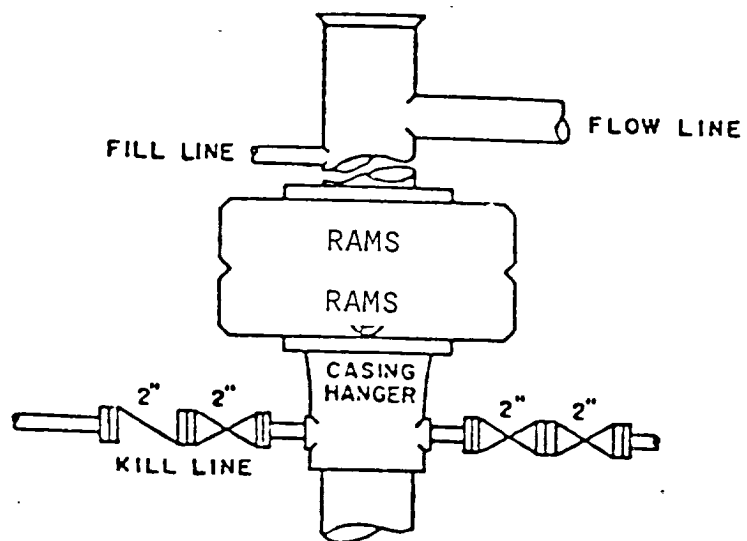

BOP STACK

3000 PSI WORKING PRESSURE

BOP ARRANGEMENT

DEC 13 1988