

N. M. OIL COMMISSION  
UNITED STATES  
DEPARTMENT OF THE INTERIOR  
BUREAU OF LAND MANAGEMENT

SUBMIT IN TRIPLICATE\*  
(Other instructions on  
reverse side)

Form approved.  
Budget Bureau No. 1004-0136  
Expires August 31, 1985

RECEIVED

APPLICATION FOR PERMIT TO DRILL, DEEPEN, OR PLUG BACK

1a. TYPE OF WORK

DRILL ☒

DEEPEN ☐

PLUG BACK ☐

b. TYPE OF WELL

OIL  
WELL ☒

GAS  
WELL ☐

OTHER

SINGLE  
ZONE ☒

MULTIPLE  
ZONE ☐

2. NAME OF OPERATOR

Siete Oil and Gas Corporation

3. ADDRESS OF OPERATOR

P.O. Box 2523

Roswell, New Mexico 88202-2523

4. LOCATION OF WELL (Report location clearly and in accordance with any State requirements.)\*

At surface 1650' FSL & 990' FWL, NW $\frac{1}{4}$ SW $\frac{1}{4}$ , Unit Letter L

At proposed prod. zone Same

14. DISTANCE IN MILES AND DIRECTION FROM NEAREST TOWN OR POST OFFICE\*

6 air miles South of Maljamar

15. DISTANCE FROM PROPOSED\*

LOCATION TO NEAREST  
PROPERTY OR LEASE LINE, FT.  
(Also to nearest drlg. unit line, if any)

330'

16. NO. OF ACRES IN LEASE

321.13

17. NO. OF ACRES ASSIGNED  
TO THIS WELL

40

18. DISTANCE FROM PROPOSED LOCATION\*  
TO NEAREST WELL, DRILLING, COMPLETED,  
OR APPLIED FOR, ON THIS LEASE, FT.

1320'

19. PROPOSED DEPTH

6500'

20. ROTARY OR CABLE TOOLS

Rotary

21. ELEVATIONS (Show whether DF, RT, GR, etc.)

3800' GR

22. APPROX. DATE WORK WILL START\*

ASAP

23. PROPOSED CASING AND CEMENTING PROGRAM

SIZE OF HOLE	SIZE OF CASING	WEIGHT PER FOOT	SETTING DEPTH	QUANTITY OF CEMENT
12 1/4"	8 5/8"	24#	400'	500 sks circ
7 7/8"	5 1/2"	15.5# & 17#	6500'	sufficient to isolate all oil, gas & water zones

Selectively perforate and treat pay zones.

Attachments:

Survey plat (C-102)  
Supplemental drilling data  
Surface use plan

APPROVAL SUBJECT TO  
GENERAL REQUIREMENTS AND  
SPECIAL STIPULATIONS  
ATTACHED

IN ABOVE SPACE DESCRIBE PROPOSED PROGRAM: If proposal is to deepen or plug back, give data on present productive zone and proposed new productive zone. If proposal is to drill or deepen directionally, give pertinent data on subsurface locations and measured and true vertical depths. Give blowout preventer program, if any.

24.

SIGNED Cathy D. Botley TITLE Drilling & Production DATE 2/17/89

(This space for Federal or State office use)

PERMIT NO.

APPROVAL DATE

APPROVED BY [Signature]

AREA MANAGER

TITLE CARLSBAD RESOURCE AREA

DATE 3-3-89

CONDITIONS OF APPROVAL, IF ANY:

\*See Instructions On Reverse Side

Title 18 U.S.C. Section 1001, makes it a crime for any person knowingly and willfully to make to any department or agency of the United States any false, fictitious or fraudulent statements or representations as to any matter within its jurisdiction.

RECEIVED

MAR 16 1989

DCD  
NOBBS OFFICE

BOP DIAGRAM  
RATED 30000

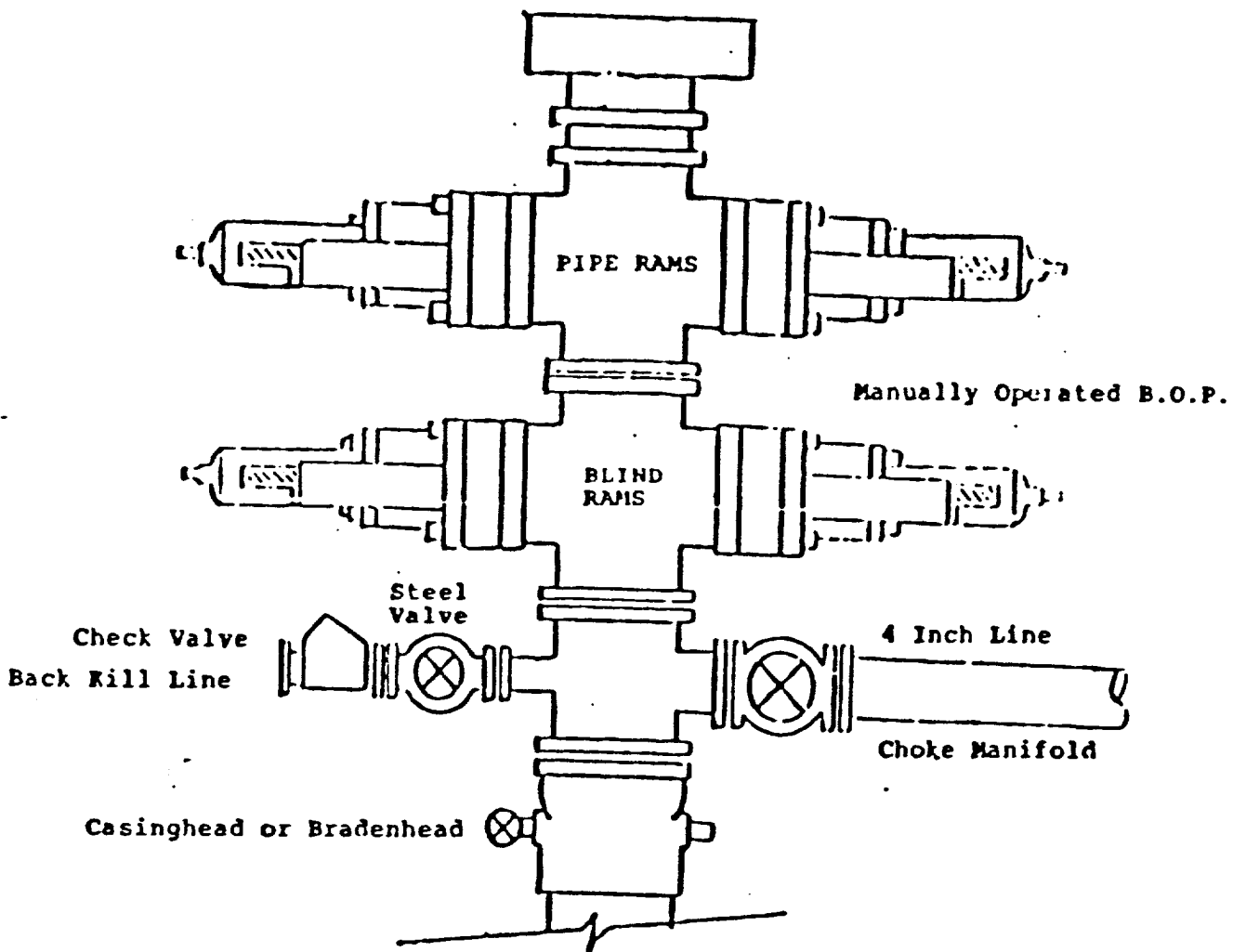

1000 1000  
1000 1000  
1000 1000  
1000 1000

**RECEIVED**

**MAR 6 1969**

**OCD  
HOBBS OFFICE**

NEW MEXICO OIL CONSERVATION COMMISSION  
WELL LOCATION AND ACREAGE DEDICATION PLAT

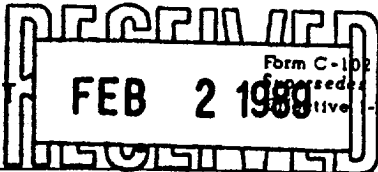

All distances must be from the outer boundaries of the Section.

Operator SIETE OIL & GAS CORPORATION			Lease Quanah Federal		Well No. 2
Unit Letter L	Section 14	Township 18 South	Range 32 East	County Lea County, N.M.	
Actual Footage Location of Well: 1650 feet from the South line and 990 feet from the West line					
Ground Level Elev. 3800.	Producing Formation Delaware		Pool Querecho Plains	Dedicated Acreage: 40 Acres	

1. Outline the acreage dedicated to the subject well by colored pencil or hachure marks on the plat below.
2. If more than one lease is dedicated to the well, outline each and identify the ownership thereof (both as to working interest and royalty).
3. If more than one lease of different ownership is dedicated to the well, have the interests of all owners been consolidated by communitization, unitization, force-pooling, etc?

☐ Yes ☐ No If answer is "yes," type of consolidation \_\_\_\_\_

If answer is "no," list the owners and tract descriptions which have actually been consolidated. (Use reverse side of this form if necessary.) \_\_\_\_\_

No allowable will be assigned to the well until all interests have been consolidated (by communitization, unitization, forced-pooling, or otherwise) or until a non-standard unit, eliminating such interests, has been approved by the Commission.

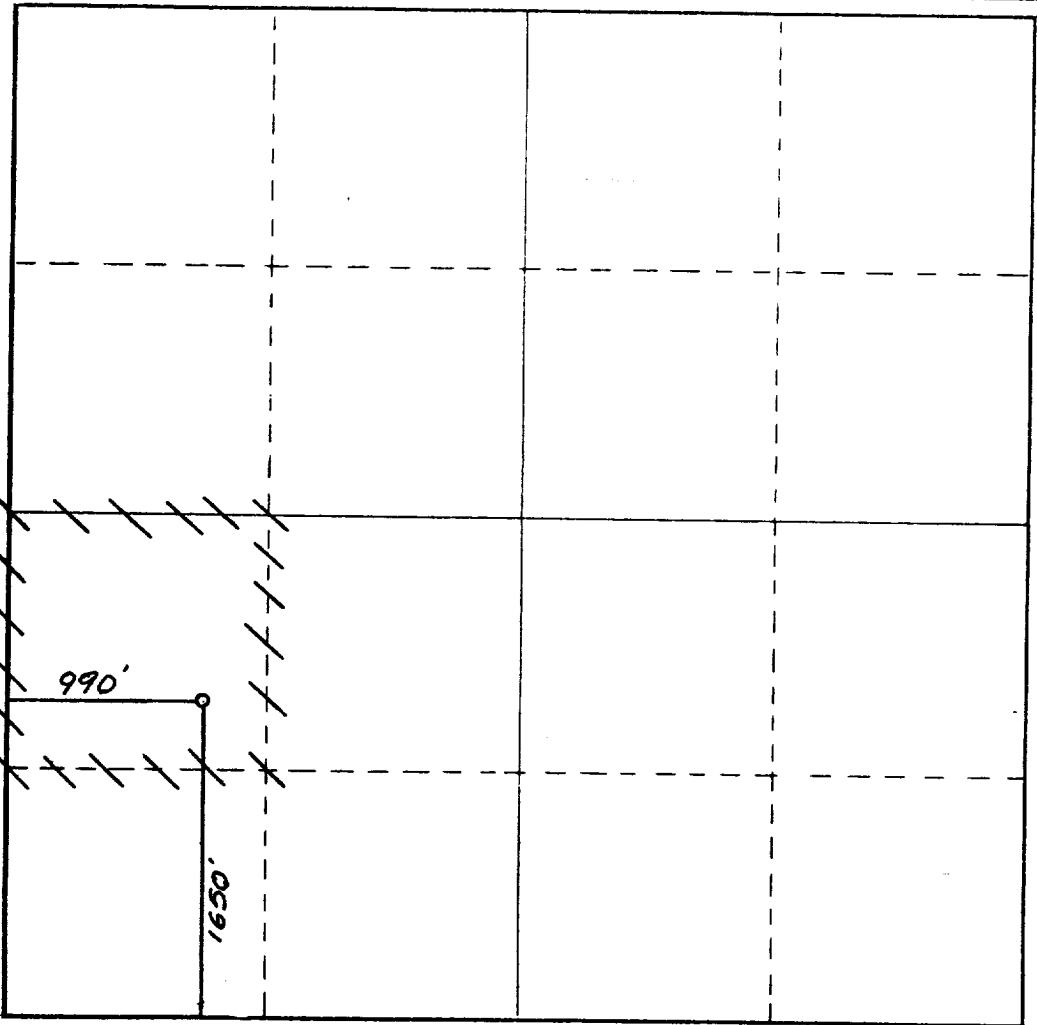

CERTIFICATION

I hereby certify that the information contained herein is true and complete to the best of my knowledge and belief.

*Harold D. Justice*  
Name

Harold D. Justice

Position

V.P. Drilling & Production

Company

Siete Oil & Gas Corporation

Date

February 17, 1989

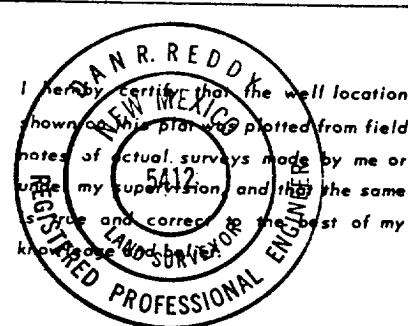

Date Surveyed

January 31, 1989

Registered Professional Engineer  
and/or Land Surveyor

*Dan R. Reddy*  
Certificate No.

NM PE&LS NO. 5412

RECEIVED

MAR 6 1966

OCB

NONP-RECEIVED