

RECEIVED

UNITED STATES  
DEPARTMENT OF THE INTERIOR  
BUREAU OF LAND MANAGEMENT  
P.O. BOX 1980  
MORRIS NEW MEXICO 882

FORM APPROVED  
Budget Bureau No. 1004-0135  
Expires: March 31, 1993

5. Lease Designation and Serial No.  
**NM-40452**

6. If Indian, Allottee or Tribe Name

7. If Unit or CA, Agreement Designation

8. Well Name and No.  
**Yuma Fed #1**

9. API Well No.  
**30590**  
**30-025-20590**

10. Field and Pool, or Exploratory Area  
**Corbin Delaware W.**

11. County or Parish, State  
**Lea NM**

**SUNDRY NOTICES AND REPORTS ON WELLS**

Do not use this form for proposals to drill or to deepen or reentry to a different reservoir.  
Use "APPLICATION FOR PERMIT—" for such proposals

**SUBMIT IN TRIPLICATE**

1. Type of Well:  
☒ Oil Well ☐ Gas Well

2. Name of Operator  
**Siete Oil and Gas Corporation**

3. Address and Telephone No.  
**P.O. Box 2523, Roswell, NM 88202-2523**

4. Location of Well (Footage, Sec., T., R., M., or Survey Description)  
**Sec. 14: T18S, R32E  
2310' FSL & 1980' FWL  
NE $\frac{1}{4}$ SW $\frac{1}{4}$ , Unit Letter K**

**CHECK APPROPRIATE BOX(S) TO INDICATE NATURE OF NOTICE, REPORT, OR OTHER DATA**

TYPE OF SUBMISSION	TYPE OF ACTION	
<input checked="" type="checkbox"/> Notice of Intent	<input type="checkbox"/> Abandonment	<input type="checkbox"/> Change of Plans
<input type="checkbox"/> Subsequent Report	<input checked="" type="checkbox"/> Recompletion	<input type="checkbox"/> New Construction
<input type="checkbox"/> Final Abandonment Notice	<input type="checkbox"/> Plugging Back	<input type="checkbox"/> Non-Routine Fracturing
	<input type="checkbox"/> Casing Repair	<input type="checkbox"/> Water Shut-Off
	<input type="checkbox"/> Altering Casing	<input type="checkbox"/> Conversion to Injection
	<input checked="" type="checkbox"/> Other <b>re-entry</b>	<input type="checkbox"/> Dispose Water

(Note: Report results of multiple completion on Well Completion or Recompletion Report and Log form.)

Describe Proposed or Completed Operations (Clearly state all pertinent details, and give pertinent dates, including estimated date of starting any proposed work. If well is directionally drilled, give subsurface locations and measured and true vertical depths for all markers and zones pertinent to this work.)

Siete Oil and Gas proposes to re-enter the above captioned well as follows:

1. Install Casinghead & BOP.
2. DO plugs @ surface, 370', 480', 1082' & 4532', circ hole clean after DO plugs.
3. Set plug @ 5150'-5000' w/60 sxs "C", 3 $\frac{1}{2}$  S-1, dress off T/plug to 5000'+-.
4. RU & run 5000' 15.5# J-55 5 $\frac{1}{2}$ " csg, cmt w/700 sxs 35/65 POZ + 175 sxs 10/10 self stress.
5. RU & run CBL @ 4990'-3000'.
6. Perf 4862'-4881'.
7. TIH w/pkr, SN & 2 3/8" tbg to 4881'.
8. Spot 2 bbls acid over perfs, pull pkr to 4762' & set APPROVAL SUBJECT TO GENERAL REQUIREMENTS AND SPECIAL STIPULATIONS ATTACHED
9. Acidize w/1000 gals.
10. Frac w/15000 gals.
11. Begin flowback.

I hereby certify that the foregoing is true and correct

Signed Cathy Gately Seely Title Reg. Spec. Date 9/8/93

This space for Federal or State office use

Approved by Ron Dunton Title AREA MANAGER Date OCT 26 1993

Conditions of approval, if any:

NEW MEXICO OIL CONSERVATION COMMISSION  
WELL LOCATION AND ACREAGE DEDICATION PLAT

Form C-102  
Supersedes C-128  
Effective 1-1-65

All distances must be from the outer boundaries of the Section.

Operator SIETE OIL & GAS CORPORATION			Lease Yuma Federal		Well No. 1
Unit Letter K	Section 14	Township 18 South	Range 32 East	County Lea County, N.M.	
Actual Footage Location of Well: 2310 feet from the South line and 1980 feet from the West line					
Ground Level Elev. 3804.	Producing Formation Delaware	Pool West Corbin <del>Querecho Plains</del>	Dedicated Acreage: 40 Acres		

1. Outline the acreage dedicated to the subject well by colored pencil or hachure marks on the plat below.
2. If more than one lease is dedicated to the well, outline each and identify the ownership thereof (both as to working interest and royalty).
3. If more than one lease of different ownership is dedicated to the well, have the interests of all owners been consolidated by communitization, unitization, force-pooling, etc?

☐ Yes ☐ No If answer is "yes," type of consolidation \_\_\_\_\_

If answer is "no," list the owners and tract descriptions which have actually been consolidated. (Use reverse side of this form if necessary.) \_\_\_\_\_

No allowable will be assigned to the well until all interests have been consolidated (by communitization, unitization, forced-pooling, or otherwise) or until a non-standard unit, eliminating such interests, has been approved by the Commission.

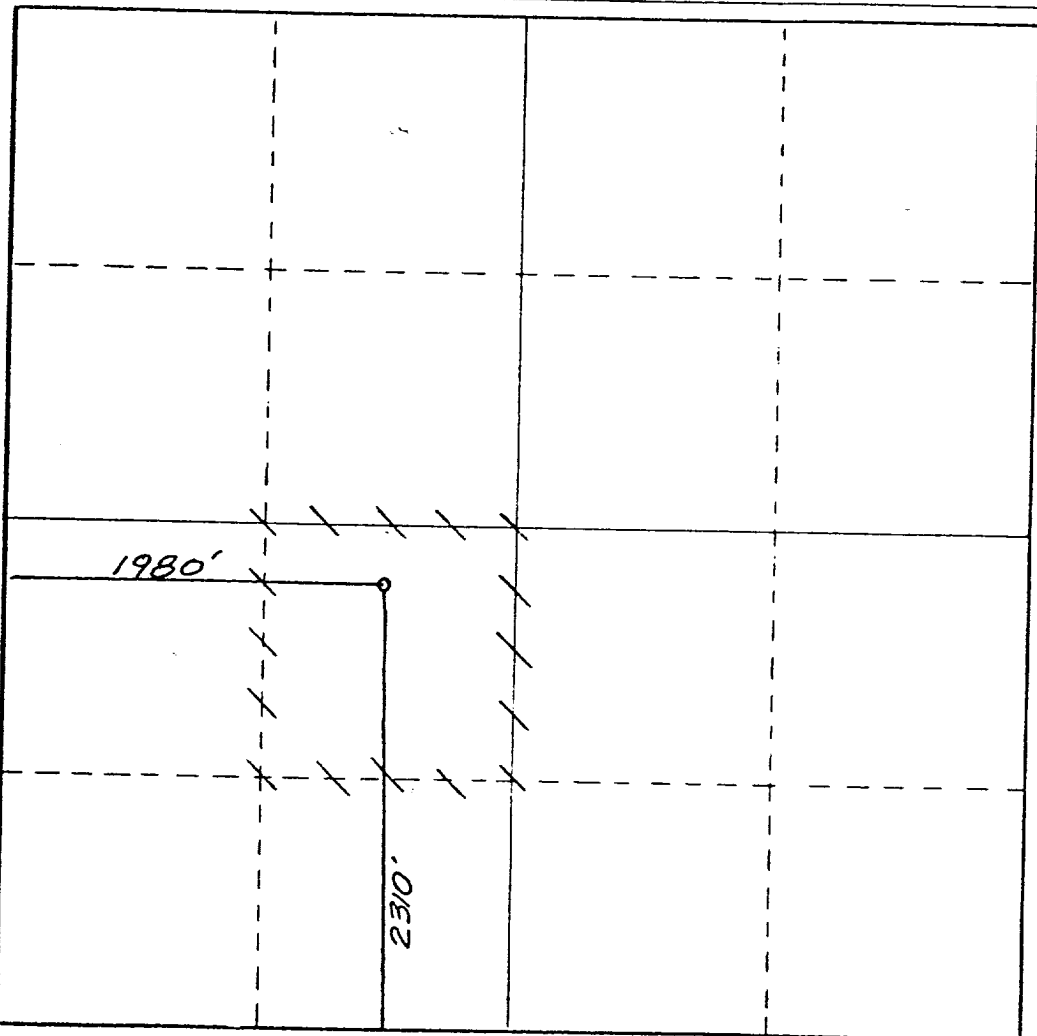

CERTIFICATION

I hereby certify that the information contained herein is true and complete to the best of my knowledge and belief.

*Harold D. Justice* <sup>CS</sup>

Name

Harold D. Justice

Position

V.P. Drilling & Production

Company

Siete Oil & Gas Corporation

Date

March 28, 1989

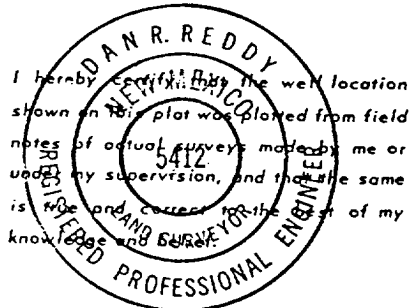

I hereby certify that the well location shown on this plat was plotted from field notes of actual surveys made by me or under my supervision, and that the same is true and correct to the best of my knowledge and belief.

Date Surveyed

March 15, 1989

Registered Professional Engineer  
and/or Land Surveyor

*Dan R. Reddy*

Certificate No.

NM PE&LS NO. 5412

SUPPLEMENTAL DRILLING DATA  
SIETE OIL AND GAS CORPORATION  
YUMA FEDERAL #1  
2310' FSL & 1980' FWL  
Section 14: T18S, R32E  
Lea County, New Mexico  
Lease Number: NM-40452

The following items supplement "Onshore Oil and Gas Order No. 1":

1. The geologic surface is quaternary.
2. The estimated geological marker tops:

Rustler	1250'
B/Salt	2600'
Queen	3935'
Delaware	4800'
3. Estimated depths to water, oil or gas:

Water:	Approx. 350'
Oil or Gas:	4800'
4. Proposed casing program:

<u>Size</u>	<u>Interval</u>	<u>Weight</u>	<u>Grade</u>	<u>Joint</u>	<u>New or Used</u>
5 1/2"	0'-5000'	15.5#	J-55	ST&C	New
5. Pressure Control Equipment: The blowout preventer will be a double ram type preventer. A sketch is attached.
6. Mud Program:

0'-TD:	Drill with a cut brine system; add starch and salt gel to maintain a vis. of 30; @ TD 40; mud wt. 10.
--------	---
7. Auxiliary Equipment: A kelly cock will be installed on the rig floor while drilling operations are in progress.
8. Testing & coring programs: None anticipated.  
Logging: None anticipated.
9. No abnormal pressures or temperature zones are anticipated. There has not been H2S encountered while drilling formations from surface to T.D. Therefore, we do not have any contingency plans for this well.
10. Anticipated starting date: Commence drilling operations ASAP upon BLM approval.

BOP DIAGRAM  
RATED 30001

