



STATE OF NEW MEXICO  
ENERGY AND MINERALS DEPARTMENT  
OIL CONSERVATION DIVISION  
HOBBS DISTRICT OFFICE

6-27-89

GARREY CARRUTHERS  
GOVERNOR

POST OFFICE BOX 1840  
HOBBS, NEW MEXICO 88241-1840  
(505) 393-6161

OIL CONSERVATION DIVISION  
P. O. BOX 2088  
SANTA FE, NEW MEXICO 87501

RE: Proposed:

MC \_\_\_\_\_  
DHC \_\_\_\_\_  
NSL X \_\_\_\_\_ amendment  
NSP \_\_\_\_\_  
SWD \_\_\_\_\_  
WFX \_\_\_\_\_  
PMX \_\_\_\_\_

Gentlemen:

I have examined the application for the: #21-0 35-17-34

Phillips Pet Co. M.E. Hale #20-N 35-17-34  
Operator Lease & Well No. Unit S-T-R

and my recommendations are as follows:

OK

Yours very truly,

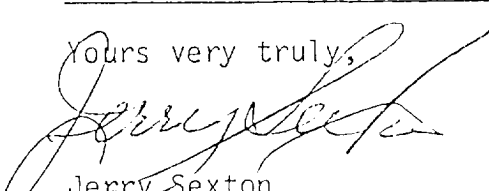
  
Jerry Sexton  
Supervisor, District 1

/ed

Submit to Appropriate  
District Office  
State Lease - 4 copies  
Fee Lease - 3 copies

State of New Mexico  
Energy, Minerals and Natural Resources Department

Form C-102  
Revised 1-1-89

OIL CONSERVATION DIVISION

P.O. Box 2088  
Santa Fe, New Mexico 87504-2088

DISTRICT I  
P.O. Box 1980, Hobbs, NM 88240

DISTRICT II  
P.O. Drawer DD, Artesia, NM 88210

DISTRICT III  
1000 Rio Brazos Rd., Aztec, NM 87410

WELL LOCATION AND ACREAGE DEDICATION PLAT

All Distances must be from the outer boundaries of the section

Operator Phillips Petroleum Co.			Lease M.E. Hale		Well No. 20
Unit Letter N	Section 35	Township 17 South	Range 34 East	County NMPM Lea	
Actual Footage Location of Well: 1225 feet from the south line and 2000 feet from the west line					
Ground level Elev. 4019.3'	Producing Formation Grayburg/San Andres		Pool Vacuum Grayburg/San Andres	Dedicated Acreage: 40 Acres	

1. Outline the acreage dedicated to the subject well by colored pencil or hatchure marks on the plat below.
2. If more than one lease is dedicated to the well, outline each and identify the ownership thereof (both as to working interest and royalty).
3. If more than one lease of different ownership is dedicated to the well, have the interest of all owners been consolidated by communitization, unitization, force-pooling, etc.?  
☐ Yes ☐ No If answer is "yes" type of consolidation \_\_\_\_\_  
If answer is "no" list the owners and tract descriptions which have actually been consolidated. (Use reverse side of this form if necessary.) \_\_\_\_\_  
No allowable will be assigned to the well until all interests have been consolidated (by communitization, unitization, forced-pooling, or otherwise) or until a non-standard unit, eliminating such interest, has been approved by the Division.

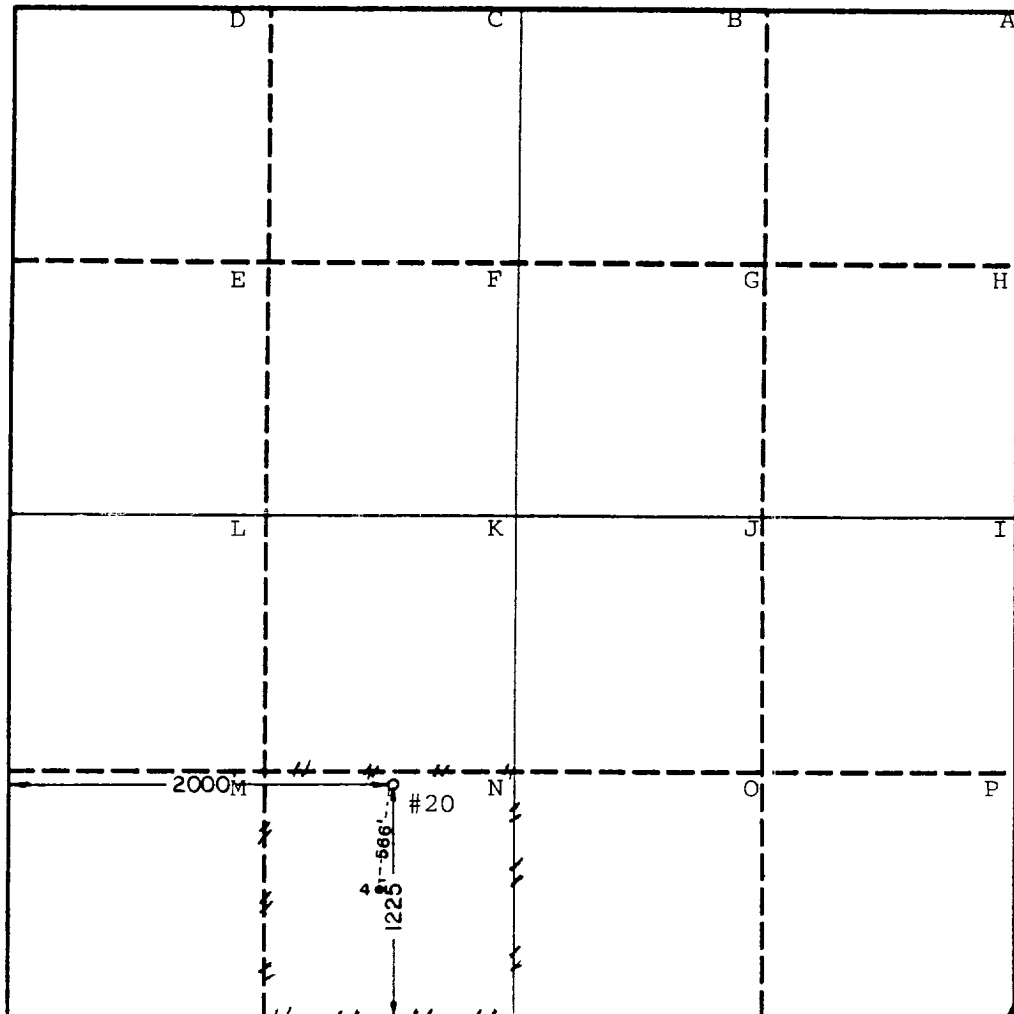

OPERATOR CERTIFICATION

I hereby certify that the information contained herein is true and complete to the best of my knowledge and belief.

*L. M. Sanders*  
Signature

L. M. Sanders  
Printed Name

Regulation & Proration Supv.  
Position

Phillips Petroleum Company  
Company

June 19, 1989  
Date

June 19, 1989  
Date

June 19, 1989  
Date

June 19, 1989  
Date

June 19, 1989  
Date

SURVEYOR CERTIFICATION

I hereby certify that the well location shown on this plat was plotted from field notes of actual surveys made by me or under my supervision, and that the same is true and correct to the best of my knowledge and belief.

June 9, 1989  
Date Surveyed

*John W. West*  
Signature & Seal of Professional Surveyor

Certificate No. JOHN W. WEST, 678  
RONALD J. EIDSON, 3239



STATE OF NEW MEXICO

ENERGY, MINERALS AND NATURAL RESOURCES DEPARTMENT

OIL CONSERVATION DIVISION

GARREY CARRUTHERS  
GOVERNOR

POST OFFICE BOX 2088  
STATE LAND OFFICE BUILDING  
SANTA FE, NEW MEXICO 87504  
(505) 827-5800

June 5, 1989

Phillips Petroleum Company  
4001 Penbrook  
Odessa, TX 79762

Attention: Larry M. Sanders  
Supervisor, Regulation and Proration

Administrative Order NSL-2662

Dear Mr. Sanders:

Reference is made to your applications of May 25, 1989 for two non-standard oil well locations to be included within an existing 40-acre standard oil spacing and proration unit comprising the SE/4 SW/4 (Unit N) of Section 35, Township 17 South, Range 34 East, NMPM, Vacuum Grayburg-San Andres Pool, Phillips Hale-Mable Vacuum Grayburg San Andres Pressure Maintenance Project Area, Lea County, New Mexico.

It is my understanding that the following described wells are necessary to complete an efficient production/injection pattern within said secondary recovery project:

M.E. Hale Well No. 20 to be located 1090 feet from the South line and 1870 feet from the West line; and,

M.E. Hale Well No. 22 to be located 650 feet from the South line and 2630 feet from the West line.

RECEIVED

JUN 26 1989

CC

NOTICE TO THE PUBLIC