

UNITED STATES  
DEPARTMENT OF THE INTERIOR  
BUREAU OF LAND MANAGEMENT

APPLICATION FOR PERMIT TO DRILL, DEEPEN, OR PLUG BACK

1a. TYPE OF WORK  
DRILL ☒ DEEPEN ☐ PLUG BACK ☐

b. TYPE OF WELL  
OIL WELL ☒ GAS WELL ☐ OTHER ☐  
SINGLE ZONE ☐ MULTIPLE ZONE ☐

2. NAME OF OPERATOR  
Harvey E. Yates Company

3. ADDRESS OF OPERATOR  
P.O. Box 1933, Roswell, New Mexico 88202

4. LOCATION OF WELL (Report location clearly and in accordance with any State requirements.)  
At surface 330' FNL & 660' FEL  
At proposed prod. zone same

14. DISTANCE IN MILES AND DIRECTION FROM NEAREST TOWN OR POST OFFICE\*  
8 miles S.E. of Maljamar, NM

15. DISTANCE FROM PROPOSED\*  
LOCATION TO NEAREST  
PROPERTY OR LEASE LINE, FT. 330  
(Also to nearest drlg. unit line, if any)

18. DISTANCE FROM PROPOSED LOCATION\*  
TO NEAREST WELL, DRILLING, COMPLETED,  
OR APPLIED FOR, ON THIS LEASE, FT. 990

21. ELEVATIONS (Show whether DF, RT, GR, etc.)  
3893.1 GL

23. PROPOSED CASING AND CEMENTING PROGRAM

SIZE OF HOLE	SIZE OF CASING	WEIGHT PER FOOT	SETTING DEPTH	QUANTITY OF CEMENT
17 1/2	13 3/8	54.5	350	<u>Circ to surface</u>
12 1/4	8 5/8	32 & 24	2925	<u>Circ to surface</u>
7 7/8	5 1/2	17	9250	600' above pay zone

MUD PROGRAM

0 - 350 FW w/paper  
350 - 2925 Brine water  
2925 - 9250 FW mud

RECEIVED  
SUBJECT TO  
CERTAIN REQUIREMENTS AND  
SPECIAL STIMULATIONS  
ATTACHED

IN ABOVE SPACE DESCRIBE PROPOSED PROGRAM: If proposal is to deepen or plug back, give data on present productive zone and proposed new productive zone. If proposal is to drill or deepen directionally, give pertinent data on subsurface locations and measured and true vertical depths. Give blowout preventer program, if any.

24. SIGNED N. Young NM Young TITLE Drilling Superintendent DATE 5/25/89  
(This space for Federal or State office use)

PERMIT NO. \_\_\_\_\_ APPROVAL DATE \_\_\_\_\_  
APPROVED BY Andrew Prenter AREA MANAGER CARLSBAD RES. DATE 6-19-89  
CONDITIONS OF APPROVAL, IF ANY:

\*See Instructions On Reverse Side

RECEIVED

JUN 20 1993

OCD  
HOBB'S OFFICE

## OIL CONSERVATION DIVISION

P.O. Box 2088  
Santa Fe, New Mexico 87504-2088

DISTRICT 1  
P.O. Box 1983, Hobbs, NM 88240

DISTRICT  
P.O. Drawer 104, Artesia, NM 88210

DISTRICT III  
1000 Rio Brazos Rd., Aztec, NM 87410

# WELL LOCATION AND ACREAGE DEDICATION PLAT

All Distances must be from the outer boundaries of the section

Operator	Lease			Well No
Plat Letter	Section	Township	Range	County
Actual Footage Location of Well	18 South	32 East	NMPM	104
Ground level Elev	feet from the	Producing Formation	line and	feet from the
			Pool	line
				Dedicated Acreage
	Bone Springs	North Young Bone Springs	40	Acres

1. Outline the acreage dedicated to the subject well by colored pencil or hashure marks on the plat below.
2. If more than one lease is dedicated to the well, outline each and identify the ownership thereof (both as to working interest and royalty).
3. If more than one lease of different ownership is dedicated to the well, have the interest of all owners been consolidated by communitization, unitization, force pooling, etc.?
- Yes \_\_\_\_\_ No \_\_\_\_\_ If answer is "yes" type of consolidation \_\_\_\_\_
- If answer is "no" list the owners and tract descriptions which have actually been consolidated. (Use reverse side of this form, if necessary.)
- No royalty will be assigned to the well until all interests have been consolidated (by communitization, unitization, force pooling, or otherwise) or until a non-standard unit, eliminating such interest, has been approved by the Division.

HEYCO et al  
NM-40456

### OPERATOR CERTIFICATION

I hereby certify that the information contained herein is true and complete to the best of my knowledge and belief.

Signature

NM Young

Drilling Superintendent

Harvey E. Yates Company

May 25, 1989



### Application

HARVEY E. YATES COMPANY  
Chevron 12 Federal #4  
Section 12, T18S, R32E  
Lea County, New Mexico

In conjunction with Form 3160-3, Application for Permit to Drill the Subject well in Section 12, Township 18 South, Range 32 East, Lea County, New Mexico, Harvey E. Yates Company submits the following ten items of pertinent information in accordance with Bureau of Land Management requirements:

1. The geologic surface formation is quaternary alluvium and bolson deposits and other surficial deposits.
2. The estimated tops of geologic markers are as follows:

Rustler	1365'	Grayburg	4644'
Yates	2850'	San Andres	4983'
Seven Rivers	3250'	Delaware Sand	5816'
Bowers	3788'	Bone Spring	6367'
Queen	4065'	TD	9250'
Penrose	4340'		

3. We do not anticipate finding water but have listed the formation in which we anticipate finding oil or gas.

Bone Spring 6367'

4. Proposed casing program: See Form 3160-3
5. Pressure control equipment: See Exhibit C.
6. Mud program: See Form 3160-3.
7. Auxiliary equipment: Blowout preventer
8. Testing, logging and coring programs: We do not plan to core or DST. The planned logs are DLL/Micro w/GR and Caliper, CN-Den w/GR and Caliper.
9. No abnormal pressures or temperatures are anticipated.
10. Anticipated starting date: As soon as possible.

## SURFACE USE PLAN

HARVEY E. YATES COMPANY  
Chevron 12 Federal #4  
Section 12, T18S, R32E  
Lea County, New Mexico

### 1. EXISTING ROADS:

Exhibit A is a portion of a New Mexico Map showing the location of existing roads and wells. The location is approximately 40 miles east of Artesia, New Mexico. Leave Artesia on U.S. Highway 82 and travel east to State Highway 529. Travel southeast on 529 to mile marker 11. Turn right on caliche road and travel southwest for 2 miles. Turn left on lease road and travel south for 1 mile. Turn left and travel east 1/2 mile to new location.

### 2. PLANNED ACCESS ROADS:

We plan to use the existing roads as far as possible. We will build approximately 1000 ft of new road to reach the proposed location. The running surface will be 14' wide, with 6" compacted caliche.

### 3. LOCATION OF EXISTING WELLS:

Exhibit B is a plat showing existing wells and their locations.

### 4. LOCATIONS OF TANK BATTERIES, ETC.:

In the event we drill a producing well, all production equipment will be located at Unit C, Sec. 12, T18S, R32E.

### 5. LOCATION AND TYPE OF WATER SUPPLY:

Water will be from commercial sources, either hauled or pipelined.

RECEIVED

JUN 26 1989

CCC  
HONOLULU

6. SOURCE OF CONSTRUCTION MATERIAL:

We will use caliche from the reserve pit area to build the road and location. Caliche will be obtained from the pit located in Sec. 1, if sufficient material is not available at the location.

7. METHODS OF HANDLING WASTE DISPOSAL:

Waste will be buried in reserve pits at a depth of 36". The wellsite will be cleaned of all waste and this will be done within 30 days after completion of the well.

8. ANCILLARY FACILITIES:

None required.

9. WELLSITE LAYOUT:

- A. Exhibit D shows the relative location and dimensions of the well pad, reserve pits and major rig components.
- B. The land is relatively flat with sandy soil and sand dunes.
- C. The pad and pit area have been staked.

10. PLANS FOR RESTORATION OF THE SURFACE:

- A. After finishing drilling and/or other completion operations, all equipment and other materials not needed for further operations will be removed. Pits will be filled and the location cleaned of all trash and junk to leave the wellsite as pleasant in appearance as possible.
- B. If the proposed well is non-productive, all restoration and/or vegetation requirements of the Bureau of Land Management will be complied with and will be accomplished as quickly as possible. All pits will be filled and levelled within 90 days after abandonment.

11. OTHER INFORMATION:

- A. The surface and minerals are Federal land.
- B. The topography consists of sandy soil with native grasses, catclaw, etc. No wildlife was observed, but the usual inhabitants of this region are jackrabbits, reptiles, coyotes, etc.
- C. There are no ponds, lakes, streams or rivers in this area.
- D. An Archaeological Survey has been made and copy has been sent to your Carlsbad office. There is no evidence of any significant archaeological, historical or cultural sites in the area. Also, there are no occupied dwellings or windmills.

12. OPERATOR'S REPRESENTATIVES:

The field representatives responsible for assuring compliance with the approved surface use and operations plan are:

Micky Young  
Harvey E. Yates Company  
P. O. Box 1933  
Roswell, New Mexico 88201  
Office: 505/623-6601  
Mobil: 505/624-1818 #840

Curtis Tolle  
Harvey E. Yates Company  
P. O. Box 1933  
Roswell, New Mexico 88201  
Office: 505/748-2435  
Mobil: 505/624-1818 #837

13. CERTIFICATION:

I hereby certify that I, or persons under my direct supervision, have inspected the proposed drill site and access route; that I am familiar with the conditions which currently exist; that the statements made in this plan are, to the best of my knowledge, true and correct; and that the work associated with operations proposed herein will be performed by Harvey E. Yates Company and its contractors and subcontractors in conformity with this plan and the terms and conditions under which it is approved. This statement is subject to the provisions of 18 U.S.C. 1001 for the filing of a false statement.

May 25, 1989

  
\_\_\_\_\_  
N.M. Young  
Drilling Superintendent



# EXHIBIT A

Harvey E. Yates Co.  
Chevron 12 Federal #4  
Sec. 12, T18S, R32E  
Lea Co., New Mexico

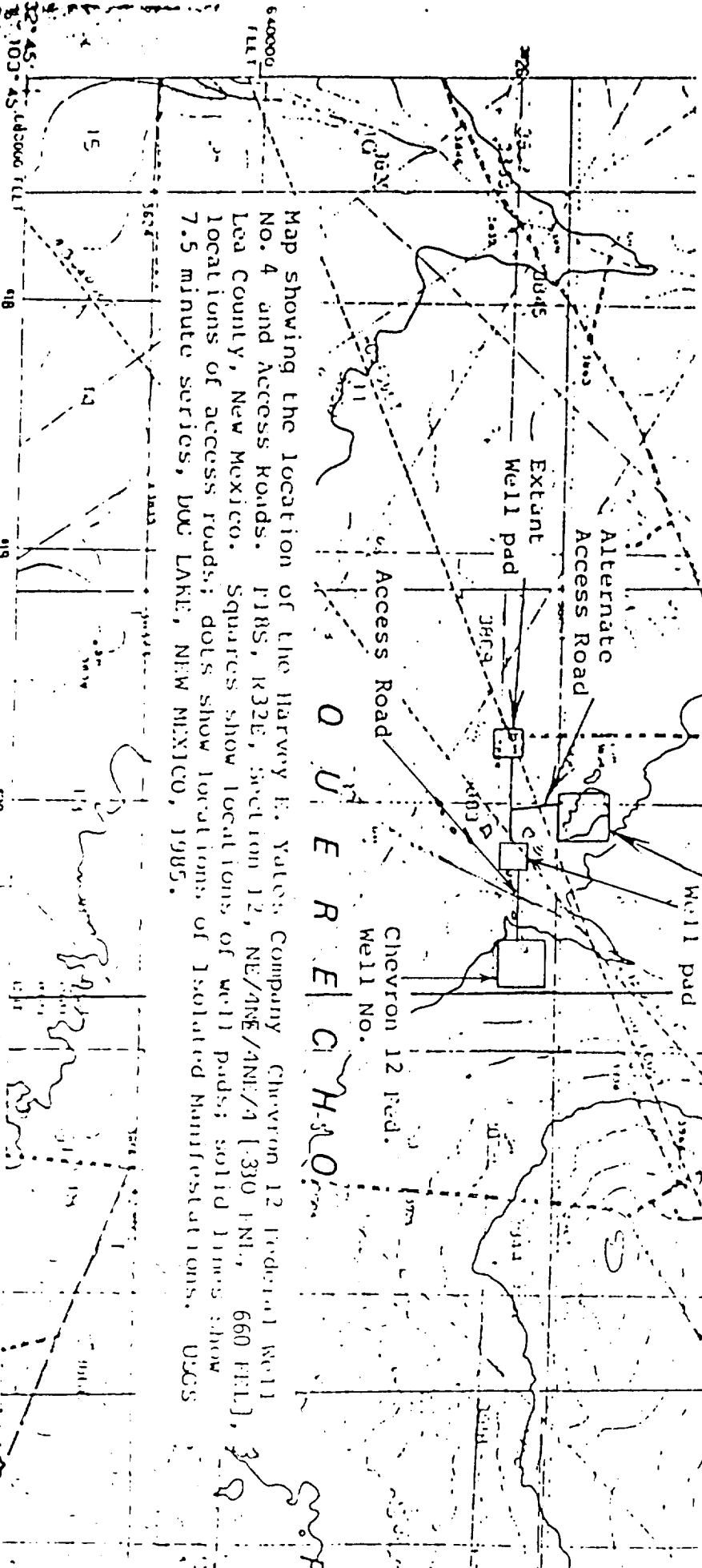

SCALE 1:24

PRODUCED BY THE UNITED STATES GEOLOGICAL SURVEY  
CONTRACT BY  
COOPERATION WITH THE UNITED STATES GEOLOGICAL SURVEY  
FIELD NO. 103-45, 10366  
MAP SHEET 103-45, 10366  
DATE 1979  
MAP SHEET 103-45, 10366  
DATE 1979  
MAP SHEET 103-45, 10366  
DATE 1979

SCALE 1:24

RECEIVED

JUN 20 1984

OCD

MOSES 09-12

EXHIBIT B

Harvey E. Yates Co  
Chevron 12 Federal #4  
Existint Well ●  
Existing Roads ———  
Proposed Well □  
Proposed Road - - - -

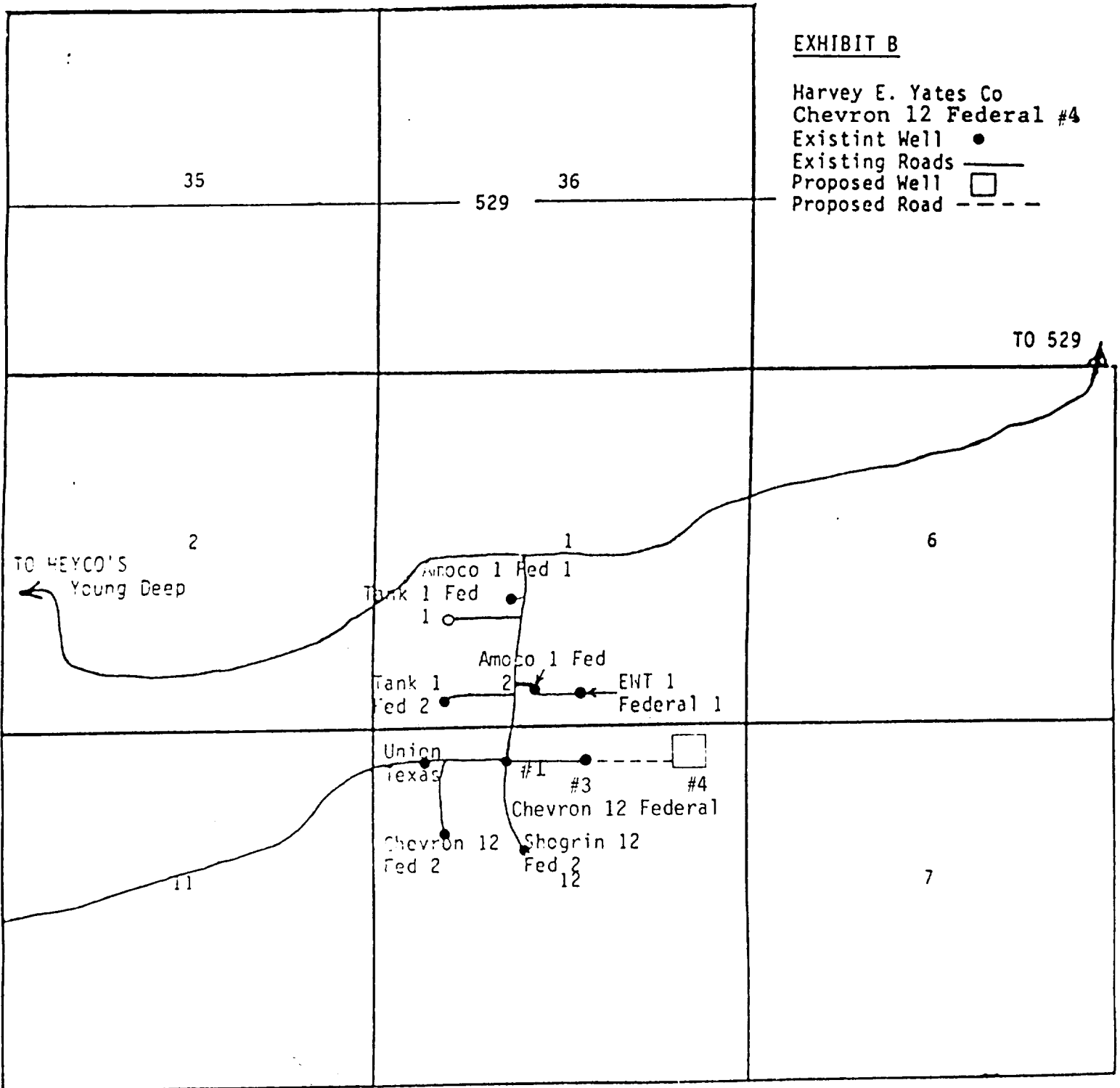

SECTION 1.12 TOWNSHIP 18 S RANGE 32 E

COUNTY Lea STATE New Mexico

EXHIBIT C

Harvey E. Yates Co.  
Chevron 12 Federal #4  
Sec. 12 T-18S R-32E  
Lea Co., New Mexico

900 Series

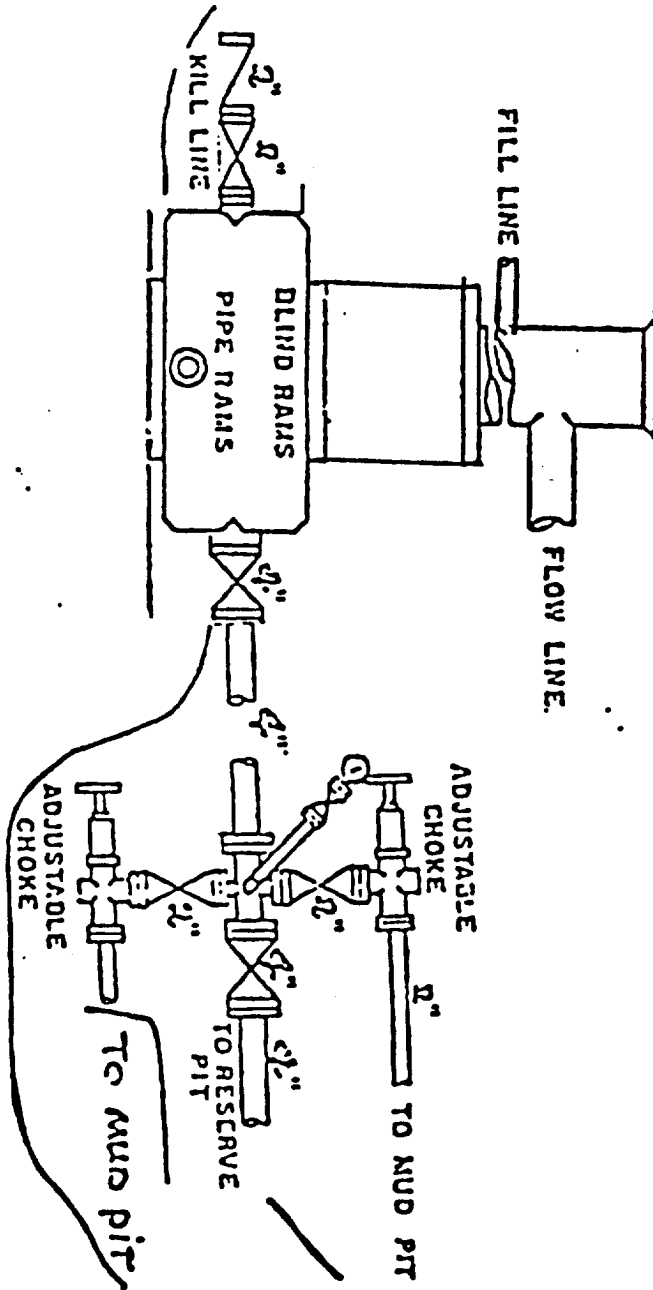
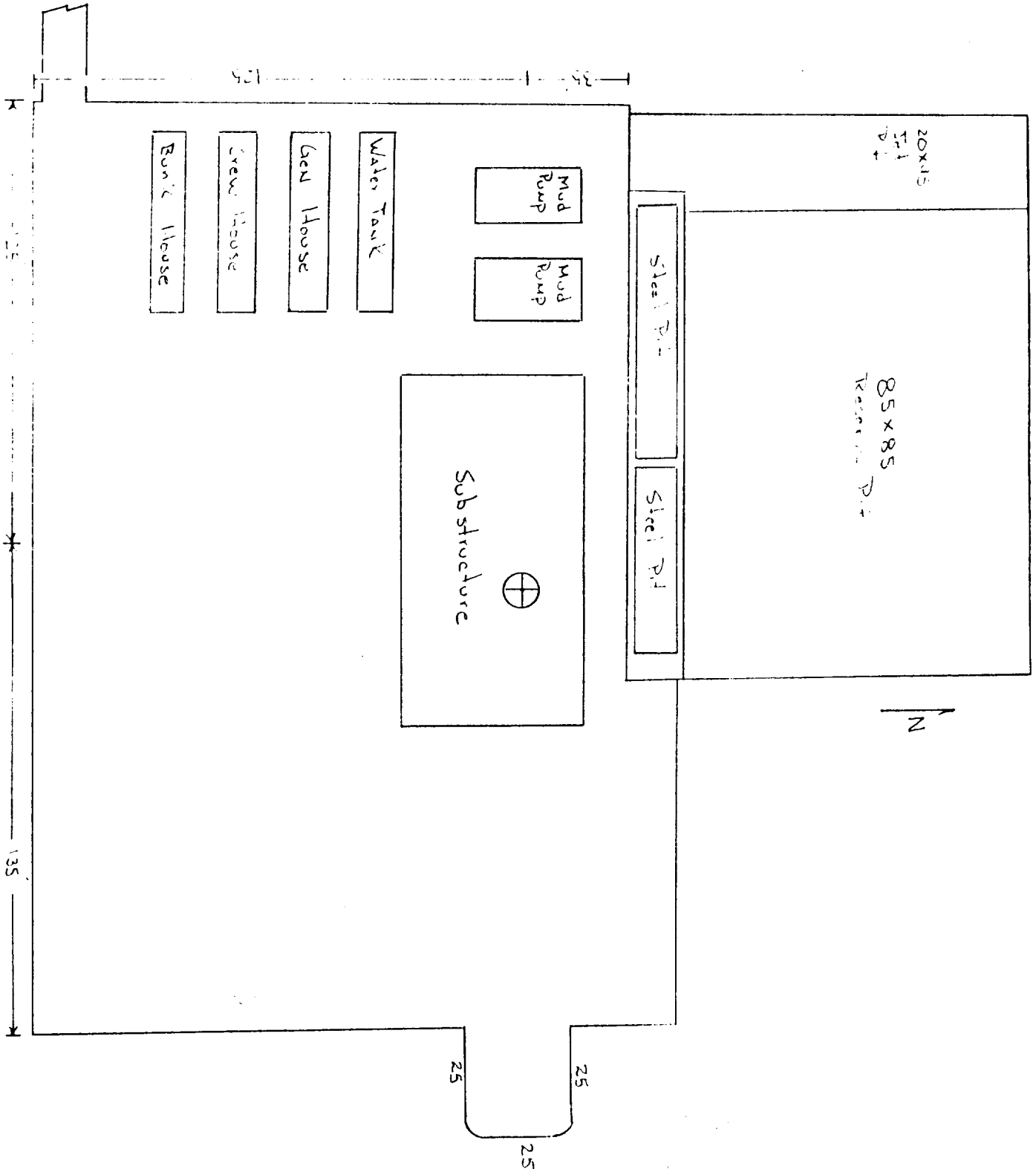

EXHIBIT D

Harvey E. Yates Co.  
Chevron 12 Federal #4  
Sec. 12 T-18S R-32E  
Lea Co., New Mexico



back 10/17/89

ELF

RECEIVED

JUN 20 1990

OCB  
HOBBS DEPT