

UNITED STATES  
DEPARTMENT OF THE INTERIOR  
BUREAU OF LAND MANAGEMENT

APPLICATION FOR PERMIT TO DRILL, DEEPEN, OR PLUG BACK

1a. TYPE OF WORK  
DRILL ☒ DEEPEN ☐ PLUG BACK ☐

b. TYPE OF WELL  
OIL WELL ☒ GAS WELL ☐ OTHER ☐ SINGLE ZONE ☒ MULTIPLE ZONE ☐

2. NAME OF OPERATOR  
Texaco Producing Inc.

3. ADDRESS OF OPERATOR  
P. O. Box 3109, Midland, TX 79702

4. LOCATION OF WELL (Report location clearly and in accordance with any State requirements.)\*  
At surface  
2100' FSL, 2310' FWL, Unit Letter: K  
At proposed prod. zone  
Same

14. DISTANCE IN MILES AND DIRECTION FROM NEAREST TOWN OR POST OFFICE\*  
15.5 Miles SSE of Maljamar, New Mexico

15. DISTANCE FROM PROPOSED\*  
LOCATION TO NEAREST  
PROPERTY OR LEASE LINE, FT.  
(Also to nearest drlg. unit line, if any)  
1650' E

16. NO. OF ACRES IN LEASE  
520

17. NO. OF ACRES ASSIGNED  
TO THIS WELL  
40

18. DISTANCE FROM PROPOSED LOCATION\*  
TO NEAREST WELL, DRILLING, COMPLETED,  
OR APPLIED FOR, ON THIS LEASE, FT.  
876' N

19. PROPOSED DEPTH  
4450

20. ROTARY OR CABLE TOOLS  
Rotary

21. ELEVATIONS (Show whether DF, RT, GR, etc.)  
3677' FR

22. APPROX. DATE WORK WILL START\*  
3-26-90

5. LEASE REGISTRATION AND SERIAL NO.  
NM-56749

6. IF INDIAN, ALLOTTEE OR TRIBE NAME  
MAR 6 11 04 AM '90

7. UNIT AGREEMENT NAME  
CARLOS

8. NAME OF LEASE NAME  
Federal (USA) "L"

9. WELL NO.  
4

10. FIELD AND POOL, OR WILDCAT  
Tonto, Seven Rivers

11. SEC. T. R. M., OR BLK.  
AND SURVEY OR AREA  
Sec. 14, T-19-S, R-33-E

12. COUNTY OR PARISH  
Lea

13. STATE  
NM

PROPOSED CASING AND CEMENTING PROGRAM

SIZE OF HOLE	SIZE OF CASING	WEIGHT PER FOOT	SETTING DEPTH	QUANTITY OF CEMENT
17-1/2"	13-3/8"	48#	40'	Redimix to Surface
12-1/4"	8-5/8"	24#	1500'	1200 Sacks CIRCULATE
7-7/8"	5-1/2"	15.5#	4450'	925 Sacks (see stips)

CEMENTING PROGRAM

Surface Casing: 1200 Sacks Class "H" with 2% CaCl<sub>2</sub> (15.6 ppg, 1.19 cu.ft/sx, 5.2 gals water/sx)

Production Casing: 625 Sacks 35/65 Pozmix Class "H" with 6% Gel, 5% Salt, 1/4# Flocele (12.8 ppg, 1.87 cu.ft/sx, 10 gals water/sx.

Followed by: 300 Sacks Class "H" with 1/4# Flocele, 2% CaCl<sub>2</sub> (15.6 ppg, 1.18 cu.ft/sx, 5.2 Gals water/sx)

Manzano Oil Co. operates a well in this 1/4 1/4 Section and they have been furnished a copy of this application.

This is an amended Location. API #30-025-30692 is assigned to this well.

IN ABOVE SPACE DESCRIBE PROPOSED PROGRAM: If proposal is to deepen or plug back, give data on present productive zone and proposed new productive zone. If proposal is to drill or deepen directionally, give pertinent data on subsurface locations and measured and true vertical depths. Give blowout preventer program, if any.

24. SIGNED C. Wade Howard C. Wade Howard  
TITLE Engineer's Assistant DATE 3-2-90  
(This space for Federal or State office use)

PERMIT NO. \_\_\_\_\_ APPROVAL DATE \_\_\_\_\_  
APPROVED BY \_\_\_\_\_ TITLE \_\_\_\_\_ DATE 3-16-90

APPROVAL SUBJECT TO  
GENERAL REQUIREMENTS AND  
SPECIAL STIPULATIONS

ATTACHED

\*See Instructions On Reverse Side

Title 18 U.S.C. Section 1001, makes it a crime for any person knowingly and willfully to make to any department or agency of the United States any false, fictitious or fraudulent statements or representations as to any matter within its jurisdiction.

*amended location*

Submit to Appropriate  
District Office  
State Lease - 4 copies  
Fee Lease - 3 copies

State of New Mexico  
Energy, Minerals and Natural Resources Department

Form C-102  
Revised 1-1-89

OIL CONSERVATION DIVISION

P.O. Box 2088

Santa Fe, New Mexico 87504-2088

DISTRICT I

P.O. Box 1980, Hobbs, NM 88240

DISTRICT II

P.O. Drawer DD, Artesia, NM 88210

DISTRICT III

1000 Rio Brazos Rd., Aztec, NM 87410

WELL LOCATION AND ACREAGE DEDICATION PLAT

All Distances must be from the outer boundaries of the section

Operator <b>Texaco Producing Inc.</b>			Lease <b>Federal (USA) "L"</b>		Well No. <b>4</b>
Unit Letter <b>K</b>	Section <b>14</b>	Township <b>19 South</b>	Range <b>33 East</b>	County <b>Lea County</b>	
Actual Footage Location of Well: <b>2100</b> feet from the <b>South</b> line and <b>2310</b> feet from the <b>West</b> line					
Ground level Elev. <b>3677</b>	Producing Formation <b>Yates</b>		Pool <b>Tonto-Seven Rivers</b>		Dedicated Acreage: <b>40 Acres</b>

1. Outline the acreage dedicated to the subject well by colored pencil or hatchure marks on the plat below.
2. If more than one lease is dedicated to the well, outline each and identify the ownership thereof (both as to working interest and royalty).
3. If more than one lease of different ownership is dedicated to the well, have the interest of all owners been consolidated by communitization, unitization, force-pooling, etc.?  
☐ Yes ☐ No If answer is "yes" type of consolidation \_\_\_\_\_

If answer is "no" list the owners and tract descriptions which have actually been consolidated. (Use reverse side of this form if necessary.)

No allowable will be assigned to the well until all interests have been consolidated (by communitization, unitization, forced-pooling, or otherwise) or until a non-standard unit, eliminating such interest, has been approved by the Division.

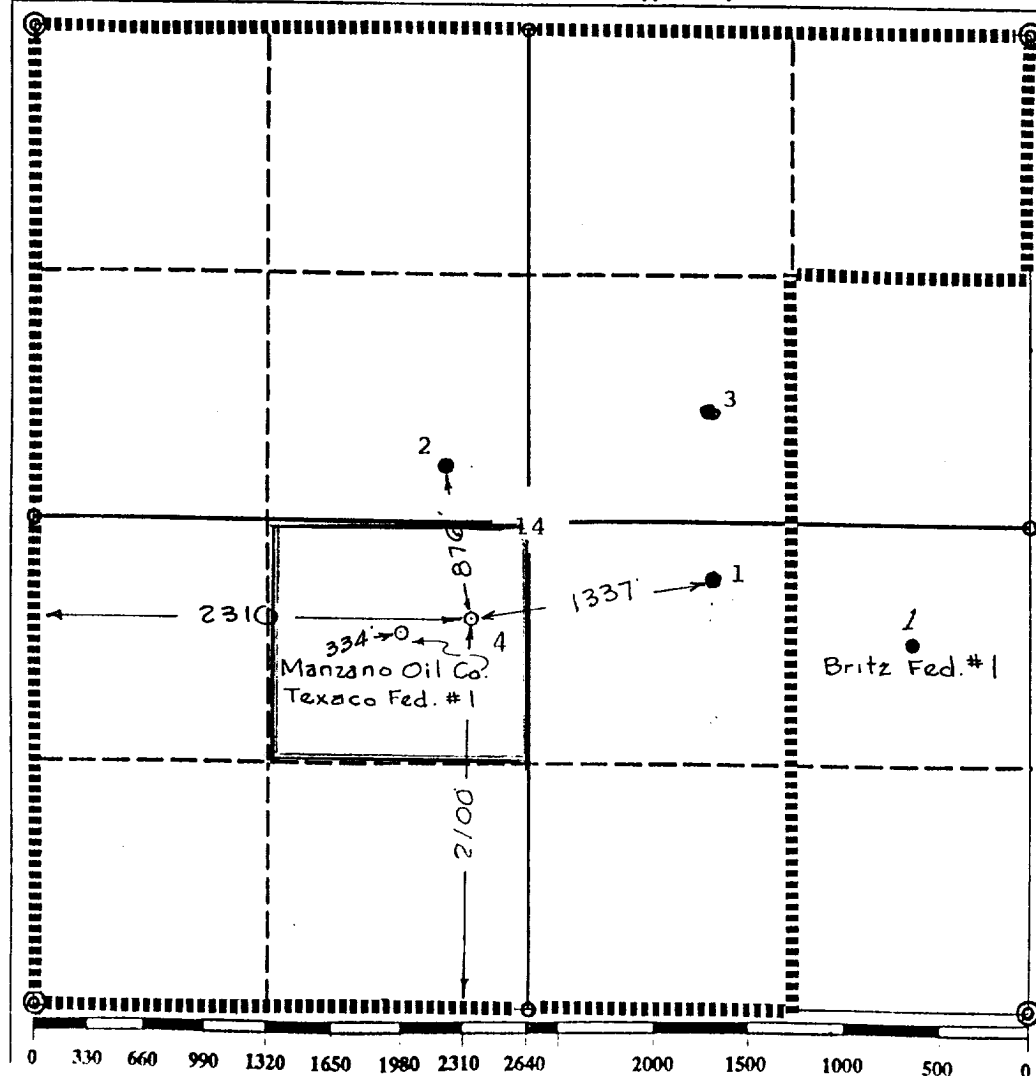

OPERATOR CERTIFICATION

I hereby certify that the information contained herein is true and complete to the best of my knowledge and belief.

Signature

*Royce D. Mariott*

Printed Name

Royce D. Mariott

Position

Division Surveyor

Company

Texaco Producing Inc.

Date

January 29, 1990

SURVEYOR CERTIFICATION

I hereby certify that the well location shown on this plat was plotted from field notes of actual surveys made by me or under my supervision, and that the same is true and correct to the best of my knowledge and belief.

Date Surveyed

January 25, 1990

Signature & Seal of  
Professional Surveyor

*John S. Piper*

Certificate No.

7254 John S. Piper

amended Plat