

OIL CONSERVATION DIVISION

P.O. Box 2088

Santa Fe, New Mexico 87504-2088

DISTRICT I

P.O. Box 1980, Hobbs, NM 88240

DISTRICT II

P.O. Drawer DD, Artesia, NM 88210

DISTRICT III

1000 Rio Brazos Rd., Aztec, NM 87410

WELL LOCATION AND ACREAGE DEDICATION PLAT

All Distances must be from the outer boundaries of the section

Operator Union Oil Company of California			Lease Laguna Deep Federal Unit		Well No. 4
Unit Letter B	Section 26	Township 19 South	Range 33 East	County Lea	
Actual Footage Location of Well: 660 feet from the North line and 1980 feet from the East line					
Ground level Elev. 3624.5		Producing Formation MORROW	Pool UNDESIGNATED EAST GEM MORROW GAS		Dedicated Acreage: 320 Acres

1. Outline the acreage dedicated to the subject well by colored pencil or hatchure marks on the plat below.

2. If more than one lease is dedicated to the well, outline each and identify the ownership thereof (both as to working interest and royalty).

3. If more than one lease of different ownership is dedicated to the well, have the interest of all owners been consolidated by communitization, unitization, force-pooling, etc.?



Yes



No

If answer is "yes" type of consolidation UNITIZATION

If answer is "no" list the owners and tract descriptions which have actually been consolidated. (Use reverse side of this form if necessary.)

No allowable will be assigned to the well until all interests have been consolidated (by communitization, unitization, forced-pooling, or otherwise) or until a non-standard unit, eliminating such interest, has been approved by the Division.

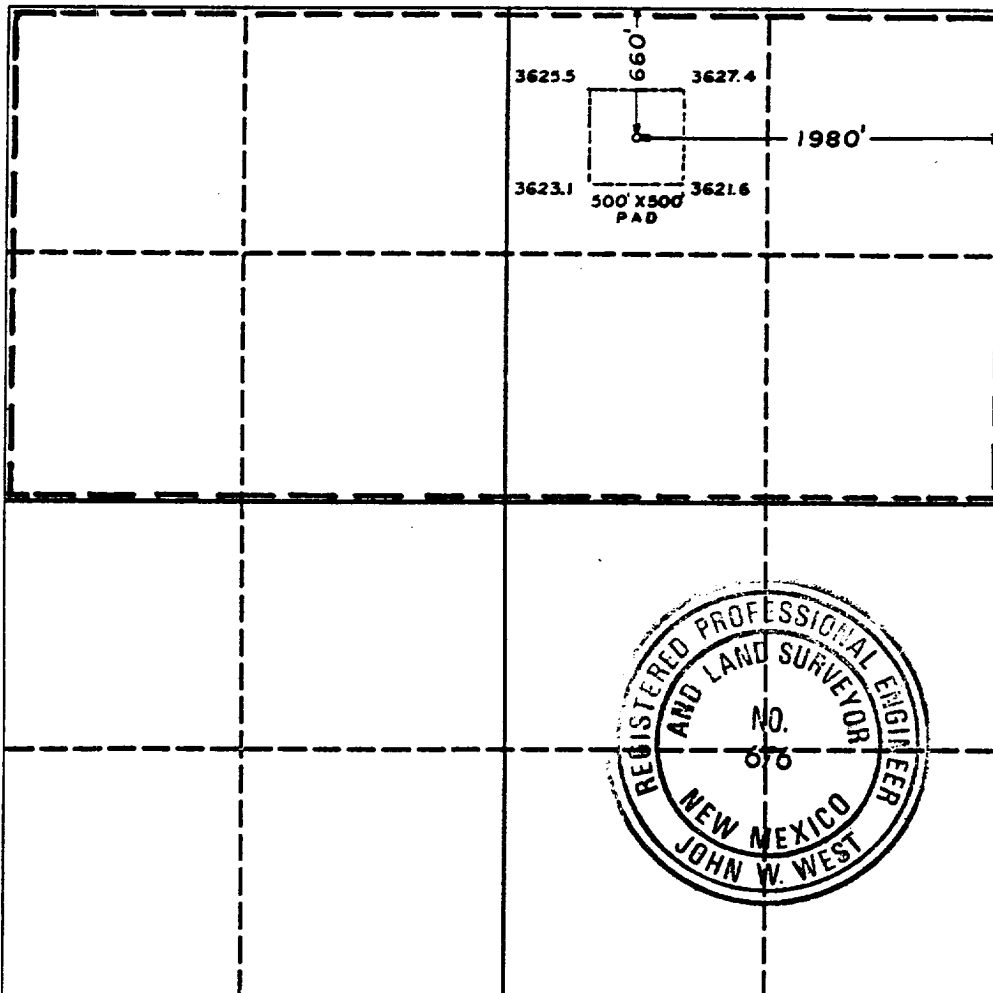

OPERATOR CERTIFICATION

I hereby certify that the information contained herein is true and complete to the best of my knowledge and belief.

Signature

Printed Name

Arthur R. Brown

Position

Agent

Company

UNION OIL COMPANY OF CALIF.

Date:

September 18, 1989

SURVEYOR CERTIFICATION

I hereby certify that the well location shown on this plat was plotted from field notes of actual surveys made by me or under my supervision, and that the same is true and correct to the best of my knowledge and belief.

Date Surveyed

September 6, 1989

Signature & Seal of
Professional Surveyor

Certificate No. JOHN W. WEST, 676

RONALD J. EIDSON, 3239