

Submit to Appropriate
District Office
State Lease - 6 copies
Fed. Lease - 5 copies

State of New Mexico
Energy, Minerals and Natural Resources Department

Form C-101
Revised 1-1-89

OIL CONSERVATION DIVISION

DISTRICT I
P.O. Box 1980, Hobbs, NM 88240

P.O. Box 2088

Santa Fe, New Mexico 87504-2088

DISTRICT II
P.O. Drawer DD, Artesia, NM 88210

DISTRICT III
1000 Rio Brazos Rd., Aztec, NM 87410

API NO. (assigned by OCD on New Wells)

30-025-30713

5. Indicate Type of Lease

STATE ☒

FEE ☐

6. State Oil & Gas Lease No.

548570

APPLICATION FOR PERMIT TO DRILL, DEEPEN, OR PLUG BACK

1a. Type of Work:

DRILL ☒

RE-ENTER ☐

DEEPEN ☐

PLUG BACK ☐

b. Type of Well:

OIL
WELL ☒

GAS
WELL ☐

OTHER

SINGLE
ZONE ☐

MULTIPLE
ZONE ☒

7. Lease Name or Unit Agreement Name

New Mexico "0" State NCT-1

2. Name of Operator

Texaco Producing Inc.

8. Well No.

30

3. Address of Operator

P. O. Box 3109, Midland, TX 79702

9. Pool name or Wildcat

Vacuum Glorieta & Vacuum
Blinebry

4. Well Location

Unit Letter

E

: 990

Feet From The West

Line and

1980

Feet From The North

Line

Section

36

Township

17 South

Range

34 East

NMPM

Lea

County

10. Proposed Depth

6600'

11. Formation

Glorieta & Blinebry

12. Rotary or C.T.

R

13. Elevations (Show whether DF, RT, GR, etc.)

GR 4005'

14. Kind & Status Plug. Bond

Blanket

15. Drilling Contractor

Basin

16. Approx. Date Work will start

10/31/89

17.

PROPOSED CASING AND CEMENT PROGRAM

| SIZE OF HOLE | SIZE OF CASING | WEIGHT PER FOOT | SETTING DEPTH | SACKS OF CEMENT | EST. TOP |
|--------------|----------------|-----------------|---------------|-----------------|----------|
| 20" | 16" | 94# | 40' | Ready-Mix | Surface |
| 15" | 11 3/4" | 42# | 1550' | 1300 sx | Surface |
| 11" | 8 5/8" | 32# | 3000' | 750 sx | Surface |
| 7 7/8" | 5 1/2" | 15.5# | 6600' | 1000 sx | Surface |

CEMENTING PROGRAM

Conductor Casing: Ready-Mix.

Surface Casing: 1300 sacks Class "H" with 2% CaCl_2 & $\frac{1}{4}\#$ Flocele (15.6 ppg, 1.19 cu ft/sx, 5.2 gal wtr/sx).

Intermediate Casing: 500 sacks 35/65 Pozmix Class "H" with 6% gel, 5% salt (12.8 ppg, 1.87 cu ft sx, 9.9 gals wtr/sx), followed by: 250 sacks Class "H" with 2% CaCl_2 (15.6 ppg, 1.19 cu ft/sx, 5.2 gals wtr/sx).

Production Casing: 300 sacks Class "H" with $\frac{1}{4}\#$ Flocele (15.6 ppg, 1.18 cu ft/sx, 5.2 gals wtr/sx)

DV Tool @ 5000': 450 sacks 35/65 Pozmix Class "H" with 6% gel, 5% salt, $\frac{1}{4}\#$ Flocele (12.8 ppg, 1.87 cu ft/sx, 9.9 gals wtr/sx), followed by: 250 sacks Class "H" (15.6 ppg, 1.18 cu ft/sx, 5.2 gals wtr/sx).

No other operator in this $\frac{1}{4}$ Section.

IN ABOVE SPACE DESCRIBE PROPOSED PROGRAM: IF PROPOSAL IS TO DEEPEN OR PLUG BACK, GIVE DATA ON PRESENT PRODUCTIVE ZONE AND PROPOSED NEW PRODUCTIVE ZONE. GIVE BLOWOUT PREVENTER PROGRAM, IF ANY.

I hereby certify that the information above is true and complete to the best of my knowledge and belief.

SIGNATURE

C. Wade Howard

TITLE

Engineering Assistant

DATE

10/19/89

TYPE OR PRINT NAME

C. Wade Howard

(915)

TELEPHONE NO

688-4606

(This space for State Use)

Eddie W. Seay

APPROVED BY

Oil & Gas Inspector

TITLE

DATE

OCT 24 1989

CONDITIONS OF APPROVAL, IF ANY:

Permit Expires 6 Months From Approval
Date Unless Drilling Underway.

Submit to Appropriate
District Office
State Lease - 4 copies
Fee Lease - 3 copies

State of New Mexico
Energy, Minerals and Natural Resources Department

Form C-102
Revised 1-1-89

OIL CONSERVATION DIVISION

DISTRICT I
P.O. Box 1980, Hobbs, NM 88240

P.O. Box 2088

Santa Fe, New Mexico 87504-2088

DISTRICT II
P.O. Drawer DD, Artesia, NM 88210

DISTRICT III
1000 Rio Brazos Rd., Aztec, NM 87410

WELL LOCATION AND ACREAGE DEDICATION PLAT

All Distances must be from the outer boundaries of the section

| | | | | | |
|---|---------------------------------|--|-------------------------------------|---------------|--------------------------------|
| Operator TEXACO PRODUCING INC. | | | Lease New Mexico "O" State NCT-1 | | Well No. 30 |
| Unit Letter E | Section 36 | Township 17 South | Range 34 East | County Lea | |
| Actual Footage Location of Well: 990 feet from the West line and 1980 feet from the North line | | | | | |
| Ground level Elev. 4005 | Producing Formation Glorieta | Pool VACUUM BLINDBAY VACUUM GLORIETA | | | Dedicated Acreage: 40 Acres |

- Outline the acreage dedicated to the subject well by colored pencil or hatchure marks on the plat below.
- If more than one lease is dedicated to the well, outline each and identify the ownership thereof (both as to working interest and royalty).
- If more than one lease of different ownership is dedicated to the well, have the interest of all owners been consolidated by communization, unitization, force-pooling, etc.?
☐ Yes ☐ No If answer is "yes" type of consolidation _____
If answer is "no" list the owners and tract descriptions which have actually been consolidated. (Use reverse side of this form if necessary). _____
No allowable will be assigned to the well until all interests have been consolidated (by communization, unitization, forced-pooling, or otherwise) or until a non-standard unit, eliminating such interest, has been approved by the Division.

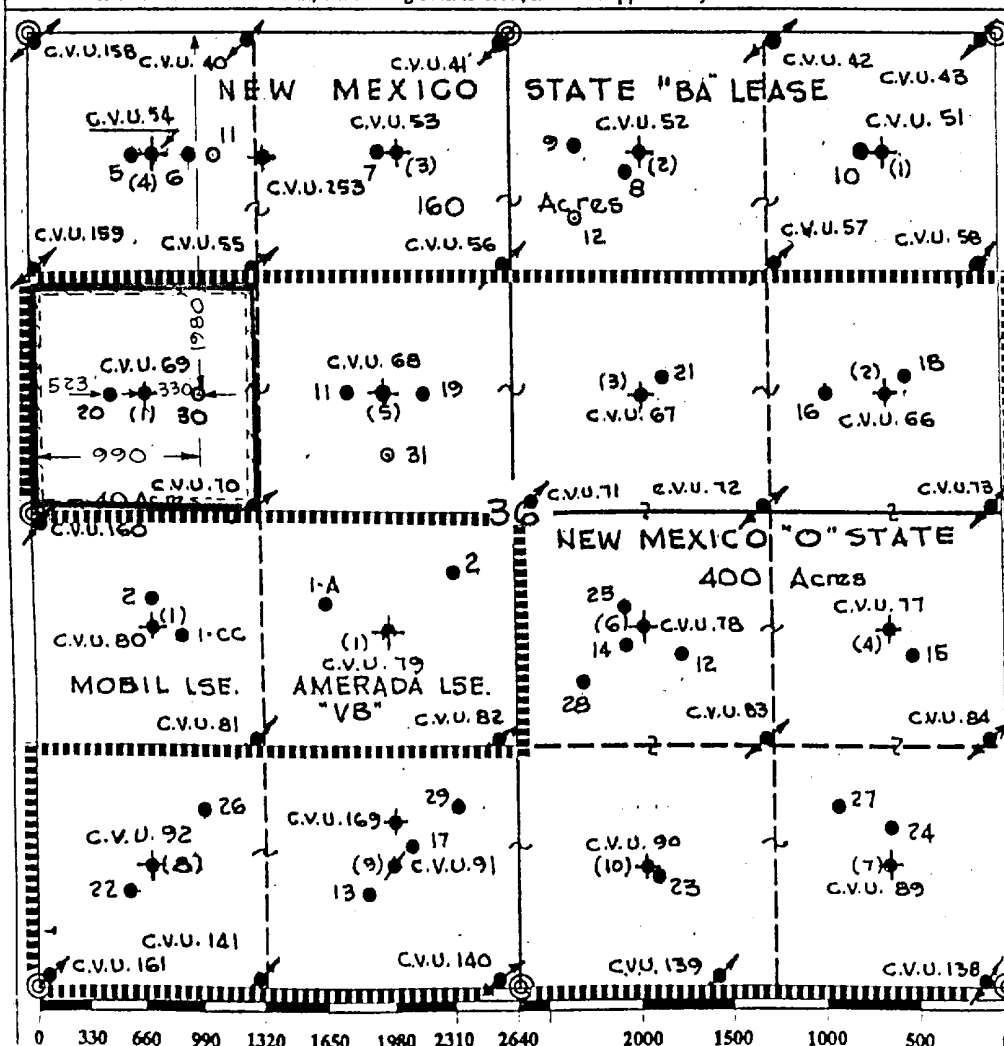

OPERATOR CERTIFICATION

I hereby certify that the information contained herein is true and complete to the best of my knowledge and belief.

Signature

Printed Name

Royce Mariott

Position

Division Surveyor

Company

Texaco Producing Inc.

Date

October 9, 1989

SURVEYOR CERTIFICATION

I hereby certify that the well location shown on this plat was plotted from field notes of actual surveys made by me or under my supervision, and that the same is true and correct to the best of my knowledge and belief.

Date Surveyed

October 5 & 6, 1989

Signature & Seal of
Professional Surveyor

John S. Piper

Certificate No.

7254

RECEIVED

OCT 23 1989

CCD
MOBBS OFFICE

DRILLING CONTROL **CONDITION III-B 3000 PSI WP**

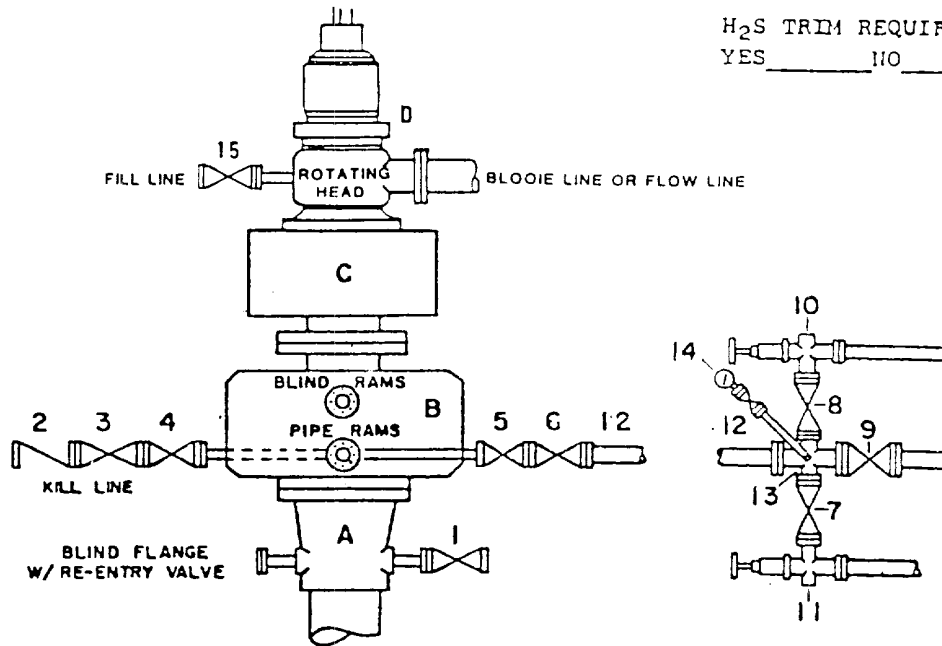

H₂S TRIM REQUIRED
 YES _____ NO _____

DRILLING CONTROL

MATERIAL LIST - CONDITION III - B

- | | |
|-------------|---|
| A | Texaco Wellhead |
| B | 3000# W.P. Dual ram type preventer, hydraulic operated with 1" steel, 3000# W.P. control lines (where sub-structure height is adequate, 2 - 3000# W.P. single ram preventers may be utilized with 3000# W.P. drilling spool with 2" minimum flanged outlet for kill line and 3" minimum flanged outlet for choke line. The drilling spool is to be installed below the single ram type preventers). |
| C | 3000# W.P. Annular Preventer with 1" steel, 3000# W.P. control lines. |
| D | Rotating Head with fill up outlet and extended Bloop line. |
| 1,3,4, 7,8, | 2" minimum 3000# W.P. flanged full opening steel gate valve, or Halliburton Lo Torc Plug valve. |
| 2 | 2" minimum 3000# W.P. back pressure valve. |
| 5,6,9 | 3" minimum 3000# W.P. flanged full opening steel gate valve, or Halliburton Lo Torc Plug valve. |
| 12 | 3" minimum Schedule 80, Grade B, seamless line pipe. |
| 13 | 2" minimum x 3" minimum 3000# W.P. flanged cross. |
| 10,11 | 2" minimum 3000# W.P. adjustable choke bodies. |
| 14 | Cameron Mud Gauge or equivalent (location optional in Choke line). |
| 15 | 2" minimum 3000# W.P. flanged or threaded full opening steel gate valve, or Halliburton Lo Torc Plug valve. |



TEXACO, INC.
 MIDLAND DIVISION
 MIDLAND, TEXAS



| SCALE | DATE | EST NO | DRG NO |
|-------------|------|--------|--------|
| DRAWN BY | | | |
| CHECKED BY | | | |
| APPROVED BY | | | |

EXHIBIT E