

OIL CONSERVATION DIVISION

DISTRICT I
P.O. Box 1980, Hobbs, NM 88240

P.O. Box 2088
Santa Fe, New Mexico 87504-2088

DISTRICT II
P.O. Drawer DD, Artesia, NM 88210

DISTRICT III
1000 Rio Brazos Rd., Aztec, NM 87410

WELL LOCATION AND ACREAGE DEDICATION PLAT

All Distances must be from the outer boundaries of the section

Operator Santa Fe Energy Operating Partners LP			Lease Uncle Sam Federal 13 ¹³		Well No. 1
Unit Letter B	Section 13	Township 18 South	Range 32 East	County Lea	NMPM
Actual Footage Location of Well: 1980 feet from the East line and 990 feet from the North line					
Ground level Elev. 3848.6	Producing Formation Delaware		Pool Und. Delaware ^{West Carbon}		Dedicated Acreage: 40 Acres

1. Outline the acreage dedicated to the subject well by colored pencil or hatchure marks on the plat below.
2. If more than one lease is dedicated to the well, outline each and identify the ownership thereof (both as to working interest and royalty).
3. If more than one lease of different ownership is dedicated to the well, have the interest of all owners been consolidated by communitization, unitization, force-pooling, etc.?
- ☐ Yes ☒ No If answer is "yes" type of consolidation _____
- If answer is "no" list the owners and tract descriptions which have actually been consolidated. (Use reverse side of this form if necessary.) _____
- No allowable will be assigned to the well until all interests have been consolidated (by communitization, unitization, forced-pooling, or otherwise) or until a non-standard unit, eliminating such interest, has been approved by the Division.

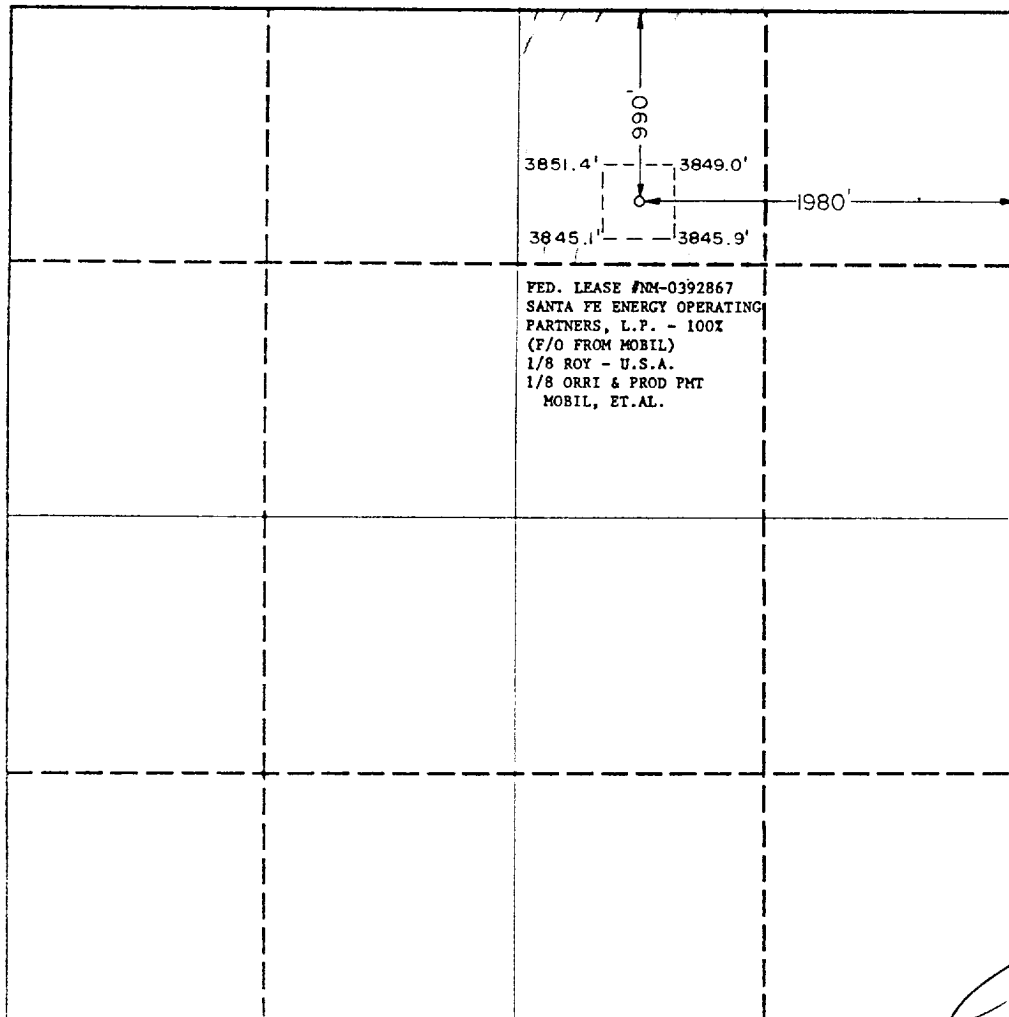

OPERATOR CERTIFICATION

I hereby certify that the information contained herein is true and complete to the best of my knowledge and belief.

Witnessed & Subscribed by the Honorable
Signature _____

Thomas E. Centry

Printed Name
Michael R. Burton

Position
District Drilling Engineer

Company Santa Fe Energy
Operating Partners, L.P.

Date 10-10-89

SURVEYOR CERTIFICATION

I hereby certify that the well location shown on this plat was plotted from field notes of actual surveys made by me or under my supervision, and that the same is true and correct to the best of my knowledge and belief.

Date Surveyed _____

~~September 30, 1989~~

Signature & Seal of Professional Surveyor

Certificate No. JOHN W. WEST 575
RONALD J. EDSON 3239