

Submit to Appropriate
Office
Lease - 4 copies
Lease - 3 copies

State of New Mexico
Department of Minerals and Natural Resources

Form C-102
Revised 1-1-89

OIL CONSERVATION DIVISION

P.O. Box 2088
Santa Fe, New Mexico 87504-2088

PIC I
Box 1980, Hobbs, NM 88240

PIC II
Drawer DD, Artesia, NM 88210

PIC III
Rto Brazos Rd., Aztec, NM 87410

WELL LOCATION AND ACREAGE DEDICATION PLAT

All Distances must be from the outer boundaries of the section

Manzano Oil Corporation			Lease Texaco Federal		Well No. 1
Letter K	Section 14	Township 19 South	Range 33 East	County Lea	NMPM
Well Location of Well: 2060 feet from the South line and 1980 feet from the West line					
and level Elev. 3673	Producing Formation Wolfcamp		Pool Tonto Wolfcamp		Dedicated Acreage: 160 40 Acres

1. Outline the acreage dedicated to the subject well by colored pencil or hatchure marks on the plat below.

2. If more than one lease is dedicated to the well, outline each and identify the ownership thereof (both as to working interest and royalty).

3. If more than one lease of different ownership is dedicated to the well, have the interest of all owners been consolidated by communitization, unitization, force-pooling, etc.?

☐ Yes ☐ No

If answer is "yes" type of consolidation

If answer is "no" list the owners and tract descriptions which have actually been consolidated. (Use reverse side of this form if necessary.)

No allowable will be assigned to the well until all interests have been consolidated (by communitization, unitization, forced-pooling, or otherwise) or until a non-standard unit, eliminating such interest, has been approved by the Division.

NM-56749
Texaco = 100% (farmout)

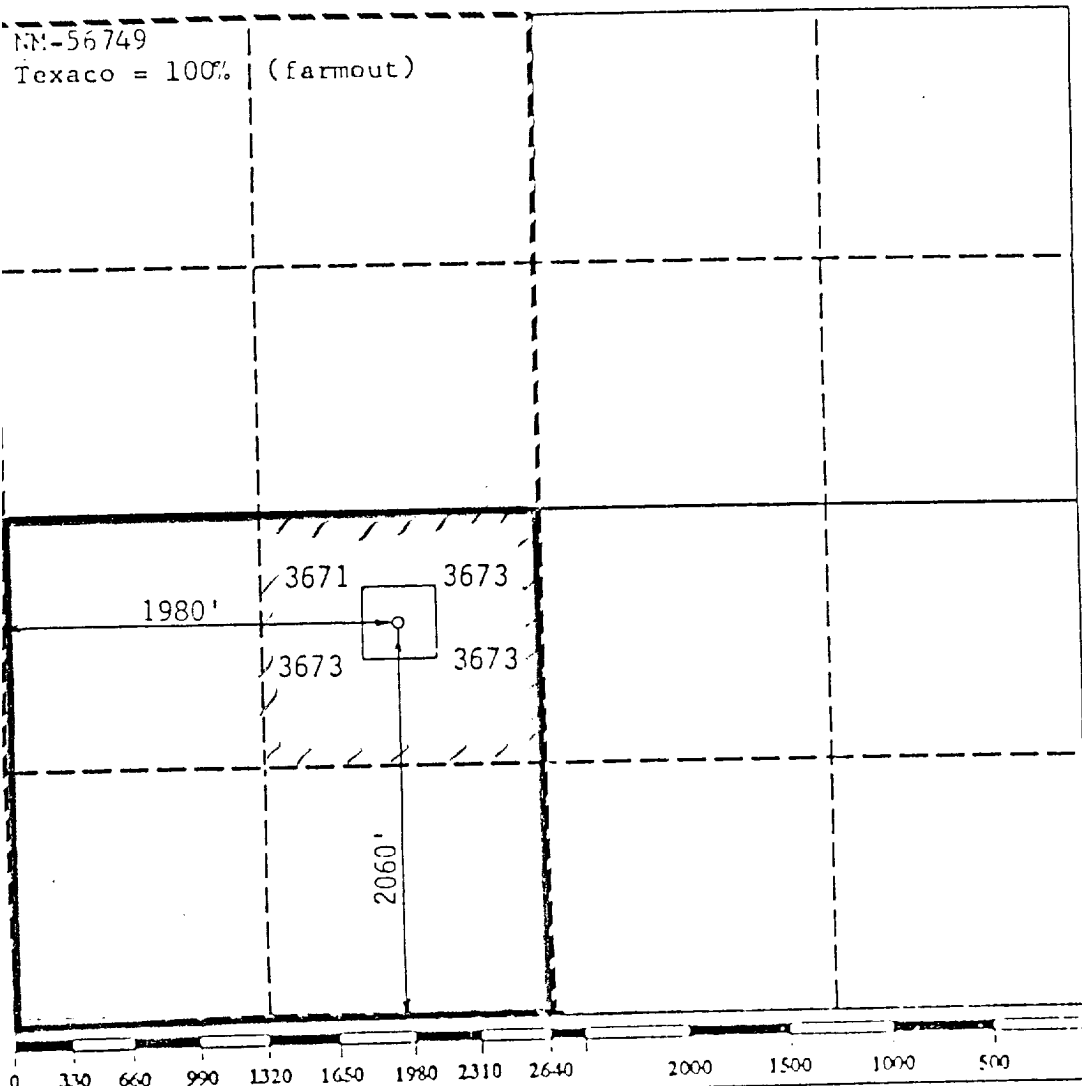

OPERATOR CERTIFICATION

I hereby certify that the information contained herein is true and complete to the best of my knowledge and belief.

Signature

Printed Name

George R. Smith

Position

Agent for:

Company

Manzano Oil Corp.

Date

April 27, 1990

SURVEYOR CERTIFICATION

I hereby certify that the well location shown on this plat was plotted from field notes of actual surveys made by me or under my supervision, and that the same is true and correct to the best of my knowledge and belief.

Date Surveyed

November 30, 1989

Signature & Seal of Professional Surveyor

P. R. Patton

Certificate No.

8112