

UNITED STATES
DEPARTMENT OF THE INTERIOR
BUREAU OF LAND MANAGEMENT

APPLICATION FOR PERMIT TO DRILL, DEEPEN, OR PLUG BACK

1a. TYPE OF WORK DRILL <input checked="" type="checkbox"/> DEEPEN <input type="checkbox"/> PLUG BACK <input type="checkbox"/>			5. LEASE DESIGNATION AND SERIAL NO. NM-12567		
b. TYPE OF WELL OIL WELL <input checked="" type="checkbox"/> GAS WELL <input type="checkbox"/> OTHER <input type="checkbox"/> SINGLE ZONE <input type="checkbox"/> MULTIPLE ZONE <input type="checkbox"/>			6. IF INDIAN, ALLOTTEE OR TRIBE NAME		
2. NAME OF OPERATOR Harvey E. Yates Company			7. UNIT AGREEMENT NAME Young Deep Unit		
3. ADDRESS OF OPERATOR P.O. Box 1933, Roswell, New Mexico 88202			8. FARM OR LEASE NAME		
4. LOCATION OF WELL (Report location clearly and in accordance with any State requirements.) At surface 1650' FNL & 660' FWL At proposed prod. zone same			9. WELL NO. #24		
14. DISTANCE IN MILES AND DIRECTION FROM NEAREST TOWN OR POST OFFICE* 6 miles south of Maljamar, New Mexico			10. FIELD AND POOL, OR WILDCAT North Young Bone Springs		
10. DISTANCE FROM PROPOSED* LOCATION TO NEAREST PROPERTY OR LEASE LINE, FT. (Also to nearest drlg. unit line, if any) 660'			11. SEC., T., R., M., OR BLE. AND SURVEY OR AREA Sec. 10, T18S, R32E		
18. DISTANCE FROM PROPOSED LOCATION* TO NEAREST WELL, DRILLING, COMPLETED, OR APPLIED FOR, ON THIS LEASE, FT. N-A			12. COUNTY OR PARISH Lea		
21. ELEVATIONS (Show whether DF, RT, GR, etc.) 3834.9 GL			13. STATE N.M.		
16. NO. OF ACRES IN LEASE 40			17. NO. OF ACRES ASSIGNED TO THIS WELL 40		
19. PROPOSED DEPTH 9220			20. ROTARY OR CABLE TOOLS Rotary		
22. APPROX. DATE WORK WILL START* ASAP					

23. PROPOSED CASING AND CEMENTING PROGRAM				
SIZE OF HOLE	SIZE OF CASING	WEIGHT PER FOOT	SETTING DEPTH	QUANTITY OF CEMENT
17 1/2	13 3/8	54.5	400	Approx 400 sks CIRCULATE
12 1/4	8 5/8	32	2800	Approx 1200 sks CIRCULATE
7 7/8	5 1/2	17	9220	Approx 350 sks

MUD PROGRAM:

0 - 400 FW w/paper
400 - 2800 Brine water
2800 - 9220 FW mud

APPROVAL SUBJECT TO
GENERAL REQUIREMENTS AND
SPECIAL STIPULATIONS

ATTACHED

IN ABOVE SPACE DESCRIBE PROPOSED PROGRAM: If proposal is to deepen or plug back, give data on present productive zone and proposed new productive zone. If proposal is to drill or deepen directionally, give pertinent data on subsurface locations and measured and true vertical depths. Give blowout preventer program, if any.

24. SIGNED N.M. Young NM Young TITLE Drilling Superintendent DATE 1/10/90
(This space for Federal or State office use)

PERMIT NO. _____ APPROVAL DATE _____
Orig. St. ... AREA MANAGER
APPROVED BY _____ TITLE CAP. STAD. RESOURCES DATE 1-19-90
CONDITIONS OF APPROVAL, IF ANY:

*See Instructions On Reverse Side

Title 18 U.S.C. Section 1001, makes it a crime for any person knowingly and willfully to make to any department or agency of the United States any false, fictitious or fraudulent statements or representations as to any matter within its jurisdiction.

Submit to Appropriate
District Office
State Lease - 4 copies
Fee Lease - 3 copies

State of New Mexico
Energy, Minerals and Natural Resources Department

Form C-102
Revised 1-1-89

OIL CONSERVATION DIVISION

P.O. Box 2088
Santa Fe, New Mexico 87504-2088

DISTRICT I
P.O. Box 1980, Hobbs, NM 88240

DISTRICT II
P.O. Drawer DD, Artesia, NM 88210

DISTRICT III
1000 Rio Brazos Rd., Aztec, NM 87410

WELL LOCATION AND ACREAGE DEDICATION PLAT

All Distances must be from the outer boundaries of the section

Operator Harvey E. Yates Company			Lease Young Deep Federal		Well No. 24
Unit Letter E	Section 10	Township 18 South	Range 32 East	County NMPM Lea	
Actual Footage Location of Well: 1650 feet from the North line and 660 feet from the West line					
Ground level Elev. 3834.9	Producing Formation Bone Springs		Pool North Young	Dedicated Acreage: 40 Acres	

1. Outline the acreage dedicated to the subject well by colored pencil or hatchure marks on the plat below.
2. If more than one lease is dedicated to the well, outline each and identify the ownership thereof (both as to working interest and royalty).
3. If more than one lease of different ownership is dedicated to the well, have the interest of all owners been consolidated by communitization, unitization, force-pooling, etc?
☒ Yes ☐ No If answer is "yes" type of consolidation Unitization
If answer is "no" list the owners and tract descriptions which have actually been consolidated. (Use reverse side of this form if necessary.)
No allowable will be assigned to the well until all interests have been consolidated (by communitization, unitization, forced-pooling, or otherwise) or until a non-standard unit, eliminating such interest, has been approved by the Division.

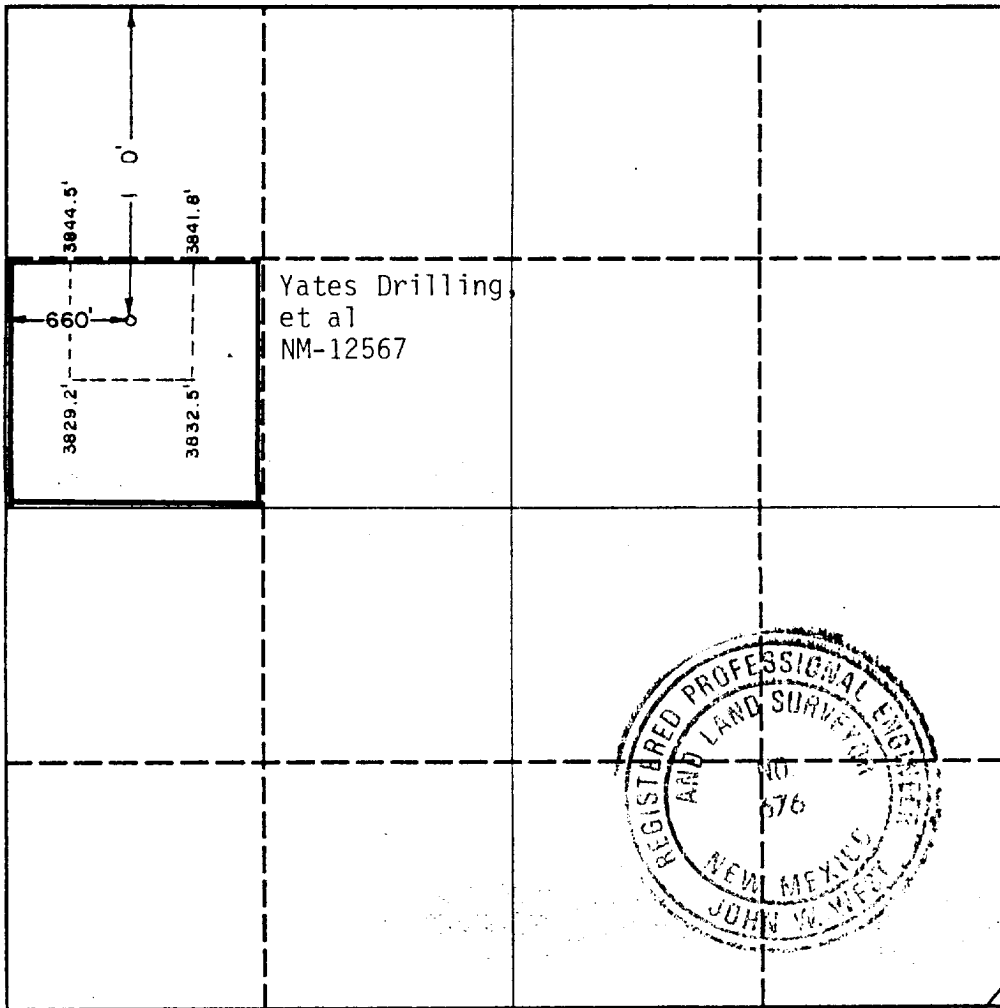

OPERATOR CERTIFICATION

I hereby certify that the information contained herein is true and complete to the best of my knowledge and belief.

Signature
[Signature]
Printed Name
NM Young
Position
Drilling Superintendent
Company
Harvey E. Yates Company
Date
1/10/90

SURVEYOR CERTIFICATION

I hereby certify that the well location shown on this plat was plotted from field notes of actual surveys made by me or under my supervision, and that the same is true and correct to the best of my knowledge and belief.

Date Surveyed
December 29, 1989
Signature & Seal of
Professional Surveyor

[Signature]
Certificate No. JOHN W. WEST, 676
RONALD J. EIDSON, 3239

0 330 660 990 1320 1650 1980 2310 2640 2000 1000 1500 500 0

HEYCO

PETROLEUM PRODUCERS



HARVEY E. YATES COMPANY

P.O. BOX 1933

ONE SUNWEST CENTRE

505/623-6601

FAX 505/622-4221

ROSWELL, NEW MEXICO 88202-1933

January 10, 1990

Williams and Sons Cattle Company
Billy Williams
803 Clayton
Artesia, New Mexico 88210

Re: Young Deep Unti #24
1650' FNL & 660' FWL
Sec. 10, T18S, R32E
Lea County, New Mexico

Dear Mr. Caviness,

Enclosed please find a check to cover the damages on the captioned well.

We are planning to drill the well and will not need to build additional road to the location. The caliche will be obtained from the pit located next to the location. We will clean up the pit area and location if the well is not successful.

If you have any questions, please do not hesitate to call.

Sincerely,

Dan Girand by O.T.
Dan Girand
Contracts Administrator

enclosure

landown

Application
HARVEY E. YATES COMPANY
Young Deep Unit #24
Sec. 10, T18S, R32E
Lea County, New Mexico

In conjunction with Form 3160-3, Application for Permit to Drill the Subject well in Section 10, Township 18 South, Range 32 East, Lea County, New Mexico, Harvey E. Yates Company submits the following ten items of pertinent information in accordance with Bureau of Land Management requirements:

1. The geologic surface formation is quaternary alluvium and bolson deposits and other surficial deposits.
2. The estimated tops of geologic markers are as follow:

Rustler	1200'	Penrose	4140'
Yates	2720'	Grayburg	4415'
Seven Rivers	3150'	San Andres	4790'
Bowers	3600'	Bone Springs	6265'
Queen	3865'	TD	9220'
3. We do not anticipate finding water but have listed the formation in which we anticipate finding oil or gas.

Bone Spring	6265'
-------------	-------
4. Proposed casing program: See Form 3160-3. HEYCO will be running some used casing when applicable.
5. Pressure control equipment: See Exhibit C. Although the rig equipment is 3M rated, this well will be a 2M PSI rating.
6. Mud program: See Form 3160-3.
7. Auxiliary equipment: Blowout preventer
8. Testing, logging and coring programs: We do not plan to core or DST. The planned logs are DLL/Micro w/GR and Caliper, CN-Den w/GR and Caliper.
9. No abnormal pressures or temperatures are anticipated.
10. Anticipated starting date: As soon as possible.

Harvey E. Yates Co
Young Deep Unit #24
1650' FNL & 660' FWL
Sec. 10 T-18S R-32E
Lea Co., New Mexico

900 Series

