

UNITED STATES  
DEPARTMENT OF THE INTERIOR  
BUREAU OF LAND MANAGEMENT

APPLICATION FOR PERMIT TO DRILL, DEEPEN, OR PLUG BACK

1a. TYPE OF WORK

DRILL ☒

DEEPEN ☐

PLUG BACK ☐

b. TYPE OF WELL

OIL  
WELL ☒

GAS  
WELL ☐

OTHER

SINGLE  
ZONE ☐

MULTIPLE  
ZONE ☐

2. NAME OF OPERATOR

Harvey E. Yates Company

3. ADDRESS OF OPERATOR

P.O. Box 1933, Roswell, New Mexico 88202

4. LOCATION OF WELL (Report location clearly and in accordance with any State requirements.)\*

At surface

2310' FNL & 990' FEL

At proposed prod. zone

same

14. DISTANCE IN MILES AND DIRECTION FROM NEAREST TOWN OR POST OFFICE\*

7 miles south of Maljamar, N.M.

15. DISTANCE FROM PROPOSED\*

LOCATION TO NEAREST  
PROPERTY OR LEASE LINE, FT.  
(Also to nearest drlg. unit line, if any)

990'

16. NO. OF ACRES IN LEASE

321.22

17. NO. OF ACRES ASSIGNED  
TO THIS WELL

40

18. DISTANCE FROM PROPOSED LOCATION\*

TO NEAREST WELL, DRILLING, COMPLETED,  
OR APPLIED FOR, ON THIS LEASE, FT.

1044'

19. PROPOSED DEPTH

8980

20. ROTARY OR CABLE TOOLS

Rotary

21. ELEVATIONS (Show whether DF, RT, GR, etc.)

3900.2 GL

22. APPROX. DATE WORK WILL START\*

ASAP

23.

PROPOSED CASING AND CEMENTING PROGRAM

SIZE OF HOLE	SIZE OF CASING	WEIGHT PER FOOT	SETTING DEPTH	QUANTITY OF CEMENT
17 1/2	13 3/8	54.5	400	Approx 400 sks
12 1/4	8 5/8	32	2800	Approx 1200 sks
7 7/8	5 1/2	17	8980	Approx 350 sks

MUD PROGRAM:

0 - 400 FW w/paper  
400 - 2800 Brine water  
2800 - 8980 Fw mud

IN ABOVE SPACE DESCRIBE PROPOSED PROGRAM: If proposal is to deepen or plug back, give data on present productive zone and proposed new productive zone. If proposal is to drill or deepen directionally, give pertinent data on subsurface locations and measured and true vertical depths. Give blowout preventer program, if any.

24.

SIGNED N.M. Young NM Young TITLE Drilling Superintendent DATE 1/10/90

(This space for Federal or State office use)

PERMIT NO. \_\_\_\_\_ APPROVAL DATE \_\_\_\_\_

APPROVED BY \_\_\_\_\_ TITLE \_\_\_\_\_ DATE 1-19-90

CONDITIONS OF APPROVAL, IF ANY:

\*See Instructions On Reverse Side

Title 18 U.S.C. Section 1001, makes it a crime for any person knowingly and willfully to make to any department or agency of the United States any false, fictitious or fraudulent statements or representations as to any matter within its jurisdiction.

RECEIVED

JAN 22 1990

U.S. DEPT. OF JUSTICE  
FEDERAL BUREAU OF INVESTIGATION

Submit to Appropriate  
District Office  
State Lease - 4 copies  
Fee Lease - 3 copies

State of New Mexico  
Energy, Minerals and Natural Resources Department

DEC 04 1990

Form C-102  
Revised 1-1-89

OIL CONSERVATION DIVISION

DISTRICT I  
P.O. Box 1980, Hobbs, NM 88240

P.O. Box 2088

Santa Fe, New Mexico 87504-2088

DISTRICT II  
P.O. Drawer DD, Artesia, NM 88210

DISTRICT III  
1000 Rio Brazos Rd., Aztec, NM 87410

WELL LOCATION AND ACREAGE DEDICATION PLAT

All Distances must be from the outer boundaries of the section

Operator HARVEY E. YATES CO.			Lease North Young Fed. "3"		Well No. 1
Unit Letter H	Section 3	Township 18 South	Range 32 East	County Lea	
Actual Footage Location of Well: 2310 feet from the North line and 990 feet from the East line					
Ground level Elev. 3900.2	Producing Formation Bone Springs	Pool North Young		Dedicated Acreage: 40 Acres	

1. Outline the acreage dedicated to the subject well by colored pencil or hatchure marks on the plat below.
2. If more than one lease is dedicated to the well, outline each and identify the ownership thereof (both as to working interest and royalty).
3. If more than one lease of different ownership is dedicated to the well, have the interest of all owners been consolidated by communitization, unitization, force-pooling, etc?  
☐ Yes ☐ No If answer is "yes" type of consolidation \_\_\_\_\_  
If answer is "no" list the owners and tract descriptions which have actually been consolidated. (Use reverse side of this form if necessary).  
No allowable will be assigned to the well until all interests have been consolidated (by communitization, unitization, forced-pooling, or otherwise) or until a non-standard unit, eliminating such interest, has been approved by the Division.

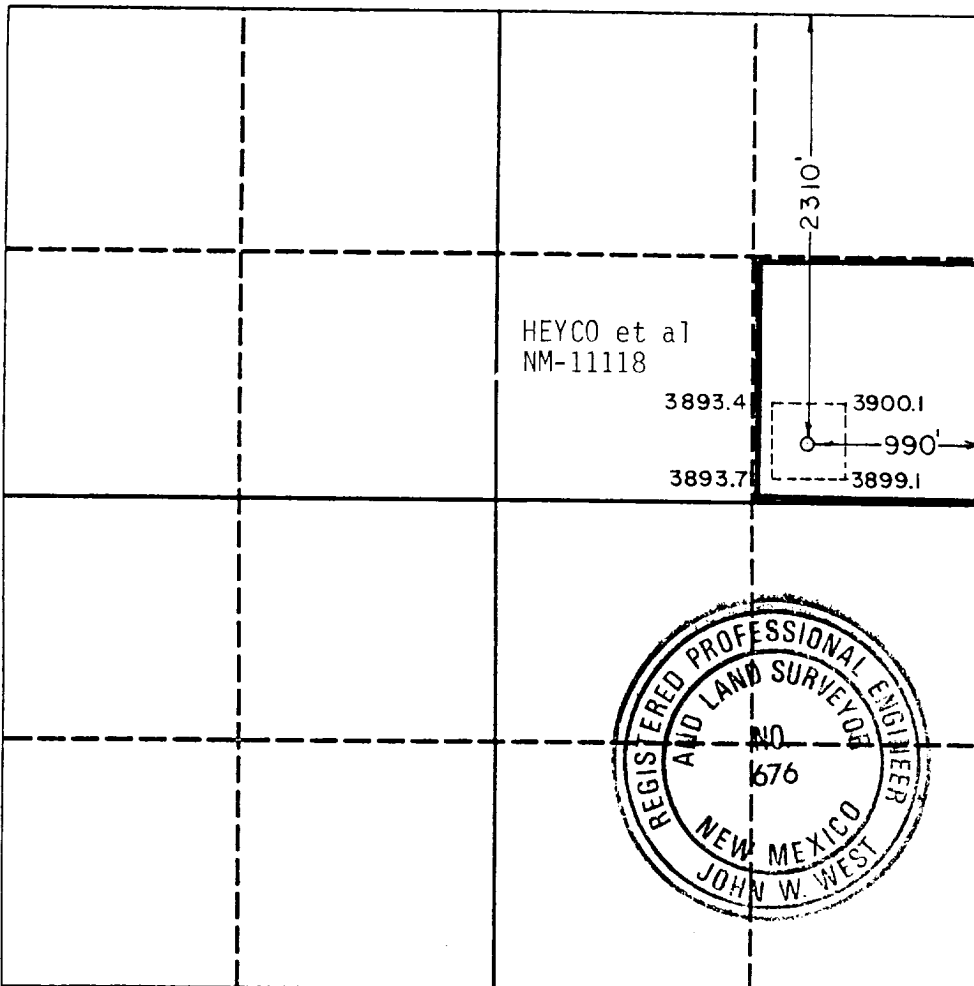

OPERATOR CERTIFICATION

I hereby certify that the information contained herein is true and complete to the best of my knowledge and belief.

Signature  
*A. M. Young*  
Printed Name  
NM Young  
Position  
Drilling Superintendent  
Company  
Harvey E. Yates Company  
Date  
1/10/90

SURVEYOR CERTIFICATION

I hereby certify that the well location shown on this plat was plotted from field notes of actual surveys made by me or under my supervision, and that the same is true and correct to the best of my knowledge and belief.

Date Surveyed  
DECEMBER 30, 1989  
Signature & Seal of Professional Surveyor  
*John W. West*  
Certificate No. JOHN W. WEST, 676  
RONALD J. EIDSON, 3239

Application  
HARVEY E. YATES COMPANY  
North Young 3 Federal #1  
Sec. 3, T18S, R32E  
Lea County, New Mexico

In conjunction with Form 3160-3, Application for Permit to Drill the Subject well in Section 3, Township 18 South, Range 32 East, Lea County, New Mexico, Harvey E. Yates Company submits the following ten items of pertinent information in accordance with Bureau of Land Management requirements:

1. The geologic surface formation is quaternary alluvium and bolson deposits and other surficial deposits.
2. The estimated tops of geologic markers are as follow:

Rustler	1230'	Penrose	4115'
Yates	2700'	Grayburg	4390'
Seven Rivers	3130'	San Andres	4770'
Bowers	3590'	Bone Spring	6000'
Queen	3860'	TD	8980'
3. We do not anticipate finding water but have listed the formation in which we anticipate finding oil or gas.  
  
Bone Springs 6000'
4. Proposed casing program: See Form 3160-3. HEYCO will be using some used casing when applicable.
5. Pressure control equipment: See Exhibit C. Although the rig equipment is 3M rated, this well will be a 2M PSI rating.
6. Mud program: See Form 3160-3.
7. Auxiliary equipment: Blowout preventer
8. Testing, logging and coring programs: Two possible DST's. No coring is anticipated. Planned logs are DLL-Micro w/GR & Caliper and CN-Den w/GR & Caliper.
9. No abnormal pressures or temperatures are anticipated.
10. Anticipated starting date: As soon as possible.

(12/28/78)

JAN 22 1990

OCB  
HOBBS OFFICE

EXHIBIT C

Harvey E. Yates Co.  
North Young 3 Federal #1  
2310' FNL & 990' FEL  
Sec. 3 T-18S R-32E  
Lea Co., New Mexico

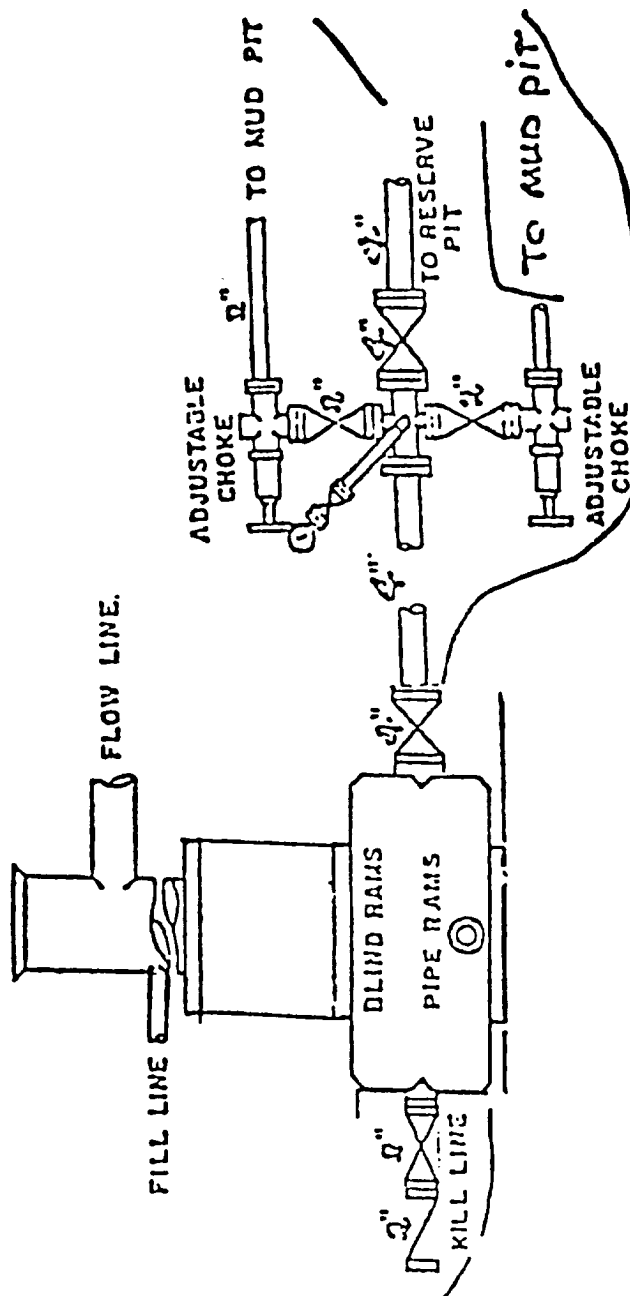

900 Series

06/5/8 22M  
173

RECEIVED  
JAN 22 1971  
HOBBS OFFICE