

Submit to Appropriate
District Office
State Lease - 6 copies
Fee Lease - 5 copies

State of New Mexico
Energy, Minerals and Natural Resources Department

Form C-101
Revised 1-1-89

OIL CONSERVATION DIVISION

DISTRICT I
P.O. Box 1980, Hobbs, NM 88240

DISTRICT II
P.O. Drawer DD, Artesia, NM 88210

DISTRICT III
1000 Rio Brazos Rd., Aztec, NM 87410

P.O. Box 2088

Santa Fe, New Mexico 87504-2088

API NO. (assigned by OCD on New Wells)

30-025-30370

5. Indicate Type of Lease

STATE ☒

FEE ☐

6. State Oil & Gas Lease No.

APPLICATION FOR PERMIT TO DRILL, DEEPEN, OR PLUG BACK

1a. Type of Work:

DRILL ☒

RE-ENTER ☐

DEEPEN ☐

PLUG BACK ☐

b. Type of Well:

OIL
WELL ☒

GAS
WELL ☐

OTHER ☐

SINGLE
ZONE ☐

MULTIPLE
ZONE ☐

7. Lease Name or Unit Agreement Name

Sharp Shooter 2 State

8. Well No.

4

9. Pool name or Wildcat

North Young Bone Spring

4. Well Location

Unit Letter G : 1650 Feet From The North Line and 1650 Feet From The East Line

Section 2 Township 18S Range 32E NMPM Lea County

10. Proposed Depth

8700'

11. Formation

Bone Spring

12. Rotary or C.T.

Rotary

13. Elevations (Show whether DF, RT, GR, etc.)

3898.7' GR

14. Kind & Status Plug. Bond

Blanket

15. Drilling Contractor

To be bid

16. Approx. Date Work will start

March 15, 1990

17.

PROPOSED CASING AND CEMENT PROGRAM

| SIZE OF HOLE | SIZE OF CASING | WEIGHT PER FOOT | SETTING DEPTH | SACKS OF CEMENT | EST. TOP |
|--------------|----------------|-----------------|---------------|-----------------|----------|
| 17-1/2" | 13-3/8" | 48.0 | 425' | 450 sx | Surface |
| 12-1/4" | 8-5/8" | 24.0 | 2800' | 2500 sx | Surface |
| 7-7/8" | 5-1/2" | 17.0 | 8700' | 800 sx | 2500' |

Move in rig and drill 17-1/2" hole to 425'±. Run 13-3/8" casing and cement to surface with Class C cement w/2% CaCl₂. Drill 12-1/4" hole to 2800'. Run 8-5/8" casing and cement to surface with 65/35 Class C cement/Poz, 6% gel, 10% salt and 1 lb/sk celloflake, followed by 360 sx Class C cement. Drill 7-7/8" hole to 8700'. Run 5-1/2" casing and cement to 3000' with 65/35 Class C cement/Poz (3000-8000') followed by 50/50 Class H cement/Poz, 2% gel, 0.8% fluid loss additive (8000-8700').

13 3/8 x 2000 annular preventer on 13 3/8" - test to 600 psi
11 x 3000 annular preventer blind ram, pipe ram, choke manifold - test csg to 1500 psi & test BOP stack to 3000 psi

IN ABOVE SPACE DESCRIBE PROPOSED PROGRAM: IF PROPOSAL IS TO DEEPEN OR PLUG BACK, GIVE DATA ON PRESENT PRODUCTIVE ZONE AND PROPOSED NEW PRODUCTIVE ZONE. GIVE BLOWOUT PREVENTER PROGRAM, IF ANY.

I hereby certify that the information above is true and complete to the best of my knowledge and belief.

SIGNATURE Michael R. Burton

TITLE District Drilling Engineer DATE 2-28-90

TYPE OR PRINT NAME Michael R. Burton

915/

TELEPHONE NO. 687-3551

(This space for State Use)

Orig. Signed by
Paul Kautz
Geologist

APPROVED BY

TITLE

DATE

CONDITIONS OF APPROVAL, IF ANY:

MAR 08 1990

THIS WELL HAS BEEN PLACED IN THE POOL
DESIGNATED BELOW. IF YOU DO NOT CONCUR
NOTIFY THIS OFFICE.

Submit to Appropriate
District Office
State Lease - 4 copies
Fee Lease - 3 copies

State of New Mexico
Energy, Minerals and Natural Resources Department

Form C-102
Revised 1-1-89

OIL CONSERVATION DIVISION

P.O. Box 2088
Santa Fe, New Mexico 87504-2088

DISTRICT I

P.O. Box 1980, Hobbs, NM 88240

DISTRICT II

P.O. Drawer DD, Artesia, NM 88210

DISTRICT III

1000 Rio Brazos Rd., Aztec, NM 87410

WELL LOCATION AND ACREAGE DEDICATION PLAT

All Distances must be from the outer boundaries of the section

| | | | | | |
|--|------------------------------------|----------------------|--|--------------------------------|---------------|
| Operator Santa Fe Energy Operating Partners L.P. | | | Lease Sharp Shooter, State "1-1-89" | | Well No. 4 |
| Unit Letter G | Section 2 | Township 18 South | Range 32 East | County Lea | |
| Actual Footage Location of Well: 1650 feet from the North line and 1650 feet from the East line | | | | | |
| Ground level Elev. 3898.7 | Producing Formation Bone Spring | | Pool North Young Bone Spring | Dedicated Acreage: 40 Acres | |

- Outline the acreage dedicated to the subject well by colored pencil or hatchure marks on the plat below.
- If more than one lease is dedicated to the well, outline each and identify the ownership thereof (both as to working interest and royalty).
- If more than one lease of different ownership is dedicated to the well, have the interest of all owners been consolidated by communitization, unitization, force-pooling, etc.?
☐ Yes ☒ No If answer is "yes" type of consolidation _____
If answer is "no" list the owners and tract descriptions which have actually been consolidated. (Use reverse side of this form if necessary.)
No allowable will be assigned to the well until all interests have been consolidated (by communitization, unitization, forced-pooling, or otherwise) or until a non-standard unit, eliminating such interest, has been approved by the Division.

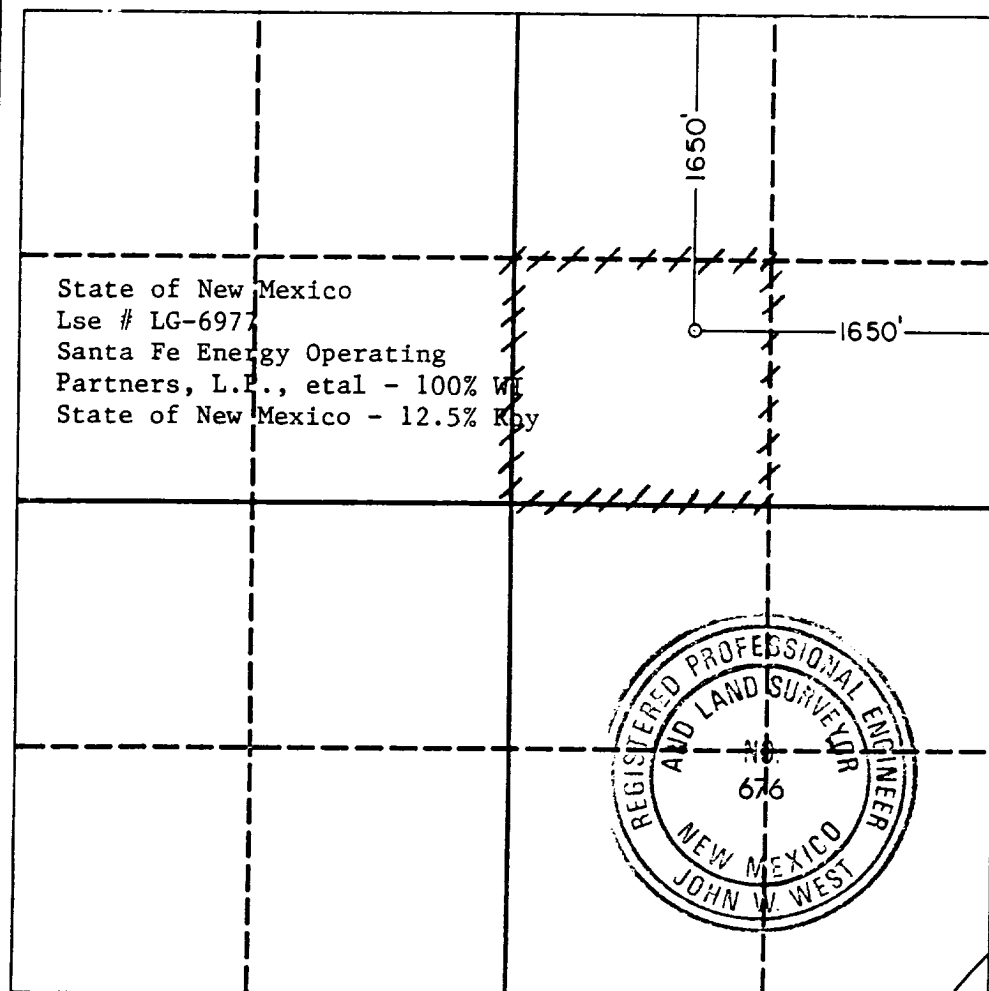

OPERATOR CERTIFICATION

I hereby certify that the information contained herein is true and complete to the best of my knowledge and belief.

| |
|---|
| Signature <i>Michael R. Burton</i> |
| Printed Name Michael R. Burton |
| Position District Drilling Engineer |
| Company Santa Fe Energy Operating Partners, L.P. |
| Date February 28, 1990 |

SURVEYOR CERTIFICATION

I hereby certify that the well location shown on this plat was plotted from field notes of actual surveys made by me or under my supervision, and that the same is true and correct to the best of my knowledge and belief.

| |
|--|
| Date Surveyed February 22, 1990 |
| Signature & Seal of Professional Surveyor <i>John W. West</i> |
| Certificate No. JOHN W. WEST, 675 RONALD J. EIDSON, 3239 |