

UNITED STATES  
DEPARTMENT OF THE INTERIOR  
BUREAU OF LAND MANAGEMENT

30-025-30951  
Form approved.  
Budget Bureau No. 1004-0136  
Expires August 31, 1985

APPLICATION FOR PERMIT TO DRILL, DEEPEN, OR PLUG BACK

1a. TYPE OF WORK  
DRILL ☒ DEEPEN ☐ PLUG BACK ☐

b. TYPE OF WELL  
OIL WELL ☒ GAS WELL ☐ OTHER ☐ SINGLE ZONE ☐ MULTIPLE ZONE ☐

2. NAME OF OPERATOR  
Harvey E. Yates Company

3. ADDRESS OF OPERATOR  
P.O. Box 1933, Roswell, New Mexico 88202

4. LOCATION OF WELL (Report location clearly and in accordance with any State requirements.)\*  
At surface 420' FSL & 990' FEL  
At proposed prod. zone same

14. DISTANCE IN MILES AND DIRECTION FROM NEAREST TOWN OR POST OFFICE\*  
8 miles SE of Maljamar, New Mexico

15. DISTANCE FROM PROPOSED\* LOCATION TO NEAREST PROPERTY OR LEASE LINE, FT. (Also to nearest drlg. unit line, if any)  
420

16. NO. OF ACRES IN LEASE  
400

17. NO. OF ACRES ASSIGNED TO THIS WELL  
40

18. DISTANCE FROM PROPOSED LOCATION\* TO NEAREST WELL, DRILLING, COMPLETED, OR APPLIED FOR, ON THIS LEASE, FT.  
2134

19. PROPOSED DEPTH  
9520

20. ROTARY OR CABLE TOOLS  
rotary

21. ELEVATIONS (Show whether DF, RT, GR, etc.)  
3857.5 GL

22. APPROX. DATE WORK WILL START\*  
ASAP

23. PROPOSED CASING AND CEMENTING PROGRAM

| SIZE OF HOLE | SIZE OF CASING | WEIGHT PER FOOT | SETTING DEPTH | QUANTITY OF CEMENT |
|--------------|----------------|-----------------|---------------|--------------------|
| 17 1/2       | 13 3/8         | 54.5            | 350           | Circ to surface    |
| 12 1/4       | 8 5/8          | 32              | 2950          | Circ to surface    |
| 7 7/8        | 5 1/2          | 17              | 9520          | 600' above pay     |

MUD PROGRAM:

0 - 350 FW w/paper  
350 - 2950 Brine water  
2950 - 9400 FW mud

APPROVAL SUBJECT TO  
GENERAL REQUIREMENTS AND  
SPECIAL STIPULATIONS  
ATTACHED

IN ABOVE SPACE DESCRIBE PROPOSED PROGRAM: If proposal is to deepen or plug back, give data on present productive zone and proposed new productive zone. If proposal is to drill or deepen directionally, give pertinent data on subsurface locations and measured and true vertical depths. Give blowout preventer program, if any.

24. SIGNED NM Young NM Young TITLE Drilling Superintendent DATE 7/10/90  
(This space for Federal or State office use)

PERMIT NO. \_\_\_\_\_ APPROVAL DATE \_\_\_\_\_  
APPROVED BY Jim Hove TITLE Director DATE 7-14-90  
CONDITIONS OF APPROVAL, IF ANY:

\*See Instructions On Reverse Side

Submit to Appropriate  
District Office  
State Lease - 4 copies  
Fee Lease - 3 copies

State of New Mexico  
Energy, Minerals and Natural Resources Department

Form C-102  
Revised 1-1-89

OIL CONSERVATION DIVISION

P.O. Box 2088  
Santa Fe, New Mexico 87504-2088

JUL 05 1990

DISTRICT I  
P.O. Box 1980, Hobbs, NM 88240

DISTRICT II  
P.O. Drawer DD, Artesia, NM 88210

DISTRICT III  
1000 Rio Brazos Rd., Aztec, NM 87410

WELL LOCATION AND ACREAGE DEDICATION PLAT

All Distances must be from the outer boundaries of the section

|  |                                     |                      |                           |               |                                |
|--|-------------------------------------|----------------------|---------------------------|---------------|--------------------------------|
| Operator<br>HARVEY E. YATES COMPANY  |                                     |                      | Lease<br>Shoot 12 Federal |               | Well No.<br>2                  |
| Unit Letter<br>P   | Section<br>12                       | Township<br>18 South | Range<br>32 East          | County<br>Lea | NMPM                           |
| Actual Footage Location of Well:<br>420 feet from the South line and 990 feet from the East line |                                     |                      |                           |               |                                |
| Ground level Elev.<br>3857.5   | Producing Formation<br>Bone Springs |                      | Pool<br>North Young       |               | Dedicated Acreage:<br>40 Acres |

1. Outline the acreage dedicated to the subject well by colored pencil or hatchure marks on the plat below.
2. If more than one lease is dedicated to the well, outline each and identify the ownership thereof (both as to working interest and royalty).
3. If more than one lease of different ownership is dedicated to the well, have the interest of all owners been consolidated by communitization, unitization, force-pooling, etc.?  
☐ Yes ☐ No If answer is "yes" type of consolidation \_\_\_\_\_  
If answer is "no" list the owners and tract descriptions which have actually been consolidated. (Use reverse side of this form if necessary.)  
No allowable will be assigned to the well until all interests have been consolidated (by communitization, unitization, forced-pooling, or otherwise) or until a non-standard unit, eliminating such interest, has been approved by the Division.

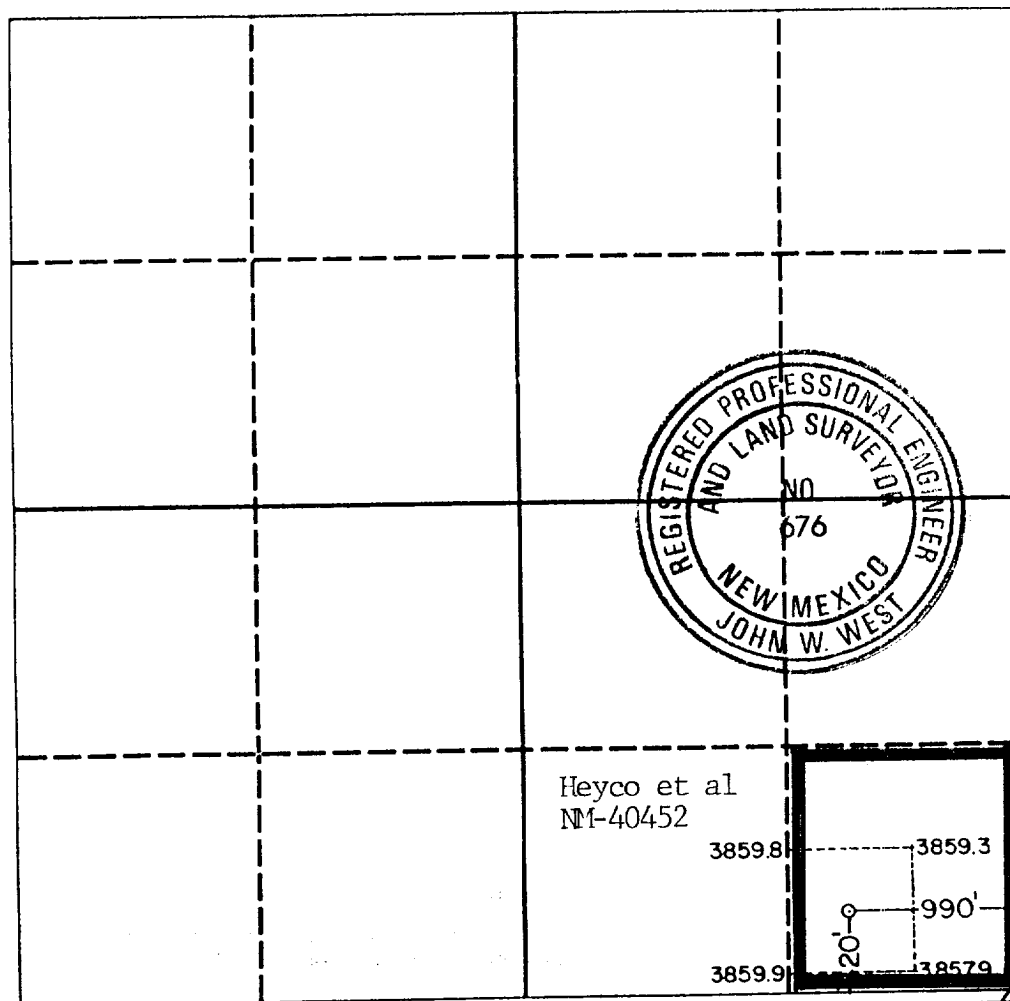

OPERATOR CERTIFICATION

I hereby certify that the information contained herein is true and complete to the best of my knowledge and belief.

Signature

*N.M. Young*

Printed Name

N.M. Young

Position

Drilling Superintendent

Company

Harvey E. Yates Co.

Date

July 9, 1990

SURVEYOR CERTIFICATION

I hereby certify that the well location shown on this plat was plotted from field notes of actual surveys made by me or under my supervision, and that the same is true and correct to the best of my knowledge and belief.

Date Surveyed

July 2, 1990

Signature & Seal of Professional Surveyor

*John W. West*

Certificate No. JOHN W. WEST 676  
RONALD J. EIDSON, 3239

EXHIBIT C

Harvey E. Yates Co.  
Shoot 12 Federal #2  
420' FSL & 990' FEL  
Sec. 12 T-18S R-32E  
Lea Co., New Mexico

900 Series

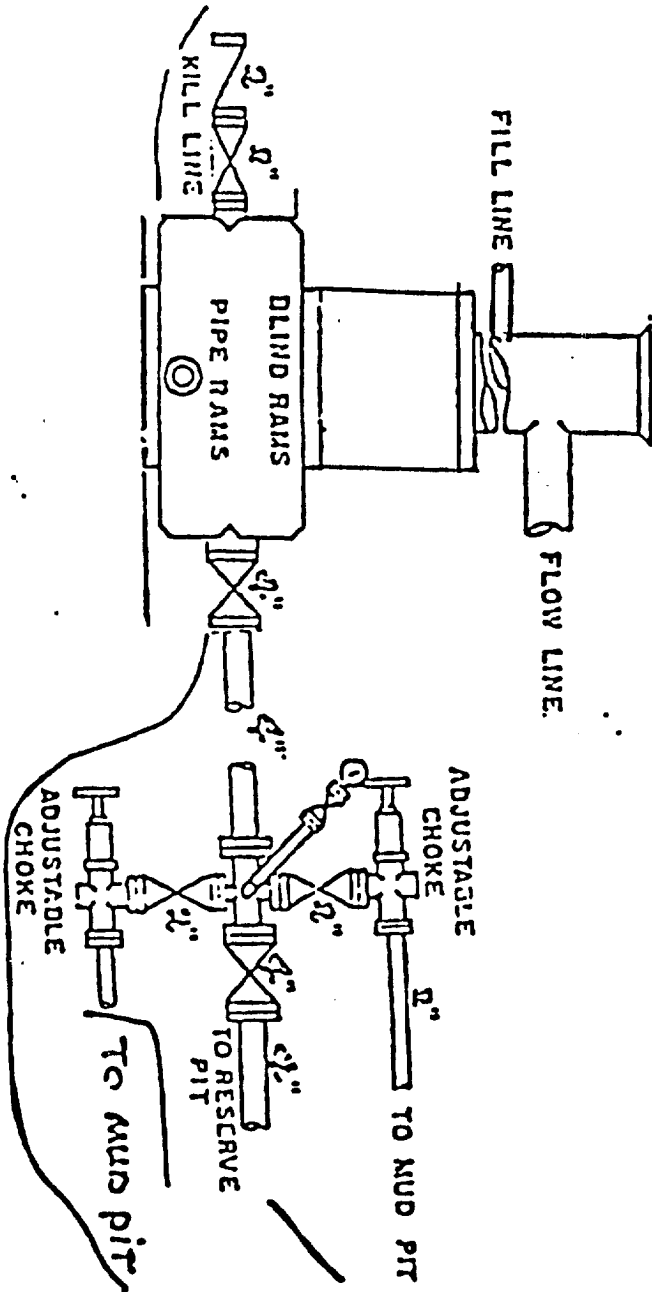

06/06/01 8004

173

JUL 20 1990

11/11/1988