

# OIL CONSERVATION DIVISION

DISTRICT I  
P.O. Box 1980, Hobbs, NM 88240

DISTRICT II  
P.O. Drawer DD, Artesia, NM 88210

DISTRICT III  
1000 Rio Brazos Rd., Aztec, NM 87410

P.O. Box 2088  
Santa Fe, New Mexico 87504-2088

## WELL LOCATION AND ACREAGE DEDICATION PLAT

All Distances must be from the outer boundaries of the section

Operator HARVEY E. YATES CO.			Lease Young Deep Unit		Well No. 26
Unit Letter F	Section 10	Township 18 South	Range 32 East	County Lea	
Actual Footage Location of Well: 1650 feet from the North line and 1650 feet from the East line					
Ground level Elev. 3843.2	Producing Formation Bone Springs	Pool North Young		Dedicated Acreage: 40 Acres	

- Outline the acreage dedicated to the subject well by colored pencil or hatchure marks on the plat below.
- If more than one lease is dedicated to the well, outline each and identify the ownership thereof (both as to working interest and royalty).
- If more than one lease of different ownership is dedicated to the well, have the interest of all owners been consolidated by communitization, unitization, force-pooling, etc.?  
☐ Yes ☐ No If answer is "yes" type of consolidation \_\_\_\_\_  
If answer is "no" list the owners and tract descriptions which have actually been consolidated. (Use reverse side of this form if necessary).  
No allowable will be assigned to the well until all interests have been consolidated (by communitization, unitization, forced-pooling, or otherwise) or until a non-standard unit, eliminating such interest, has been approved by the Division.

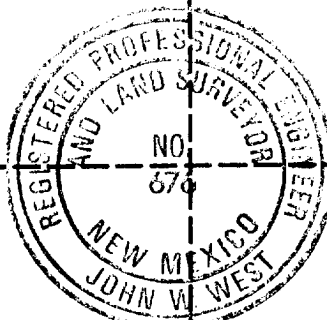
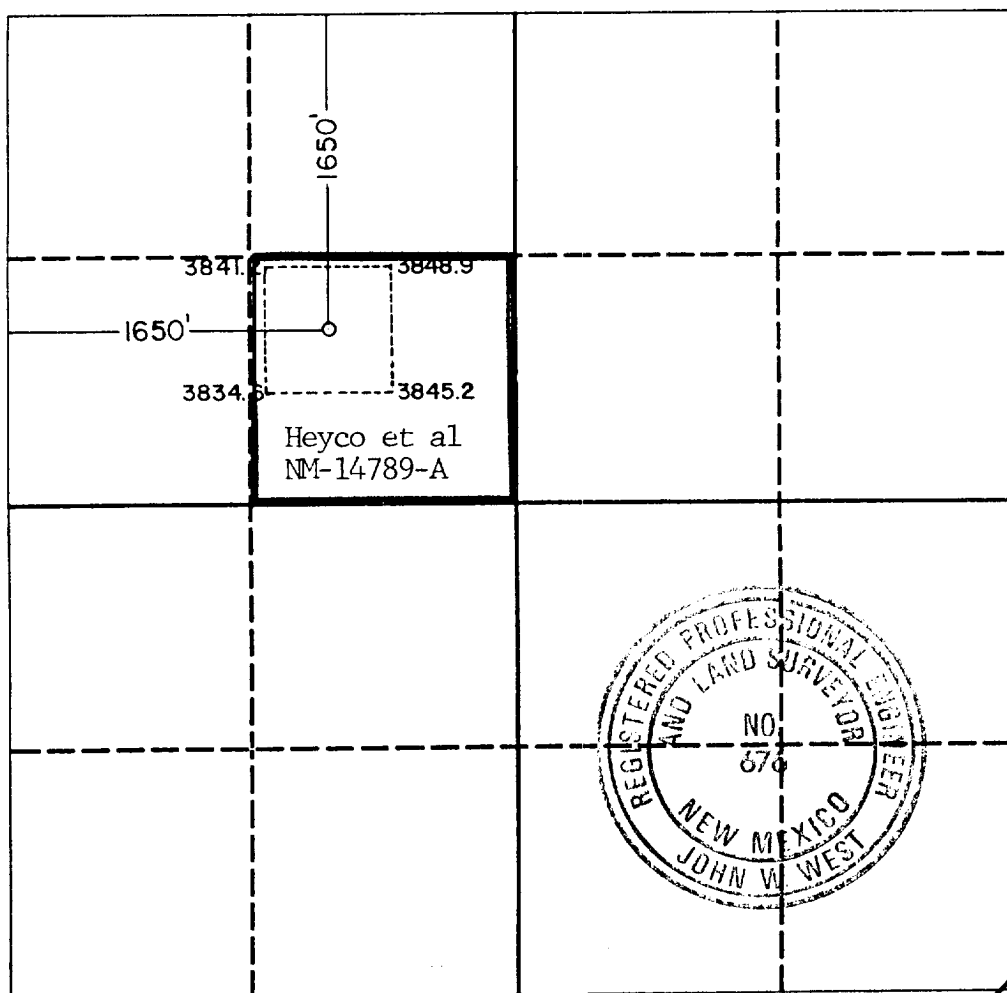

### OPERATOR CERTIFICATION

I hereby certify that the information contained herein is true and complete to the best of my knowledge and belief.

Signature  
Printed Name  
N.M. Young  
Position  
Drilling Superintendent  
Company  
Harvey E. Yates Co.  
Date  
July 9, 1990

### SURVEYOR CERTIFICATION

I hereby certify that the well location shown on this plat was plotted from field notes of actual surveys made by me or under my supervision, and that the same is true and correct to the best of my knowledge and belief.

Date Surveyed  
June 8, 1990  
Signature & Seal of  
Professional Surveyor  
Certificate No. JOHN W. WEST, 676  
RONALD J. EIDSON, 3239

Harvey E. Yates Co  
Young Deep Unit #26  
1650' FN & WL  
Sec. 10 T-18S R-32E  
Lea Co., New Mexico

900 Series

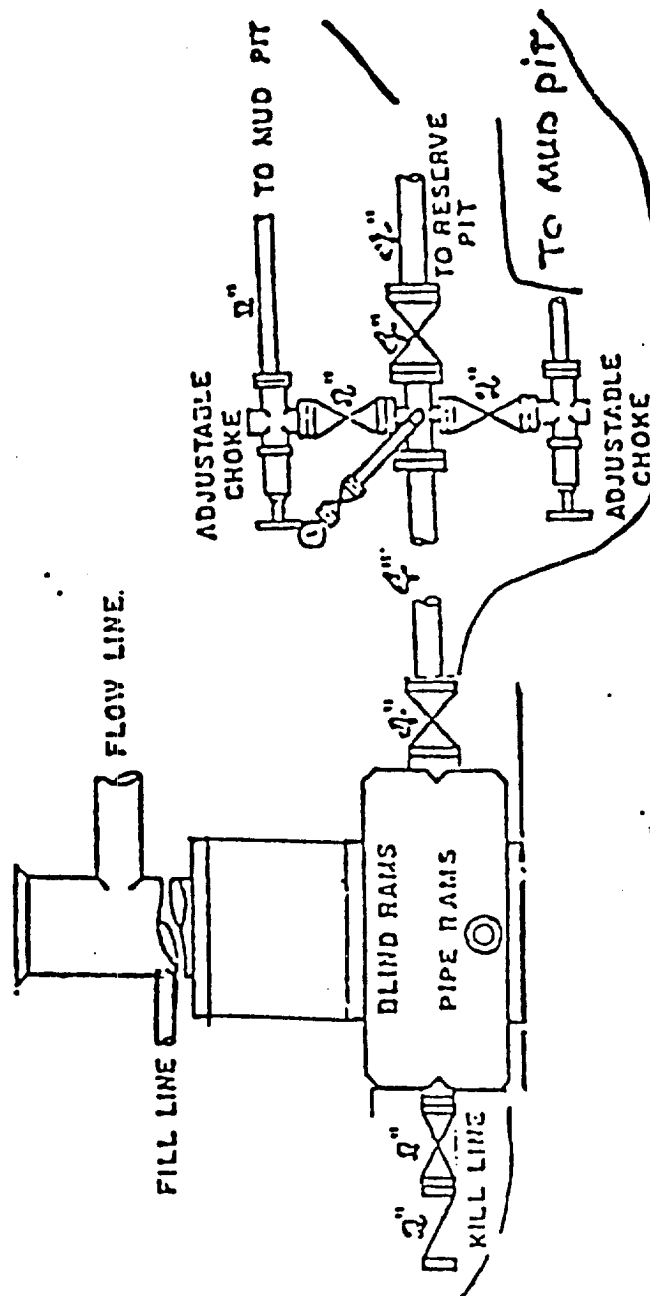

06-91-01 85 ni

173