

Submit to Appropriate  
District Office  
State Lease - 6 copies  
Fee Lease - 5 copies

State of New Mexico  
Energy, Minerals and Natural Resources Department

Form C-101  
Revised 1-1-89

OIL CONSERVATION DIVISION

P.O. Box 2088  
Santa Fe, New Mexico 87504-2088

DISTRICT I  
P.O. Box 1980, Hobbs, NM 88240

DISTRICT II  
P.O. Drawer DD, Artesia, NM 88210

DISTRICT III  
1000 Rio Brazos Rd., Aztec, NM 87410

API NO. (assigned by OCD on New Wells)

30-025-30967

5. Indicate Type of Lease

STATE ☒

FEE ☐

6. State Oil & Gas Lease No.

B-1722-1

APPLICATION FOR PERMIT TO DRILL, DEEPEN, OR PLUG BACK

1a. Type of Work:

DRILL ☒

RE-ENTER ☐

DEEPEN ☐

PLUG BACK ☐

b. Type of Well:

OIL  
WELL ☒

GAS  
WELL ☐

OTHER ☐

SINGLE  
ZONE ☒

MULTIPLE  
ZONE ☐

7. Lease Name or Unit Agreement Name

NEW MEXICO -N- STATE

2. Name of Operator

TEXACO PRODUCING INC.

8. Well No.

10

3. Address of Operator

P. O. Box 3109, Midland, Texas 79702

9. Pool name or Wildcat

VACUUM GLORIETA

4. Well Location

Unit Letter M : 990 Feet From The SOUTH Line and 895 Feet From The WEST Line

Section 30

Township 17-SOUTH

Range 35-EAST

NMPM

LEA

County

10. Proposed Depth

6270'

11. Formation

GLOFIIETA

12. Rotary or C.T.

ROTARY

13. Elevations (Show whether DF, RT, GR, etc.)

GR-3990'

14. Kind & Status Plug. Bond

BLANKET

15. Drilling Contractor

BASIN

16. Approx. Date Work will start

09-15-90

17.

PROPOSED CASING AND CEMENT PROGRAM

SIZE OF HOLE	SIZE OF CASING	WEIGHT PER FOOT	SETTING DEPTH	SACKS OF CEMENT	EST. TOP
15	11 3/4	42#	1550'	1200	SURFACE
11	8 5/8	32#	3000'	850	SURFACE
7 7/8	5 1/2	15.5#	6270'	1150	SURFACE

CEMENTING PROGRAM: CONDUCTOR - 16in, 94# SET @ 40'. CEMENTED WITH REDIMIX.

SURFACE CASING - 1200 SX CLASS H w/ 2% CaCl<sub>2</sub> (15.6ppg, 1.19f3/s, 5.2gw/s).

INTERMEDIATE CASING - 600 SX 35/65 POZ CLASS H w/ 6% GEL & 5% SALT (12.8ppg, 1.87f3/s, 9.9gw/s). F/B 250 SX CLASS H w/ 2% CaCl<sub>2</sub> (15.6ppg, 1.19f3/s, 5.2gw/s).

PRODUCTION CASING - 1st STAGE: 300 SX CLASS H w/ 1/4# FLOCELE (15.6ppg, 1.18f3/s, 5.2gw/s).

DV TOOL @ 5000' - 2nd STAGE: 600 SX 35/65 POZ CLASS H w/ 6% GEL, 5% SALT, 1/4# FLOCELE (12.8ppg, 1.87f3/s, 9.9gw/s). F/B 250 SX CLASS H (15.6ppg, 1.18f3/s, 5.2gw/s).

NO OTHER OPERATORS IN THIS QUARTER QUARTER SECTION.

IN ABOVE SPACE DESCRIBE PROPOSED PROGRAM: IF PROPOSAL IS TO DEEPEN OR PLUG BACK, GIVE DATA ON PRESENT PRODUCTIVE ZONE AND PROPOSED NEW PRODUCTIVE ZONE. GIVE BLOWOUT PREVENTER PROGRAM, IF ANY.

I hereby certify that the information above is true and complete to the best of my knowledge and belief.

SIGNATURE C. Wade Howard TITLE ENGINEERING ASSISTANT DATE 08-07-90

TYPE OR PRINT NAME C. W. HOWARD

TELEPHONE NO. 915 688-4606

(This space for State Use)

APPROVED BY \_\_\_\_\_ TITLE \_\_\_\_\_ DATE \_\_\_\_\_

CONDITIONS OF APPROVAL, IF ANY:

Permit Expires 6 Months From Approval  
Date Unless Drilling Underway.

# OIL CONSERVATION DIVISION

P.O. Box 2088

Santa Fe, New Mexico 87504-2088

## DISTRICT I

P.O. Box 1980, Hobbs, NM 88240

## DISTRICT II

P.O. Drawer DD, Artesia, NM 88210

## DISTRICT III

1000 Rio Brazos Rd., Aztec, NM 87410

## WELL LOCATION AND ACREAGE DEDICATION PLAT

All Distances must be from the outer boundaries of the section

Operator <b>TEXACO PRODUCING INC.</b>			Lease <b>NEW MEXICO "N" STATE</b>		Well No. <b>10</b>
Unit Letter <b>M</b>	Section <b>30</b>	Township <b>17-South</b>	Range <b>35-East</b>	County <b>Lea</b>	
Actual Footage Location of Well: <b>990</b> feet from the <b>South</b> line and <b>895</b> feet from the <b>West</b> line					
Ground level Elev. <b>3990</b>	Producing Formation <b>Glorieta; Paddock</b>		Pool <b>Vacuum Glorieta</b>		Dedicated Acreage: <b>37.59</b> Acres

- Outline the acreage dedicated to the subject well by colored pencil or hatchure marks on the plat below.
- If more than one lease is dedicated to the well, outline each and identify the ownership thereof (both as to working interest and royalty).
- If more than one lease of different ownership is dedicated to the well, have the interest of all owners been consolidated by communization, unitization, force-pooling, etc.?  
☐ Yes ☐ No If answer is "yes" type of consolidation \_\_\_\_\_  
If answer is "no" list the owners and tract descriptions which have actually been consolidated. (Use reverse side of this form if necessary).  
No allowable will be assigned to the well until all interests have been consolidated (by communization, unitization, forced-pooling, or otherwise) or until a non-standard unit, eliminating such interest, has been approved by the Division.

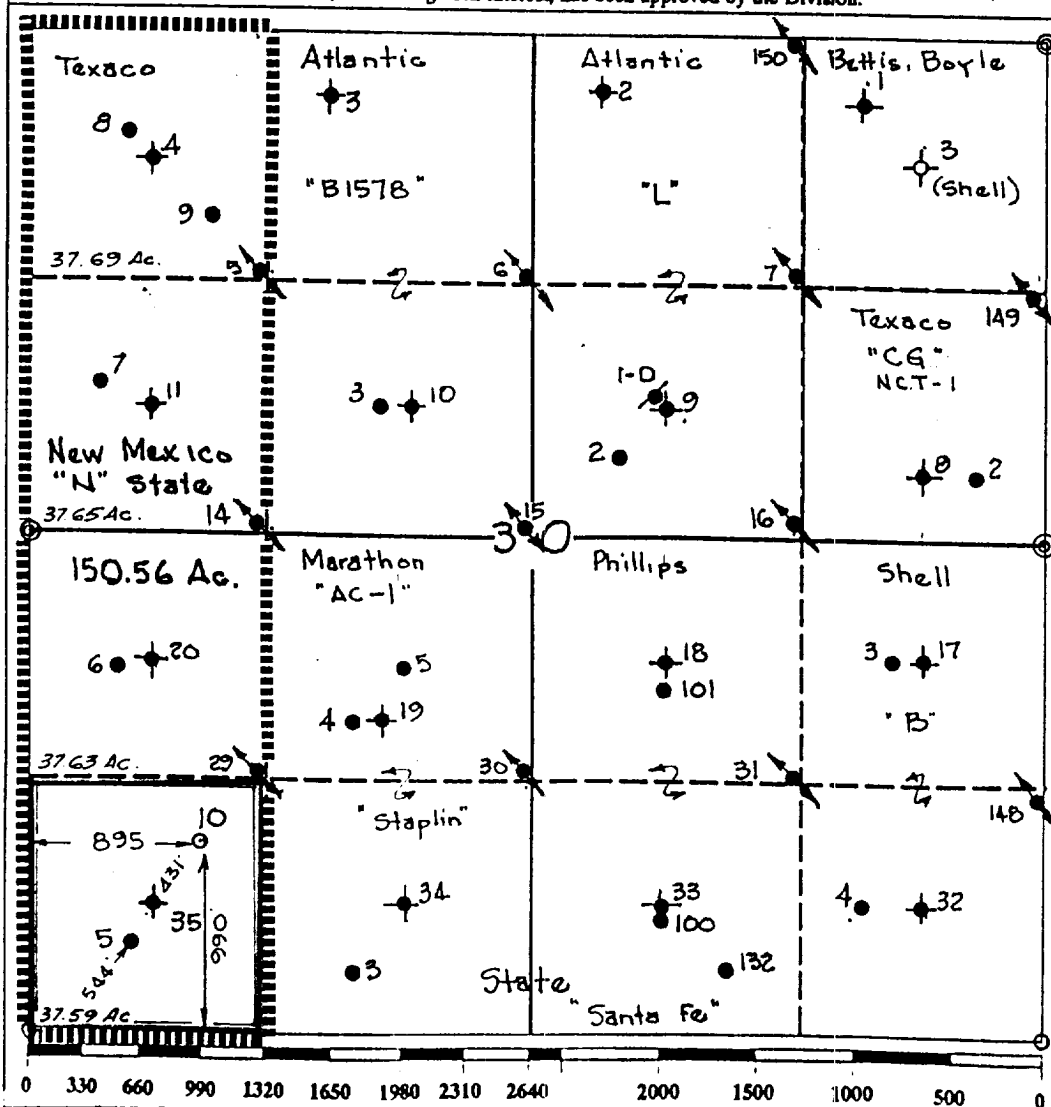

### OPERATOR CERTIFICATION

I hereby certify that the information contained herein is true and complete to the best of my knowledge and belief.

Signature  
*Royce D. Mariott*  
Printed Name  
**Royce D. Mariott**  
Position  
**Division Surveyor**  
Company  
**Texaco Producing Inc.**  
Date  
**August 7, 1990**

### SURVEYOR CERTIFICATION

I hereby certify that the well location shown on this plat was plotted from field notes of actual surveys made by me or under my supervision, and that the same is true and correct to the best of my knowledge and belief.

Date Surveyed  
**August 1, 1990**  
Signature & Seal of Professional Surveyor  
*John S. Piper*  
Certificate No.  
**7254 John S. Piper**

• = Central Vacuum Unit Rod, • = C. Vacuum Injector, © = G.L.O. B.C. & Iron Pipe, O = Monument by others, O = Staked Location

**DRILLING CONTROL  
CONDITION II-B 3000 WP  
FOR AIR DRILLING OR  
WHERE NITROGEN OR AIR BLOWS ARE EXPECTED**

H<sub>2</sub>S TRIM REQUIRED  
YES \_\_\_\_\_ NO \_\_\_\_\_

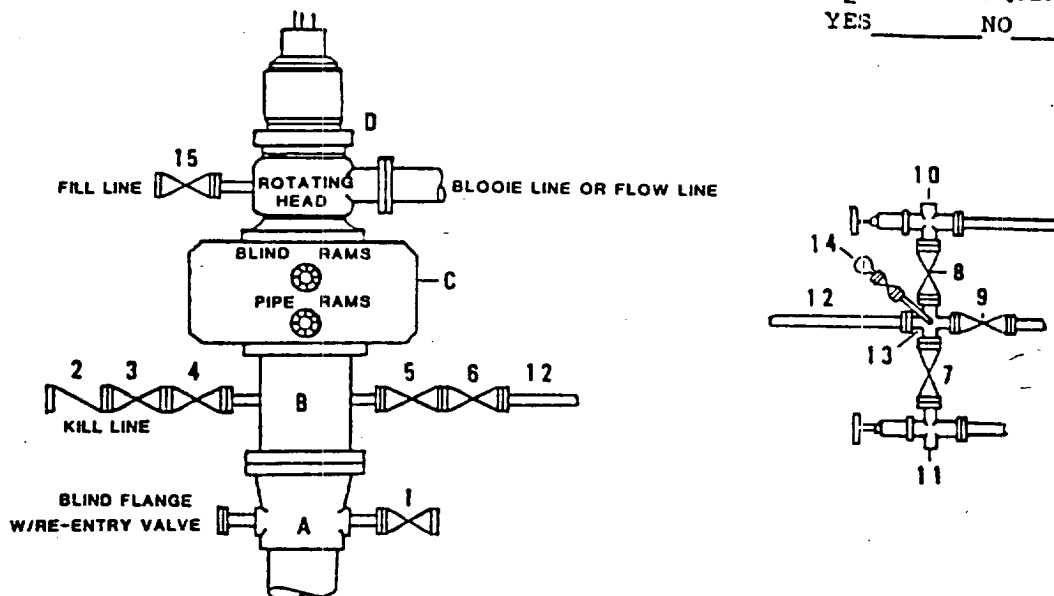

DRILLING CONTROL

MATERIAL LIST - CONDITION II - B

- |                |  |
|----------------|--|
| A              | Texaco Wellhead  |
| B              | 3000# W.P. drilling spool with a 2" minimum flanged outlet for kill line and 3" minimum flanged outlet for choke line.   |
| C              | 3000# W.P. Dual ram type preventer, hydraulic operated with 1" steel, 3000# W.P. control lines (where substructure height is adequate, 2 - 3000# W.P. single ram type preventers may be utilized). |
| D              | Rotating Head with fill up outlet and extended Blooie Line.  |
| 1,3,4,<br>7,8, | 2" minimum 3000# W.P. flanged full opening steel gate valve, or Halliburton Lo Torc Plug valve.  |
| 2              | 2" minimum 3000# W.P. back pressure valve.   |
| 5,6,9          | 3" minimum 3000# W.P. flanged full opening steel gate valve, or Halliburton Lo Torc Plug valve.  |
| 12             | 3" minimum schedule 80, Grade "B", seamless line pipe.   |
| 13             | 2" minimum x 3" minimum 3000# W.P. flanged cross.  |
| 10,11          | 2" minimum 3000# W.P. adjustable choke bodies.   |
| 14             | Cameron Mud Gauge or equivalent ( location optional in choke line).  |
| 15             | 2" minimum 3000# W.P. flanged or threaded full opening steel gate valve, or Halliburton Lo Torc Plug valve.  |



TEXACO, INC.  
MIDLAND DIVISION  
MIDLAND, TEXAS



SCALE	DATE	EST. NO.	DRG. NO.
DRAWN BY:			
CHECKED BY:			
APPROVED BY:			

EXHIBIT C