

UNITED STATES DEPARTMENT OF THE INTERIOR
BUREAU OF LAND MANAGEMENT

APPLICATION FOR PERMIT TO DRILL, DEEPEN, OR PLUG BACK

1a. TYPE OF WORK
DRILL ☒ DEEPEN ☐ PLUG BACK ☐

b. TYPE OF WELL
OIL WELL ☒ GAS WELL ☐ OTHER ☐
SINGLE ZONE ☐ MULTIPLE ZONE ☐

2. NAME OF OPERATOR
Santa Fe Energy Operating Partners, L.P.

3. ADDRESS OF OPERATOR
500 W. Illinois, Suite 500, Midland, TX 79701

4. LOCATION OF WELL (Report location clearly and in accordance with any State requirements.)
At surface

1650' FNL & 330' FEL, Sec. 13, T-18S, R-32E
At proposed prod. zone *unit H*
Same

14. DISTANCE IN MILES AND DIRECTION FROM NEAREST TOWN OR POST OFFICE*
26 miles east of Carlsbad, NM

15. DISTANCE FROM PROPOSED*
LOCATION TO NEAREST
PROPERTY OR LEASE LINE, FT.
(Also to nearest drlg. unit line, if any) 330'

16. NO. OF ACRES IN LEASE
40

17. NO. OF ACRES ASSIGNED
TO THIS WELL 40

18. DISTANCE FROM PROPOSED LOCATION*
TO NEAREST WELL, DRILLING, COMPLETED,
OR APPLIED FOR, ON THIS LEASE, FT. N/A

19. PROPOSED DEPTH
5300'

20. ROTARY OR CABLE TOOLS
Rotary

21. ELEVATIONS (Show whether DF, RT, GR, etc.)
3846.8' GR

22. APPROX. DATE WORK WILL START*
ASAP

23. PROPOSED CASING AND CEMENTING PROGRAM

SIZE OF HOLE	SIZE OF CASING	WEIGHT PER FOOT	SETTING DEPTH	QUANTITY OF CEMENT
12 1/4"	8 5/8"	24.0	425'	Circulate
7 7/8"	5 1/2"	15.5	5300'	Circulate

Move on location and rig up. Drill a 12 1/4" hole to 425'. Run and cement 8 5/8" casing with sufficient Class C containing 2% CaCl₂ to circulate cement to surface. Wait on cement 8 hours. Test casing to 600 psi. Drill a 7 7/8" hole to 5300'. Run logs. Run and cement 5 1/2" casing with sufficient lite weight cement to circulate to surface when followed by 262 cu.ft. Class C containing 2% calcium chloride.

APPROVAL SUBJECT TO
GENERAL REQUIREMENTS AND
SPECIAL STIPULATIONS
ATTACHED

IN ABOVE SPACE DESCRIBE PROPOSED PROGRAM: If proposal is to deepen or plug back, give data on present productive zone and proposed new productive zone. If proposal is to drill or deepen directionally, give pertinent data on subsurface locations and measured and true vertical depths. Give blowout preventer program, if any.

24.

SIGNED Danell Roberts TITLE Senior Drilling Engineer DATE 7-18-90

(This space for Federal or State office use)

PERMIT NO. _____ APPROVAL DATE _____

APPROVED BY [Signature] TITLE [Signature] DATE 9-5-90
CONDITIONS OF APPROVAL, IF ANY:

*See Instructions On Reverse Side

Submit to Appropriate
District Office
State Lease - 4 copies
Fee Lease - 3 copies

State of New Mexico
Energy, Minerals and Natural Resources Department

Form C-102
Revised 1-1-89

OIL CONSERVATION DIVISION

P.O. Box 2088
Santa Fe, New Mexico 87504-2088

DISTRICT I
P.O. Box 1980, Hobbs, NM 88240

DISTRICT II
P.O. Drawer DD, Artesia, NM 88210

DISTRICT III
1000 Rio Brazos Rd., Aztec, NM 87410

WELL LOCATION AND ACREAGE DEDICATION PLAT

All Distances must be from the outer boundaries of the section

Operator SANTA FE ENERGY OPERATING PARTNERS LP			Lease Uncle Sam 13 Federal		Well No. 3
Unit Letter H	Section 13	Township 18 South	Range 32 East	County Lea	NMPM
Actual Footage Location of Well: 1650 feet from the North line and 330 feet from the East line					
Ground level Elev. 3846.8	Producing Formation Delaware	Pool Und. West Corbin Delaware	Dedicated Acreage: 40 Acres		

1. Outline the acreage dedicated to the subject well by colored pencil or hatchure marks on the plat below.
2. If more than one lease is dedicated to the well, outline each and identify the ownership thereof (both as to working interest and royalty).
3. If more than one lease of different ownership is dedicated to the well, have the interest of all owners been consolidated by communitization, unitization, force-pooling, etc.?
☐ Yes ☒ No If answer is "yes" type of consolidation _____
If answer is "no" list the owners and tract descriptions which have actually been consolidated. (Use reverse side of this form if necessary.)
No allowable will be assigned to the well until all interests have been consolidated (by communitization, unitization, forced-pooling, or otherwise) or until a non-standard unit, eliminating such interest, has been approved by the Division.

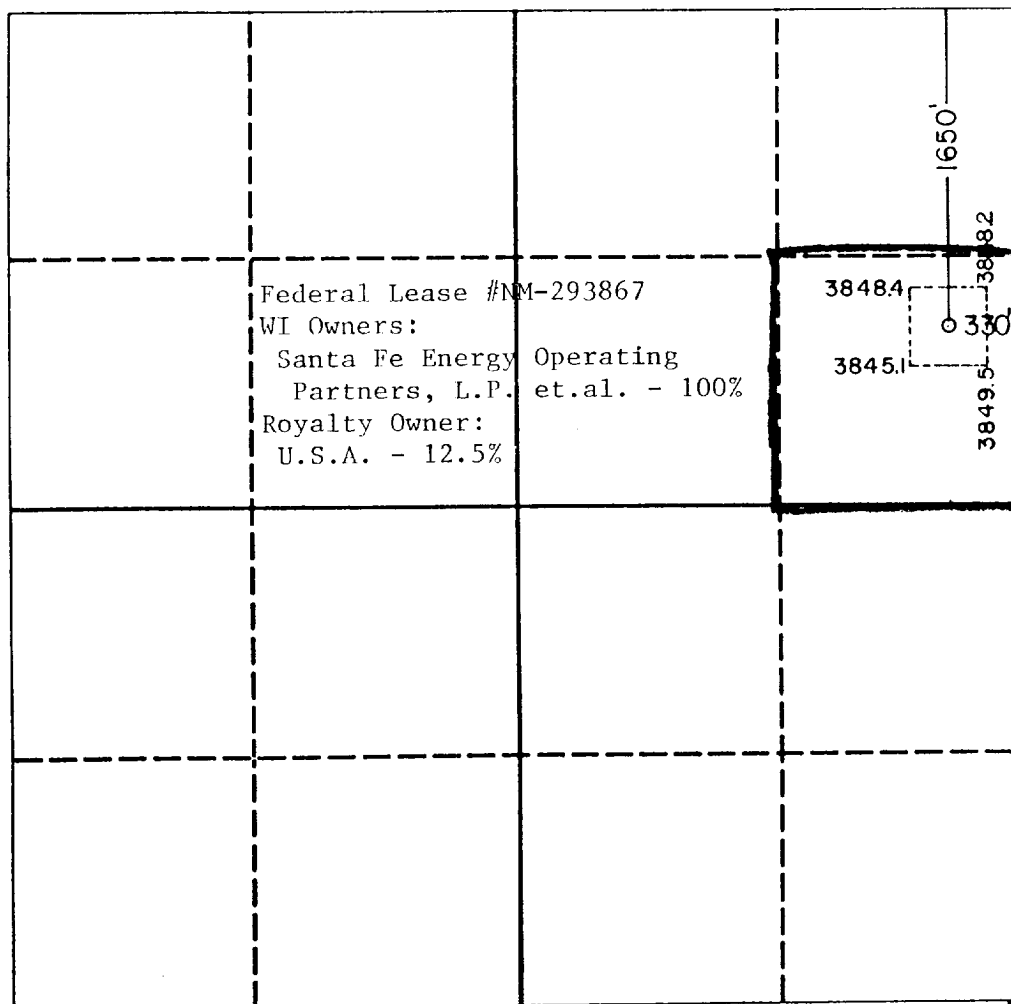

OPERATOR CERTIFICATION

I hereby certify that the information contained herein is true and complete to the best of my knowledge and belief.

Signature <i>Darrell Roberts</i>
Printed Name Darrell Roberts
Position Senior Drilling Engineer
Company Santa Fe Energy Operating Partners, L.P.
Date July 18, 1990

SURVEYOR CERTIFICATION

I hereby certify that the well location shown on this plat was plotted from field notes of actual surveys made by me or under my supervision, and that the same is true and correct to the best of my knowledge and belief.

Date Surveyed July 11, 1990
Signature & Seal of Professional Surveyor <i>John W. West</i>
Certificate No. JOHN W. WEST, 676 RONALD J. EIDSON, 3239

PROPOSED BOPE AND CHOKE ARRANGEMENT

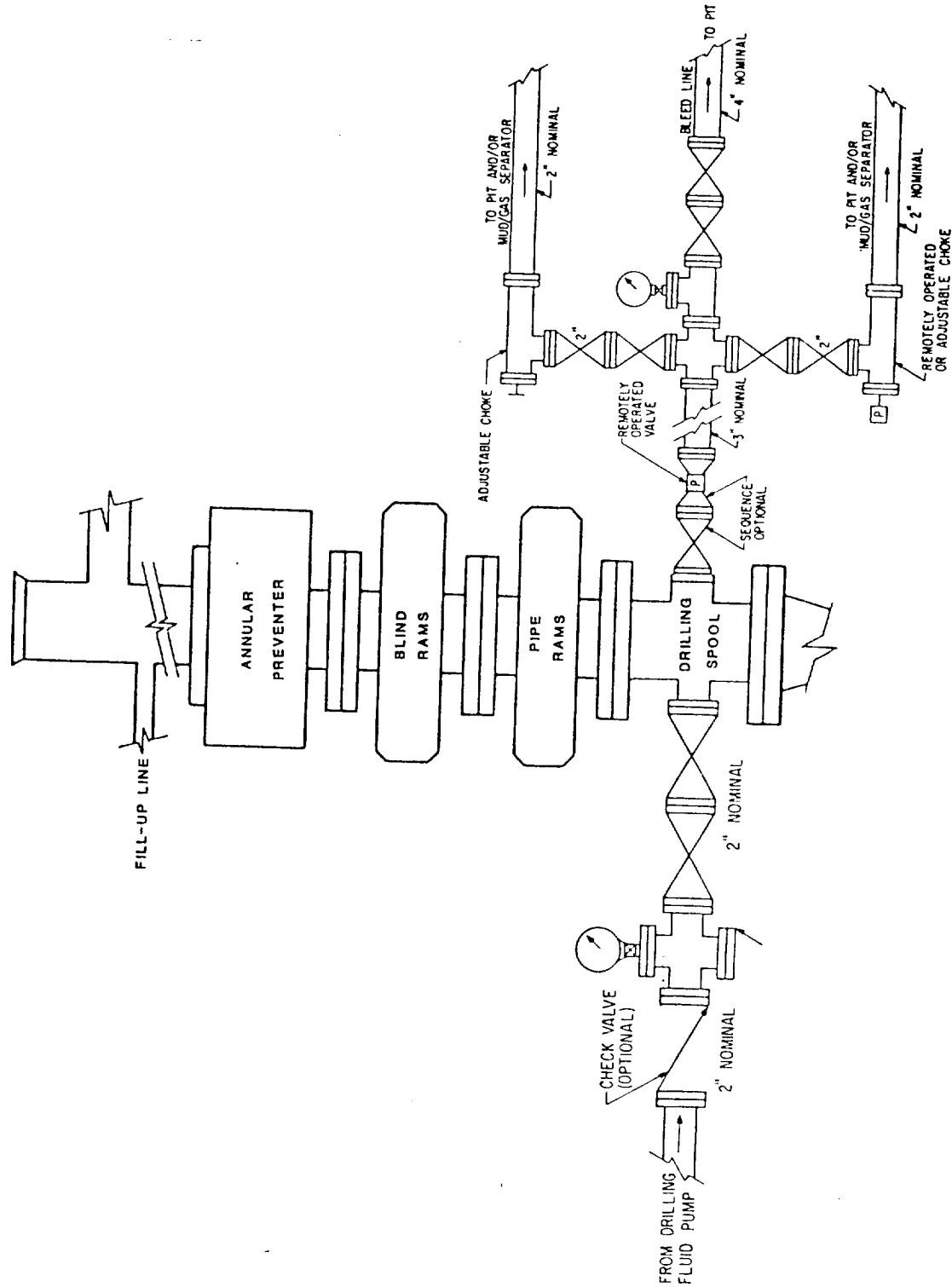

EXHIBIT B

SANTA FE ENERGY OPERATING PARTNERS, LP.
 Uncle Sam "13" Fed. #3
 Sec. 13, T18S, R32E
 1650' FNL & 330' FEL
 LEA COUNTY, NEW MEXICO