

UNITED STATES  
DEPARTMENT OF THE INTERIOR  
BUREAU OF LAND MANAGEMENT

30-025-31008  
SUBMIT IN 1 LIGATE\*

Form approved.  
Budget Bureau No. 1004-0136  
Expires August 31, 1985

APPLICATION FOR PERMIT TO DRILL, DEEPEN, OR PLUG BACK

1a. TYPE OF WORK

DRILL ☐

DEEPEN ☐

PLUG BACK ☐

b. TYPE OF WELL

OIL  
WELL ☐

GAS  
WELL ☐

OTHER

Re-entry  
Redrill

SINGLE  
ZONE ☐

MULTIPLE  
ZONE ☐

2. NAME OF OPERATOR

JFG Enterprises (Prev. Operator: Chevron U.S.A.) (farmout)

3. ADDRESS OF OPERATOR

P. O. Box 100 Artesia, New Mexico 88210

4. LOCATION OF WELL (Report location clearly and in accordance with any State requirements.)\*

At surface

1980' FSL & 1980' FWL

At proposed prod. zone

same

14. DISTANCE IN MILES AND DIRECTION FROM NEAREST TOWN OR POST OFFICE\*

Approximately 32 road miles west of Hobbs, NM

15. DISTANCE FROM PROPOSED\*

LOCATION TO NEAREST  
PROPERTY OR LEASE LINE, FT.  
(Also to nearest drlg. unit line, if any)

660'

16. NO. OF ACRES IN LEASE

400 (120 ac.  
farmout)

17. NO. OF ACRES ASSIGNED  
TO THIS WELL

40

18. DISTANCE FROM PROPOSED LOCATION\*

TO NEAREST WELL, DRILLING, COMPLETED,  
OR APPLIED FOR, ON THIS LEASE, FT.

19. PROPOSED DEPTH

9650'

20. ROTARY OR CABLE TOOLS

Rotary or Workover rig

21. ELEVATIONS (Show whether DF, RT, GR, etc.)

3622.7 GL

22. APPROX. DATE WORK WILL START\*

ASAP after approval

23.

PROPOSED CASING AND CEMENTING PROGRAM

SIZE OF HOLE	SIZE OF CASING	WEIGHT PER FOOT	SETTING DEPTH	QUANTITY OF CEMENT
* 14 3/4"	11 3/4"	42#	500'	345 sx "C" circulated
* 11"	8 5/8"	32#	5,200'	2000 sx "C" circulated
New 7 7/8"	5 1/2"	17#	9,600'	Tie back w/1125 sx "H" + 50/50poz

\* Existing casing and cement in hole.

Propose to re-drill well temporarily plugged and abandoned by Chevron U.S.A., Inc. in December, 1990. Will drill plugs with tops of: surface, 400', 5100', 7,650', 8000', and will then set 5 1/2" casing to 9650' TD and cement back to the 8 5/8" casing and then test potential production horizons in the Delaware and Bone Spring between 7726' - 9500'.

Mud Program: 0' - 5,200' Drill out cement plugs as shown above in existing casing.  
5,200' - 9,650' Below the 8 5/8" existing casing, will drill with fresh water and native mud to clean up hole and drill additional plugs.

BOP Program: A 10" 3000 psi wp, Series 900 BOP will be installed on the 8 5/8" casing before drilling out with the 7 7/8" and will be tested. The BOP will be used as a 2000 psi wp system and will be tested daily.

IN ABOVE SPACE DESCRIBE PROPOSED PROGRAM: If proposal is to deepen or plug back, give data on present productive zone and proposed new productive zone. If proposal is to drill or deepen directionally, give pertinent data on subsurface locations and measured and true vertical depths. Give blowout preventer program, if any.

24.

Agent for:

SIGNED

*George R. Smith*

TITLE

JFG Enterprises

DATE

April 1, 1991

(This space for Federal or State office use)

PERMIT NO.

APPROVAL DATE

APPROVED BY

TITLE

DATE

4/4/91

CONDITIONS OF APPROVAL, IF ANY:

\*See Instructions On Reverse Side

RECEIVED

APR 08 1991

RECEIVED

Submit to Appropriate  
District Office  
State Lease - 4 copies  
Fee Lease - 3 copies

State of New Mexico  
Energy, Minerals and Natural Resources Department

Form C-102  
Revised 1-1-89

OIL CONSERVATION DIVISION

P.O. Box 2088  
Santa Fe, New Mexico 87504-2088

DISTRICT I  
P.O. Box 1980, Hobbs, NM 88240

DISTRICT II  
P.O. Drawer DD, Artesia, NM 88210

DISTRICT III  
1000 Rio Brazos Rd., Aztec, NM 87410

WELL LOCATION AND ACREAGE DEDICATION PLAT

All Distances must be from the outer boundaries of the section

Operator Prev. Oper.: (CHEVRON USA, INC)		New Oper.: JFG Enterprises		Lease LOWELL FEDERAL		Well No. 1	
Unit Letter K	Section 15	Township 19 SOUTH	Range 33 EAST	County NMPM		LEA	
Actual Footage Location of Well: 1980 feet from the south line and 1980 feet from the west line							
Ground level Elev. 3622.7'		Producing Formation Bone Springs		Pool Tonto Bone Springs		Dedicated Acreage: 40 Acres	

1. Outline the acreage dedicated to the subject well by colored pencil or hatchure marks on the plat below.

2. If more than one lease is dedicated to the well, outline each and identify the ownership thereof (both as to working interest and royalty).

3. If more than one lease of different ownership is dedicated to the well, have the interest of all owners been consolidated by communitization, unitization, force-pooling, etc.?

☐ Yes

☐ No

If answer is "yes" type of consolidation

If answer is "no" list the owners and tract descriptions which have actually been consolidated. (Use reverse side of this form if necessary).

No allowable will be assigned to the well until all interests have been consolidated (by communitization, unitization, forced-pooling, or otherwise) or until a non-standard unit, eliminating such interest, has been approved by the Division.

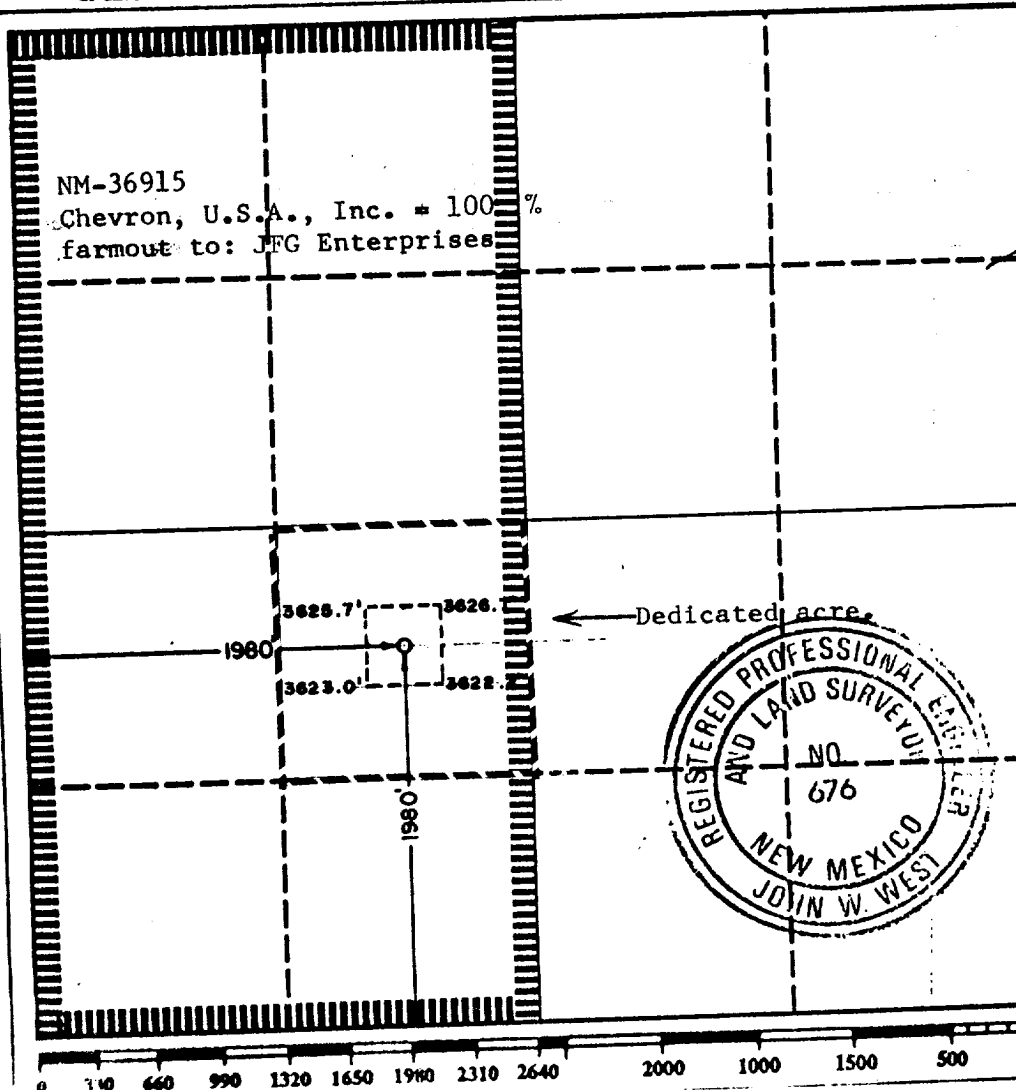

OPERATOR CERTIFICATION

I hereby certify that the information contained herein is true and complete to the best of my knowledge and belief.

Signature  
Printed Name  
R. C. Smith  
Position  
Div. Dir. Mgr.  
Company  
Chevron U.S.A. Inc.  
Date  
7-20-90

SURVEYOR CERTIFICATION

I hereby certify that the well location shown on this plat was plotted from field notes of actual surveys made by me or under my supervision, and that the same is true and correct to the best of my knowledge and belief.

Date Surveyed  
July 12, 1990  
Signature & Seal of  
Professional Surveyor

Certificate No. JOHN W. WEST, 676  
RONALD J. EIDSON, 3239

EXHIBIT "A"  
JFG ENTERPRISES  
(ORIG. CHEVRON, U.S.A., INC.)  
Lowell Federal, Well No. 1  
1980' FSL & 1980' FWL, Sec. 15-T19S-R33E

Plugging		Bit	Casing	Depth	Cement
50'	<p>Surface</p> <p>Open</p> <p>Hole</p>	14 3/4"	<u>Existing</u> 11 3/4"	500'	345 sx "C" circ
400'-600' 50 sx					
5100'-5300' 65 sx		11"	8 5/8"	5,200'	2000 sx "C" circ
7,650'-7850' 75 sx					
8000'-8200' 65 sx		7 7/8"	<u>New Casing</u> 5 1/2"	9,650'	1125 sx "H" tie back to 8 5/8"
10,600'-10,700 40 sx					
13,600'-13,700' 35 sx					