

Submit to Appropriate  
District Office  
State Lease - 6 copies  
Fee Lease - 5 copies

State of New Mexico  
Energy, Minerals and Natural Resources Department

Form C-101  
Revised 1-1-89

DISTRICT I  
P.O. Box 1980, Hobbs, NM 88240

DISTRICT II  
P.O. Drawer DD, Artesia, NM 88210

DISTRICT III  
1000 Rio Brazos Rd., Aztec, NM 87410

OIL CONSERVATION DIVISION  
P.O. Box 2088  
Santa Fe, New Mexico 87504-2088

API NO. (assigned by OCD on New Wells)

30-025-31050

5. Indicate Type of Lease  
STATE ☒ FEE ☐

6. State Oil & Gas Lease No.  
B-1606

APPLICATION FOR PERMIT TO DRILL, DEEPEN, OR PLUG BACK

1a. Type of Work:

DRILL ☒ RE-ENTER ☐ DEEPEN ☐ PLUG BACK ☐

b. Type of Well:

OIL WELL ☒ GAS WELL ☐ OTHER ☐  
SINGLE ZONE ☐ MULTIPLE ZONE ☐

2. Name of Operator

Phillips Petroleum Company

3. Address of Operator

4001 Penbrook Street, Odessa, Texas 79762

4. Well Location

Unit Letter E : 1840 Feet From The North Line and 755 Feet From The West Line

Section 7 Township 17-S Range 35-E NMPM Lea County

10. Proposed Depth  
8900'

11. Formation  
Abo

12. Rotary or C.T.  
Rotary

13. Elevations (Show whether DF, RT, GR, etc.)

4012' GL (unprepared)

14. Kind & Status Plug. Bond  
Blanket

15. Drilling Contractor  
Will advise later

16. Approx. Date Work will start  
Upon approval

17.

PROPOSED CASING AND CEMENT PROGRAM

SIZE OF HOLE	SIZE OF CASING	WEIGHT PER FOOT	SETTING DEPTH	SACKS OF CEMENT	EST. TOP
17-1/2"	13-3/8"	54.5	1800'	1000 (1)	Surface
12-1/4"	8-5/8"	24, 32	5000'	1150 (2)	Surface
7-7/8"	5-1/2"	14, 15.5, 17	8900	300 (3)	7500'

(1) Class "C" + 2% CaCl<sub>2</sub>.

(2) Lead: 1000 sx Class "C" 65/35 Poz + 6% bentonite + 5% salt.  
Tail: 150 sx Class "C" Neat

(3) Class "C" + 05.% FLA (or equiv.) + 0.35% CD31 (or equiv.)

Shares Proration Unit with Santa Fe "A" No. 1.  
Use mud additives as required for control.

BOP Equipment: Figure No. 7-9 or 7-10 (see attached schematic).

IN ABOVE SPACE DESCRIBE PROPOSED PROGRAM: IF PROPOSAL IS TO DEEPEN OR PLUG BACK, GIVE DATA ON PRESENT PRODUCTIVE ZONE AND PROPOSED NEW PRODUCTIVE ZONE. GIVE BLOWOUT PREVENTER PROGRAM, IF ANY.

I hereby certify that the information above is true and complete to the best of my knowledge and belief.

SIGNATURE L. M. Sanders TITLE Supv., Reg. & Proration DATE 10-26-90  
TYPE OR PRINT NAME L. M. Sanders TELEPHONE NO. 368-1488

(This space for State Use)

Orig. Signed by  
Paul Kautz  
Geologist

APPROVED BY \_\_\_\_\_ TITLE \_\_\_\_\_ DATE NOV 01 1990

CONDITIONS OF APPROVAL, IF ANY:

Permit Expires 6 Months From Approval  
Date Unless Drilling Underway.

RECEIVED

OCT 31 1990

OCO  
HOBBS OFFICE

Submit to Appropriate  
District Office  
State Leases - 4 copies  
Fee Leases - 3 copies

State of New Mexico  
Energy, Minerals and Natural Resources Department

Form C-102  
Revised 1-1-89

OIL CONSERVATION DIVISION

P.O. Box 2088  
Santa Fe, New Mexico 87504-2088

DISTRICT I  
P.O. Box 1980, Hobbs, NM 88240

DISTRICT II  
P.O. Drawer DD, Artesia, NM 88210

DISTRICT III  
1000 Rio Brazos Rd., Aztec, NM 87410

WELL LOCATION AND ACREAGE DEDICATION PLAT

All Distances must be from the outer boundaries of the section

Operator PHILLIPS PETROLEUM CO.			Lease Santa Fe "A" <i>com</i>		Well No. 2
Unit Letter E	Section 7	Township 17 South	Range 35 East	County Lea	
Actual Footage Location of Well: 1840 feet from the North line and 755 feet from the West line					
Ground level Elev. 4012.2		Producing Formation Abo		Pool North Vacuum Abo	
					Dedicated Acreage: 80 75.06 Acres

1. Outline the acreage dedicated to the subject well by colored pencil or hatchure marks on the plat below.
2. If more than one lease is dedicated to the well, outline each and identify the ownership thereof (both as to working interest and royalty).
3. If more than one lease of different ownership is dedicated to the well, have the interest of all owners been consolidated by communitization, unitization, force-pooling, etc.?  
☒ Yes ☐ No If answer is "yes" type of consolidation Communitization dated 09-17-71.  
If answer is "no" list the owners and tract descriptions which have actually been consolidated. (Use reverse side of this form if necessary).  
No allowable will be assigned to the well until all interests have been consolidated (by communitization, unitization, forced-pooling, or otherwise) or until a non-standard unit, eliminating such interest, has been approved by the Division.

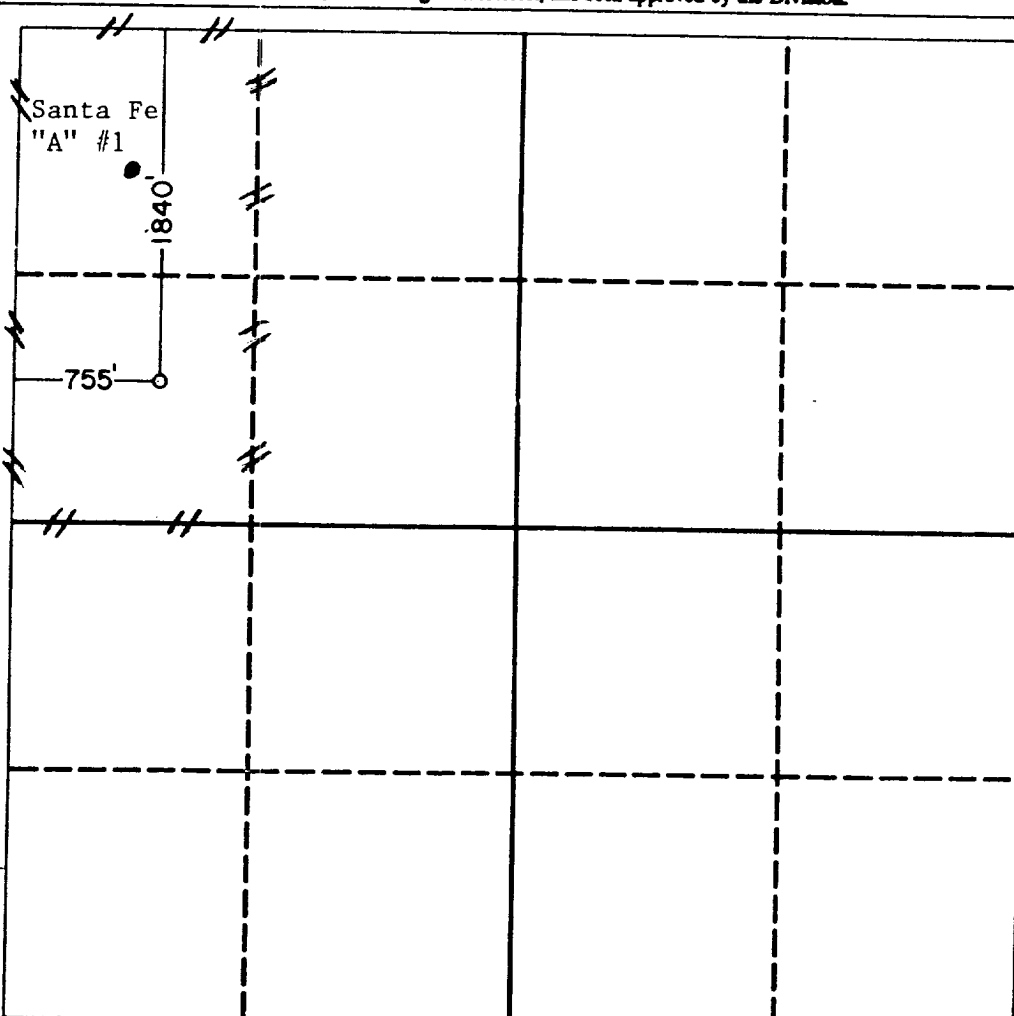

OPERATOR CERTIFICATION

I hereby certify that the information contained herein is true and complete to the best of my knowledge and belief.

*L. M. Sanders*  
Signature

L. M. Sanders

Printed Name

Supv., Reg. & Proration

Position

Phillips Petroleum Company

Company

October 26, 1990

Date

SURVEYOR CERTIFICATION

I hereby certify that the well location shown on this plat was plotted from field notes of actual surveys made by me or under my supervision, and that the same is true and correct to the best of my knowledge and belief.

Date Surveyed

June 21, 1990

Signature & Seal of  
Professional Surveyor

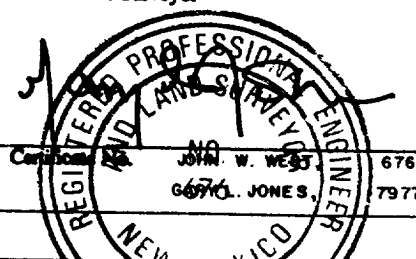

RECEIVED

**OCT 31 1990**

OCD  
**NOBBS OFFICE**

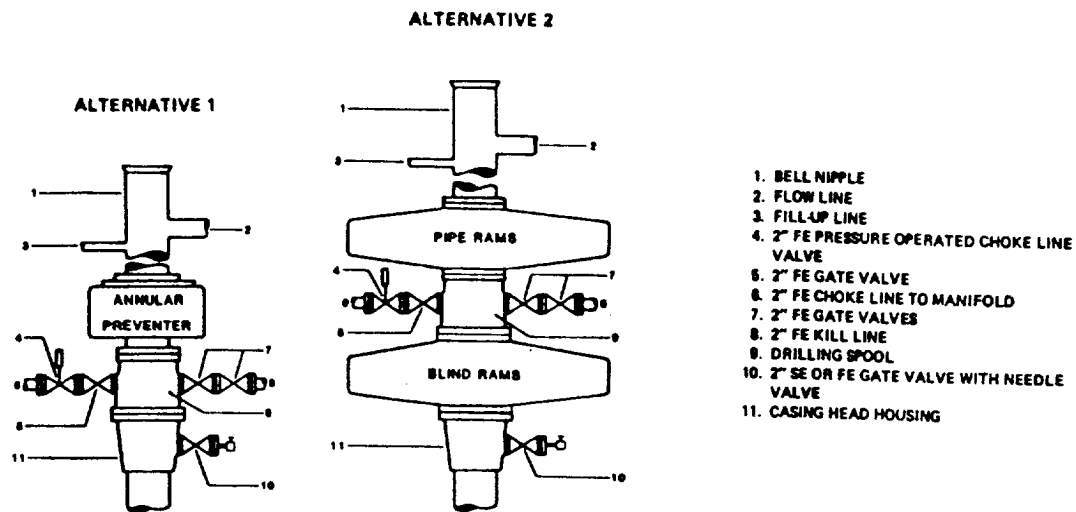

NOTE: THE DRILLING SPOOL MAY BE LOCATED BELOW BOTH SETS OF RAMS IF A DOUBLE PREVENTER IS USED AND IT DOES NOT HAVE SUITABLE OUTLETS BETWEEN RAMS

Figure 7-9. Standard Hydraulic Blowout Preventer Assembly (2 M or 3 M Working Pressure) Alternative 1

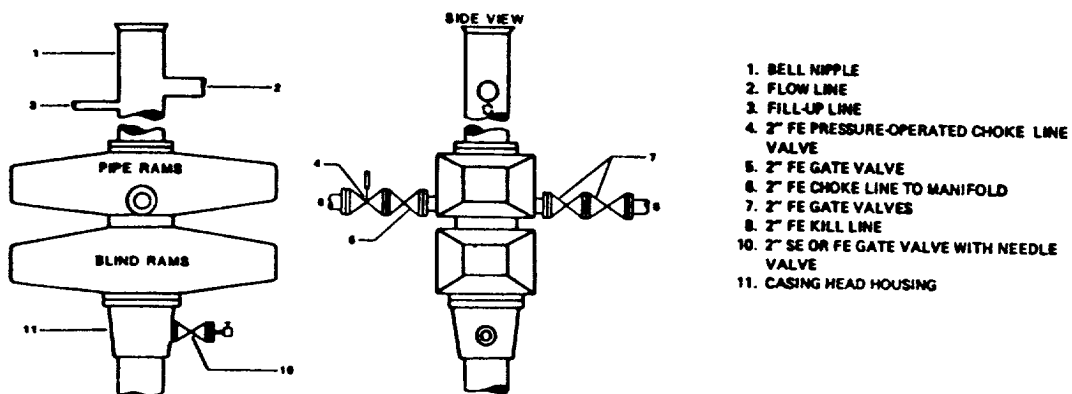

Figure 7-10. Standard Hydraulic Blowout Preventer Assembly (2 M or 3 M Working Pressure) Alternative 3 (without Drilling Spool)