

Submit to Appropriate
District Office
State Lease - 6 copies
Fee Lease - 5 copies

State of New Mexico
Energy, Minerals and Natural Resources Department

Form C-101
Revised 1-1-89

OIL CONSERVATION DIVISION

P.O. Box 2088
Santa Fe, New Mexico 87504-2088

DISTRICT I
P.O. Box 1980, Hobbs, NM 88240

DISTRICT II
P.O. Drawer DD, Artesia, NM 88210

DISTRICT III
1000 Rio Brazos Rd., Aztec, NM 87410

API NO. (assigned by OCD on New Wells)

30-025-31121

5. Indicate Type of Lease

STATE ☒

FEE ☐

6. State Oil & Gas Lease No.

E-5838

APPLICATION FOR PERMIT TO DRILL, DEEPEN, OR PLUG BACK

1a. Type of Work:

DRILL ☒

RE-ENTER ☐

DEEPEN ☐

PLUG BACK ☐

b. Type of Well:

OIL
WELL ☒

GAS
WELL ☐

OTHER ☐

SINGLE
ZONE ☐

MULTIPLE
ZONE ☐

7. Lease Name or Unit Agreement Name

East Pearl Queen Unit

2. Name of Operator

Pyramid Energy, Inc.

8. Well No.

#82

3. Address of Operator

14100 San Pedro, Ste. 700 San Antonio, Texas 78232

9. Pool name or Wildcat

Pearl Queen

4. Well Location

Unit Letter K : 1500 Feet From The South Line and 1410 Feet From The West Line

Section 27

Township

19S

Range

35E

NMPM

Lea

County

10. Proposed Depth

5200'

11. Formation

Queen

12. Rotary or C.T.

Rotary

13. Elevations (Show whether DF, RT, GR, etc.)

14. Kind & Status Plug. Bond

Surety Bond-Current

15. Drilling Contractor

Peterson

16. Approx. Date Work will start

01-11-91

17. PROPOSED CASING AND CEMENT PROGRAM

SIZE OF HOLE	SIZE OF CASING	WEIGHT PER FOOT	SETTING DEPTH	SACKS OF CEMENT	EST. TOP
12 1/4"	8 5/8"	24#	400'	250 sx.	surface
7 7/8"	5 1/2"	15.50# & 17#	5000'	1000 sx.	surface

IN ABOVE SPACE DESCRIBE PROPOSED PROGRAM: IF PROPOSAL IS TO DEEPEN OR PLUG BACK, GIVE DATA ON PRESENT PRODUCTIVE ZONE AND PROPOSED NEW PRODUCTIVE ZONE. GIVE BLOWOUT PREVENTER PROGRAM, IF ANY.

I hereby certify that the information above is true and complete to the best of my knowledge and belief.

SIGNATURE

Scott Graef

TITLE

Production Engineer

DATE 01-02-91

TYPE OR PRINT NAME

Scott Graef

TELEPHONE NO. (512) 490-500

(This space for State Use)

Original
Paul Kautz
Geologist

APPROVED BY

TITLE

DATE

CONDITIONS OF APPROVAL, IF ANY:

MSL-2976

1. This permit is valid for 12 months from approval.
2. This permit is valid for 12 months from approval.

BOP

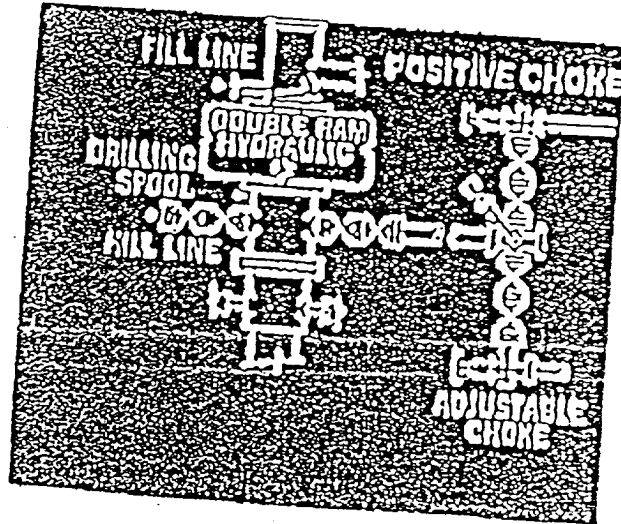

N. MEXICO OIL CONSERVATION COMMISS
WELL LOCATION AND ACREAGE DEDICATION PLAT

Form C-102
 Supersedes C-128
 Effective 1-1-65

All distances must be from the outer boundaries of the Section.

Operator PYRAMID ENERGY INC.			Lease East Pearl Queen Unit		Well No. 82
Unit Letter K	Section 27	Township 19 South	Range 35 East	County Lea County, N.M.	
Actual Footage Location of Well: 1500 feet from the South line and 1410 feet from the West line					
Ground Level Elev. 3721.	Producing Formation Queen	Pool Pearl Queen		Dedicated Acreage 40 Acres	

1. Outline the acreage dedicated to the subject well by colored pencil or hachure marks on the plat below.
2. If more than one lease is dedicated to the well, outline each and identify the ownership thereof (both as to working interest and royalty).
3. If more than one lease of different ownership is dedicated to the well, have the interests of all owners been consolidated by communitization, unitization, force-pooling, etc?

☒ Yes ☐ No If answer is "yes," type of consolidation Unitization

If answer is "no," list the owners and tract descriptions which have actually been consolidated. (Use reverse side of this form if necessary.) _____

No allowable will be assigned to the well until all interests have been consolidated (by communitization, unitization, forced-pooling, or otherwise) or until a non-standard unit, eliminating such interests, has been approved by the Commission.

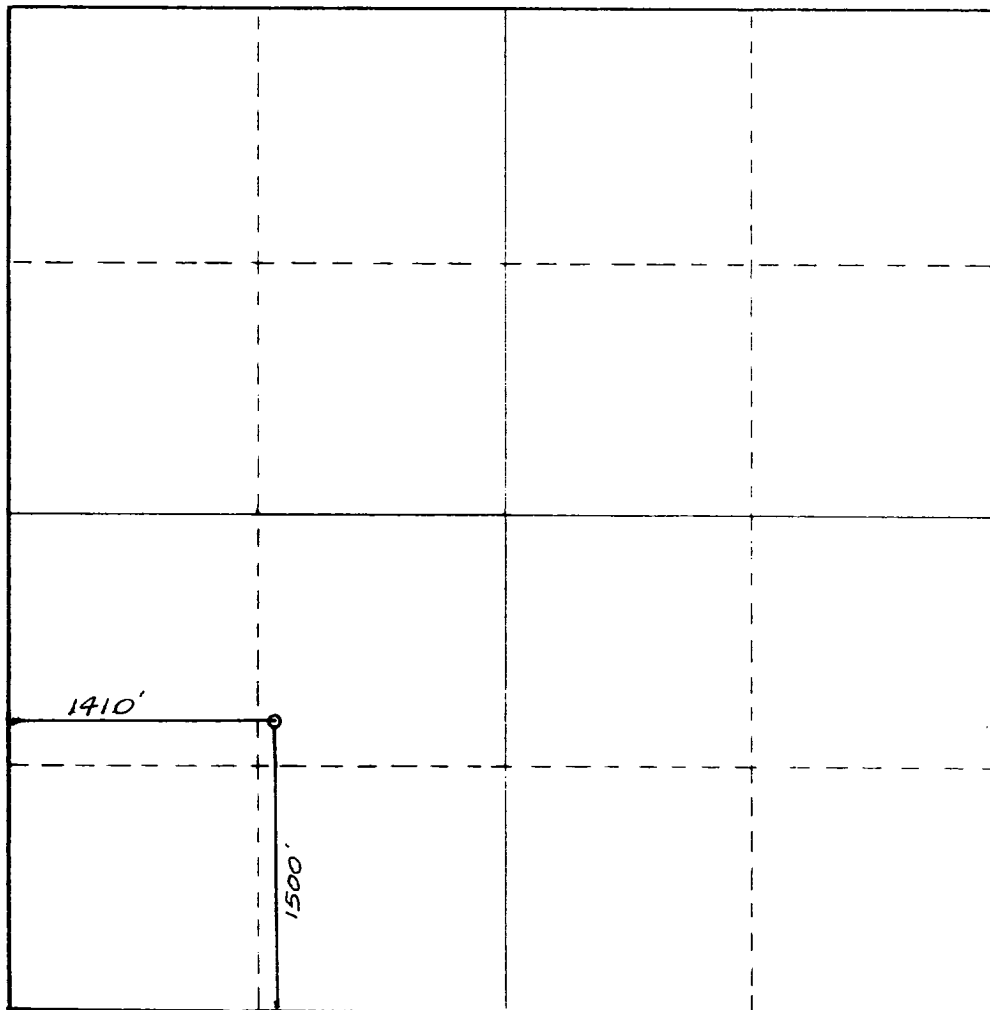

CERTIFICATION

I hereby certify that the information contained herein is true and complete to the best of my knowledge and belief.

Scott Graef

Name Scott Graef

Position Production Engineer

Company Pyramid Energy, Inc.

Date 01/02/91

I hereby certify that the well location shown on this plat was plotted from field notes of actual surveys made by me or under my supervision, and that the same is true and correct to the best of my knowledge and belief.

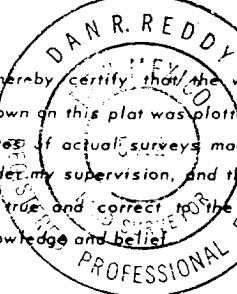

Date Surveyed December 29, 1990

Registered Professional Engineer and/or Land Surveyor

Dan R. Reddy

Certificate No.

NM PE&PS NO. 5412

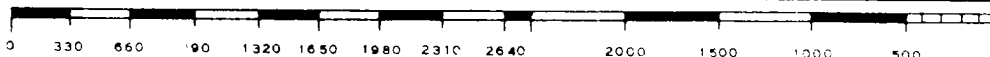

12-7-71
113

JAN 11 1971

1
HOZAK 2000