



STATE OF NEW MEXICO
ENERGY, MINERALS AND NATURAL RESOURCES DEPARTMENT

OIL CONSERVATION DIVISION
HOBBS DISTRICT OFFICE

BRUCE KING
GOVERNOR

5-28-91

POST OFFICE BOX 1980
HOBBS, NEW MEXICO 88241-1980
(505) 393-6161

OIL CONSERVATION DIVISION
P. O. BOX 2088
SANTA FE, NEW MEXICO 87501

NSL-3013

RE: Proposed:

MC _____
DHC _____
NSL ☒ _____
NSP _____
SWD _____
WFX _____
PMX _____

Gentlemen:

I have examined the application for the:

Greenhill Petroleum Corp. West Lovington Unit #78-P 5-17-36.
Operator Lease & Well No. Unit S-T-R

and my recommendations are as follows:

OK

Yours very truly,

Jerry Sexton
Supervisor, District 1

/ed



GREENHILL PETROLEUM CORPORATION

12777 JONES ROAD, SUITE 375
HOUSTON, TEXAS 77070
TELEPHONE (713) 955-1146
FAX (713) 890-2405

Incorporated in Delaware, U.S.A.

May 16, 1991

Oil Conservation Division
State of New Mexico
Energy, Minerals and Natural Resources Dept.
P.O. Box 2088
Santa Fe, NM 87504-2088

Attn: Mike Stogner

Re: Unorthodox Location and Drilling Permit
Proposed Well No. 78
West Lovington
Lea County, New Mexico

Greenhill Petroleum Corporation respectfully requests the State of New Mexico Oil Conservation Division grant approval of the proposed unorthodox location and the attached permit to drill Well Number 78 in the West Lovington Unit, located in Lea County, New Mexico.

The West Lovington Unit is presently developed and being water-flooded utilizing a 40-acre well density. It is believed that infill development using a 20-acre well density will improve waterflood sweep efficiency and will increase secondary oil recovery. The proposed location for Well No. 78 is located in the interior of the unit and is not competitive with offset wells outside the unit. Information gathered as a result of drilling this infill well will be utilized in evaluating additional infill development potential in the unit and ultimately may be used to evaluate the feasibility of tertiary recovery.

Greenhill Petroleum Corporation wishes to commence drilling operations of the proposed well as soon as possible and would appreciate a response to this request at your earliest convenience.

Respectfully yours,

GREENHILL PETROLEUM CORPORATION
Michael J. Newport
Michael J. Newport
Land Manager-Permian Basin

MJN:JB
Enclosures

Submit to Appropriate
District Office
State Lease - 4 copies
Fee Lease - 3 copies

State of New Mexico
Energy, Minerals and Natural Resources Department

Form C-102
Revised 1-1-89

OIL CONSERVATION DIVISION

DISTRICT I
P.O. Box 1980, Hobbs, NM 88240

P.O. Box 2088

Santa Fe, New Mexico 87504-2088

DISTRICT II
P.O. Drawer DD, Artesia, NM 88210

DISTRICT III
1000 Rio Brazos Rd., Aztec, NM 87410

WELL LOCATION AND ACREAGE DEDICATION PLAT

All Distances must be from the outer boundaries of the section

Operator GREENHILL PETROLEUM CORP.			Lease WEST LOVINGTON UNIT		Well No. 78
Unit Letter P	Section 5	Township 17 SOUTH	Range 36 EAST	County LEA	

Actual Footage Location of Well:

1305 feet from the SOUTH line and 15 feet from the EAST line			
Ground level Elev. 3884.4	Producing Formation San Andres	Pool West Lovington Upper A	Dedicated Acreage: 4/0 Acres

1. Outline the acreage dedicated to the subject well by colored pencil or hatchure marks on the plat below.
2. If more than one lease is dedicated to the well, outline each and identify the ownership thereof (both as to working interest and royalty).
3. If more than one lease of different ownership is dedicated to the well, have the interest of all owners been consolidated by communitization, unitization, force-pooling, etc.?
☐ Yes ☐ No If answer is "yes" type of consolidation UNITIZED
If answer is "no" list the owners and tract descriptions which have actually been consolidated. (Use reverse side of this form if necessary).
No allowable will be assigned to the well until all interests have been consolidated (by communitization, unitization, forced-pooling, or otherwise) or until a non-standard unit, eliminating such interest, has been approved by the Division.

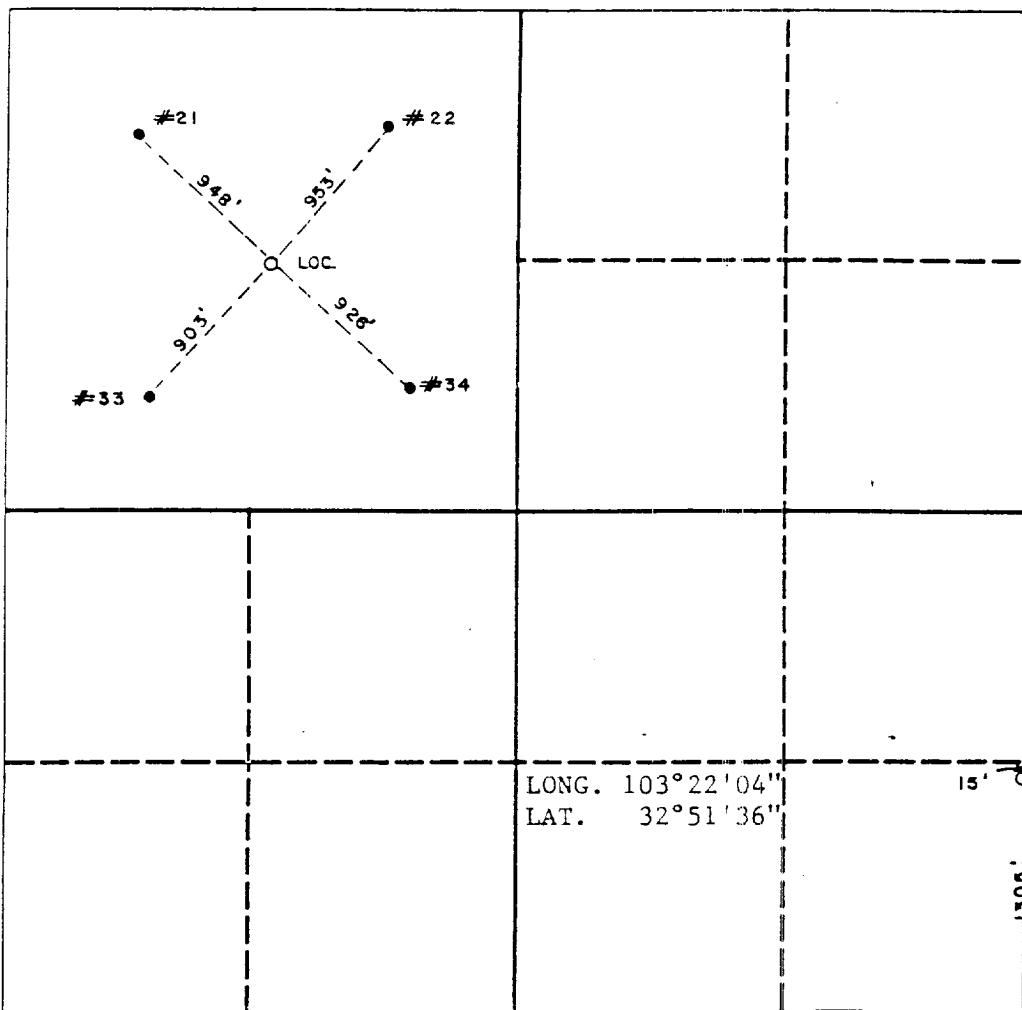

OPERATOR CERTIFICATION

I hereby certify that the information contained herein is true and complete to the best of my knowledge and belief.

Signature <i>Michael J. Newport</i>
Printed Name Michael J. Newport
Position Land Manager
Company Greenhill Petroleum
Date 5/15/91

SURVEYOR CERTIFICATION

I hereby certify that the well location shown on this plat was plotted from field notes of actual surveys made by me or under my supervision, and that the same is true and correct to the best of my knowledge and belief.

Date Surveyed 5-3-91
Signature & Seal of Professional Surveyor <i>John W. West</i>
Certificate No. JOHN W. WEST 676
RONALD A. ECKSON, 3239

