

Submit to Appropriate  
District Office  
State Lease - 4 copies  
Fee Lease - 3 copies

State of New Mexico  
Energy, Minerals and Natural Resources Department

Form C-102  
Revised 1-1-89

OIL CONSERVATION DIVISION

P.O. Box 2088

Santa Fe, New Mexico 87504-2088

DISTRICT I

P.O. Box 1980, Hobbs, NM 88240

DISTRICT II

P.O. Drawer DD, Artesia, NM 88210

DISTRICT III

1000 Rio Brazos Rd., Aztec, NM 87410

WELL LOCATION AND ACREAGE DEDICATION PLAT

All Distances must be from the outer boundaries of the section

Operator GREENHILL PETROLEUM CORP.			Lease LOVINGTON SAN ANDRES UNIT		Well No. 73
Unit Letter A	Section 1	Township 17 SOUTH	Range 36 EAST	County LEA	
Actual Footage Location of Well: 1210 feet from the NORTH line and 1170 feet from the EAST line					
Ground level Elev. 3827.1	Producing Formation San Andres		Pool Lovington Grayburg San Andres		Dedicated Acreage: 40 Acres

1. Outline the acreage dedicated to the subject well by colored pencil or hatchure marks on the plat below.

2. If more than one lease is dedicated to the well, outline each and identify the ownership thereof (both as to working interest and royalty).

3. If more than one lease of different ownership is dedicated to the well, have the interest of all owners been consolidated by communitization, unitization, force-pooling, etc.?

☒ Yes

☐ No

If answer is "yes" type of consolidation Unitized

If answer is "no" list the owners and tract descriptions which have actually been consolidated. (Use reverse side of this form if necessary.)

No allowable will be assigned to the well until all interests have been consolidated (by communitization, unitization, forced-pooling, or otherwise) or until a non-standard unit, eliminating such interest, has been approved by the Division.

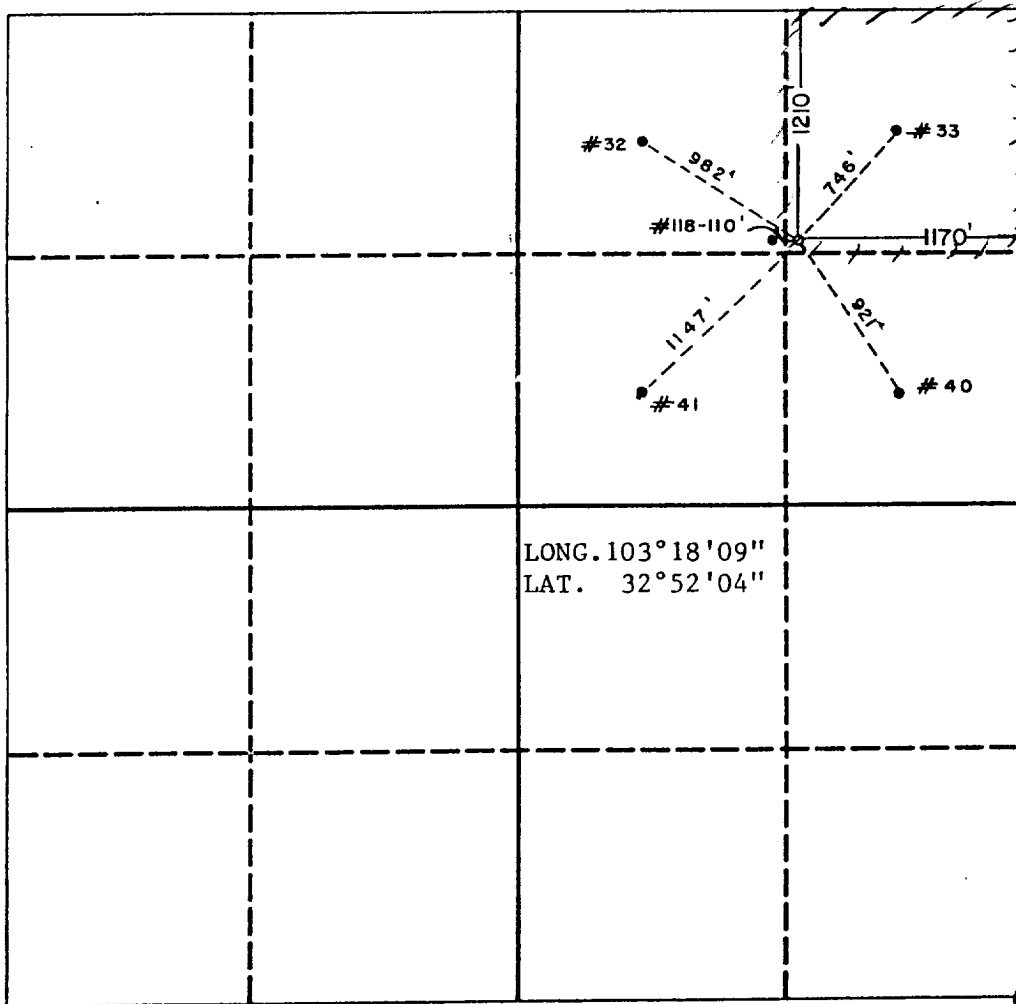

OPERATOR CERTIFICATION

I hereby certify that the information contained herein is true and complete to the best of my knowledge and belief.

Signature

*Michael J. Newport*

Printed Name

Michael J. Newport

Position

Landman

Company

Greenhill Petroleum Corp

Date

8/21/91

SURVEYOR CERTIFICATION

I hereby certify that the well location shown on this plat was plotted from field notes of actual surveys made by me or under my supervision, and that the same is true and correct to the best of my knowledge and belief.

Date Surveyed

7-26-91

Signature & Seal of Professional Surveyor

JOHN W. WEST

676

NEW MEXICO

JOHN W. WEST

676

Certificate No.

JOHN W. WEST,

RONALD J. EIDSON,

676

3239