

Submit to Appropriate  
District Office  
State Lease - 6 copies  
Fee Lease - 5 copies

State of New Mexico  
Energy, Minerals and Natural Resources Department

Form C-101  
Revised 1-1-89

OIL CONSERVATION DIVISION

P.O. Box 2088  
Santa Fe, New Mexico 87504-2088

DISTRICT I  
P.O. Box 1980, Hobbs, NM 88240

DISTRICT II  
P.O. Drawer DD, Artesia, NM 88210

DISTRICT III  
1000 Rio Brazos Rd., Aztec, NM 87410

API NO. (assigned by OCD on New Wells)

30-025-31459

5. Indicate Type of Lease

STATE ☒ FEE ☐

6. State Oil & Gas Lease No.

84120

APPLICATION FOR PERMIT TO DRILL, DEEPEN, OR PLUG BACK

1a. Type of Work:

DRILL ☒

RE-ENTER ☐

DEEPEN ☐

PLUG BACK ☐

b. Type of Well:

OIL  
WELL ☒

GAS  
WELL ☐

OTHER ☐

SINGLE  
ZONE ☒

MULTIPLE  
ZONE ☐

7. Lease Name or Unit Agreement Name

West Lovington Unit

2. Name of Operator

GREENHILL PETROLEUM CORPORATION

8. Well No.

94

3. Address of Operator

11490 Westheimer, Suite 200, Houston, TX. 77077

9. Pool name or Wildcat

West Lovington Upper San Andres

4. Well Location

Unit Letter

E

: 15

Feet From The

West

Line and

2625

Feet From The

North

Line

Section

8

Township

17 South

Range 36 East

NMPM

Lea

County

10. Proposed Depth

5230

11. Formation

San Andres

12. Rotary or C.T.

Rotary

13. Elevations (Show whether DF, RT, GR, etc.)

3894.3

14. Kind & Status Plug. Bond

Blanket on file

15. Drilling Contractor

TBD

16. Approx. Date Work will start

12-1-91

17.

PROPOSED CASING AND CEMENT PROGRAM

SIZE OF HOLE	SIZE OF CASING	WEIGHT PER FOOT	SETTING DEPTH	SACKS OF CEMENT	EST. TOP
12 1/4	8 5/8	24#	350'	250	Surface
7 7/8	5 1/2	15.5#	5230'	1300	Surface

IN ABOVE SPACE DESCRIBE PROPOSED PROGRAM: IF PROPOSAL IS TO DEEPEN OR PLUG BACK, GIVE DATA ON PRESENT PRODUCTIVE ZONE AND PROPOSED NEW PRODUCTIVE ZONE. GIVE BLOWOUT PREVENTER PROGRAM, IF ANY.

I hereby certify that the information above is true and complete to the best of my knowledge and belief.

SIGNATURE

*Michael J. Newport*

TITLE Land Manager-Permian Basin DATE 11-11-91

713 589-8484

TYPE OR PRINT NAME

Michael J. Newport

TELEPHONE NO.

(This space for State Use) ORIGINAL SIGNATURE OF APPROVING OFFICIAL

JAN 22 '92

APPROVED BY

TITLE

DATE

CONDITIONS OF APPROVAL, IF ANY:

NLF-3090

Permit Expires 6 Months From Approval  
Date Unless Drilling Underway.

GREENHILL PETROLEUM CORPORATION  
BOP PROGRAM FOR WEST LOVINGTON UNIT NUMBER 94

Casing Program

BOP Program

<u>Size</u>	<u>Depth</u>	<u>Wt.</u>	<u>Grade</u>	<u>Configuration</u>	<u>Test Program</u>
8 5/8"	350'	24#	J55, STC	*RR or RA	250/1500 psi
5 1/2"	5230'	15.5#	J55, STC	N/A	

\*RR-Ram Ram  
RA-Ram Annular

Submit to Appropriate  
District Office  
State Lease - 4 copies  
Fee Lease - 3 copies

State of New Mexico  
Energy, Minerals and Natural Resources Department

Form C-102  
Revised 1-1-89

OIL CONSERVATION DIVISION

P.O. Box 2088  
Santa Fe, New Mexico 87504-2088

DISTRICT I  
P.O. Box 1980, Hobbs, NM 88240

DISTRICT II  
P.O. Drawer DD, Artesia, NM 88210

DISTRICT III  
1000 Rio Brazos Rd., Aztec, NM 87410

WELL LOCATION AND ACREAGE DEDICATION PLAT

All Distances must be from the outer boundaries of the section

Operator GREENHILL PETROLEUM CORP.			Lease WEST LOVINGTON UNIT		Well No. 94
Unit Letter E	Section 8	Township 17 SOUTH	Range 36 EAST	County LEA	
Actual Footage Location of Well: 15 feet from the WEST line and 2625 feet from the NORTH line					
Ground level Elev. 3894.3	Producing Formation San Andres		Pool Lovington Upper San Andres, West	Dedicated Acreage: 20 40 Acres	

- Outline the acreage dedicated to the subject well by colored pencil or hatchure marks on the plat below.
- If more than one lease is dedicated to the well, outline each and identify the ownership thereof (both as to working interest and royalty).
- If more than one lease of different ownership is dedicated to the well, have the interest of all owners been consolidated by communitization, unitization, force-pooling, etc.?  
☒ Yes ☐ No If answer is "yes" type of consolidation unitized  
If answer is "no" list the owners and tract descriptions which have actually been consolidated. (Use reverse side of this form if necessary.)  
No allowable will be assigned to the well until all interests have been consolidated (by communitization, unitization, forced-pooling, or otherwise) or until a non-standard unit, eliminating such interest, has been approved by the Division.

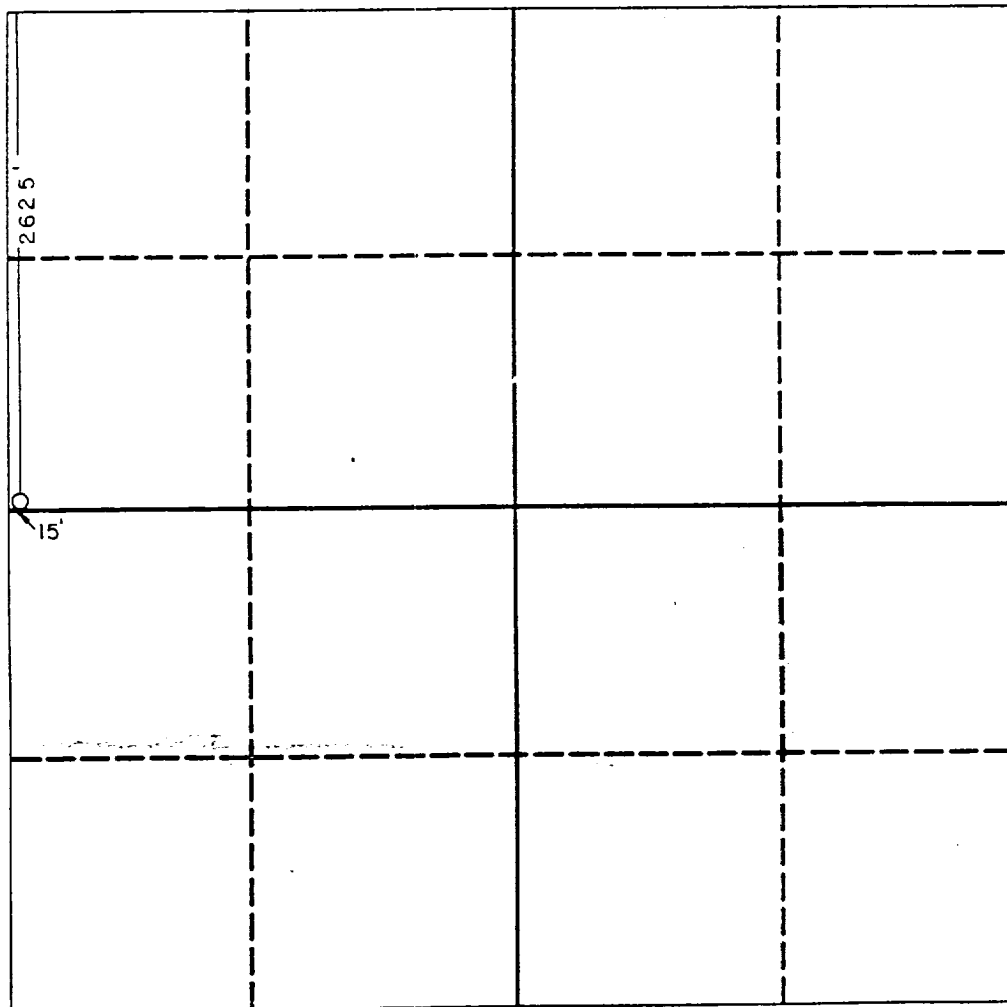

OPERATOR CERTIFICATION

I hereby certify that the information contained herein is true and complete to the best of my knowledge and belief.

Michael J. Newport

Signature

*Michael J. Newport*

Printed Name

Land Manager-Permian Basin  
Position

Greenhill Petroleum Corp.  
Company

11-11-91  
Date

SURVEYOR CERTIFICATION

I hereby certify that the well location shown on this plat was plotted from field notes of actual surveys made by me or under my supervision, and that the same is true and correct to the best of my knowledge and belief.

Date Surveyed

10-15-91

Signature & Seal of  
Professional Surveyor

*Ronald J. Eidson*  
Certificate No. 676  
RONALD J. EIDSON, 3239  
W.O. 91-11-0117